

**INDEX OF SHEETS**

SEE SHEET 2

STATE OF VERMONT  
AGENCY OF TRANSPORTATION

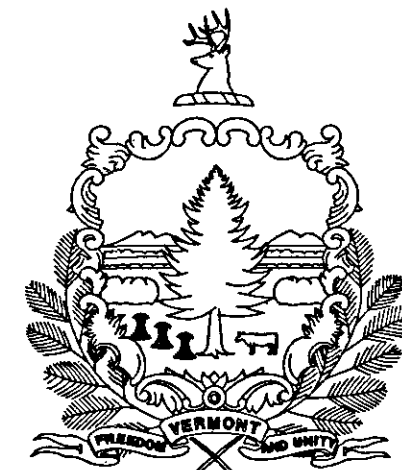

PROPOSED IMPROVEMENT  
BRIDGE PROJECT  
TOWN OF JOHNSON  
COUNTY OF LAMOILLE

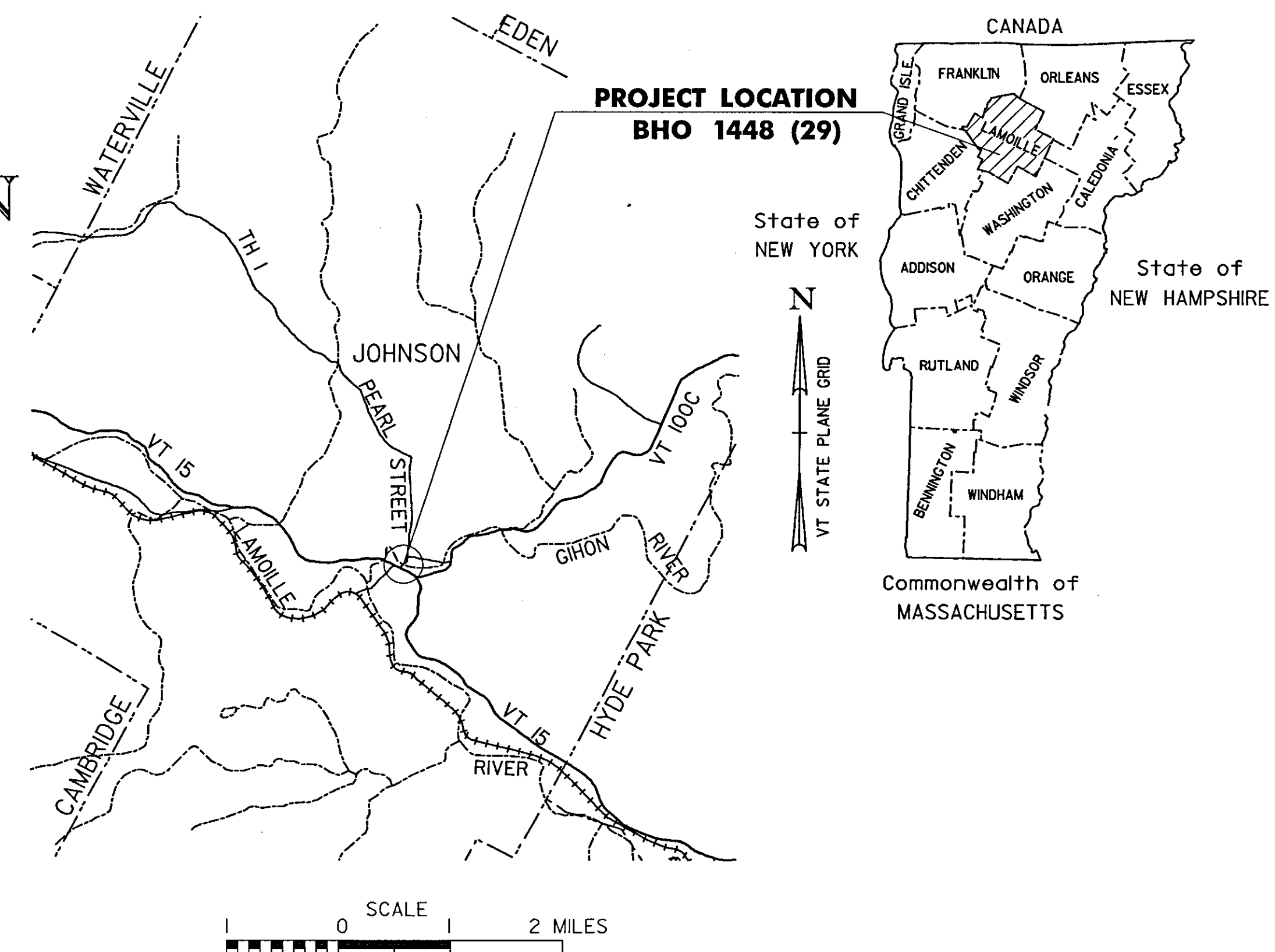

ROUTE NO : TH 1 CLASS 2 BRIDGE NO : 5  
FUNCTIONAL CLASSIFICATION: LOCAL ROAD

PROJECT LOCATION : BEGINNING ON TH NO.1 AT A POINT 230 FEET NORTHEAST OF THE INTERSECTION OF VT ROUTE 15 IN THE TOWN OF JOHNSON AND EXTENDING NORTHEAST 245 FEET ALONG TH NO.1

PROJECT DESCRIPTION : REMOVAL OF EXISTING SUPERSTRUCTURE AND PARTIAL REMOVAL OF ABUTMENT NO.2, REHABILITATION OF ABUTMENT NO.1 AND PIER, CONSTRUCTION OF A NEW COMPOSITE STEEL BEAM AND CONCRETE DECK SUPERSTRUCTURE, CAST-IN-PLACE CONCRETE ABUTMENT NO.2 AND CAST-IN-PLACE CONCRETE SIDEWALK WITH ASSOCIATED ROADWAY APPROACH IMPROVEMENTS.

LENGTH OF STRUCTURE : 151.00 FEET.  
LENGTH OF ROADWAY : 94.00 FEET.  
LENGTH OF PROJECT : 245.00 FEET.

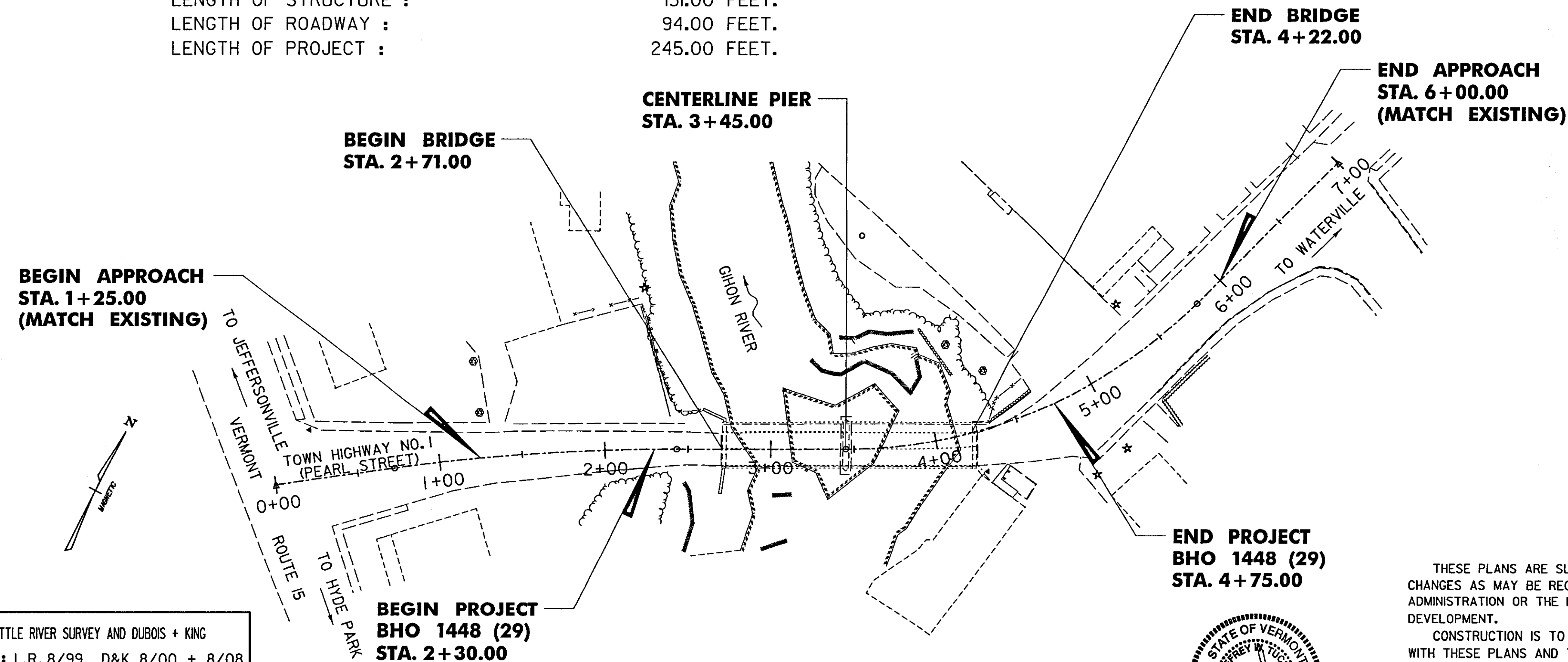

**RECORD PLANS**

CONTRACTOR: S. D. IRELAND CONC. CONST. CORP - BURLINGTON, VT

RESIDENT ENGINEER: CARL GLEASON

CONSTRUCTION BEGAN: JUNE 1, 2009

CONSTRUCTION COMPLETE: OCTOBER 21, 2010

RECORD PLANS BY: CARL GLEASON & MATT BIRCHARD

I HEREBY CERTIFY THAT ALL THE CONSTRUCTION REQUIRED BY THIS SET OF DRAWINGS HAS BEEN ACCOMPLISHED AS INDICATED HEREIN.

BY: *Carl Gleason* RESIDENT ENGINEER  
DATE: 4/26/11

NOTE: Any further information concerning final quantities, amounts or other details relative to this project may be found at Central Files in the electronic archives.

**CONVENTIONAL SYMBOLS**

COUNTY LINE	
TOWN LINE	
LIMITS OF ACCESS	
POINT OF ACCESS	
FENCE LINE	
STONE WALL	
TRAVELED WAY	
GUARD RAIL	
RAILROAD	
SURVEY LINE	
CULVERT	
POWER POLE	
TELEPHONE POLE	
TREES	
CONTROL OF ACCESS	
PROPERTY LINE	
R.O.W. TAKING LINE	
SLOPE RIGHTS	
TOP OF CUT	
TOE OF SLOPE	

SURVEYED BY : LITTLE RIVER SURVEY AND DUBOIS + KING  
SURVEYED DATE : L.R. 8/99 D&K 8/00 + 8/08

DATUM  
VERTICAL : NAVD 88  
HORIZONTAL : ASSUMED



SCALE 1" = 50'-0"  
50 0 50

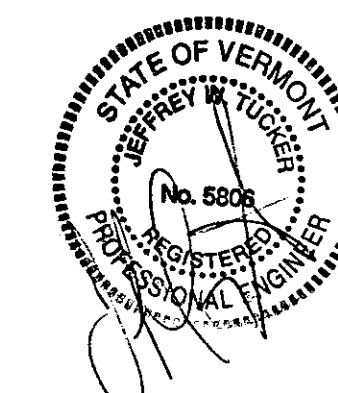

THESE PLANS ARE SUBJECT TO SUCH ENGINEERING CHANGES AS MAY BE REQUIRED BY THE FEDERAL HIGHWAY ADMINISTRATION OR THE DIRECTOR OF PROGRAM DEVELOPMENT.

CONSTRUCTION IS TO BE CARRIED ON IN ACCORDANCE WITH THESE PLANS AND THE STANDARD SPECIFICATIONS FOR CONSTRUCTION DATED 2006, AS APPROVED BY THE FEDERAL HIGHWAY ADMINISTRATION ON JUNE 15, 2006 FOR USE ON THIS PROJECT, INCLUDING ALL SUBSEQUENT REVISIONS AND SUCH REVISED SPECIFICATIONS AND SPECIAL PROVISIONS AS ARE INCORPORATED IN THESE PLANS.

DIRECTOR OF PROGRAM DEVELOPMENT  
APPROVED: *Kristin M. Higgins* DATE: 2-11-09

PROJECT MANAGER : KRISTIN M. HIGGINS, P.E.

PROJECT NAME : JOHNSON  
PROJECT NUMBER : BHO 1448 (29)

SHEET 1 OF 68 SHEETS

PLOTTED 2/9/2009