

LIGHT NO.	LOCATION	OFFSET	HEIGHT TO LUMINAIRE(FT)	MANUFACTURER	CATALOGUE No.	LAMPS	JUNCTION BOX	REMARKS
1	12+01.00	21'-1" RT	14'	LUMEC	CAND1-CN1-1A-150HPS-RR3-240V-GN4/TX-AM8U-15	(1) 150W/HPS	POLE	SITE LITE, 240V (VERIFY VOLTAGE)
2	12+87.00	21'-1" RT	14'	LUMEC	CAND1-CN1-1A-150HPS-RR3-240V-GN4/TX-AM8U-15	(1) 150W/HPS	POLE	SITE LITE, 240V (VERIFY VOLTAGE)
3	14+07.00	21'-1" RT	14'	LUMEC	CAND1-CN1-1A-150HPS-RR3-240V-GN4/TX-AM8U-15	(1) 150W/HPS	POLE	SITE LITE, 240V (VERIFY VOLTAGE)
4	14+93.00	21'-1" RT	14'	LUMEC	CAND1-CN1-1A-150HPS-RR3-240V-GN4/TX-AM8U-15	(1) 150W/HPS	POLE	SITE LITE, 240V (VERIFY VOLTAGE)

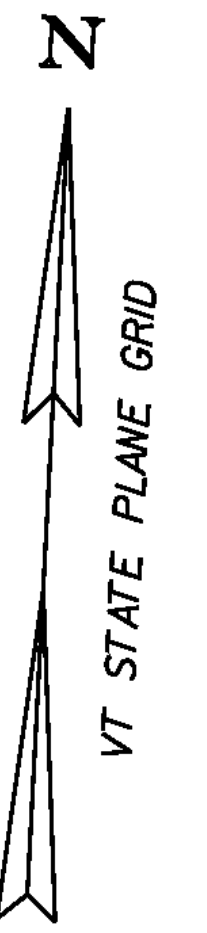
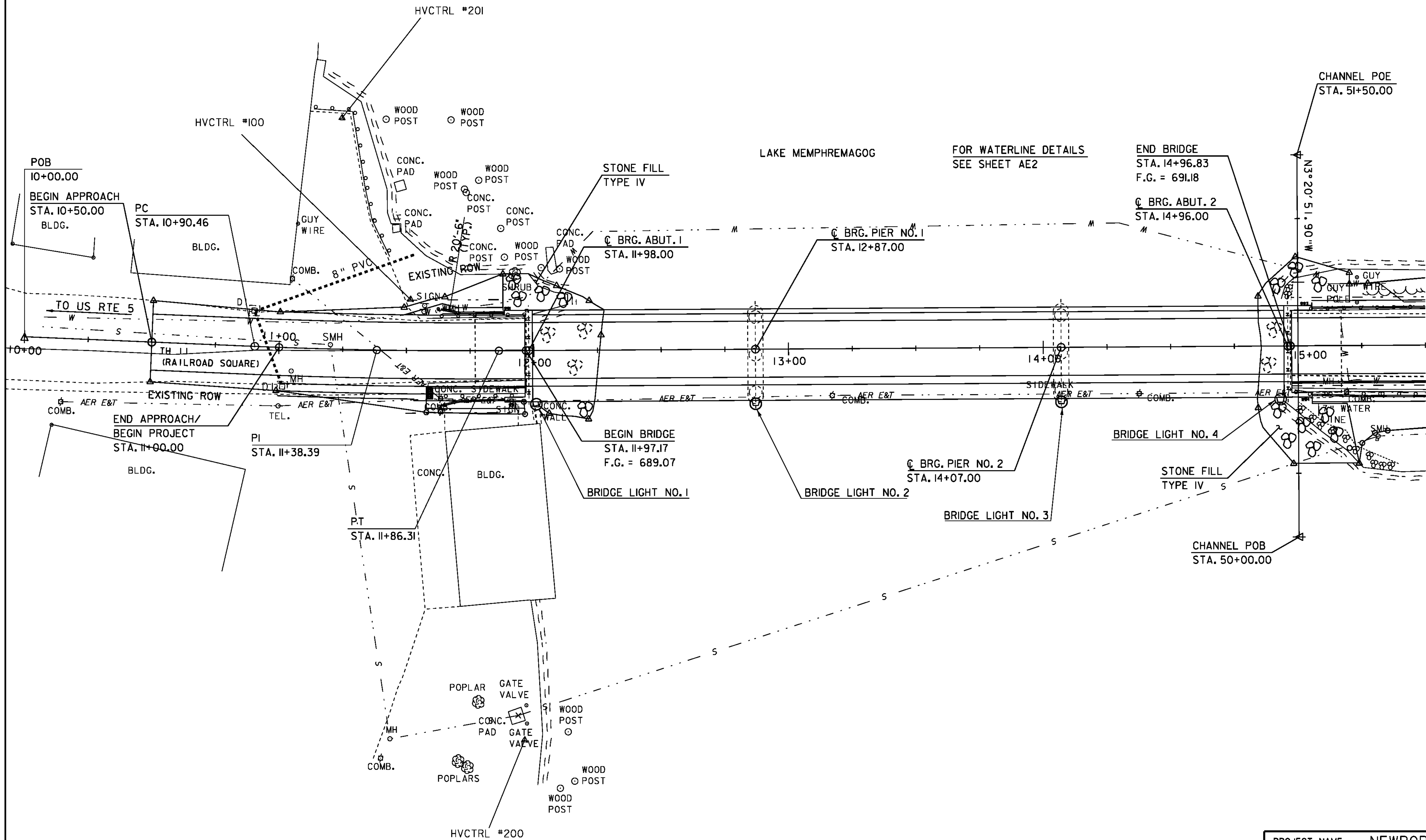

SCALE 1" = 20'-0"
20 0 20

PROJECT NAME: NEWPORT CITY	PLOT DATE: 22-NOV-2011
PROJECT NUMBER: BRO 1449(25)	DRAWN BY: C. MOONEY
FILE NAME: str/s96j314lighting.dgn	CHECKED BY: C. CARLSON
PROJECT LEADER: C. CARLSON	SHEET 36 OF 75
DESIGNED BY: D. PETERSON	
BRIDGE LIGHTING LAYOUT SHEET	