

STATE OF VERMONT AGENCY OF TRANSPORTATION MATERIALS & RESEARCH DIVISION SUBSURFACE INFORMATION		HOLE NO.: B-2 SHEET 1 OF 3 DATE STARTED: 11/27/01 DATE COMPLETED: 12/5/01							
PROJECT NAME: NEWPORT SITE NAME: BR 9 STATION: 4.5' east of Abutment #2 GROUND EL.: 690.76		PROJECT NUMBER: BHO 1449 (25) SITE NO.: MT. VERNON St. OFFSET: 5.5' south of centerline G.W. DEPTH:							
BORING CREW CREW CHIEF: TALLMAN DRILLER: TALLMAN LOGGER: RUSSELL		BORING RIG: LARGE SKID RIG BORING TYPE: WASH BORE SAMPLE TYPE: SPLIT BARREL							
DEPTH	SYMBOL	CLASSIFICATION OF MATERIALS (Description)	BLOWS PER FOOT	M.C. %	GRAVEL %	SAND %	FINES %	LL	PI
		0.0' - 1.1', Asphalt							
	CONCRETE	1.1' - 3.25', Concrete							
5		Visual Class: Possible Stone Fill, gry, Moist, Rec. = 0.20'	6	3.4					
		A-1-a, SaGr, brn, Wet, Rec. = 0.50'	10	9.7	71.2	21.5	7.3		
10		A-2-4, SaSiGr, brn, Wet, Rec. = 0.60'	8	14.6	35.5	32	32.5		
		A-1-a, Gr, brn, Moist, Rec. = 0.10'	15	7	76.1	18.7	5.2		
		12.0' - 14.0', No Rec.	34						
15		A-1-b, GrSa, brn, Wet, Rec. = 0.60'	11	13.4	33.2	52.1	14.7		
		A-1-a, Gr, gry, Moist, Rec. = 0.20'	14	4.3	93.3	5.8	0.9		
		A-1-b, SiSaGr, brn, Moist, Rec. = 0.70'	10	12.3	48.4	30.5	21.1		
20		20.0' - 22.0', No Rec.	7						
		A-2-4, GrSiSa, brn, Moist, Rec. = 0.50'	7	15.3	25.8	45	29.2		
25		A-2-4, SiGrSa, brn, Moist, Rec. = 0.50'	4	14.4	24	55.4	20.6		
		A-2-4, GrSiSa, brn, Wet, Rec. = 0.40'	6	26.8	20.5	57.2	22.3		
		A-2-4, SiSa, brn, Moist, Rec. = 1.00'	3	19.7	11.2	58.6	30.2		
30		A-2-4, SiSa, gry-brn, Moist, Rec. = 0.20'	4	23.3	4.3	74.7	21		
35		A-2-4, Sa, brn-gry, Moist, Rec. = 0.45'	7	25.1	0.8	84.5	14.7		
40		A-1-b, GrSa, brn-gry, Moist, Rec. = 1.0'	12	19.9	34.1	56.9	9		
45		A-1-a, Gr, gry, Moist, Rec. = 0.25'	26	5.8	96.5	1.3	2.2		
		Material appears to have changed @ 48.0'.							

BOTTOM OF
ABUTMENT NO. 2
ELEVATION 681.00

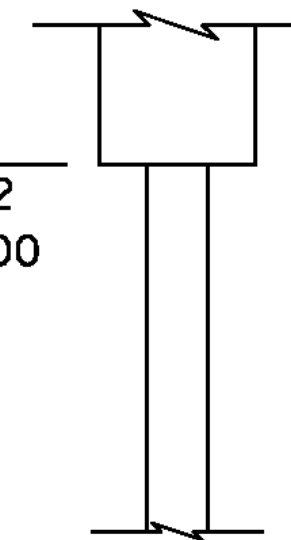

STATE OF VERMONT AGENCY OF TRANSPORTATION MATERIALS & RESEARCH DIVISION SUBSURFACE INFORMATION		HOLE NO.: B-2 SHEET 2 OF 3 DATE STARTED: 11/27/01 DATE COMPLETED: 12/5/01							
PROJECT NAME: NEWPORT SITE NAME: BR 9 STATION: 4.5' east of Abutment #2 GROUND EL.: 690.76		PROJECT NUMBER: BHO 1449 (25) SITE NO.: MT. VERNON St. OFFSET: 5.5' south of centerline G.W. DEPTH:							
BORING CREW CREW CHIEF: TALLMAN DRILLER: TALLMAN LOGGER: RUSSELL		BORING RIG: LARGE SKID RIG BORING TYPE: WASH BORE SAMPLE TYPE: SPLIT BARREL							
DEPTH	SYMBOL	CLASSIFICATION OF MATERIALS (Description)	BLOWS PER FOOT	M.C. %	GRAVEL %	SAND %	FINES %	LL	PI
		A-4, Si with Trace of Organics (7.4%), gry, Moist, Rec. = 1.60'	3	80.6	0.3	6	93.7		
55		A-4, Si with Trace of Organics (4.4%), gry, Moist, Rec. = 0.08'	12	58.8					
60		A-1-b, GrSa, gry, Moist, Rec. = 0.85', Some wood particles within sample.	20	17.3	36.6	53.8	9.6		
65		65.0' - 67.0', No Rec., Stone in end of sampler.	31						
70		A-4, Si, gry, Moist, Rec. = 0.15'	21	27.8		2.4	97.6		
75		A-4, Si, gry, Wet, Rec. = 0.25'	13	26.7	0.3	5.6	94.1		
80		BXDMDC, 79.0' - 80.5', Boulder							
		No sample, Pulled casing @ 80.5', Changed bit.							
85		A-1-b, SaGr, gry, Wet, Rec. = 0.50'	10	13.4	44.1	39.4	16.5		
90		BXDMDC, 88.5' - 90.5', Boulder, No Sample							
95		95.0' - 97.0', No Rec.	32						

STATE OF VERMONT AGENCY OF TRANSPORTATION MATERIALS & RESEARCH DIVISION SUBSURFACE INFORMATION		HOLE NO.: B-2 SHEET 3 OF 3 DATE STARTED: 11/27/01 DATE COMPLETED: 12/5/01							
PROJECT NAME: NEWPORT SITE NAME: BR 9 STATION: 4.5' east of Abutment #2 GROUND EL.: 690.76		PROJECT NUMBER: BHO 1449 (25) SITE NO.: MT. VERNON St. OFFSET: 5.5' south of centerline G.W. DEPTH:							
BORING CREW CREW CHIEF: TALLMAN DRILLER: TALLMAN LOGGER: RUSSELL		BORING RIG: LARGE SKID RIG BORING TYPE: WASH BORE SAMPLE TYPE: SPLIT BARREL							
DEPTH	SYMBOL	CLASSIFICATION OF MATERIALS (Description)	BLOWS PER FOOT	M.C. %	GRAVEL %	SAND %	FINES %	LL	PI
		A-2-4, SiSaGr, gry, Moist, Rec. = 0.90'	38	11	41.5	31.1	27.4		
105		Visual Classification: Various Broken Stone gry, Moist, Rec. = 0.20'	R						
110		No Rec. No Sample, Possible boulders or cobbles from 110.0' - 115.0'	R						
115		BXGDC, 115.0' - 120.0', Visual Class: Various Cobbles and Boulders Rec. = 0.10'							
120		Visual Class: Various Broken Stone, Rec. = 0.15'	R						
Hole stopped @ 120.45'									
Driller's Notes: 1. Various seams encountered between 105.0' and 117.0'									
125									
130									
135									
140									
145									

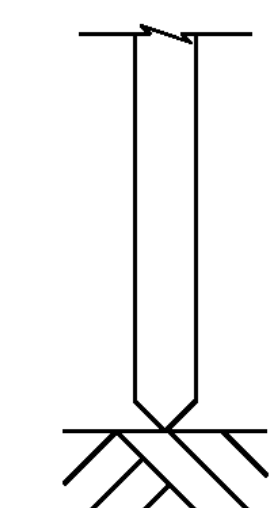

ESTIMATED PILE TIP
ELEVATION 544.00

PROJECT NAME: NEWPORT CITY	PLOT DATE: 22-NOV-2011
PROJECT NUMBER: BRO 1449(25)	DRAWN BY: J. TOUCHETTE
FILE NAME: 96j314/str/96j314bor.dgn	CHECKED BY: C. BENDA
PROJECT LEADER: C. CARLSON	SHEET 21 OF 75
DESIGNED BY: C. BENDA	
BORING LOG 2	