

ROOF FRAMING PLAN
SCALE: 1/4" = 1'-0"

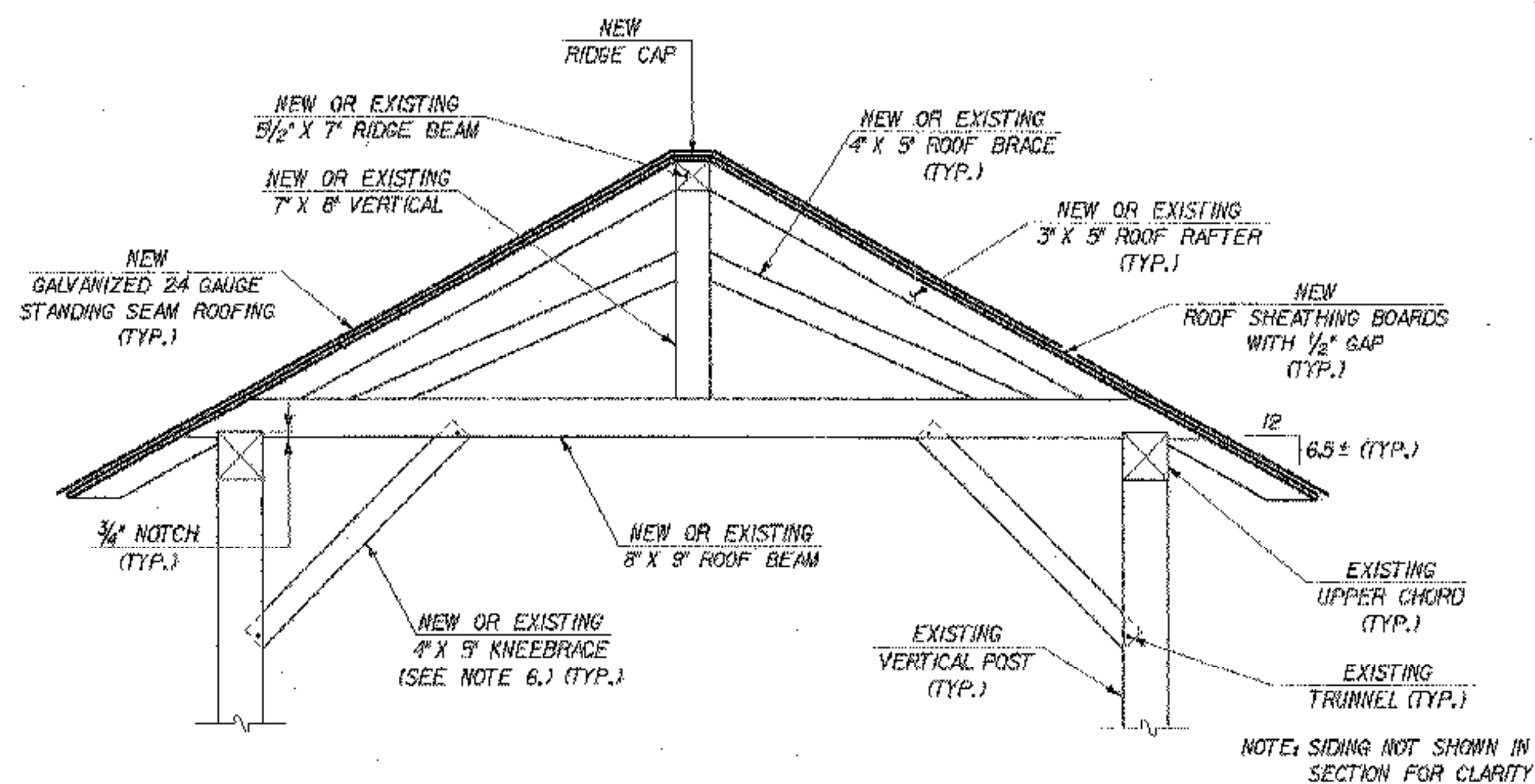

SECTION A-A
SCALE: 1/2" = 1'-0"

NOTES

1. REPLACE ROOF BEAMS AT LOCATIONS 2, 3 AND 6. ANY ADDITIONAL ROOF BEAMS THAT ARE FOUND TO BE IN A CONDITION THAT WARRANTS REPLACEMENT SHALL BE BROUGHT TO THE ATTENTION OF THE RESIDENT ENGINEER FOR ASSESSMENT AND APPROVAL FOR ESTIMATING PURPOSES. 2 ADDITIONAL NEW ROOF BEAMS HAVE BEEN INCLUDED IN ITEM 522.20, STRUCTURAL LUMBER & TIMBER - UNTREATED.
2. INDIVIDUAL ROOF RAFTERS SHALL BE RETAINED WHERE THESE ARE IN GOOD CONDITION WITH TIGHT JOINTS. DEFICIENT ROOF RAFTERS SHALL BE REPLACED AS ORDERED BY THE RESIDENT ENGINEER. FOR ESTIMATING PURPOSES, 20 NEW ROOF RAFTERS HAVE BEEN INCLUDED IN ITEM 522.20, STRUCTURAL LUMBER & TIMBER - UNTREATED.
3. STRUCTURAL ROOF SYSTEM MEMBERS SHALL BE FULL SAWN SPRUCE, NO.1 GRADE, AND PAID UNDER ITEM 522.20, STRUCTURAL LUMBER & TIMBER - UNTREATED.
4. THE ROOF SHEATHING SHALL BE FULL SAWN SPRUCE, NO.1 GRADE, OR HEMLOCK, NO.1 GRADE, AND PAID UNDER ITEM 522.30, NON-STRUCTURAL LUMBER - UNTREATED (SIDING & ROOF). MINIMUM LENGTH SHALL BE 16 FEET.
5. ALL NEW TIMBER CONNECTIONS IN THE ROOF SYSTEM, INCLUDING NOTCHES, MORTISE-AND-TENON JOINTS, AND OTHER CONNECTIONS, SHALL MATCH THE EXISTING JOINTING CONFIGURATION AND TYPE AND SHALL BE CUT TO PROVIDE A TIGHT JOINT. ANY DEVIATION FROM THE EXISTING JOINTING TECHNIQUES SHALL BE APPROVED BY THE RESIDENT ENGINEER.
6. KNEEBRACES SHALL BE RETAINED WHERE THESE ARE IN GOOD CONDITION WITH TIGHT JOINTS. DEFICIENT KNEEBRACES SHALL BE REPLACED AS ORDERED BY THE RESIDENT ENGINEER. FOR ESTIMATING PURPOSES, 8 NEW KNEEBRACES HAVE BEEN INCLUDED IN ITEM 522.20, STRUCTURAL LUMBER & TIMBER - UNTREATED.

NOTE

DETAILS AND DIMENSIONS SHOWN ON THIS SHEET ARE APPROXIMATE AND FOR INFORMATIONAL PURPOSES. THE CONTRACTOR SHALL BE RESPONSIBLE FOR MAKING FIELD MEASUREMENTS OF ALL EXISTING COMPONENTS TO ASSURE CONSISTENCY WITH PROPOSED MODIFICATIONS. FINAL TIMBER REMOVAL AND REPLACEMENT DETAILS SHALL BE PREPARED BY THE CONTRACTOR AND APPROVED BY THE RESIDENT ENGINEER PRIOR TO ADVANCING THE WORK.

**STATE OF VERMONT
AGENCY OF TRANSPORTATION**

Town Of	CAMBRIDGE	Bridge No.	30
Highway No.	TH 31	Log Sta.	
		Surv. Sta.	
CANYON ROAD OVER BREWSTER RIVER			
ROOF FRAMING PLAN AND DETAILS			
Designed By	B. COLEBURN	Drawn By	S. MERRIN
Checked By	Date	Bridge Design Supervisor	Date
R. JOY	05/03	M. ZYDEL	05/03
PROJECT	CAMBRIDGE	PROJECT NO.	BHO 1448(24)
I.G.C. Info. m:\15\19105\BRIDGE\BHO1448\24\2561.dwg			
Bridge Sheet No.		Sheet	16 of 26



12-104-2003
PLOTED