

NOTE:
SIDING, DECK AND ROOF NOT SHOWN FOR CLARITY.

INTERIOR NORTH TRUSS ELEVATION - REHABILITATED

(LOOKING NORTH)
SCALE: 1/4" = 1'-0"

Ⓝ DENOTES NEW FLOORBEAM

SIDING NAILERS REPLACED
ON BOTH TRUSSES

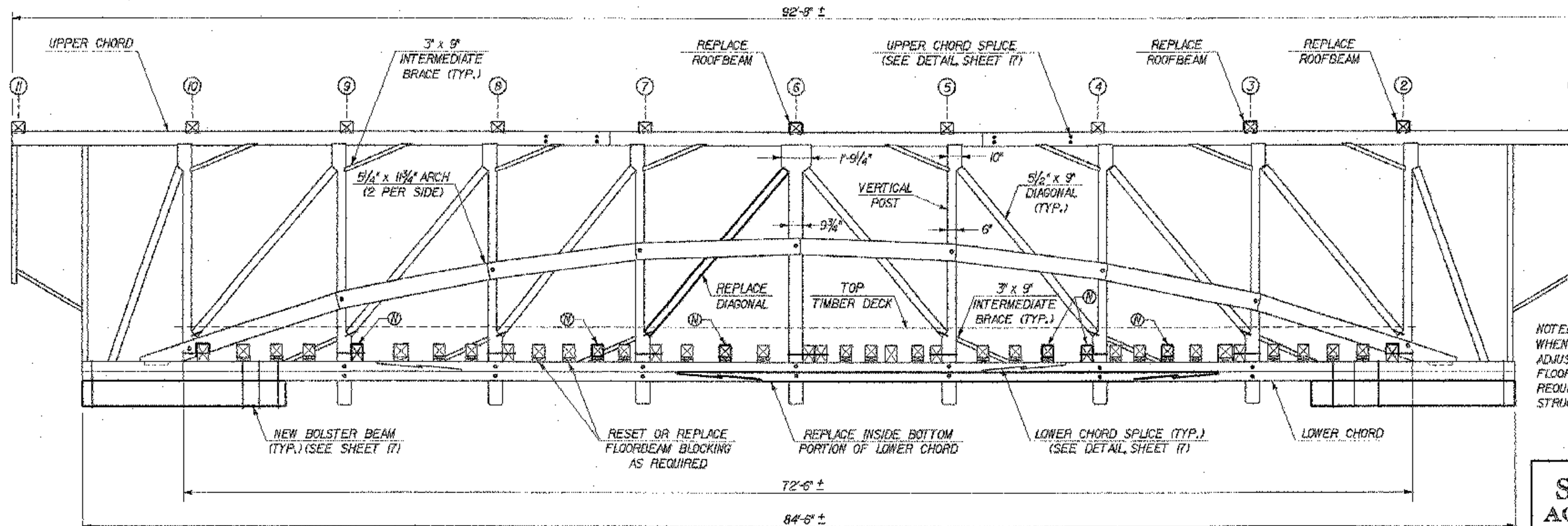

NOTE:
SIDING, DECK AND ROOF NOT SHOWN FOR CLARITY.

INTERIOR SOUTH TRUSS ELEVATION - REHABILITATED

(LOOKING SOUTH)
SCALE: 1/4" = 1'-0"

Ⓝ DENOTES NEW FLOORBEAM

NOTE:
WHEN REPLACING FLOORBEAMS OR RESETTING FLOORBEAMS TO ADJUST THEIR SPACING AS PER SHEET IS ALSO REPLACE THE FLOORBEAM BLOCKING. REPLACE OTHER FLOORBEAM BLOCKING AS REQUIRED. FLOORBEAM BLOCKING TO BE PAID AS ITEM 522.25, STRUCTURAL LUMBER & TIMBER - TREATED (FLOOR SYSTEM).

NOTE

DETAILS AND DIMENSIONS SHOWN ON THIS SHEET ARE APPROXIMATE AND FOR INFORMATIONAL PURPOSES. THE CONTRACTOR SHALL BE RESPONSIBLE FOR MAKING FIELD MEASUREMENTS OF ALL EXISTING COMPONENTS TO ASSURE CONSISTENCY WITH PROPOSED MODIFICATIONS. FINAL TIMBER REMOVAL AND REPLACEMENT DETAILS SHALL BE PREPARED BY THE CONTRACTOR AND APPROVED BY THE RESIDENT ENGINEER PRIOR TO ADVANCING THE WORK

**STATE OF VERMONT
AGENCY OF TRANSPORTATION**

Town Of	CAMBRIDGE	Bridge No.	30
Highway No.	TH 31	Log Sta.	
		Surv. Sta.	
CANYON ROAD OVER BREWSTER RIVER			
TRUSS ELEVATIONS			
Designed By	B. COLBURN	Drawn By	S. MERRIFAN
Checked By	R. JOY	Bridge Design Supervisor	M. ZYDEL
Date	05/03	Date	05/03
PROJECT	CAMBRIDGE	PROJECT NO.	BHO 1448(24)
I.G.C. Info. m:\549105\BRIDGE\6.com\2\2596hd.dgn			
Bridge Sheet No.		Sheet	13 of 26



PUBLISHED 12-MAY-2003