

NOTES:

1. LOCATION OF EXISTING BURIED WATER LINES OBTAINED FROM BRADFORD WATER DEPARTMENT. CONTRACTOR SHALL VERIFY ALL LOCATIONS PRIOR TO CONSTRUCTION OF NEW WATER LINE. ALL DISCREPANCIES SHALL BE REPORTED TO THE ENGINEER.
2. CONTRACTOR TO COORDINATE TEMPORARY SHUTDOWN OF WATER SYSTEM WITH TOWN OF BRADFORD WATER DEPARTMENT.

LEGEND

- EXISTING WATER MAIN
- NEW WATER MAIN
- ⊗ EXISTING GATE VALVE
- ⊗ NEW GATE VALVE

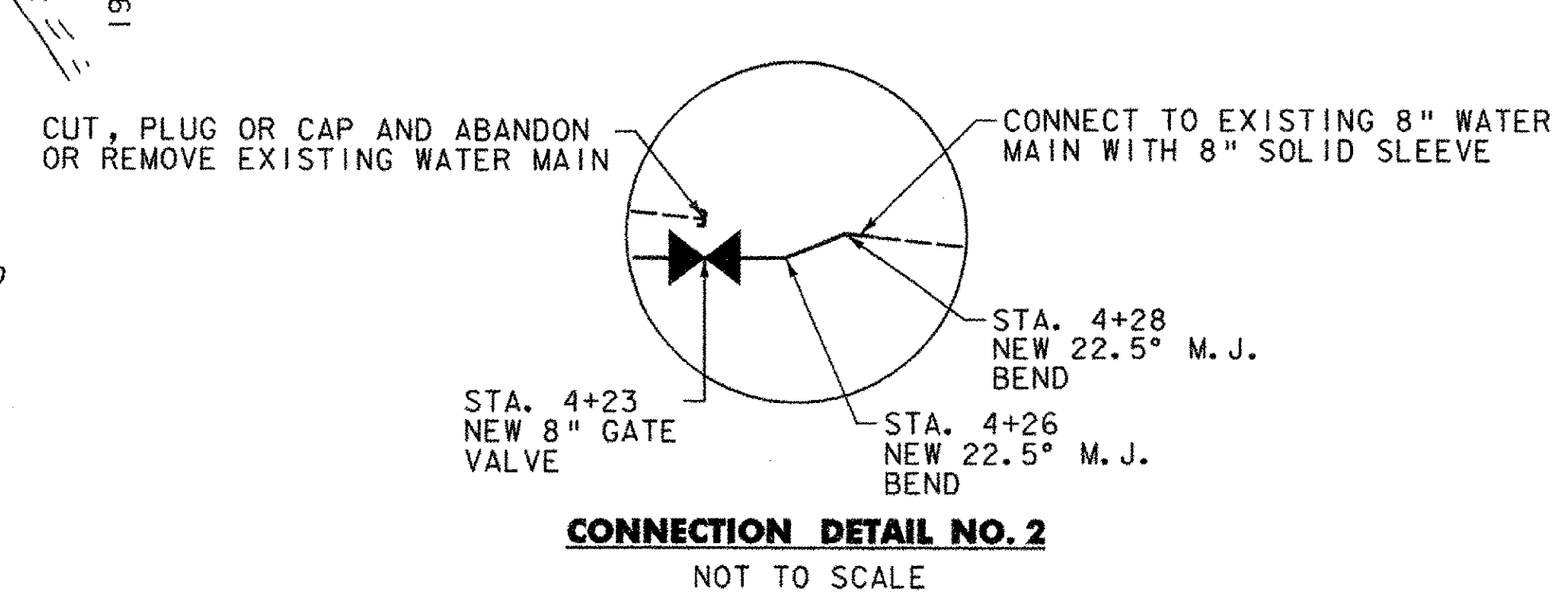
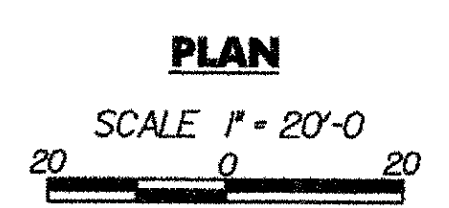
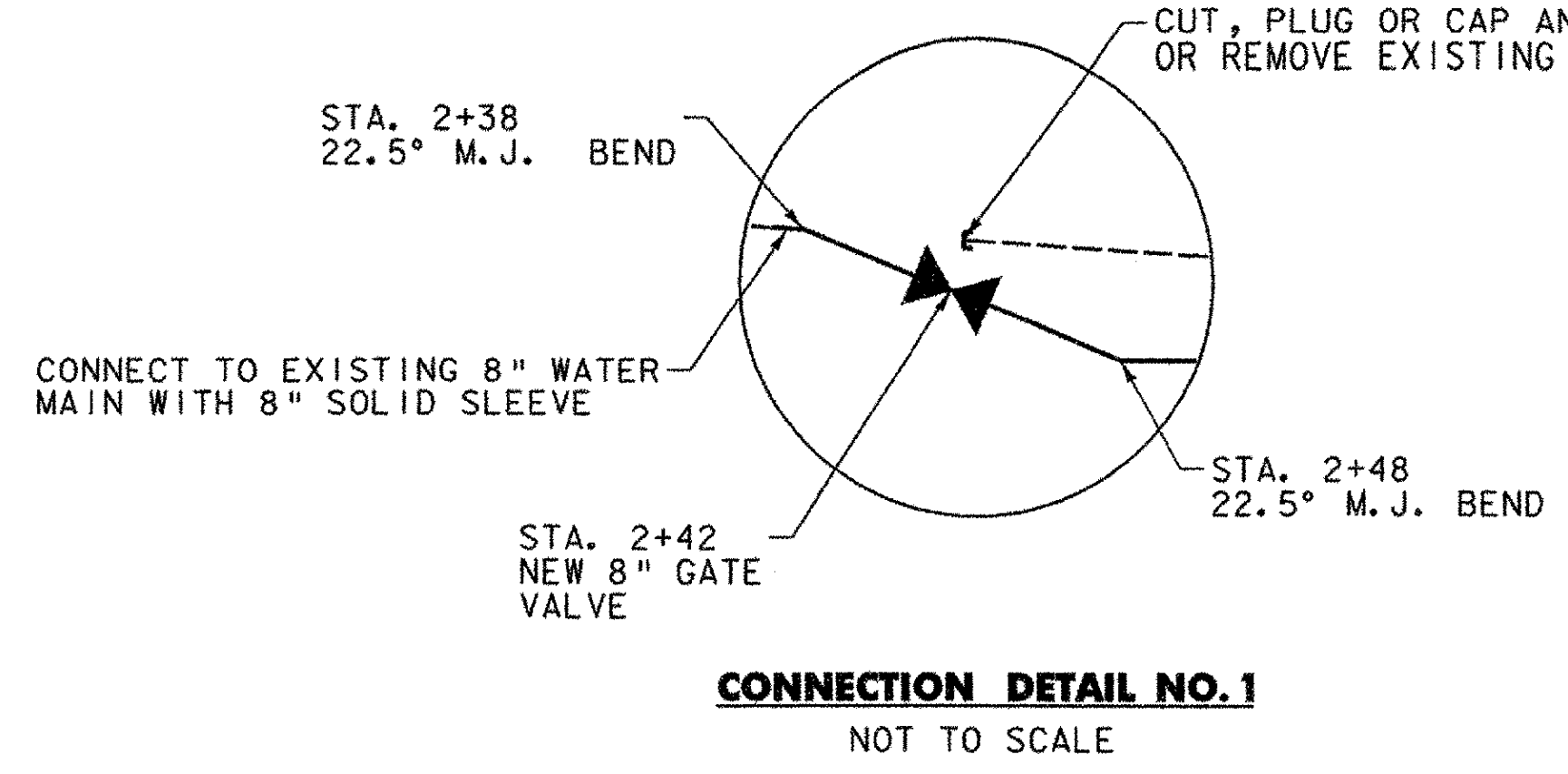
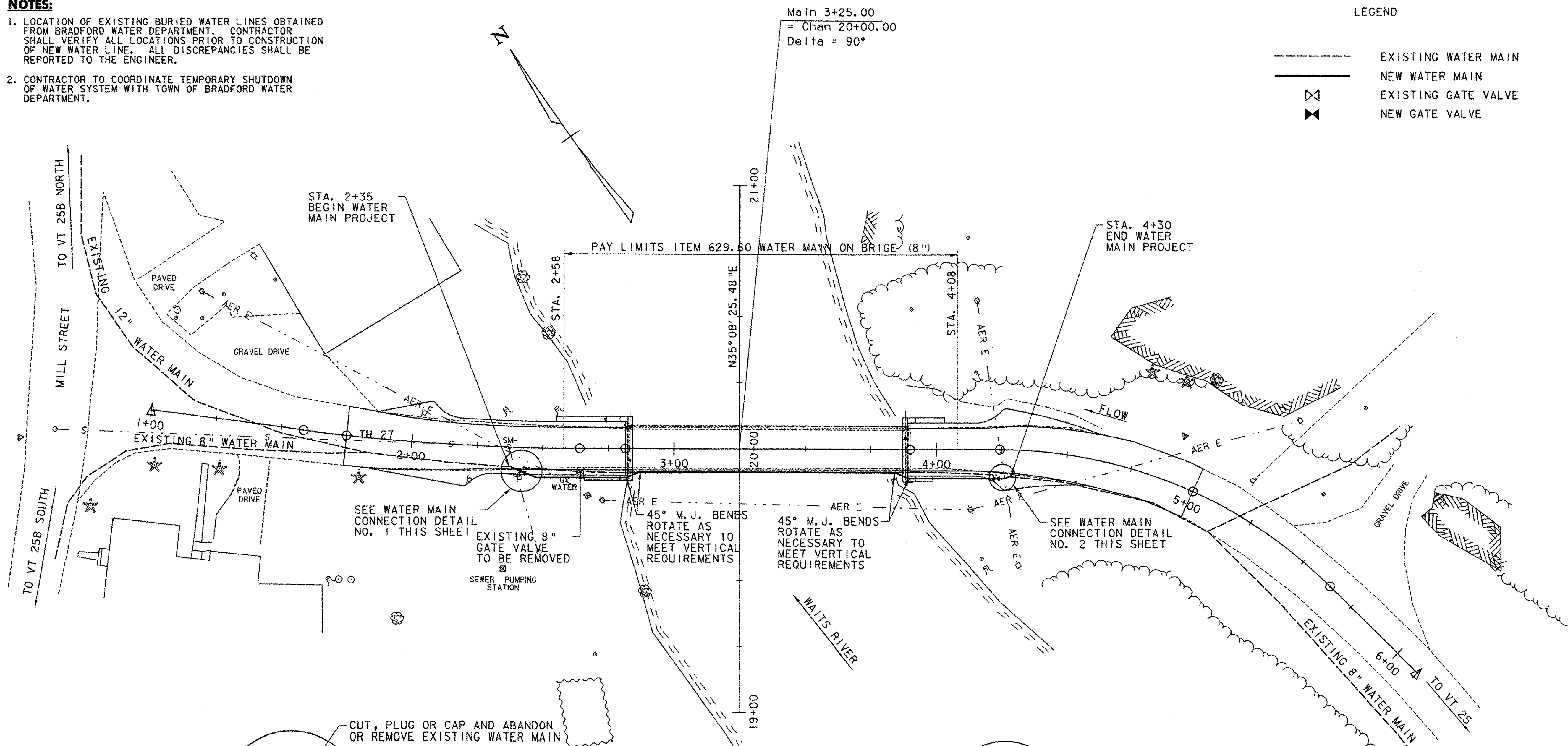

NOTE:
INFORMATION ON THIS SHEET FOR WATER MAIN AND DETAILS ONLY. REFER TO OTHER DRAWINGS FOR BRIDGE AND ROADWAY DETAILS.

STATE OF VERMONT
AGENCY OF TRANSPORTATION

Town Of	BRADFORD	Bridge No.	22
Highway No.	27	Log Sta.	
		Surv. Sta.	
CREAMERY ROAD OVER WAITS RIVER			

NO.	DATE	REVISIONS	BY	CK'D

DuBois & King Inc.
engineering planning management development

TOWN OF BRADFORD, VERMONT
CREAMERY ROAD BRIDGE REPLACEMENT
WATER MAIN REPLACEMENT PLAN

DRAWN BY	APG	DATE	OCT. 2006
CHECKED BY	CKG	PROJ. NO.	219248L
PROJ. ENG.	APG	DRAW. NO.	---
SHEET 30 OF 63			

PLOTTED 11/01/2006