

SEE SHEET 2 FOR INDEX OF SHEETS
AND LIST OF STANDARDS

STATE OF VERMONT AGENCY OF TRANSPORTATION

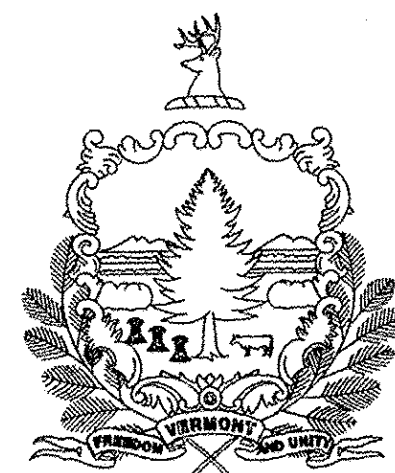

PROPOSED IMPROVEMENT BRIDGE PROJECT

TOWN OF BRADFORD
COUNTY OF ORANGE

ROUTE NO : TH 27 (CLASS 3) BRIDGE NO : 22

PROJECT LOCATION : BEGINNING AT A POINT APPROX. 0.03 MI FROM THE JUNCTION OF MILL STREET AND TH 27 AND EXTENDING SOUTHEASTERLY ALONG TH 27 FOR 190 FEET.

PROJECT DESCRIPTION : THE PROJECT SHALL CONSIST OF THE REHABILITATION OF THE EXISTING TRUSS WITH NEW ABUTMENTS INCLUDING THE RELATED APPROACH ROADWAY AND CHANNEL WORK

LENGTH OF STRUCTURE : 108.50 FEET.
LENGTH OF ROADWAY : 81.50 FEET.
LENGTH OF PROJECT : 190.00 FEET.

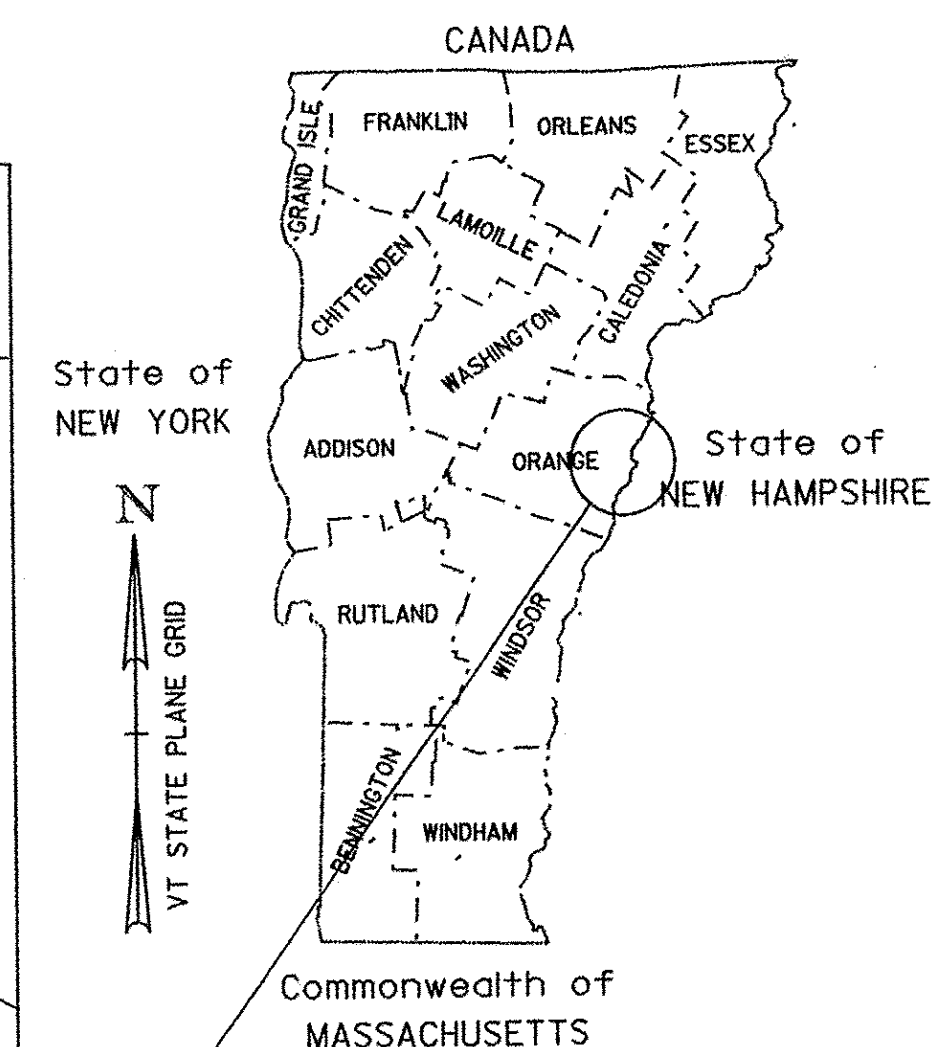
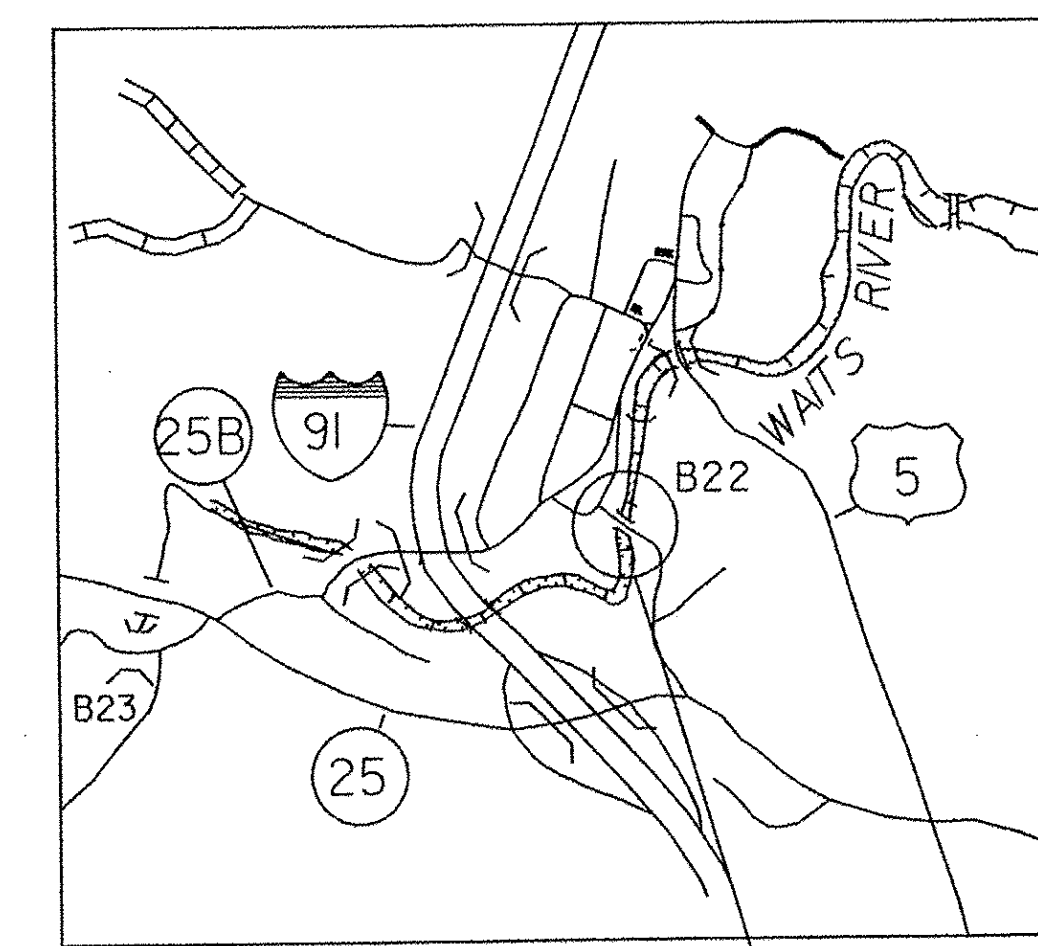

BRADFORD
STP 1447 (28)

RECORD PLANS	
CONTRACTOR:	AUSTIN CONSTRUCTION, INC.- CONCORD, VT
RESIDENT ENGINEER:	RON GRAY
CONSTRUCTION BEGAN:	APRIL 16, 2007
CONSTRUCTION COMPLETE:	NOVEMBER 4, 2011
RECORD PLANS BY:	RON GRAY & JENNA HYDE
I HEREBY CERTIFY THAT ALL THE CONSTRUCTION REQUIRED BY THIS SET OF DRAWINGS HAS BEEN ACCOMPLISHED AS INDICATED HEREIN.	
BY <i>Donald A. Gray</i>	RESIDENT ENGINEER
DATE <i>10/17/12</i>	
NOTE: Any further information concerning final quantities, amounts or other details relative to this project may be found at Central Files in the electronic archives.	

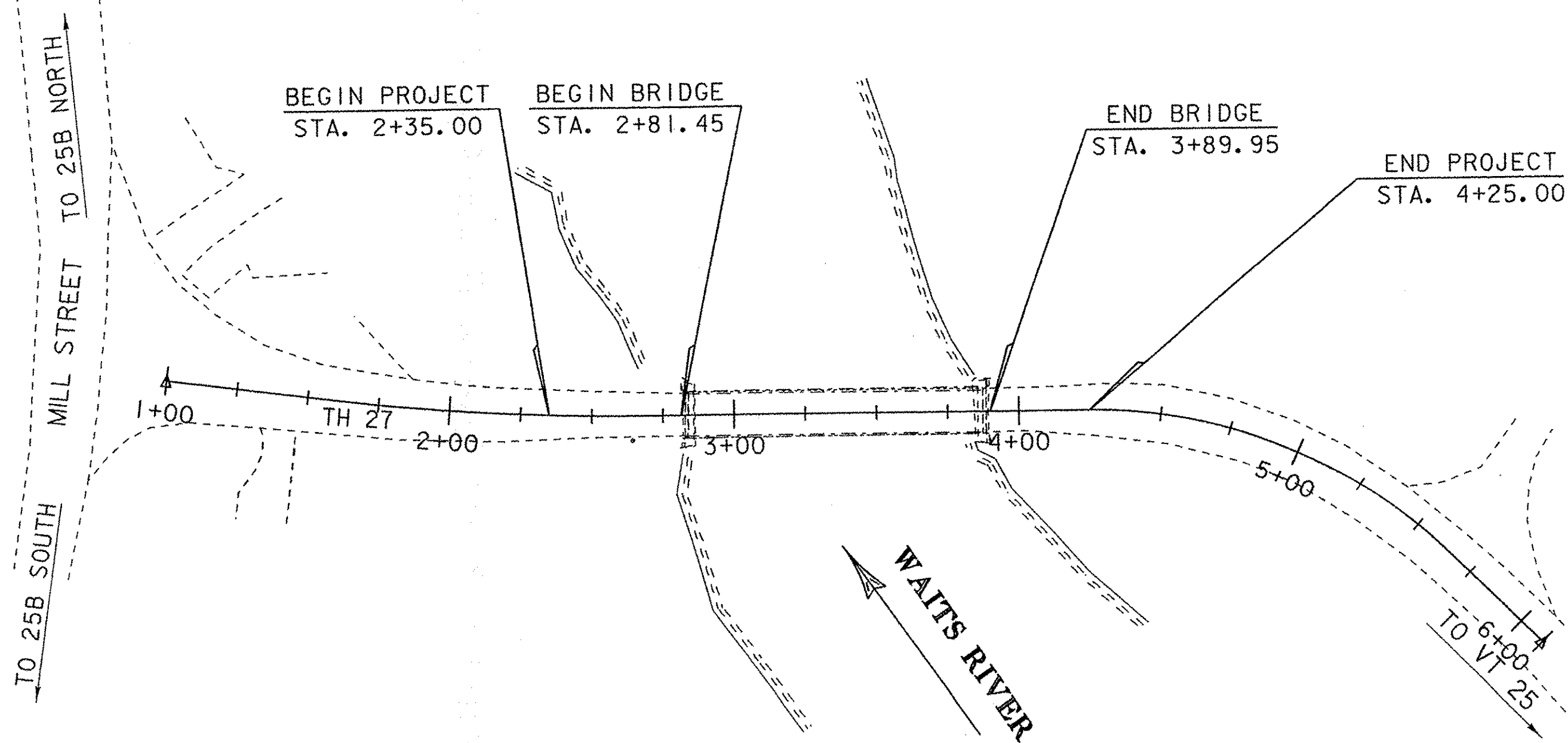
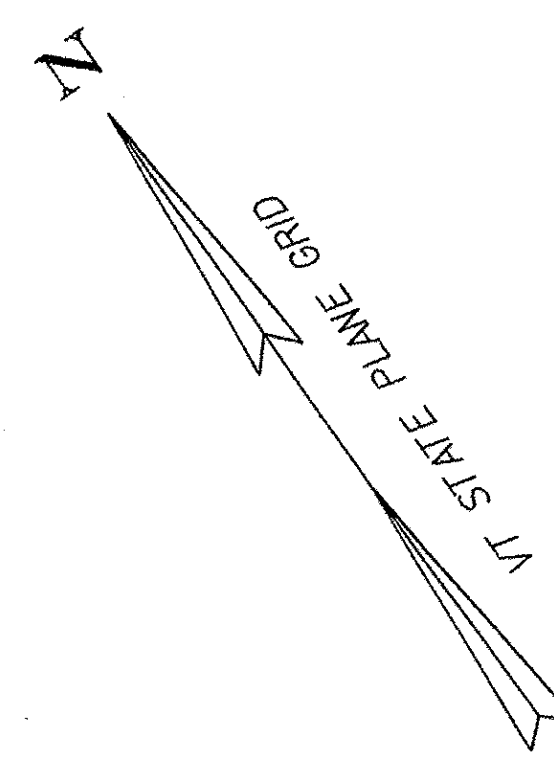

SCALE 1" = 40'-0"
40 0 40

CONVENTIONAL SYMBOLS	
COUNTY LINE	
TOWN LINE	
LIMITS OF ACCESS	
POINT OF ACCESS	
FENCE LINE	
STONE WALL	
TRAVELED WAY	
GUARD RAIL	
RAILROAD	
SURVEY LINE	
CULVERT	
POWER POLE	
TELEPHONE POLE	
TREES	
CONTROL OF ACCESS	
PROPERTY LINE	
R.O.W. TAKING LINE	
SLOPE RIGHTS	
TOP OF CUT	
TOE OF SLOPE	

SURVEYED BY : R. GILMAN
SURVEYED DATE : 11/00

DATUM
VERTICAL : NAVD 88
HORIZONTAL : NAD 83/96

THESE PLANS ARE SUBJECT TO SUCH ENGINEERING CHANGES AS MAY BE REQUIRED BY THE FEDERAL HIGHWAY ADMINISTRATION OR THE DIRECTOR OF PROGRAM DEVELOPMENT.

CONSTRUCTION IS TO BE CARRIED ON IN ACCORDANCE WITH THESE PLANS AND THE STANDARD SPECIFICATIONS FOR CONSTRUCTION DATED 2001, AS APPROVED BY THE FEDERAL HIGHWAY ADMINISTRATION ON JANUARY 4, 2001 FOR USE ON THIS PROJECT, INCLUDING ALL SUBSEQUENT REVISIONS AND SUCH REVISED SPECIFICATIONS AND SPECIAL PROVISIONS AS ARE INCORPORATED IN THESE PLANS.

DIRECTOR OF PROGRAM DEVELOPMENT	
APPROVED <i>R. Williams</i>	DATE <i>11/2/06</i>
PROJECT MANAGER : C. WILLIAMS	
PROJECT NAME : BRADFORD	
PROJECT NUMBER : STP 1447 (28)	
SHEET 1 OF 63 SHEETS	

PLOTTED 01-NOV-2006