

STA. R 5+005.00 - STA. 5+063.00, RT
 ABANDON EXISTING RAILROAD STREET
 REMOVE EXISTING BITUMINOUS CONCRETE PAVEMENT AND
 CONCRETE SIDEWALK. REPLACE WITH 100 mm TOPSOIL,
 SEED, MULCH, AND FERTILIZE PER SEEDING FORMULA ON
 THE GENERAL NOTES SHEET.

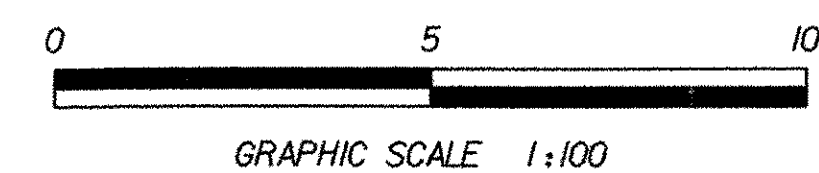
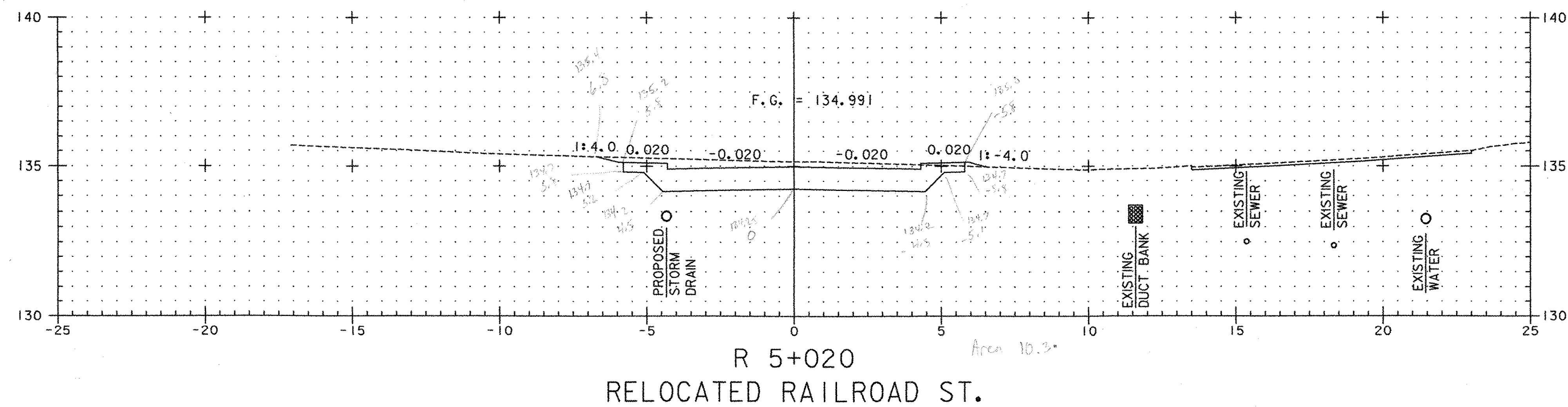

PROJECT NAME: WATERBURY
 PROJECT NUMBER: BRO 1446(26)

FILE NAME: ...149-59 sections.ptf PLOT DATE: 01/26/2004
 PROJECT LEADER: G EDWARDS/R GINGRAS DRAWN BY: M MEILLEUR
 DESIGNED BY: M MEILLEUR CHECKED BY: R GINGRAS
RAILROAD STREET CROSS SECTIONS SHEET 53 OF 63

...149-59 sections.ptf 01/26/2004 08:18:27 AM