

DECK PLAN
SCALE: 1/4" = 1'-0"

- NOTES**
- THE CONTRACTOR MAY INVESTIGATE AND PROPOSE AN ALTERNATIVE BRIDGE DECK CONSTRUCTION JOINT LOCATION, INCLUDING INCORPORATING A JOINT FORMED ALONG A CONCENTRIC CURVE WITH THE NEW FASCIA WHICH COULD POSSIBLY AVOID THE NEED TO FIELD CUT THE TRANSVERSE DECK STEEL. THE LOCATION OF THE BRIDGE DECK CONSTRUCTION JOINT SHALL ENSURE THAT MINIMUM 10-FOOT TEMPORARY TRAVEL LANES ARE MAINTAINED. THE CONTRACTOR SHALL SUBMIT HIS/HER PROPOSED SCHEME TO THE RESIDENT ENGINEER FOR REVIEW AND APPROVAL.

- LEGEND**
- N.F. = NEAR FACE
 - F.F. = FAR FACE
 - E.F. = EACH FACE
 - ▲ = CUT TO FIT IN FIELD

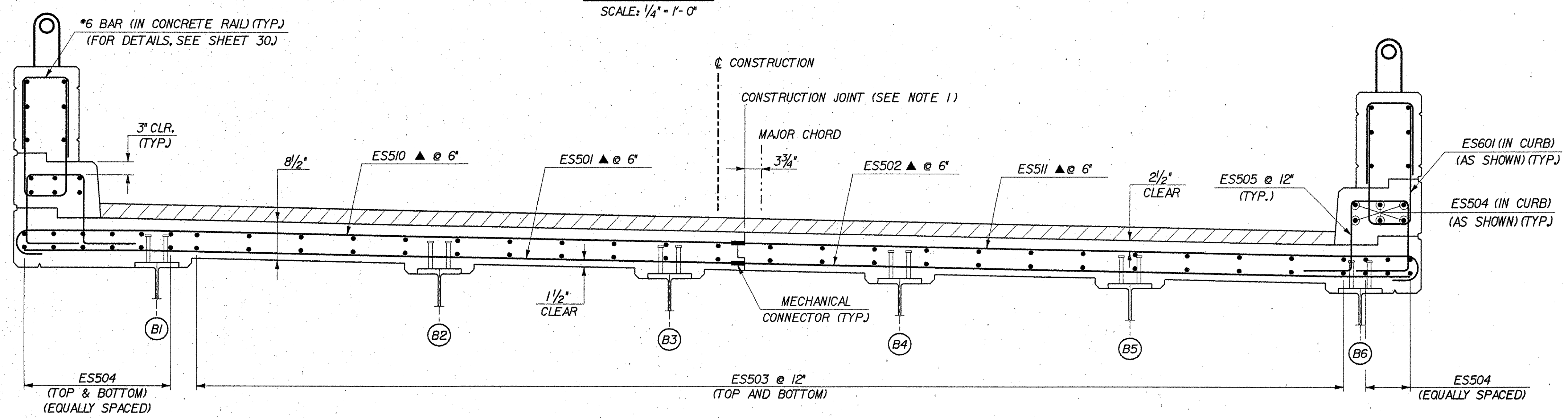

| | | | |
|--|----------|--------------------------|-------------|
| STATE OF VERMONT AGENCY OF TRANSPORTATION | | | |
| Town Of | WARREN | Bridge No. | 7 |
| Highway No. | TH 1 | Log Sta. | |
| | | Surv. Sta. | |
| BROOK ROAD OVER FREEMAN BROOK | | | |
| REINFORCING PLAN & DETAILS | | | |
| Designed By | S. DELIA | Drawn By | S. DELIA |
| Checked By | R. JOY | Date | 02/07 |
| | | Bridge Design Supervisor | R. ROONEY |
| | | Date | 02/07 |
| PROJECT | WARREN | PROJECT NO. | BHF 0188(7) |
| I.G.C. Info. m:\549107-Warren\BRIDGE\Drawz\J276dtd.dgn | | | |
| Bridge Sheet No. | | Sheet | 18 of 36 |

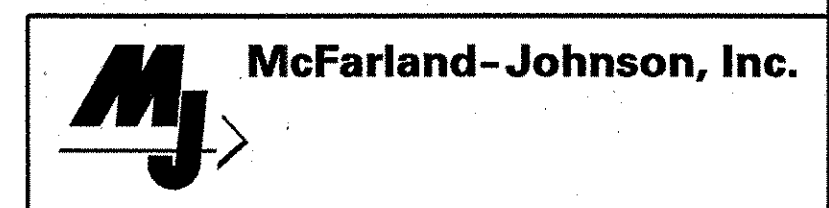

PLOTTED: 02-MAR-2007