

GPS CONTROL POINTS

**LINCOLN AZ MK**  
STATION MARK IS A SURVEY DISK SET INTO THE TOP OF A METAL PIPE EMBEDDED IN THE GROUND. THE MARK IS STAMPED LINCOLN AZ MK 1997.

APPROX. LATITUDE: 440602 N  
APPROX. LONGITUDE: 0725947 W  
APPROX. ELEVATION: 325 M

LOCATION: LINCOLN, VT

FROM THE INTERSECTION OF NORTH AND SOUTH STREETS AT THE TRAFFIC LIGHT IN BRISTOL VILLAGE, GO EAST ALONG VT ROUTES 17 AND 116 FOR 1.6 MI (2.6 KM). TURN LEFT AND GO SOUTHEAST ALONG WEST RIVER ROAD FOR 3.4 MI (5.5 KM) TO THE INTERSECTION OF QUAKER STREET LEFT, EAST RIVER ROAD STRAIGHT, AND GOVE HILL ROAD RIGHT IN LINCOLN VILLAGE. TURN RIGHT AND GO SOUTH ALONG GOVE HILL ROAD FOR 0.4 MI (0.6 KM) TO THE SITE OF THE MARK ON THE RIGHT ON THE EAST EDGE OF A FIELD, JUST SOUTH OF A 1/2 STORY HOUSE WITH GAMBREL ROOF ON THE LEFT. THE MARK IS A STATE OF VERMONT SURVEY MARK SET 3 CM BELOW GROUND SURFACE IN THE TOP OF A CAST ALUMINUM MONUMENT. IT IS 7.1 M (23.3 FT) WEST OF AND ABOUT 0.5 M (1.6 FT) HIGHER THAN THE CENTERLINE OF GOVE HILL ROAD, 37.5 M (123.0 FT) WEST SOUTHWEST OF THE SOUTHWEST CORNER OF THE GAMBREL ROOFED HOUSE, 44.8 M (147.0 FT) NORTH OF POLE NO. 5X, AND 11.8 M (38.7 FT) SOUTH OF POLE NO. 7/104/7 AND A FIBERGLASS WITNESS POST.

**LINCOLN**  
STATION MARK IS A SURVEY DISK SET INTO THE TOP OF A METAL PIPE EMBEDDED IN THE GROUND. THE MARK IS STAMPED LINCOLN 1997.

APPROX. LATITUDE: 440636 N  
APPROX. LONGITUDE: 0725952 W  
APPROX. ELEVATION: 310 M

LOCATION: LINCOLN, VT

FROM THE INTERSECTION OF NORTH AND SOUTH STREETS AT THE TRAFFIC LIGHT IN BRISTOL VILLAGE, GO EAST ALONG VT ROUTES 17 AND 116 FOR 1.6 MI (2.6 KM). TURN LEFT AND GO SOUTHEAST ALONG WEST RIVER ROAD FOR 3.4 MI (5.5 KM) TO THE INTERSECTION OF QUAKER STREET LEFT, EAST RIVER ROAD STRAIGHT, AND GOVE HILL ROAD RIGHT IN LINCOLN VILLAGE. TURN LEFT AND GO NORTH ALONG QUAKER STREET FOR 0.2 MI (0.3 KM) TO THE LEE CEMETERY AND THE SITE OF THE MARK ON THE LEFT IN A GRASS STRIP BETWEEN THE CEMETERY AND THE ROAD. THE MARK IS A STATE OF VERMONT SURVEY MARK SET 3 CM BELOW GROUND SURFACE IN THE TOP OF A CAST ALUMINUM MONUMENT. IT IS 6.5 M (21.3 FT) WEST OF AND ABOUT 1 M (3.3 FT) HIGHER THAN THE CENTERLINE OF QUAKER STREET, 6.4 M (21.0 FT) SOUTH OF THE CENTER OF A GATE LEADING INTO THE CEMETERY, 0.5 M (1.6 FT) EAST OF THE CEMETERY FENCE, AND 21.9 M (71.9 FT) NORTH OF POLE NO. 7/90/81 AND A FIBERGLASS WITNESS POST.

**971**  
STATION MARK IS A BENCH MARK DISK SET INTO AN ABUTMENT. THE MARK IS STAMPED 971 MONTPELIER.

APPROX. LATITUDE: 440620 N  
APPROX. LONGITUDE: 0725948 W  
APPROX. ELEVATION: 296 M

LOCATION: LINCOLN, VT

FROM THE INTERSECTION OF NORTH AND SOUTH STREETS AT THE TRAFFIC LIGHT IN BRISTOL VILLAGE, GO EAST ALONG VT ROUTES 17 AND 116 FOR 1.6 MI (2.6 KM). TURN LEFT AND GO SOUTHEAST ALONG WEST RIVER ROAD FOR 3.4 MI (5.5 KM) TO THE INTERSECTION OF QUAKER STREET LEFT, EAST RIVER ROAD STRAIGHT, AND GOVE HILL ROAD RIGHT IN LINCOLN VILLAGE. TURN RIGHT AND GO SOUTH ALONG GOVE HILL ROAD FOR ABOUT 15 M (49.2 FT) TO THE NORTH END OF THE GOVE HILL ROAD BRIDGE OVER THE NEW HAVEN RIVER AND THE MARK ON THE LEFT IN THE TOP OF THE ABUTMENT AT THE NORTHEAST CORNER OF THE BRIDGE. THE MARK IS SET IN THE TOP OF THE ABUTMENT DIRECTLY UNDER A L-SHAPED CUTOUT IN THE SOUTH END OF THE NORTHEAST CONCRETE WINGWALL. THE CUTOUT IN THE WINGWALL WAS CONSTRUCTED SPECIFICALLY TO PRESERVE THE MARK. IT IS 3.1 M (10.2 FT) EAST OF AND ABOUT 1.2 M (3.9 FT) LOWER THAN THE CENTERLINE OF GOVE HILL ROAD, 16.0 M (52.5 FT) SOUTH OF THE CENTERLINE OF EAST RIVER ROAD, 3.6 M (11.8 FT) SOUTH OF A GOVE HILL ROAD AND STOP SIGN, 0.3 M (1.0 FT) NORTH OF THE SOUTH FACE OF THE ABUTMENT, AND 0.3 M (1.0 FT) WEST OF THE EAST EDGE OF THE ABUTMENT.

TRAVERSE TIES

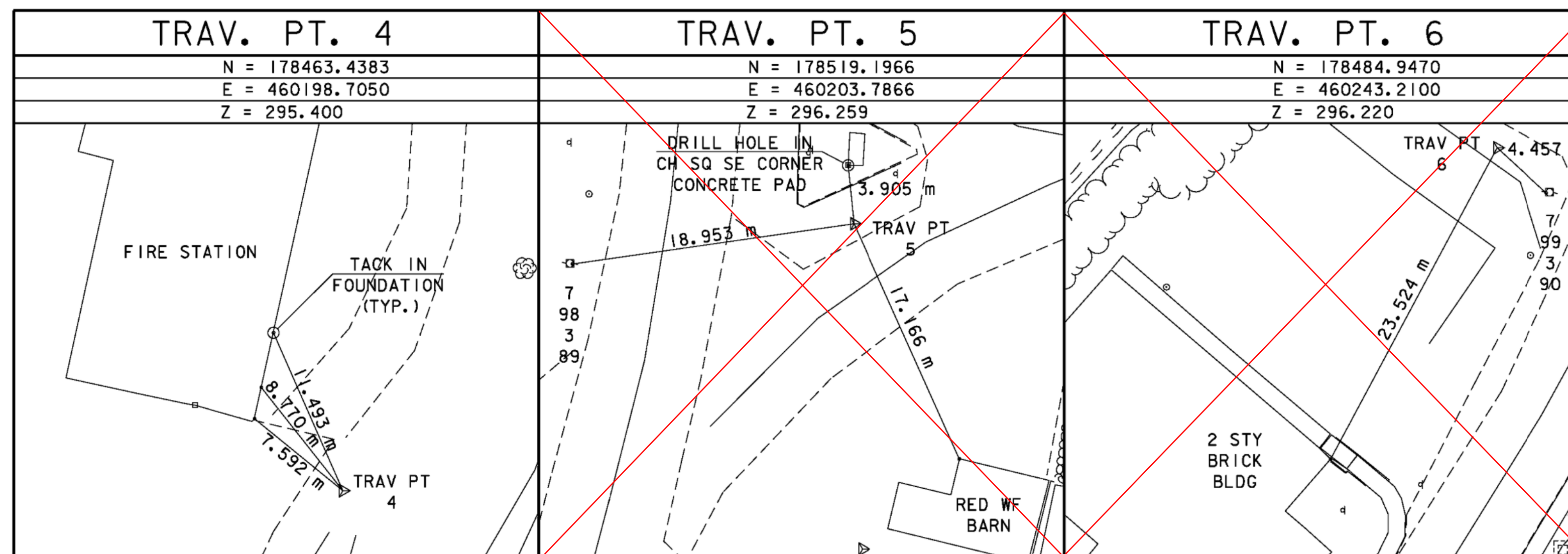

ALIGNMENT TIES

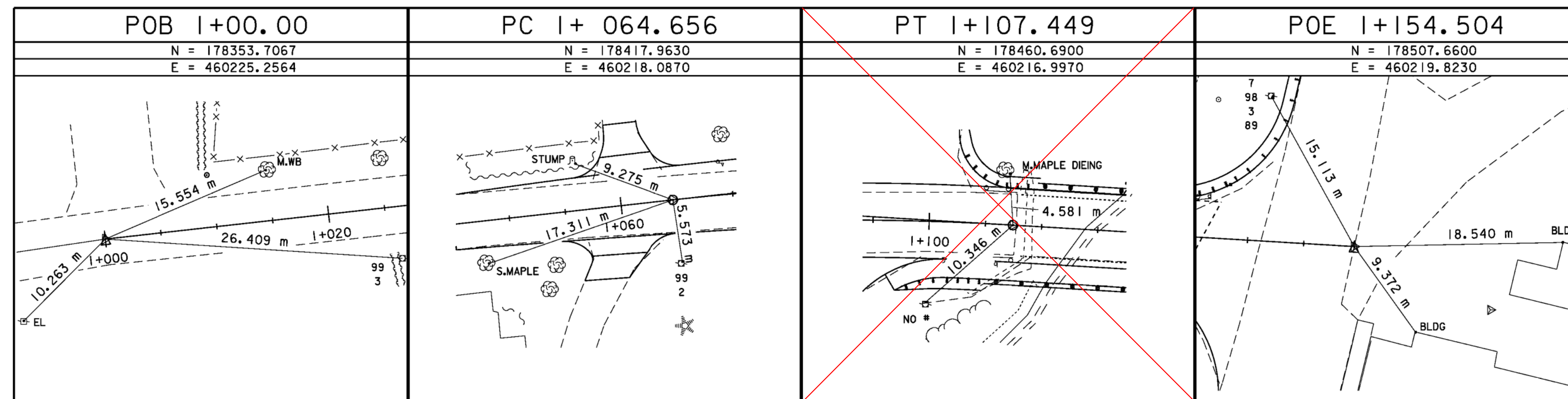

SURVEY TIES

DATUM	
VERTICAL	NAVD 88
HORIZONTAL	NAD 83 (92)

PROJECT NAME: LINCOLN	
PROJECT NUMBER: BRO 1445 (25)	
FILE NAME: s96j266+1e.dgn	PLOT DATE: 29-JAN-2009
PROJECT LEADER: R. WHITCOMB	DRAWN BY: S. SCRIBNER
DESIGNED BY: S. SCRIBNER	CHECKED BY: R. WHITCOMB
SURVEY TIES	SHEET 9 OF 58