

NOTE:
TRUSS TIE RODS NOT SHOWN FOR CLARITY. TO BE REPLACED. EXISTING TIMBER DIMENSIONS PROVIDED FOR GENERAL REFERENCE. ACTUAL DIMENSIONS MAY VARY.

EXISTING TYPICAL BRIDGE SECTION

SCALE: 3/8" = 1'-0"

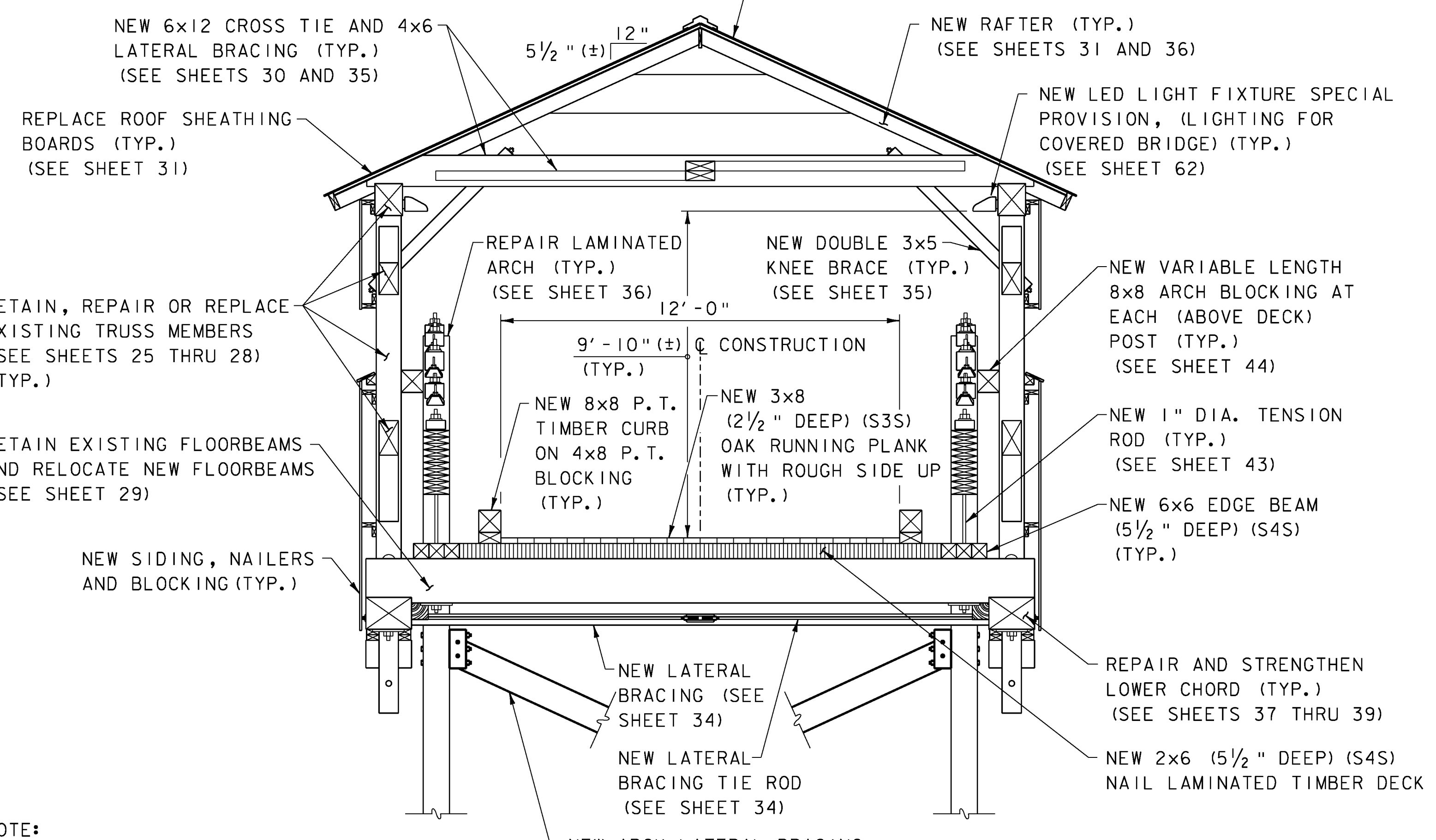

NOTE:
NEW TRUSS DOUBLE TENSION RODS NOT SHOWN FOR CLARITY.

PROPOSED TYPICAL BRIDGE SECTION

SCALE: 3/8" = 1'-0"

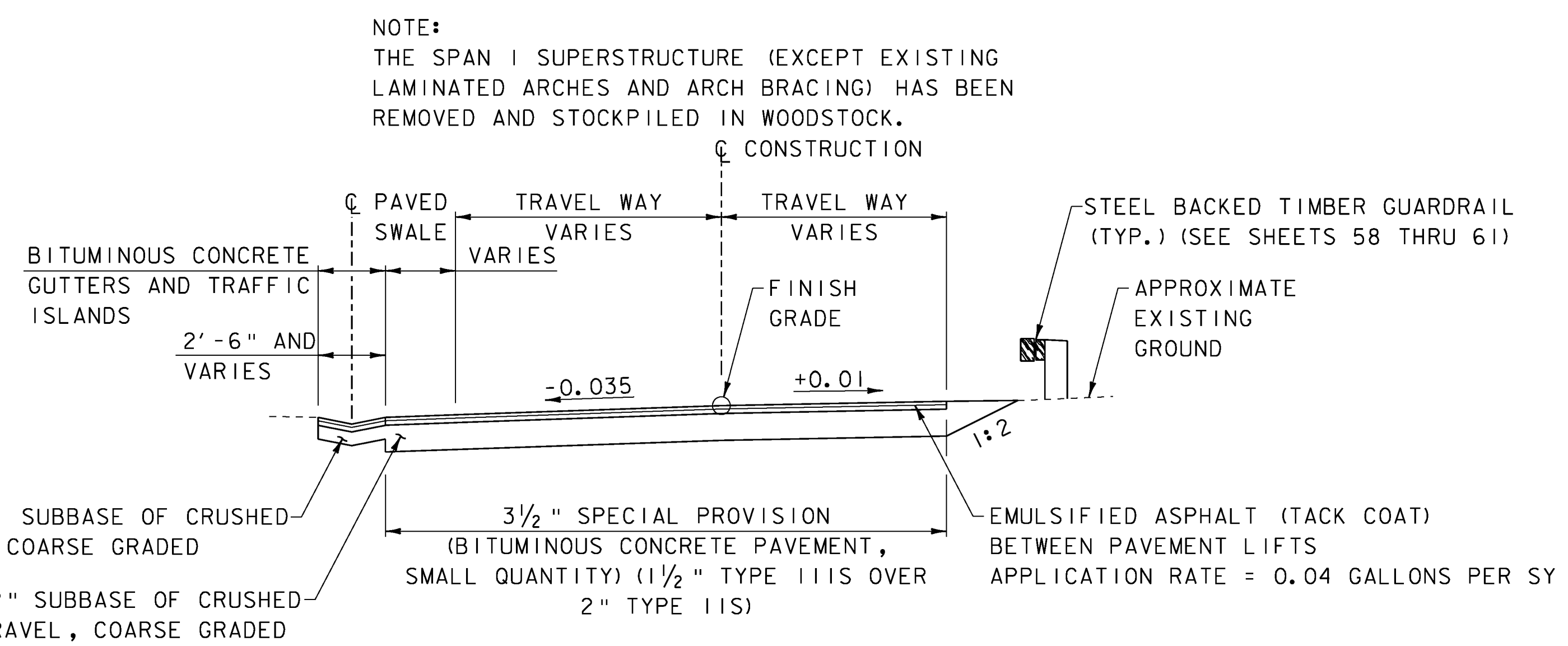

NOTE:
THE SPAN I SUPERSTRUCTURE (EXCEPT EXISTING LAMINATED ARCHES AND ARCH BRACING) HAS BEEN REMOVED AND STOCKPILED IN WOODSTOCK.

TYPICAL WEST APPROACH SECTION

SCALE: 1/4" = 1'-0"

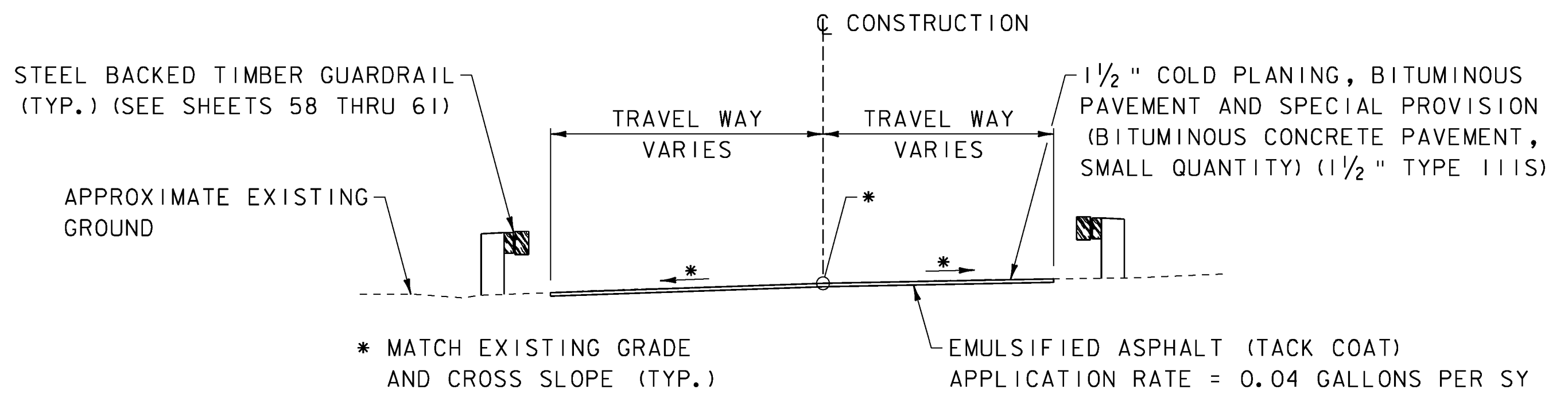

TYPICAL EAST APPROACH SECTION

SCALE: 1/4" = 1'-0"

LEGEND

- P. T. PRESSURE TREATED
- S4S SURFACED 4 SIDES
- F. S. FULL SAWN

MATERIAL TOLERANCES
(IF USED ON THIS PROJECT)

- SURFACE
 - PAVEMENT (TOTAL THICKNESS) ± 1/4"
 - AGGREGATE SURFACE COURSE ± 1/2"
- SUBBASE ± 1"

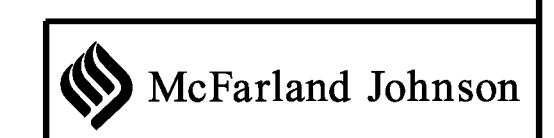
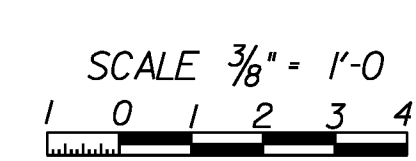
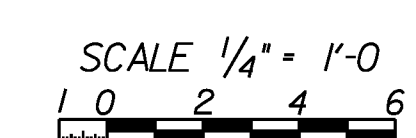

PROJECT NAME:	WOODSTOCK	WOODSTOCK
PROJECT NUMBER:	BHO 1444(52)	ST 1444(58)
FILE NAME:	z96j262+sl.dgn	
PROJECT LEADER:	M. Sargent	PLOT DATE: 10-JUL-2012
DESIGNED BY:	P. Dustin	DRAWN BY: P. Dustin
TYPICAL SECTIONS (10F 2)		CHECKED BY: R. Joy
		SHEET 3 OF 68