

# STATE OF VERMONT AGENCY OF TRANSPORTATION

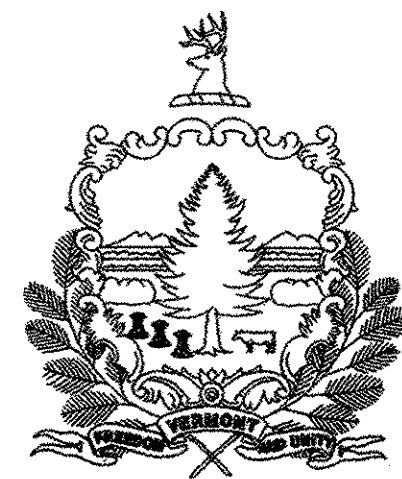

## PROPOSED IMPROVEMENT BRIDGE PROJECT TOWN OF NORWICH COUNTY OF WINDSOR BRIDGE NO. 46 ON STATE NUMBERED TOWN HIGHWAY 132 (TOWN HIGHWAY NO. 3)

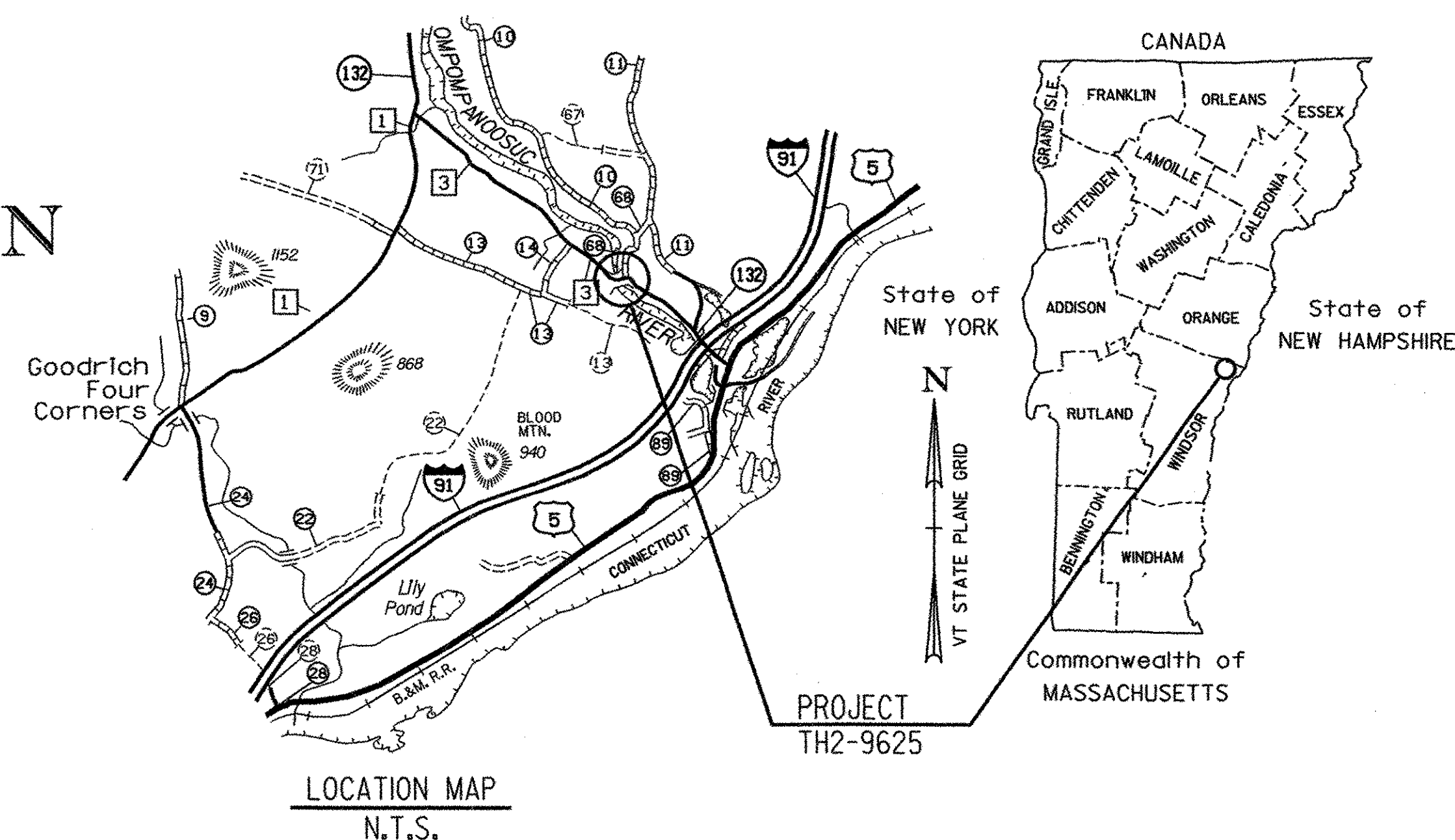

INDEX OF SHEETS	
1.	TITLE SHEET
2.	PRELIMINARY INFORMATION SHEET
3.	TYPICAL ROADWAY SECTIONS
4.-5.	QUANTITY SHEETS
6.	TIE SHEET
7.	LAYOUT SHEET
8.	PROFILE SHEET
9.	TRAFFIC CONTROL PLAN
10.	TRAFFIC CONTROL DETAILS
11.-14.	BORING INFORMATION SHEETS
15.	PLAN AND ELEVATION
16.	EROSION CONTROL SHEET
17.	PROJECT NOTES
18.	TYPICAL BRIDGE SECTION
19.	DECK REINFORCING PLAN
20.	FRAMING PLAN
21.	MISCELLANEOUS STEEL DETAILS
22.	ABUTMENT BEARING DETAILS
23.	PIER BEARING DETAILS
24.	SCUPPER DETAILS
25.	APPROACH SLAB DETAILS
26.	ABUTMENT #1 DETAILS
27.	ABUTMENT #2 DETAILS
28.	PIER DETAILS
29.	CONCRETE CURB DETAILS
30.	TRAFFIC SIGN SUMMARY SHEET
31.	REINFORCING SCHEDULE
32.-37.	ROADWAY CROSS SECTIONS
38.-40.	CHANNEL CROSS SECTIONS

PROJECT LOCATION: BEGINNING AT APPROXIMATELY 0.71 MILES WEST OF THE INTERSECTION OF STATE NUMBERED TOWN HIGHWAY 132 (T.H. 3) AND U.S. ROUTE 5 AND EXTENDING EAST 0.064 MILES.

PROJECT DESCRIPTION: THIS PROJECT INVOLVES THE REMOVAL OF THE EXISTING BRIDGE SUPERSTRUCTURE, REHABILITATION OF EXISTING BRIDGE ABUTMENTS AND PIER, CONSTRUCTION OF THE NEW BRIDGE SUPERSTRUCTURE, STONE ARMORING AND MINOR APPROACH RECONSTRUCTION.  
 LENGTH OF STRUCTURE: 99.90 FEET (0.019 MILES)  
 LENGTH OF ROADWAY: 240.10 FEET (0.045 MILES)  
 LENGTH OF PROJECT: 340.00 FEET (0.064 MILES)

RECORD PLANS	
CONTRACTOR:	WINTERSET, INC. - LYNDONVILLE, VT.
RESIDENT ENGINEER:	TOM CHASE
CONSTRUCTION BEGAN:	APRIL 26, 2005
CONSTRUCTION COMPLETE:	OCTOBER 21, 2005
RECORD PLANS BY:	TOM CHASE & C. PIERCE
I HEREBY CERTIFY THAT ALL THE CONSTRUCTION REQUIRED BY THIS SET OF DRAWINGS HAS BEEN ACCOMPLISHED AS INDICATED HEREIN.	
BY:	<i>Thomas A. Chase</i> RESIDENT ENGINEER
DATE:	03/12/07
NOTE: Any further information concerning final quantities, amounts or other details relative to this project may be found at Central Files in the electronic archives.	

### VAOT STANDARDS

B-71	11-16-00
C-1	01-03-00
E-100	01-06-97
E-101	03-10-97
E-102	08-08-95
E-102A	08-08-95
E-107	08-08-95
E-107A	08-08-95
E-121	08-08-95
E-136C	08-08-95
E-138	08-08-95
E-143	09-20-95
E-152	08-08-95
E-155	08-08-95
E-160	05-20-99
G-1	01-03-00
G-1d	01-03-00
T-1	06-01-94
T-2	06-01-94
SB-R4A-82	09-19-89
SB-R6-82	01-06-95

### CONVENTIONAL SYMBOLS

COUNTY LINE	
TOWN LINE	
LIMITS OF ACCESS	
POINT OF ACCESS	
FENCE LINE	
STONE WALL	
TRAVELED WAY	
GUARD RAIL	
RAILROAD	
SURVEY LINE	
CULVERT	
POWER POLE	
TELEPHONE POLE	
TREES	
CONTROL OF ACCESS	
PROPERTY LINE	
R.O.W. TAKING LINE	
SLOPE RIGHTS	
TOP OF CUT	
TOE OF SLOPE	

SURVEYED BY : VTRANS  
 SURVEYED DATE : DECEMBER 01, 2000

DATUM  
 VERTICAL NGVD 1988  
 HORIZONTAL NAD 1983

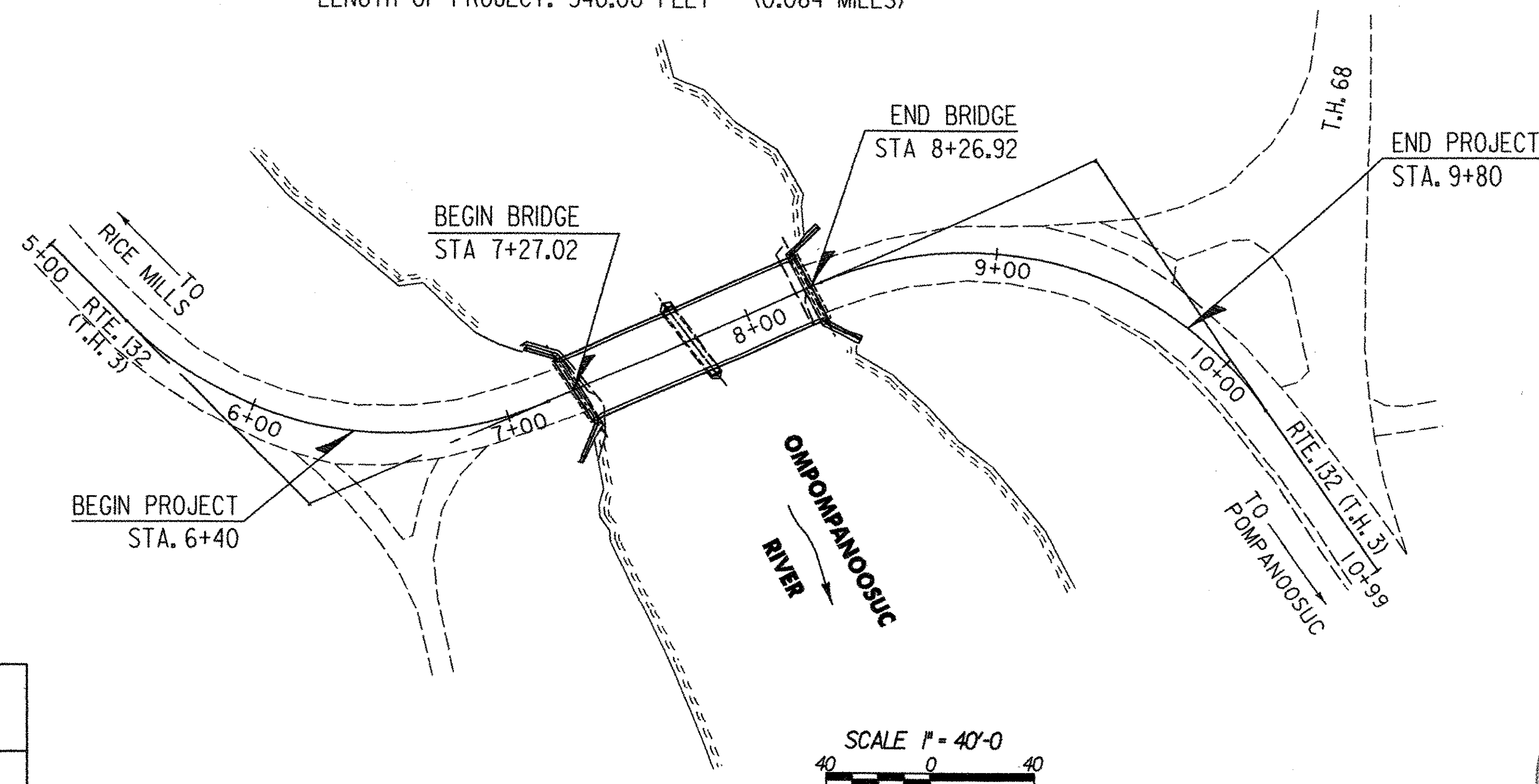
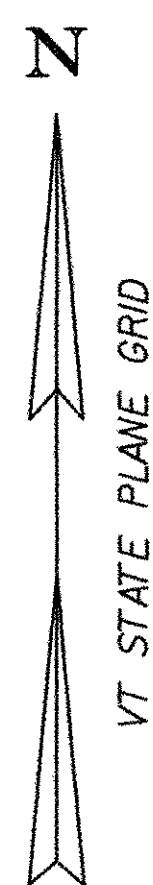

SCALE 1" = 40'-0"

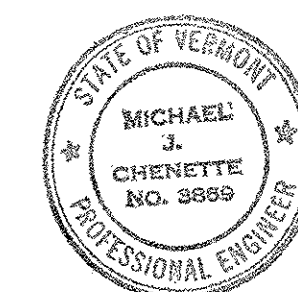

PLANS PREPARED BY:  
  
 BY: *Michael J. Chenette*

DIRECTOR OF PROGRAM DEVELOPMENT  
 APPROVED *[Signature]* DATE 4/7/04  
 PROJECT MANAGER : MICHAEL J. CHENETTE  
 PROJECT NAME : NORWICH  
 PROJECT NUMBER : TH2-9625  
 SHEET 1 OF 40 SHEETS

THESE PLANS ARE SUBJECT TO SUCH ENGINEERING CHANGES AS MAY BE REQUIRED BY THE FEDERAL HIGHWAY ADMINISTRATION OR THE DIRECTOR OF PROJECT DEVELOPMENT.  
 CONSTRUCTION IS TO BE CARRIED ON IN ACCORDANCE WITH THESE PLANS AND THE STANDARD SPECIFICATIONS FOR CONSTRUCTION DATED 2001, AS APPROVED BY THE FEDERAL HIGHWAY ADMINISTRATION ON JANUARY 4, 2001 FOR USE ON THIS PROJECT, INCLUDING ALL SUBSEQUENT REVISIONS AND SUCH REVISED SPECIFICATIONS AND SPECIAL PROVISIONS AS ARE INCORPORATED IN THESE PLANS.