

25B - BELGRADE SILT LOAM
WITH 3% TO 8% SLOPES
"K FACTOR" = 0.49

21 - RIPPOWAM FINE SANDY LOAM
WITH 0% TO 3% SLOPES
"K FACTOR" = 0.20

109 - TEEL SILT LOAM, SANDY SUBSTRATUM
WITH 0% TO 3% SLOPES
"K FACTOR" = 0.37

BEGIN
NON-PARTICIPATING
PAVING
STA 0+06.29

END NON-PARTICIPATING PAVING
BEGIN APPROACH
STA 1+50.00

BEGIN PROJECT
STA 2+50.00

BEGIN BRIDGE
STA 3+40.50

END BRIDGE
STA 4+33.50

END PROJECT
STA 4+75.00

END APPROACH
RESUME NON-PARTICIPATING
PAVING
STA 5+75.00

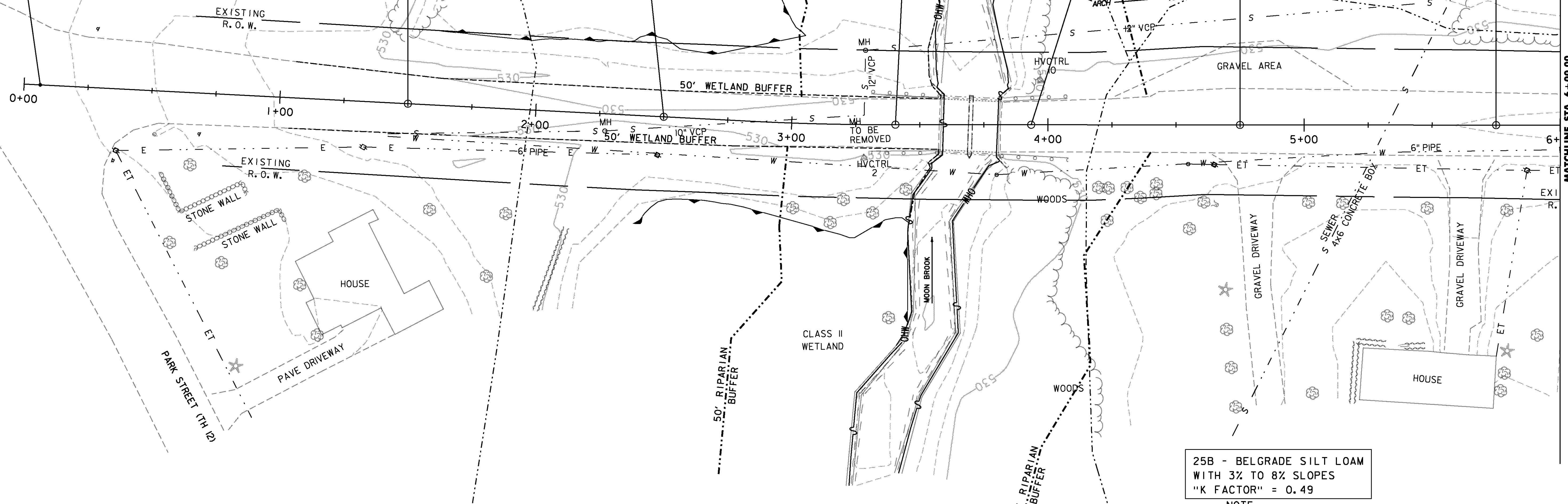

25B - BELGRADE SILT LOAM
WITH 3% TO 8% SLOPES
"K FACTOR" = 0.49

NOTE:
REFER TO CROSS SECTIONS FOR FINAL GROUND CONTOURS.
SEE SYMBOLY LEGEND SHEET AND EPSC DETAILS
SHEETS 1 & 2 FOR LEGEND INFORMATION.

EXISTING BRIDGE DATA
CONCRETE SLAB DECK
LENGTH = 20'-0"
WIDTH = 23'-0" CURB TO CURB
BUILT IN 1900

SCALE 1" = 20'-0"
20 0 20

PROJECT NAME:	RUTLAND CITY	PLOT DATE:	05-MAR-2014	
PROJECT NUMBER:	BRF 3000(18)	DRAWN BY:	R. PELLETT	
FILE NAME:	s96j244epsc_dur.dgn	DESIGNED BY:	M. EVANS-MONGEON	
PROJECT LEADER:	C. CARLSON	EPSC EXISTING LAYOUT I	CHECKED BY:	M. E-M
			SHEET 37 OF 44	

MATCHLINE STA 6+00.00