

REMOVAL AND DISPOSAL OF GUARDRAIL
 TH 14 STA 10+92.43 7.84' RT - 11+65.42 10.34' RT
 TH 14 STA 11+03.11 8.75' LT - 11+72.81 9.97' LT

HD STEEL BEAM GUARDRAIL, GALVANIZED W/8 FT POSTS
 TH 14 STA 10+50.33 - 10+90.07 RT
 TH 14 STA 10+75.93 - 10+98.48 LT
 TH 14 STA 11+82.94 - 13+09.53 RT

GUARDRAIL APPROACH SECTION, GALV HD STEEL BEAM W/8 FT POSTS
 TH 14 STA 10+90.08 - 11+16.52 RT
 TH 14 STA 10+98.48 - 11+22.15 LT
 TH 14 STA 11+56.35 - 11+82.94 RT
 TH 14 STA 11+57.57 - 11+81.22 LT

BRIDGE RAILING, GALVANIZED HDSB/FASCIA MOUNTED/STEEL TUBING
 TH 14 STA 11+16.52 - 11+56.35 RT
 TH 14 STA 11+22.15 - 11+57.57 LT

ANCHOR FOR STEEL BEAM GUARDRAIL
 TH 14 STA 10+59.12 RT
 TH 14 STA 10+83.79 LT
 TH 14 STA 11+83.25 LT
 TH 14 STA 12+99.67 RT

CONSTRUCT DRIVE (AGGREGATE SURFACE COURSE)
 TH 14 STA 12+77.11 LT

STONE LINED DITCH
 TH 14 STA 9+75.00 10.50' LT - 10+76.50 19.00' LT
 TH 14 STA 11+91.75 20.33' LT - 12+79.00 14.00' LT
 TH 14 STA 10+35.00 13.5' RT - 10+75.00 22.50' RT

STONE FILL, TYPE II
 TH 14 STA 10+76.50 - 11+25.00 LT
 TH 14 STA 11+69.00 - 11+91.75 LT

STONE FILL, TYPE IV
 TH 14 STA 10+88.67 - 11+72.26

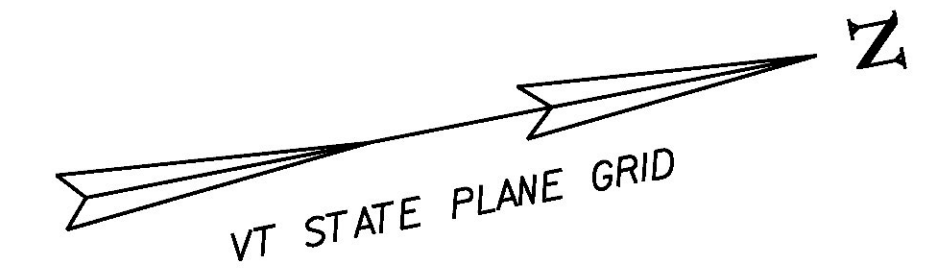

CURVE (1)
 DELTA = 64°09'45"
 D = 34°43'29"
 R = 165.00'
 T = 103.43'
 L = 184.77'
 E = 29.74'
 BANKING = 0.040

**BEGIN R.O.W. PROJECT
 STP 1441(29)
 STA. 10+57.70, 24.75' LT**

**END R.O.W. PROJECT
 STP 1441(29)
 STA 13+30.33, 24.75' LT**

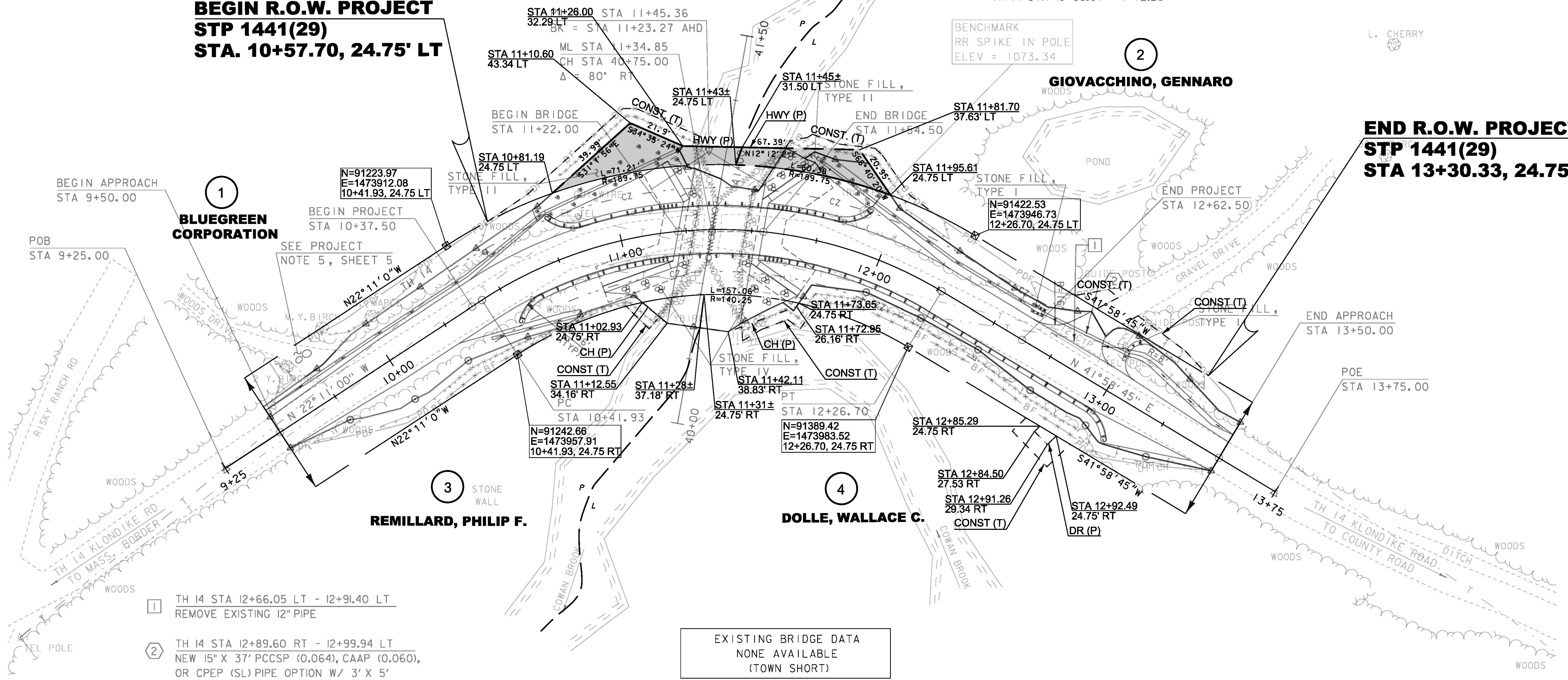

- 1 TH 14 STA 12+66.05 LT - 12+91.40 LT
REMOVE EXISTING 12" PIPE
- 2 TH 14 STA 12+89.60 RT - 12+99.94 LT
NEW 15" X 37" PCCSP (0.064), CAAP (0.060),
OR CPEP (SL) PIPE OPTION W/ 3' X 5'
STONE FILL PAD, TYPE I @ OUTLET

EXISTING BRIDGE DATA
 NONE AVAILABLE
 (TOWN SHORT)

SCALE 1" = 20' - 0"
 20 0 20

**FOR R.O.W.
 USE ONLY**

LINES SHOWN ON THIS PLAN AS EXISTING
 PROPERTY LINES P/L ARE BELIEVED TO
 BE ACCURATE BUT SHOULD NOT BE RELIED
 UPON FOR PURPOSES UNRELATED TO THE
 STATE OF VERMONT'S ACQUISITION OF LAND
 AND RIGHTS FOR THIS PROJECT.

PROJECT NAME: STAMFORD	PLOT DATE: 03-DEC-2015
PROJECT NUMBER: STP 1441(29)	DRAWN BY: J. BLANCHARD
FILE NAME: r96j226.lay1.DK.dgn	CHECKED BY: H. SALLS
PROJECT LEADER: C. CARLSON	SHEET 43 OF 44
R.O.W. LAYOUT SHEET	