

SECTION "C-C" ABUTMENT #1

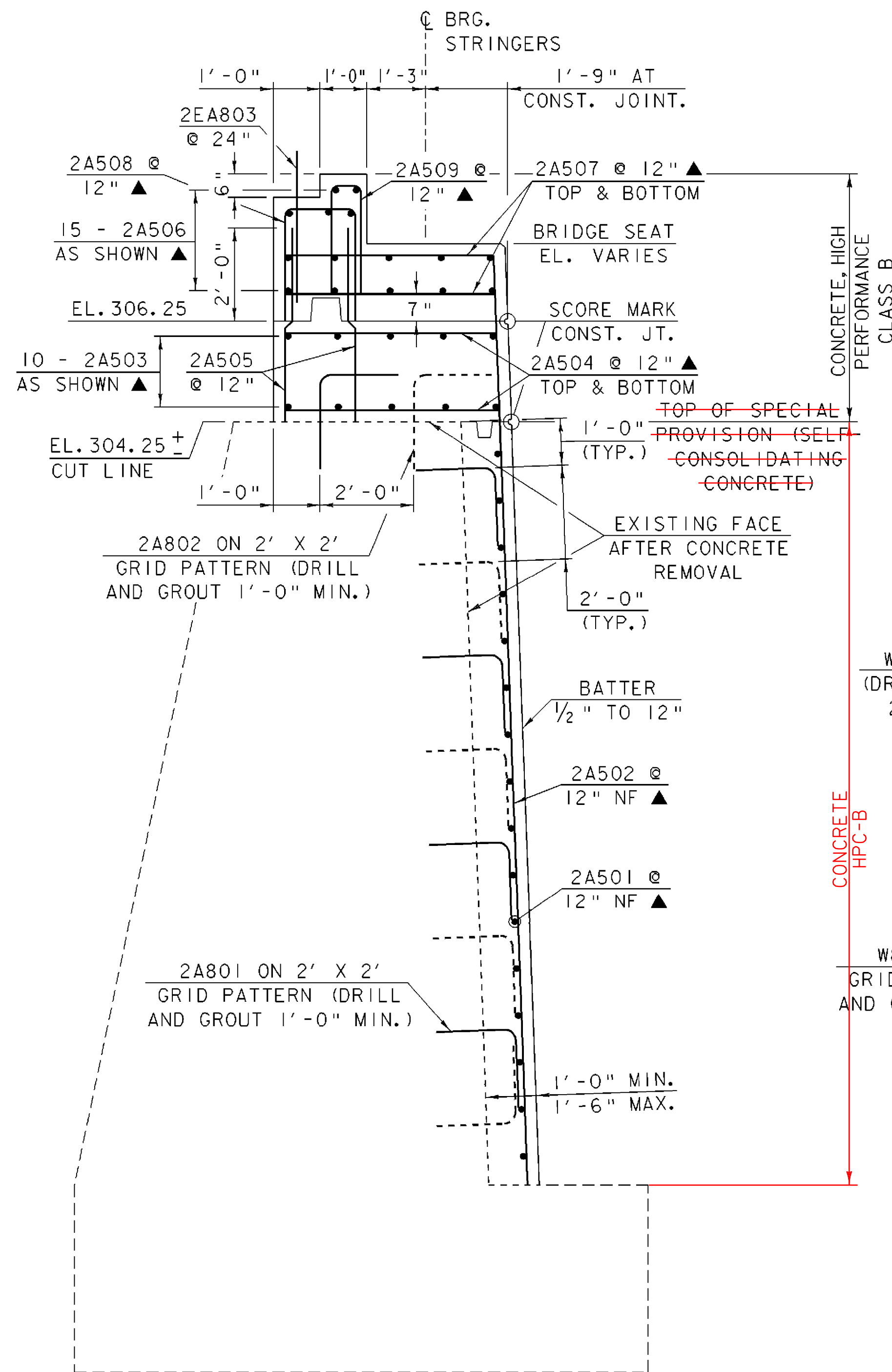

SECTION "D-D" ABUTMENT #2

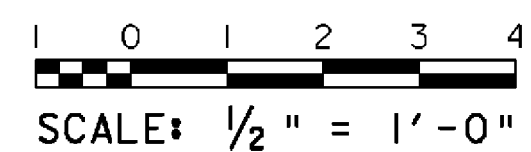
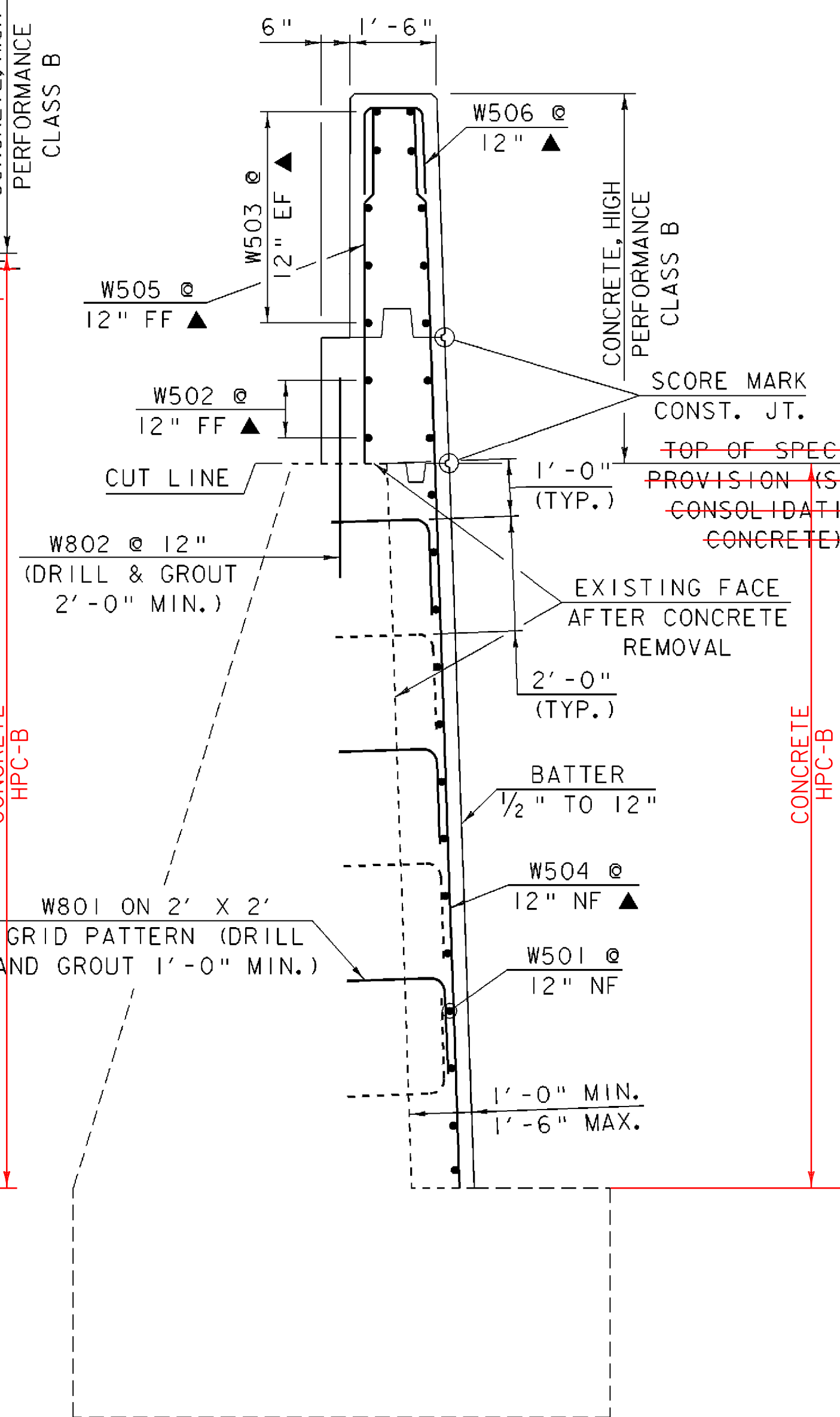
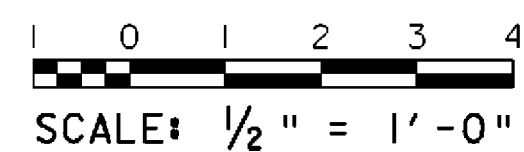

SECTION "E-E"

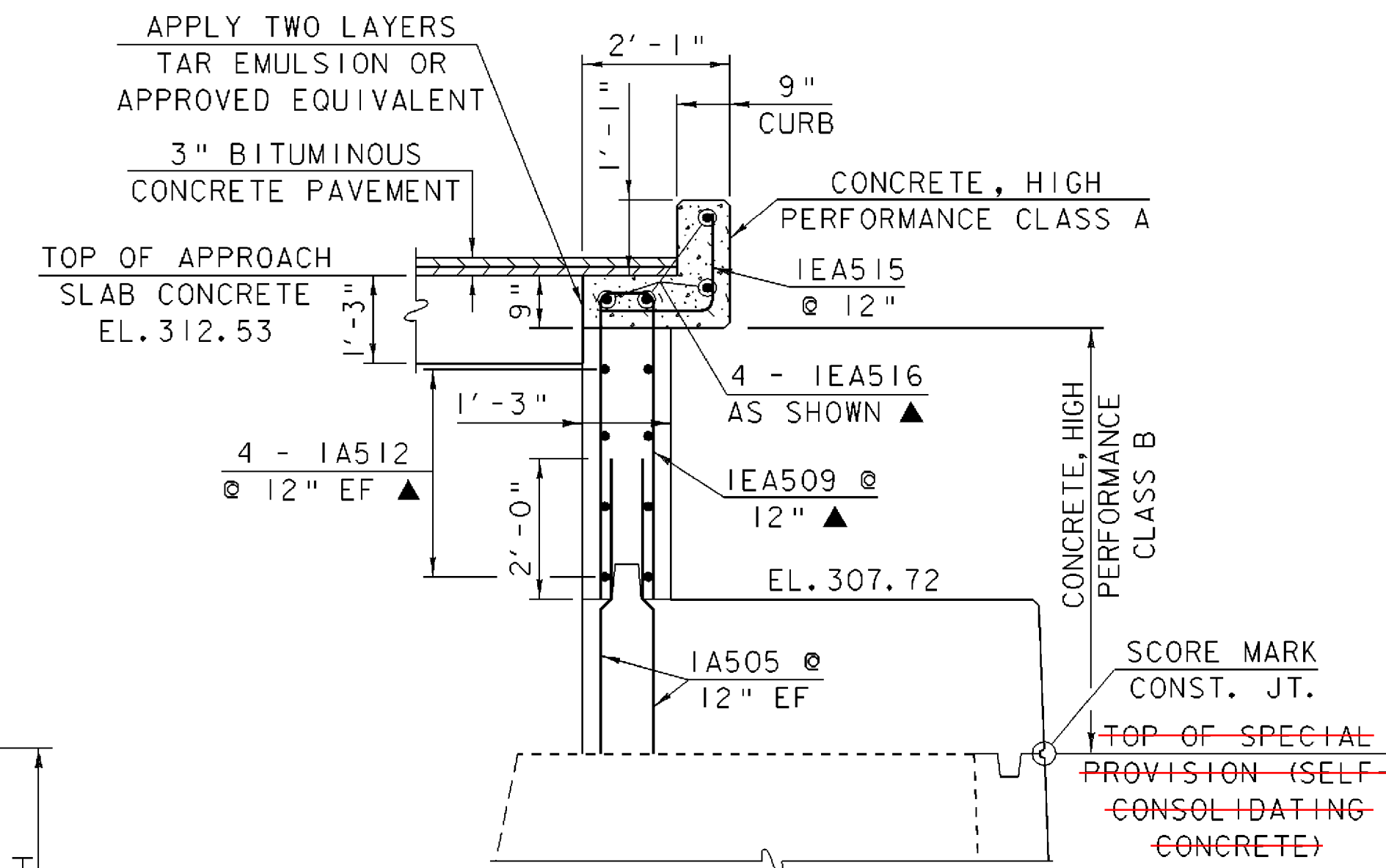
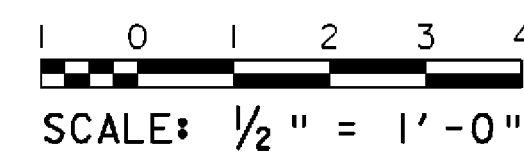

SECTION "F-F"

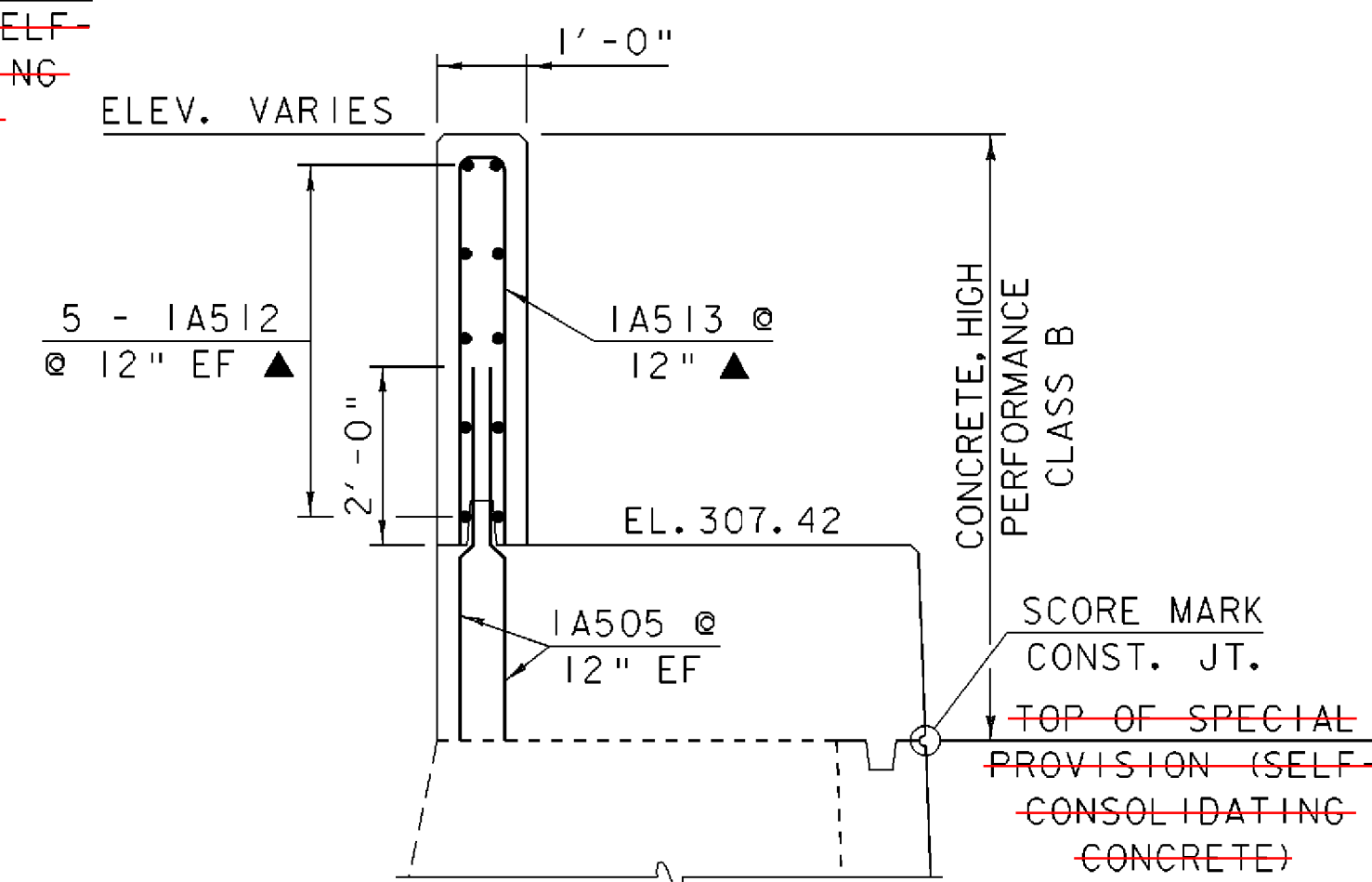
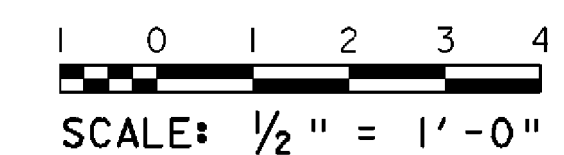

SECTION "G-G"

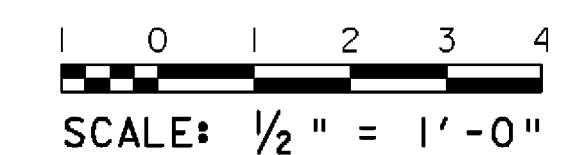

NOTE:
 NF = NEAR FACE
 FF = FAR FACE
 EF = EACH FACE
 ▲ = CUT TO FIT IN FIELD
 3" CLR. UNLESS OTHERWISE NOTED
 2'-2" BAR LAP UNLESS OTHERWISE NOTED

ABUTMENT SECTIONS

PROJECT NAME:	SPRINGFIELD	PLOT DATE:	27-DEC-2007
PROJECT NUMBER:	BHO 1442(30)	DRAWN BY:	G. ROY
FILE NAME:	96J348/str/s96J348ab.dgn	DESIGNED BY:	C. CARLSON
PROJECT MANAGER:	R. R. WHITCOMB	CHECKED BY:	C. CARLSON
DESIGNED BY:	C. CARLSON	SHEET	44 OF 85
s96J348sec.1			

NOTE:
 TAR EMULSION OR APPROVED EQUIVALENT SHALL BE INCIDENTAL TO PAY ITEM "CONCRETE, HIGH PERFORMANCE CLASS A".