

RECONSTRUCT BIKE PATH
STA. 10+91.16 LT.

SPECIAL PROVISION (BOX BEAM GUARDRAIL, PAINTED)
STA. 10+90.45 LT. - STA. 11+69.49 LT.
T.H. 68 STA. 30+65.07 LT. - STA. 12+01.49 RT.
STA. 13+29.49 LT. - STA. 13+47.20 LT.
STA. 13+61.49 RT. - STA. 14+49.20 RT.

REMOVAL AND DISPOSAL OF GUARDRAIL
STA. 11+17.70 LT. - STA. 11+64.90 RT.
STA. 11+89.20 RT. - STA. 11+94.20 RT.
STA. 13+34.30 LT. - STA. 13+45.00 LT.

RECONSTRUCT T.H. 68 APPROACH
STA. 11+51.75 RT.

CONSTRUCT PAVED APRON
STA. 13+60.53 LT.

GUIDE POSTS
STA. 10+90.20 LT.
STA. 13+47.91 LT.

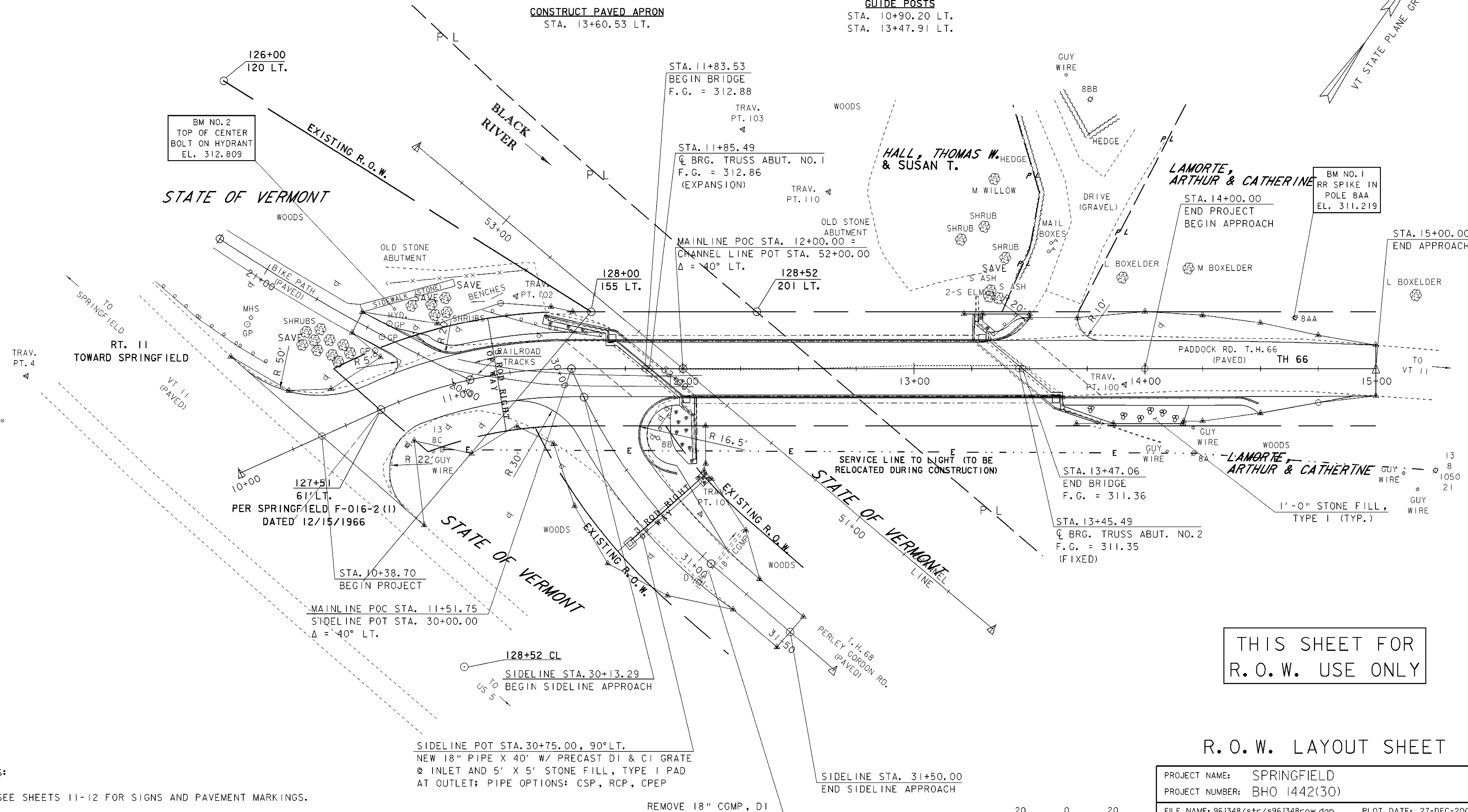
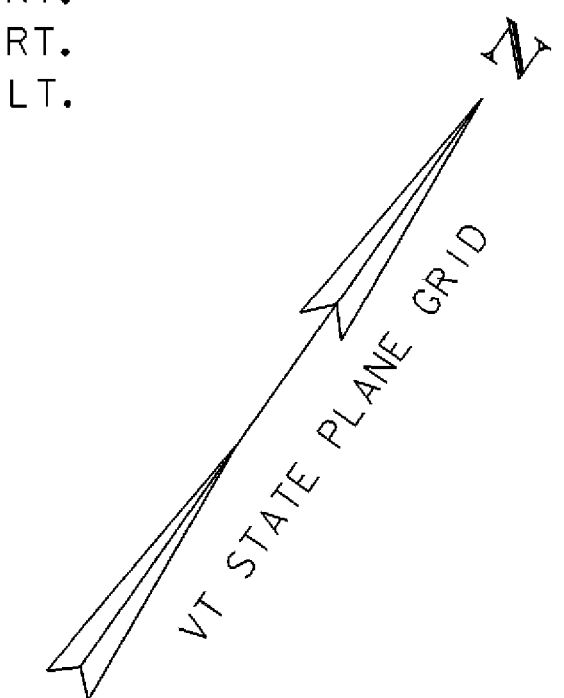

BM NO. 2
TOP OF CENTER
BOLT ON HYDRANT
EL. 312.809

BM NO. 1
RR SPIKE IN
POLE 8AA
EL. 311.219

RT. 11
TOWARD SPRINGFIELD

THIS SHEET FOR
R.O.W. USE ONLY

R.O.W. LAYOUT SHEET

NOTES:
1. SEE SHEETS 11-12 FOR SIGNS AND PAVEMENT MARKINGS.



PROJECT NAME:	SPRINGFIELD	PLOT DATE:	27-DEC-2007
PROJECT NUMBER:	BHO 1442(30)	DRAWN BY:	G. ROY
FILE NAME:	96j348/str/s96j348row.dgn	CHECKED BY:	C. CARLSON
PROJECT MANAGER:	R. R. WHITCOMB	SHEET	6 OF 85
DESIGNED BY:	G. ROY		

SIDE LINE POT STA. 30+75.00, 90° LT.
NEW 18" PIPE X 40' W/ PRECAST DI & CI GRATE
@ INLET AND 5' X 5' STONE FILL, TYPE I PAD
AT OUTLET; PIPE OPTIONS: CSP, RCP, CPEP

REMOVE 18" CGMP, DI