

STATE OF VERMONT AGENCY OF TRANSPORTATION



PROPOSED IMPROVEMENT BRIDGE PROJECT TOWN OF CHITTENDEN COUNTY OF RUTLAND

ROUTE NO : TOWN HIGHWAY 23 (LOCAL), BRIDGE 20

PROJECT LOCATION : ON TH 23 OVER WILDCAT BROOK APPROXIMATELY 4.13 km (2-1/2 MILES) SOUTHEASTERLY FROM THE INTERSECTION OF TH 23 AND TH 1 IN THE CENTER OF TOWN.

PROJECT DESCRIPTION : REPLACEMENT OF EXISTING BRIDGE ALONG WITH ROADWAY, APPROACH AND CHANNEL WORK.

LENGTH OF STRUCTURE: 10.000 METERS.
LENGTH OF ROADWAY: 100.000 METERS.
LENGTH OF PROJECT : 110.000 METERS.

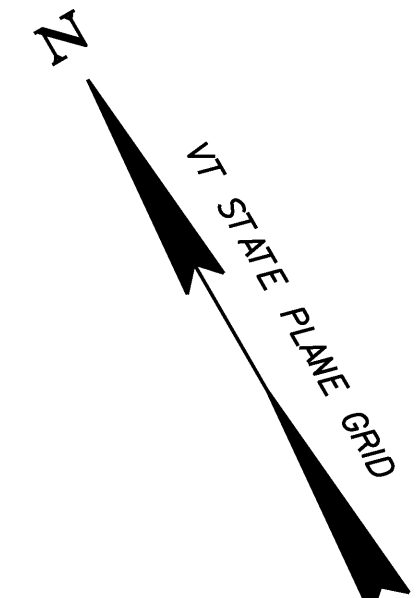
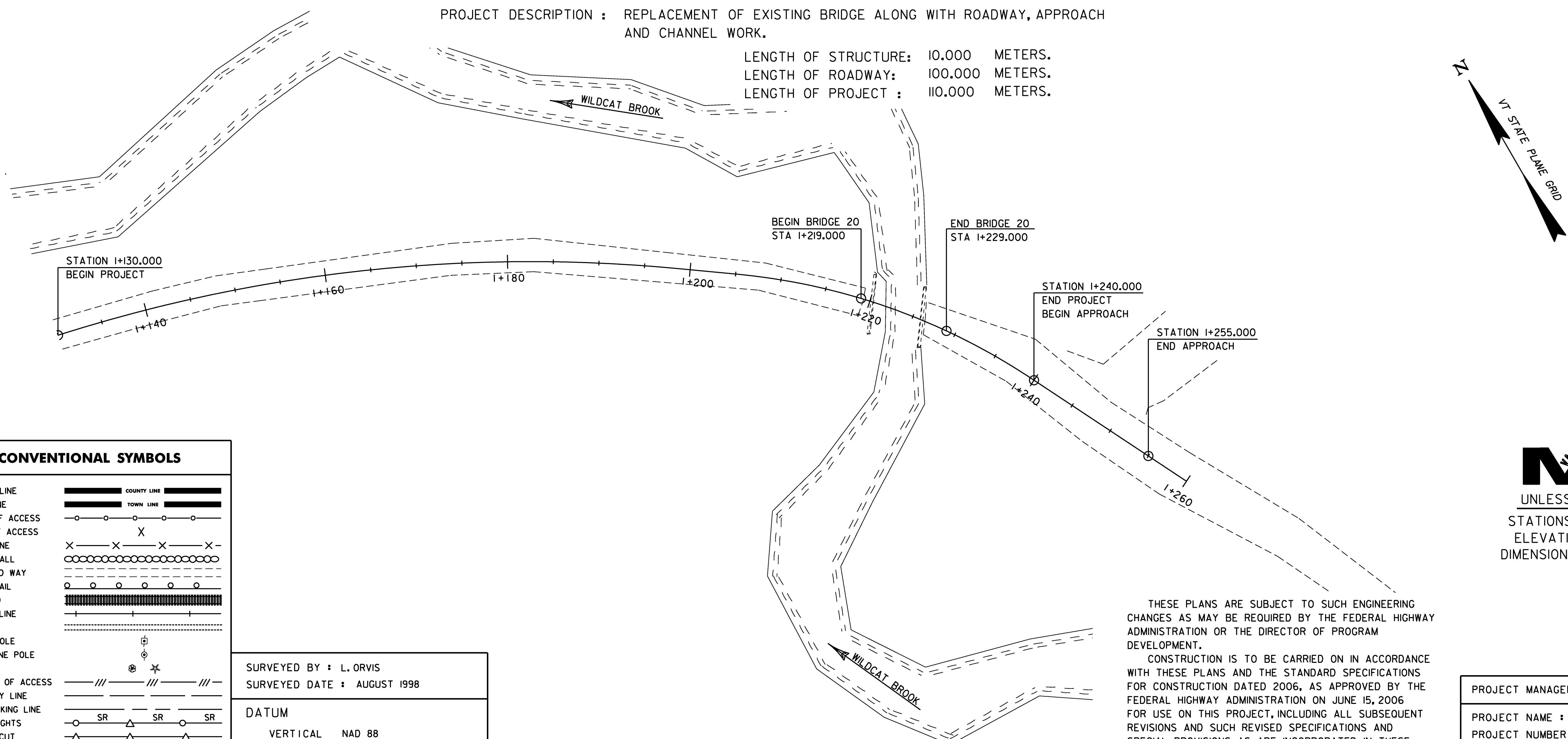
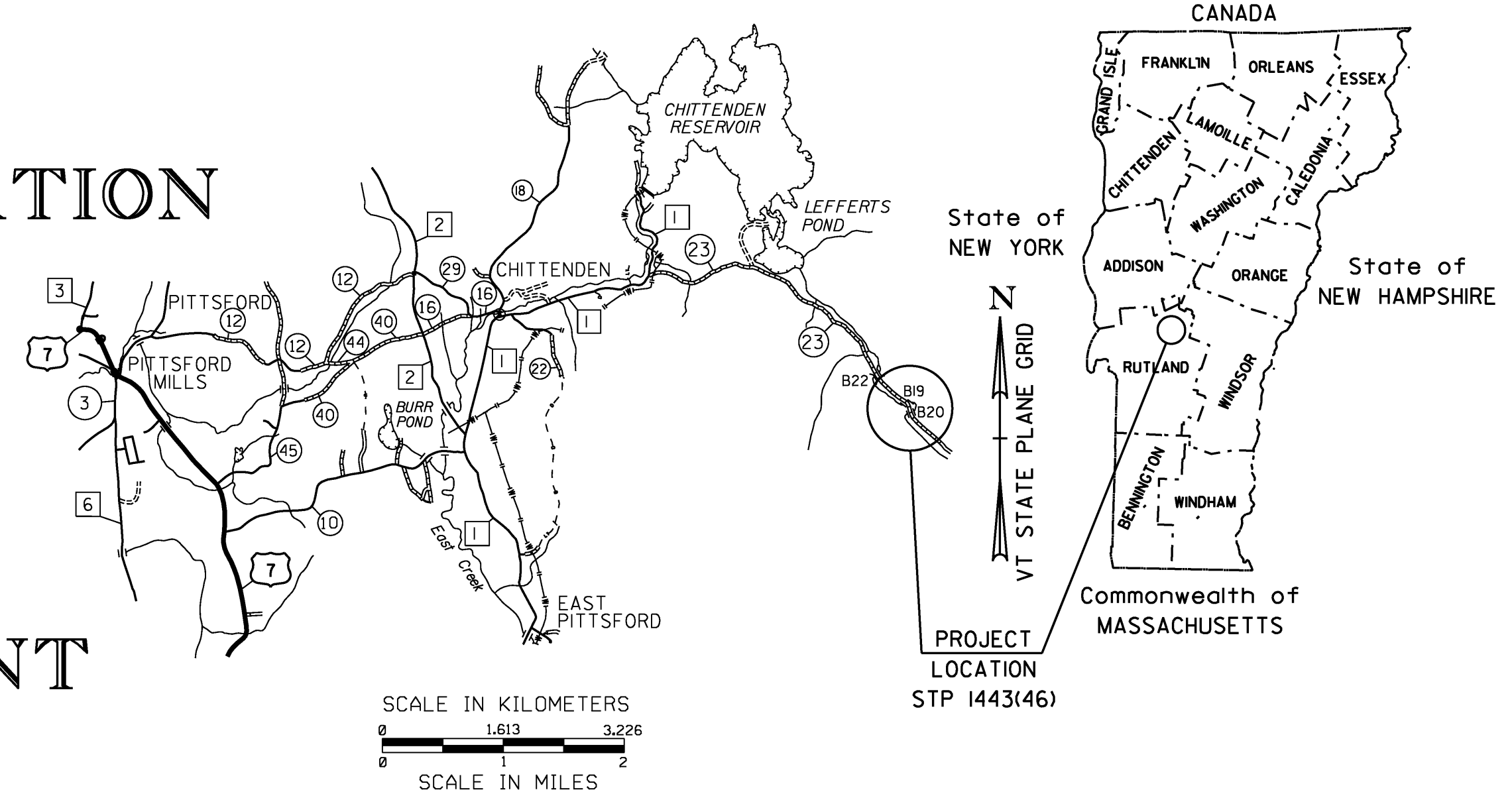

CONVENTIONAL SYMBOLS

COUNTY LINE	
TOWN LINE	
LIMITS OF ACCESS	
POINT OF ACCESS	
FENCE LINE	
STONE WALL	
TRAVELED WAY	
GUARD RAIL	
RAILROAD	
SURVEY LINE	
CULVERT	
POWER POLE	
TELEPHONE POLE	
TREES	
CONTROL OF ACCESS	
PROPERTY LINE	
R.O.W. TAKING LINE	
SLOPE RIGHTS	
TOP OF CUT	
TOE OF SLOPE	

SURVEYED BY : L. ORVIS
SURVEYED DATE : AUGUST 1998

DATUM
VERTICAL NAD 88
HORIZONTAL NAD 83/92

Metric
UNLESS NOTED OTHERWISE
STATIONS ARE IN KILOMETERS
ELEVATIONS ARE IN METERS
DIMENSIONS ARE IN MILLIMETERS

THESE PLANS ARE SUBJECT TO SUCH ENGINEERING CHANGES AS MAY BE REQUIRED BY THE FEDERAL HIGHWAY ADMINISTRATION OR THE DIRECTOR OF PROGRAM DEVELOPMENT.

CONSTRUCTION IS TO BE CARRIED ON IN ACCORDANCE WITH THESE PLANS AND THE STANDARD SPECIFICATIONS FOR CONSTRUCTION DATED 2006, AS APPROVED BY THE FEDERAL HIGHWAY ADMINISTRATION ON JUNE 15, 2006 FOR USE ON THIS PROJECT, INCLUDING ALL SUBSEQUENT REVISIONS AND SUCH REVISED SPECIFICATIONS AND SPECIAL PROVISIONS AS ARE INCORPORATED IN THESE PLANS.

PROJECT MANAGER : C. CARLSON

PROJECT NAME : CHITTENDEN
PROJECT NUMBER : STP 1443(46)

SHEET 53 OF 81 SHEETS