

**PRECAST UNIT REINFORCEMENT
UNIT C2 ONLY**

WEIGHT OF REQUIRED REINFORCEMENT = 513 LBS/FT

SHEET NO.	CIRCUMFERENTIAL AREA REQ'D (IN ² /FT)	LONGITUDINAL AREA REQ'D (IN ² /FT)	MESH SIZE	LENGTH (FT)	CIRCUMFERENTIAL AREA SUP'L'D (IN ² /FT)	LONGITUDINAL AREA SUP'L'D (IN ² /FT)
1	A1 = 1.44	0.13	ALTERNATE #4 @ 4" O.C. WITH #5 @ 4" O.C.	35'-0"	1.53	0.30
3	A2 = 0.48	0.13	4 x 6 W8 x W6.5 + #4 EA 10" CIRC	13'-9"	0.48	0.13
4	A3A = 0.72	0.07	2 x 6 W10 x W6.5 + #4 EA 18" CIRC	25'-4"	0.72	0.13
5	A3B = 0.72	0.06	2 x 6 W10 x W6.5 + #4 EA 18" CIRC	21'-4"	0.72	0.13
6	A4 = 0.48	0.13	4 x 6 W8 x W6.5 + #4 EA 18" CIRC	15'-0"	0.48	0.13
7	A5 = 0.24	0.13	4 x 6 W8 x W6.5	7'-0"	0.24	0.13

DESIGN LOADING: HL-93

MARK	DATE	REVISION DESCRIPTION	BY
7	06/27/2011	C2 UNIT REINFORCING	RKL
6	05/05/2011	APPROVED FOR CONSTRUCTION	RKL
5	4/27/2011	REVISIONS PER REVIEWERS COMMENTS	RKL
4	4/18/2011	NO CHANGES ON THIS SHEET	RKL
3	4/8/2011	NO CHANGES ON THIS SHEET	RKL
2	4/4/11	NO CHANGES ON THIS SHEET	RKL
1	3/10/2011	REVISIONS PER REVIEWERS COMMENTS	RKL

COVER = 6" MIN. 1/8" MAX.

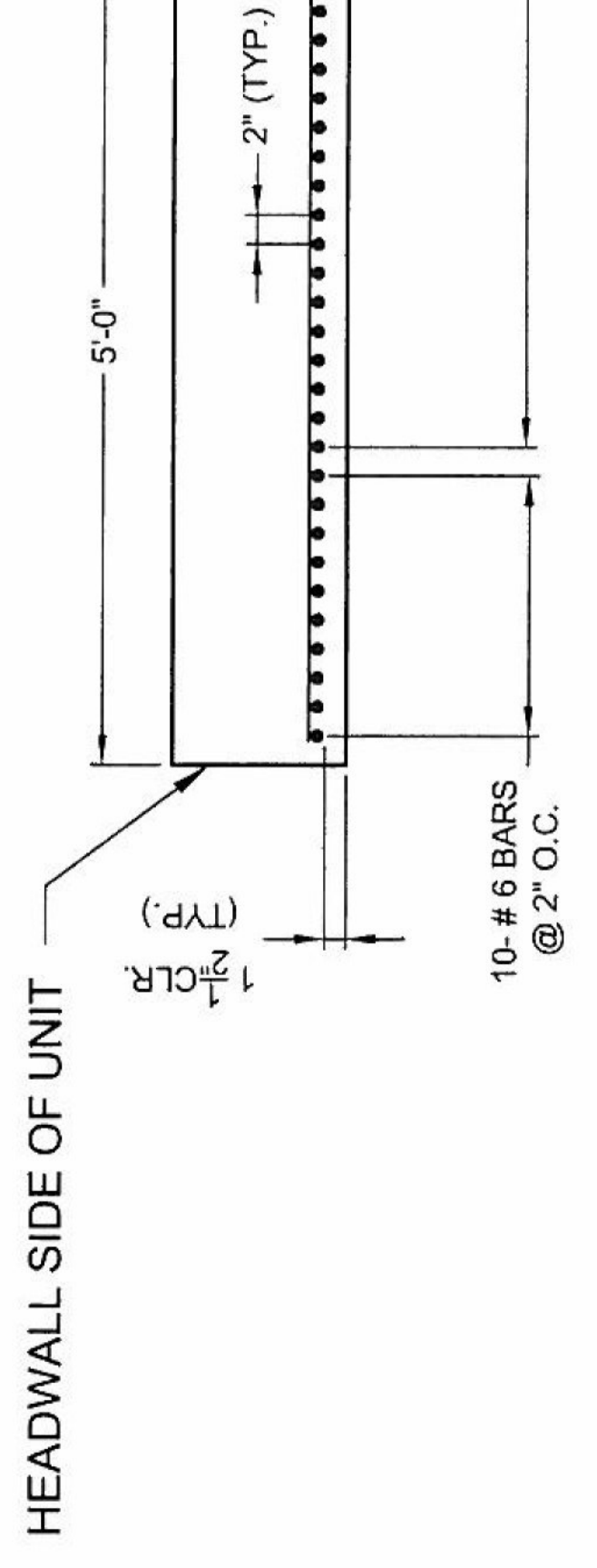

SECTION

The design and information shown on this drawing is provided as a service to the project owner, engineer and contractor by CONTECH CONSTRUCTION PRODUCTS INC. Neither the drawing, nor any part thereof, may be used, reproduced or modified in any manner without the prior written consent of CONTECH. CONTECH expressly disclaims any liability or responsibility for such use.

It is understood that the information upon which this drawing is based and actual field conditions are encountered as the project progresses. These discrepancies must be reported to CONTECH immediately. CONTECH accepts no liability for designs based on missing, incomplete or inaccurate information supplied by others.

CONTECH
CONSTRUCTION PRODUCTS INC.
www.contech-cpi.com

9025 Centre Pointe Dr., Suite 400, West Chester, OH 45069
800-338-1122 513-645-7000 513-645-7993 FAX

CONISPAN
BRIDGE SYSTEMS

CONTECH
FABRICATION
DRAWING

HARTFORD THRU
VERMONT AGENCY OF TRANSPORTATION
HARTFORD