

WINGWALL - WW3A

TOTAL WEIGHT = 8.7 TONS

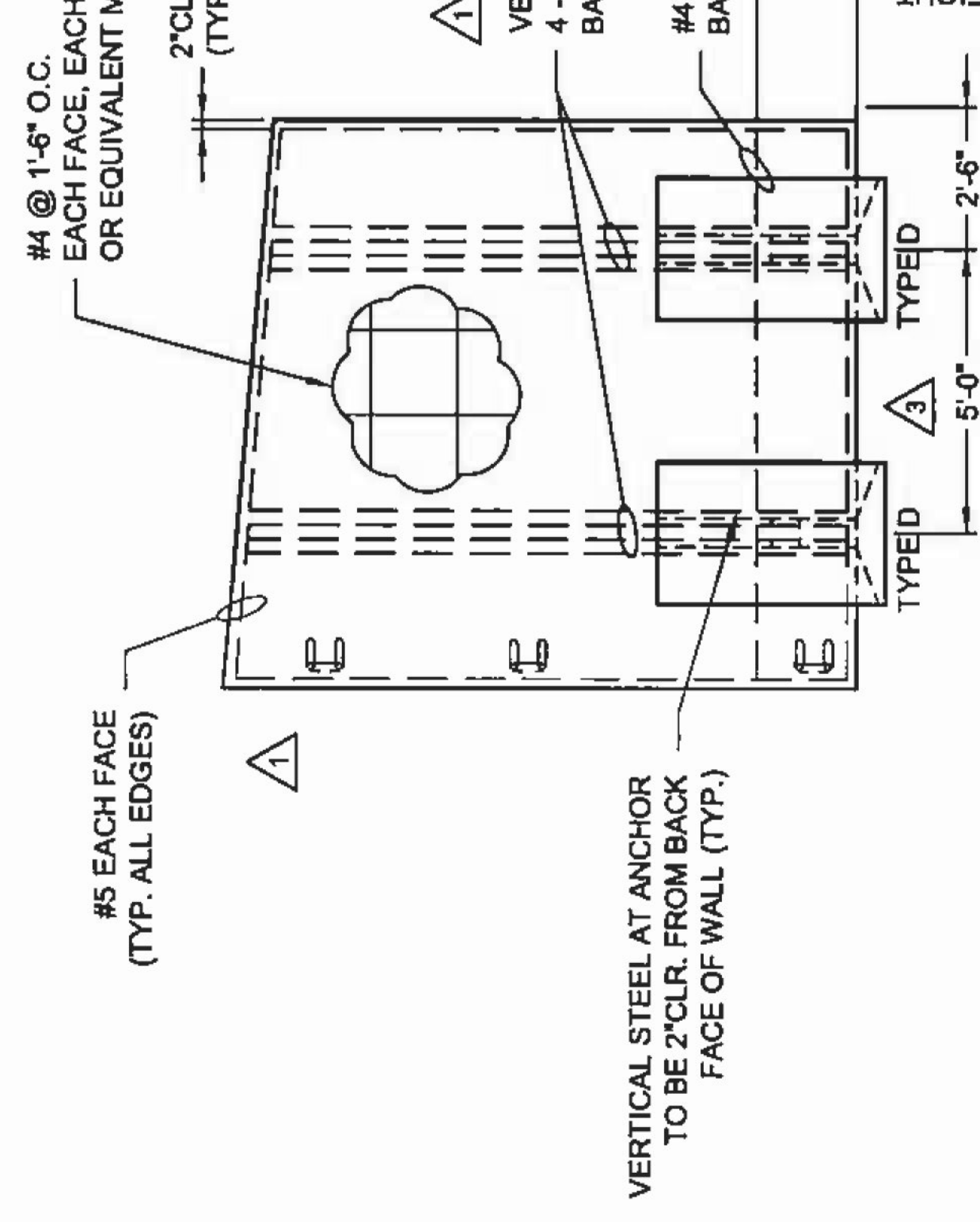

REINFORCING DETAIL - WW3A
(FOR ANCHOR REINFORCING SEE SHEET)

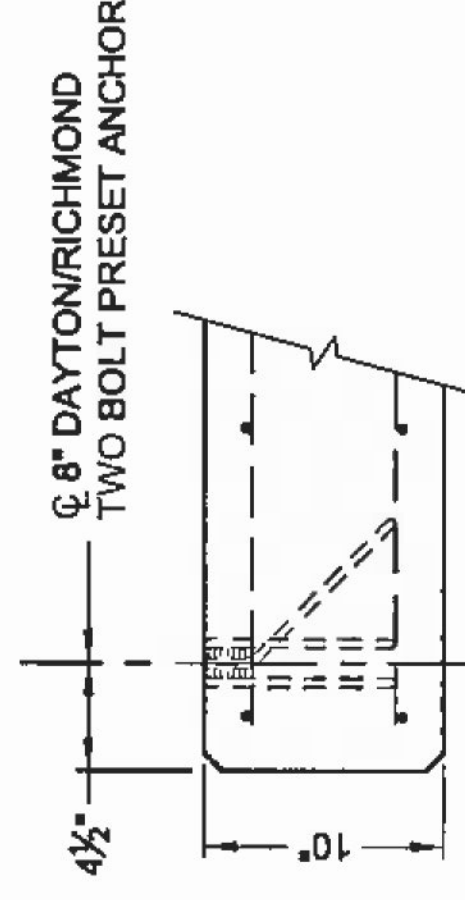

SECTION

24

Vermont Agency of Transportation
RECEIVE
 CK'D BY GML OK'D BY T
 7:13 am, May 03, 2011
 RESUBMIT APPROVE
 BY KMH DATE

This design and information shown on this drawing is prepared by CONTECH Construction Products Inc. or one of its authorized representatives. It is intended for use only for the project and site identified herein. It may be used, reproduced or modified in any manner without the prior written consent of CONTECH. Failure to obtain the prior written consent of CONTECH represents an acknowledgment of liability for responsibility for such use. CONTECH does not warrant the accuracy of the information shown on this drawing. The user of this drawing is responsible for the accuracy of the information shown on this drawing. CONTECH is not responsible for the accuracy of the information shown on this drawing. CONTECH is not responsible for the accuracy of the information shown on this drawing. CONTECH is not responsible for the accuracy of the information shown on this drawing.

MARK	DATE	REVISION DESCRIPTION	BY
5	4/27/2011	NO CHANGES ON THIS SHEET	RKL
4	4/19/2011	REVISIONS PER REVIEWERS COMMENTS	RKL
3	4/8/2011	REVISIONS PER REVIEWERS COMMENTS	RKL
2	4/4/11	NO CHANGES ON THIS SHEET	RKL
1	3/10/2011	REVISIONS PER REVIEWERS COMMENTS	RKL



www.contech-cpi.com
 9025 Centre Pointe Dr., Suite 400, West Chester, OH 45069
 600-338-1122 513-645-7000 513-645-7993 FAX



CORTECH FABRICATION DRAWING

HARTFORD TH#
 VERMONT AGENCY OF TRANSPORTATION
 HARTFORD, VT