

☉ LIFT POINTS (TOP 2 LIFT POINTS MUST BE CAPABLE OF SUPPORTING ENTIRE WEIGHT OF WINGWALL)

#4 @ 1'-6" O.C. EACH FACE, EACH WAY OR EQUIVALENT MESH

VERTICAL BARS: 4 - #6 @ 3" O.C. BACK FACE ONLY

#4 x 8'-6" BACK FACE ONLY

VERTICAL BARS: 6 - #8 @ 3" O.C. BACK FACE ONLY

VERTICAL STEEL TO BE 2" CLR. FROM FACE OF WALL

WINGWALL - WW1C

TOTAL WEIGHT = 12.6 TONS

REINFORCING DETAIL - WW1C

(FOR ANCHOR REINFORCING SEE SHEET S25)

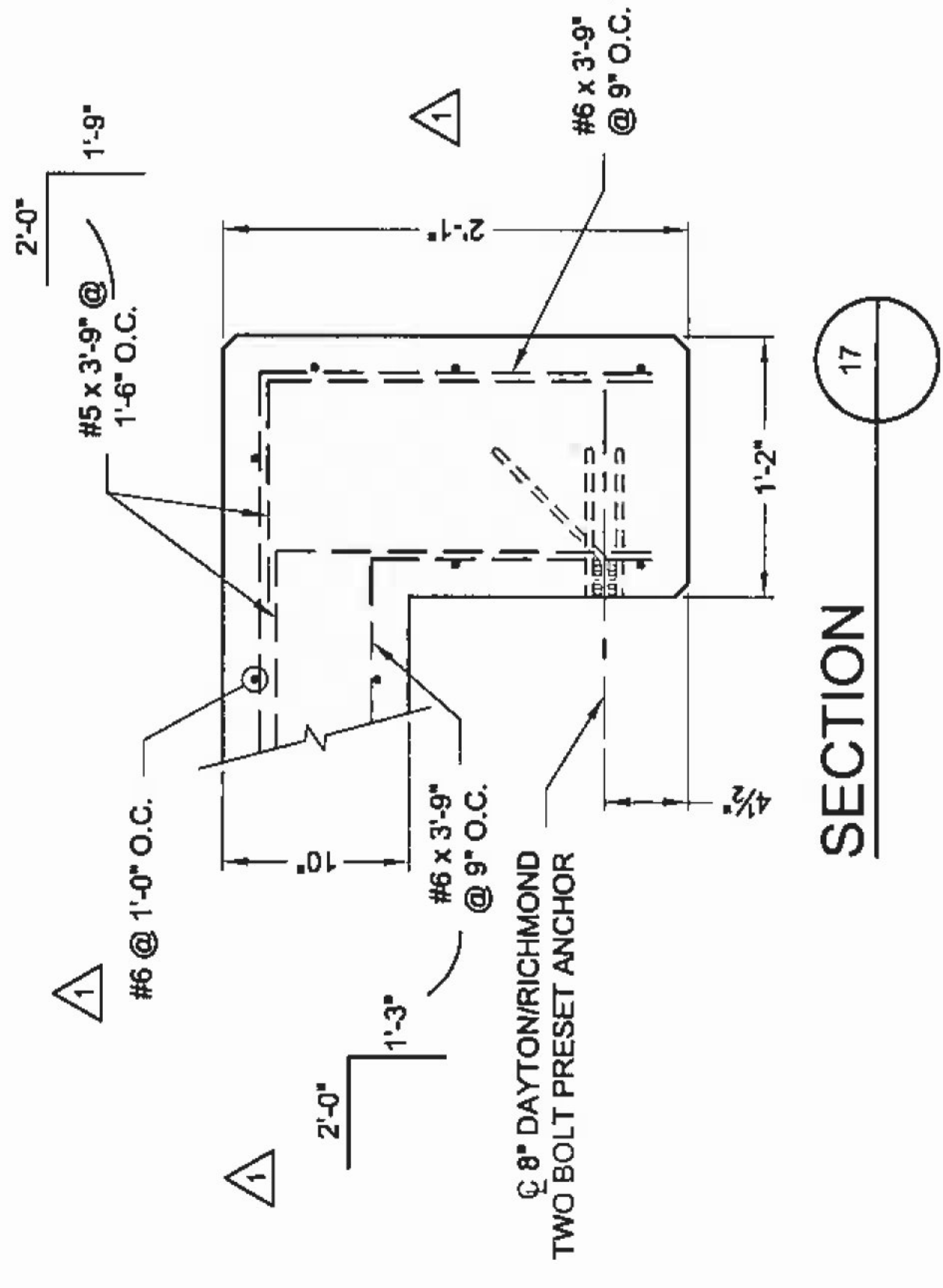

SECTION 16-17

SECTION 17-17

The design and information shown on this drawing is prepared by CONTECH Construction Products Inc. or one of its affiliates. It is intended for use only for the project and location specified. Without the prior written consent of CONTECH, its use for any other project, location, or purpose is prohibited. CONTECH assumes no liability for any errors or omissions on this drawing. The drawings are based on actual field conditions and are subject to change without notice. The drawings are based on actual field conditions and are subject to change without notice. The drawings are based on actual field conditions and are subject to change without notice.

MARK	DATE	REVISION DESCRIPTION	BY
5	4/27/2011	NO CHANGES ON THIS SHEET	RKL
4	4/18/2011	REVISIONS PER REVIEWERS COMMENTS	RKL
3	4/8/2011	REVISIONS PER REVIEWERS COMMENTS	RKL
2	4/4/11	NO CHANGES ON THIS SHEET	RKL
1	3/10/2011	REVISIONS PER REVIEWERS COMMENTS	RKL

CONTECH
CONSTRUCTION PRODUCTS INC.
www.contech-cpl.com
9025 Centre Pointe Dr., Suite 400, West Chester, OH 45069
800-338-1122 513-645-7000 513-645-7993 FAX

CONSPAN
BRIDGE SYSTEMS
CONTECH FABRICATION DRAWING

HARTFORD TH#
VERMONT AGENCY OF TRANSPORTATION
HARTFORD, VT