

WINGWALL CORNER DETAIL

SCALE 1" = 1'-0"
 1 9 6 3 0
 2

WW1 ELEV 438.87
 WW2 ELEV 438.93
 WW3 ELEV 438.84
 WW4 ELEV 438.90

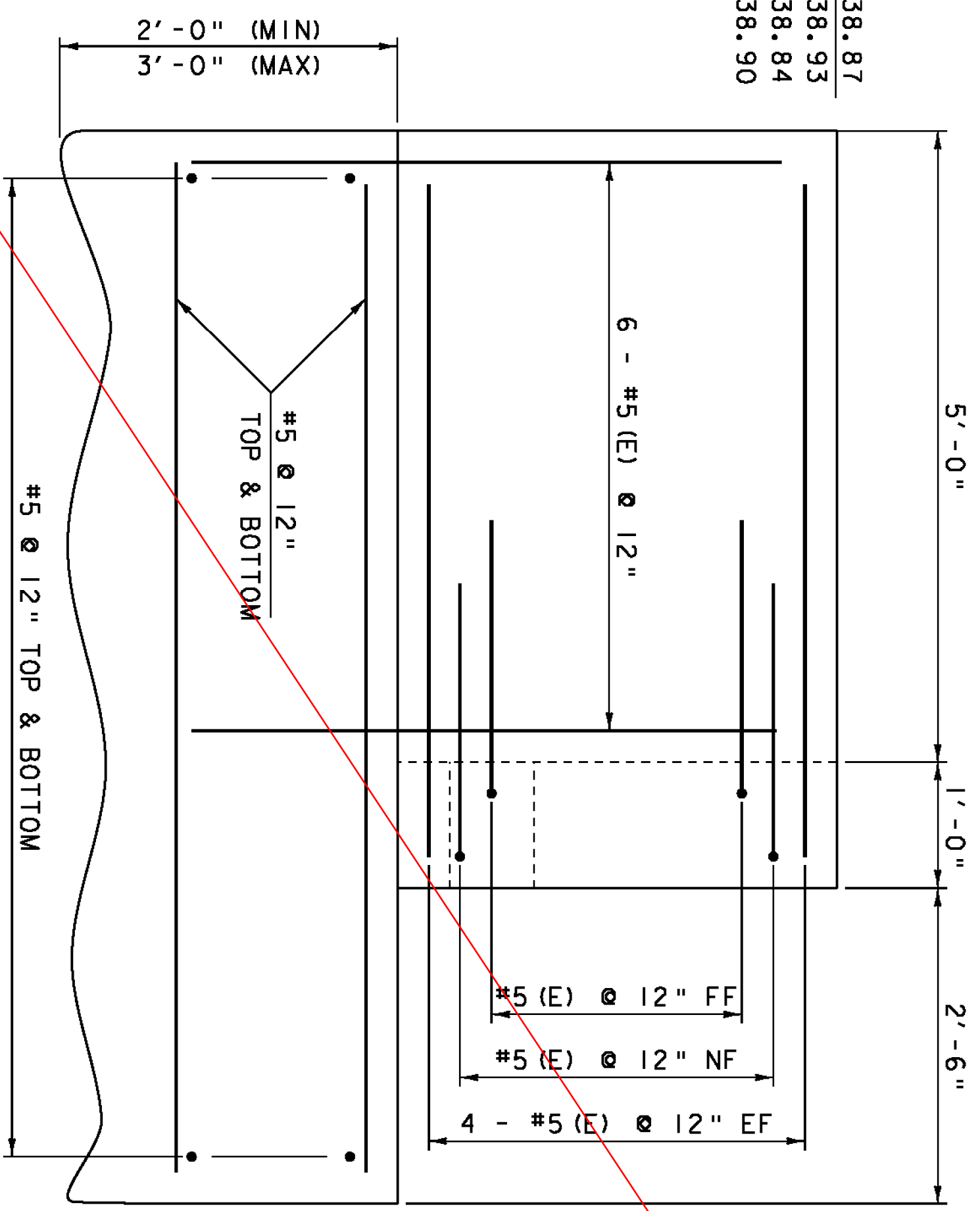

WINGWALL ELEVATION VIEW

SCALE 1" = 1'-0"
 1 9 6 3 0
 2

ELEV 435.58

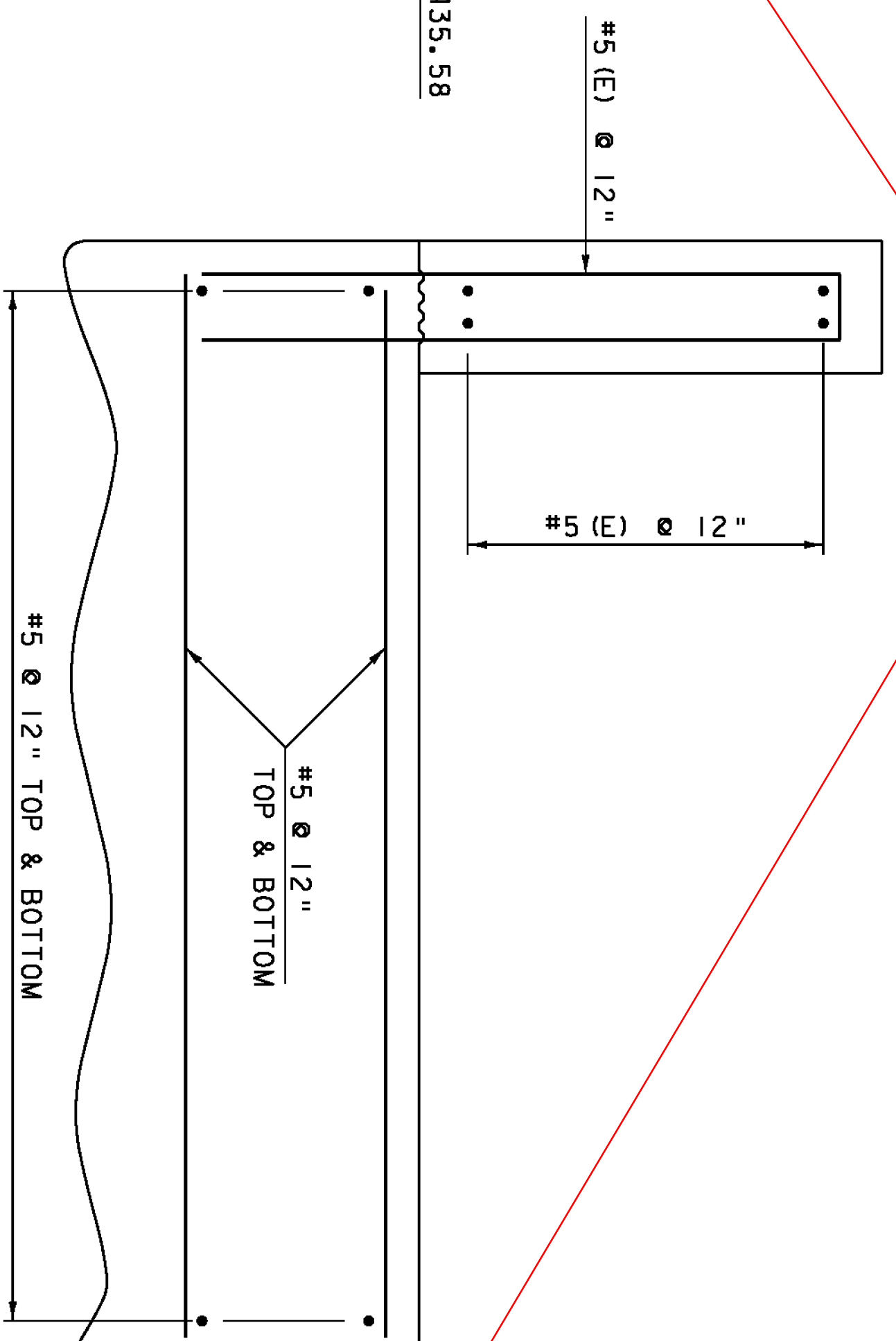

WINGWALL TYPICAL SECTION

SCALE 1" = 1'-0"
 1 9 6 3 0
 2

NOTE:
 CONTRACTOR IS RESPONSIBLE FOR DETERMINING THE LENGTHS AND REINFORCING BAR BENDS BASED ON THESE DRAWINGS. ALL LAP LENGTHS SHALL BE AT LEAST THE LENGTH SPECIFIED BELOW:

- #5 - 2'-2"
- #6 - 2'-7"
- #7 - 3'-5"
- #8 - 4'-6"
- #9 - 5'-8"
- #10 - 7'-3"
- #11 - 8'-10"

NOTE:
 NF = NEAR FACE
 FF = FAR FACE
 EF = EACH FACE
 ▲ = CUT TO FIT IN FIELD
 3" CLEAR, UNLESS OTHERWISE SPECIFIED ON THE PLANS.

SEE REVISED ABUTMENT DRAWINGS
 SHEET 10F 1 DATED 4/25/12

PROJECT NAME: HARTFORD (WILDER)	PLOT DATE: 16-JUN-2010
PROJECT NUMBER: STP 1444(35)	DRAWN BY: T. FILLBACH
FILE NAME: B38\SP610705sub-b38.dgn	CHECKED BY: JSALVATORI
PROJECT LEADER: K. HIGGINS	SHEET 57 OF 69
DESIGNED BY: T. FILLBACH	
WINGWALL DETAILS - BRIDGE 38	