

* SEE SHEET 8 FOR AN INDEX OF SHEETS AND LIST OF STANDARDS.

STATE OF VERMONT AGENCY OF TRANSPORTATION

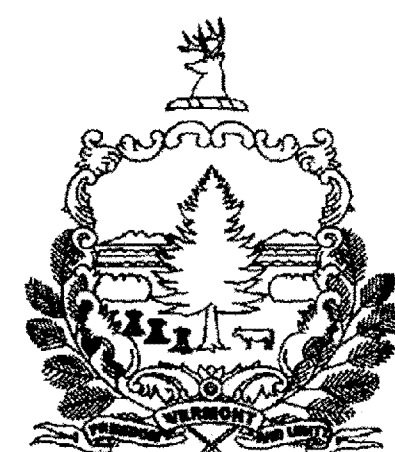

PROPOSED IMPROVEMENT BRIDGE PROJECT TOWN OF HARTFORD (WILDER) COUNTY OF WINDSOR

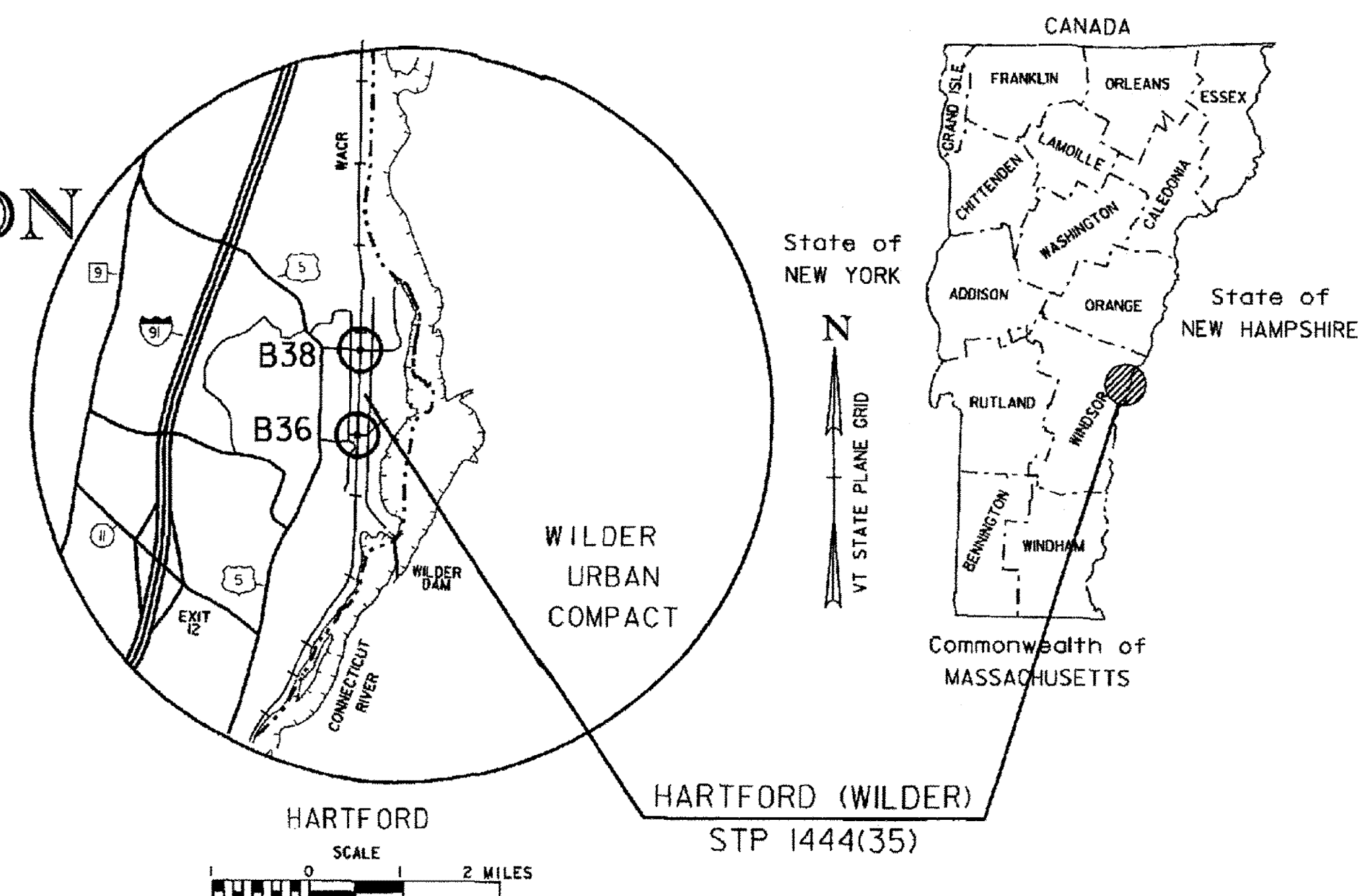

RECORD PLANS	
CONTRACTOR:	RENAUD BROTHERS, INC. - VERNON, VT
RESIDENT ENGINEER:	DARYL BASSETT
CONSTRUCTION BEGAN:	DECEMBER 13, 2010
CONSTRUCTION COMPLETE:	JUNE 5, 2013
RECORD PLANS BY:	DARYL BASSETT, NICK GARBACIK & P. BANNERMAN
I HEREBY CERTIFY THAT ALL THE CONSTRUCTION REQUIRED BY THIS SET OF DRAWINGS HAS BEEN ACCOMPLISHED AS INDICATED HEREIN.	
BY:	<i>Daryl Bassett</i> RESIDENT ENGINEER
DATE:	2/12/15
NOTE: Any further information concerning final quantities, amounts or other details relative to this project may be found at Central Files in the electronic archives.	

ROUTE NO : TH 29, CLASS 3 (LOCAL) BRIDGE NO : 38

PROJECT LOCATION : BEGINNING AT A POINT ON TH 29 APPROXIMATELY 125 FEET EAST OF THE INTERSECTION OF TH 29 AND TH 30 AND PROGRESSING EASTERLY ALONG TH 29 FOR 125 FEET. PASSING OVER WACR CONN RIVER DIVISION

PROJECT DESCRIPTION : THIS PROJECT SHALL CONSIST OF THE REHABILITATION OF THE HISTORIC SINGLE SPAN STEEL PONY TRUSS BRIDGE WHICH CARRIES TH 29 OVER THE WASHINGTON COUNTY RAILROAD (CONNECTICUT RIVER LINE).

LENGTH OF STRUCTURE : 73.33 FEET
 LENGTH OF ROADWAY : 151.67 FEET
 LENGTH OF PROJECT : 225.00 FEET

ROUTE NO : TH 81, CLASS 3 (LOCAL) BRIDGE NO : 36

PROJECT LOCATION : BEGINNING AT A POINT ON TH 81 APPROXIMATELY 75 FEET EAST OF THE INTERSECTION OF TH 81 AND TH 30 AND PROGRESSING EASTERLY ALONG TH 81 FOR 200 FEET. PASSING OVER WACR CONN RIVER DIVISION

PROJECT DESCRIPTION : THE PROJECT SHALL CONSIST OF REPLACING THE EXISTING WOODEN BRIDGE WITH A SINGLE SPAN BRIDGE WHICH CARRIES TH 81 OVER THE WASHINGTON COUNTY RAILROAD (CONNECTICUT RIVER LINE).

LENGTH OF STRUCTURE : 44.00 FEET
 LENGTH OF ROADWAY : 106.00 FEET
 LENGTH OF PROJECT : 150.00 FEET

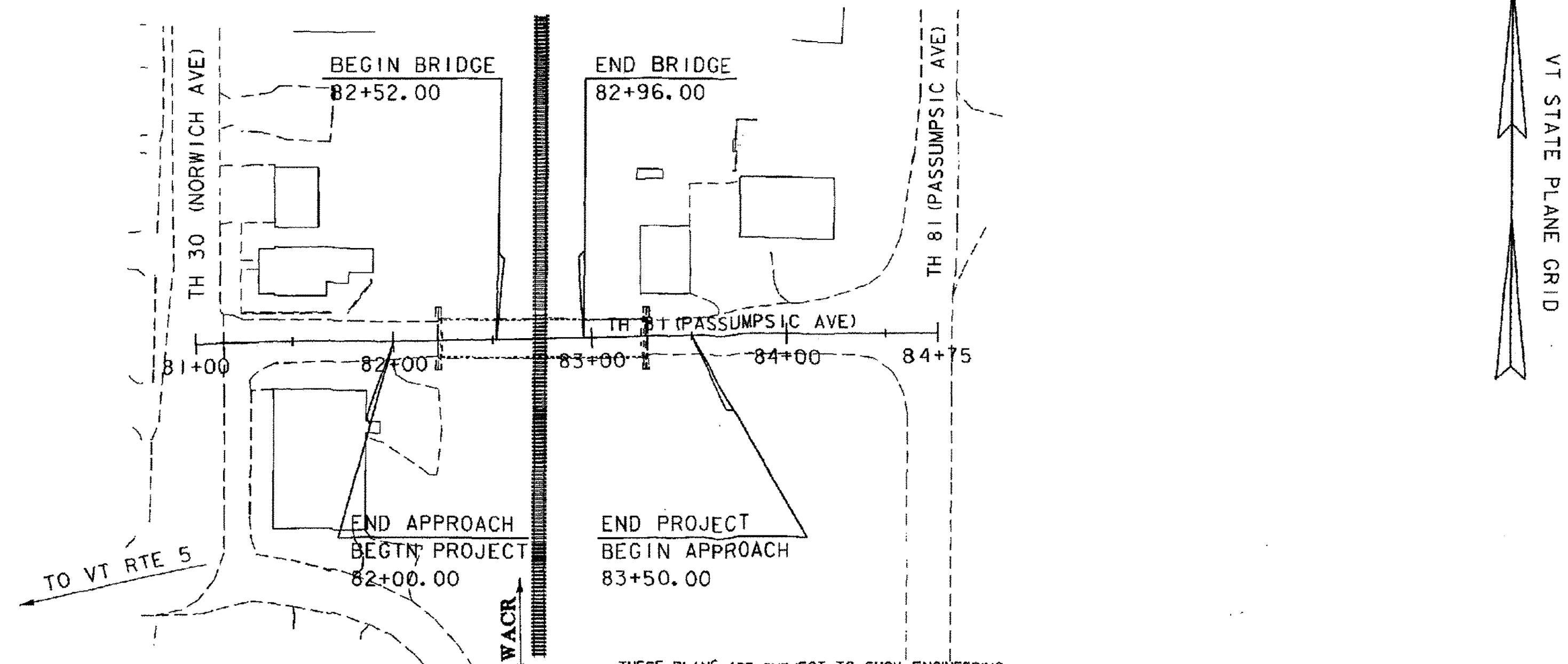
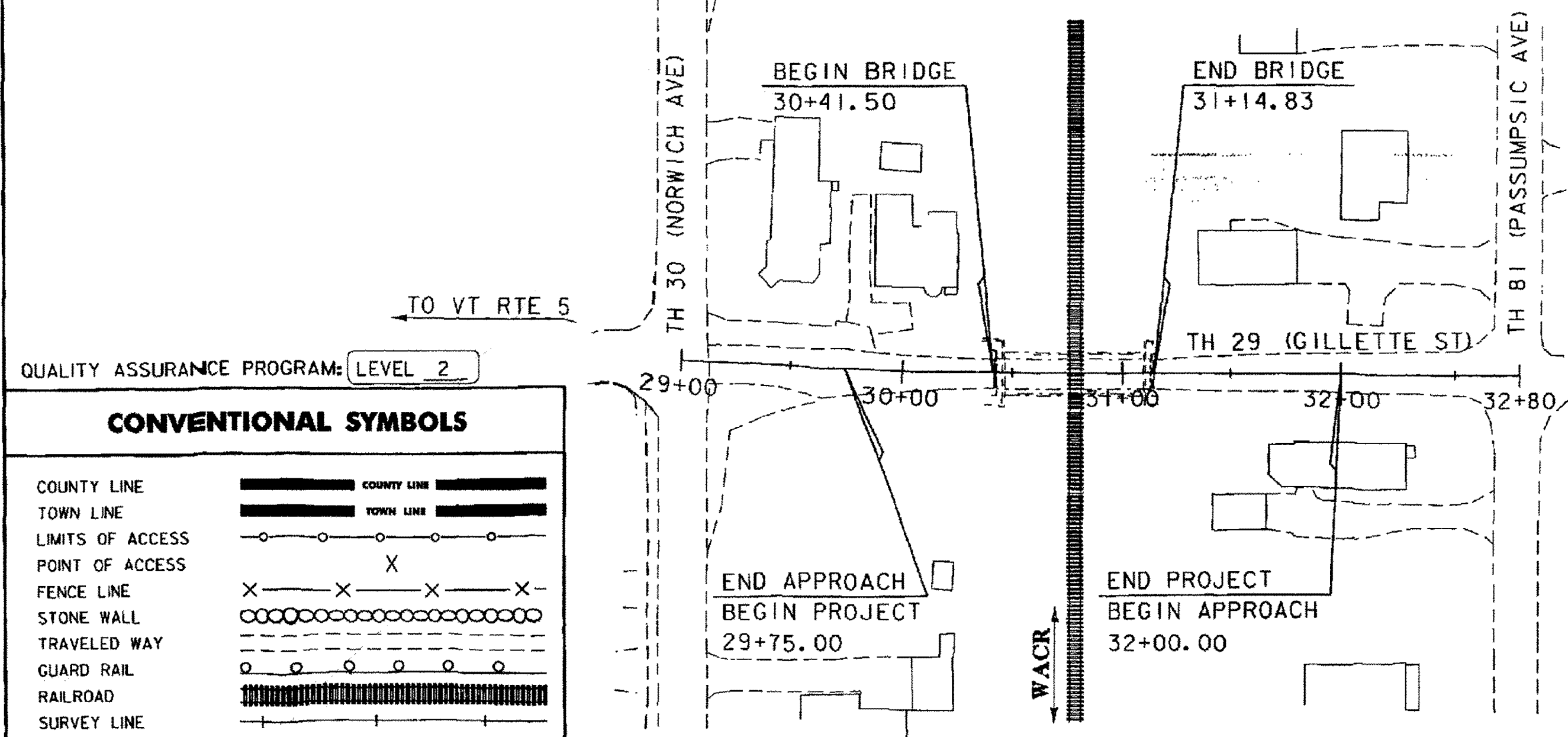

QUALITY ASSURANCE PROGRAM: LEVEL 2

CONVENTIONAL SYMBOLS	
COUNTY LINE	
TOWN LINE	
LIMITS OF ACCESS	
POINT OF ACCESS	
FENCE LINE	
STONE WALL	
TRAVELED WAY	
GUARD RAIL	
RAILROAD	
SURVEY LINE	
CULVERT	
POWER POLE	
TELEPHONE POLE	
TREES	
CONTROL OF ACCESS	
PROPERTY LINE	
R.O.W. TAKING LINE	
SLOPE RIGHTS	
TOP OF CUT	
TOE OF SLOPE	

SURVEYED BY : GILMAN & WINTER
 SURVEYED DATE : MAY 2003

DATUM
 VERTICAL NAVD 88
 HORIZONTAL NAD 83 (92)

SCALE 1" = 50' - 0

THESE PLANS ARE SUBJECT TO SUCH ENGINEERING CHANGES AS MAY BE REQUIRED BY THE FEDERAL HIGHWAY ADMINISTRATION OR THE DIRECTOR OF PROGRAM DEVELOPMENT.

CONSTRUCTION IS TO BE CARRIED ON IN ACCORDANCE WITH THESE PLANS AND THE STANDARD SPECIFICATIONS FOR CONSTRUCTION DATED 2006, AS APPROVED BY THE FEDERAL HIGHWAY ADMINISTRATION ON JUNE 15, 2006 FOR USE ON THIS PROJECT, INCLUDING ALL SUBSEQUENT REVISIONS AND SUCH REVISED SPECIFICATIONS AND SPECIAL PROVISIONS AS ARE INCORPORATED IN THESE PLANS.

s96j070116.dgn PLOTTED 16-JUN-2010

DIRECTOR OF PROGRAM DEVELOPMENT	
APPROVED: <i>Richard J. ...</i>	DATE: 6-17-10
PROJECT MANAGER : KRISTIN HIGGINS	
PROJECT NAME :	HARTFORD (WILDER)
PROJECT NUMBER :	STP 1444 (35)
SHEET 1 OF 69 SHEETS	