

DELINEATOR DETAIL

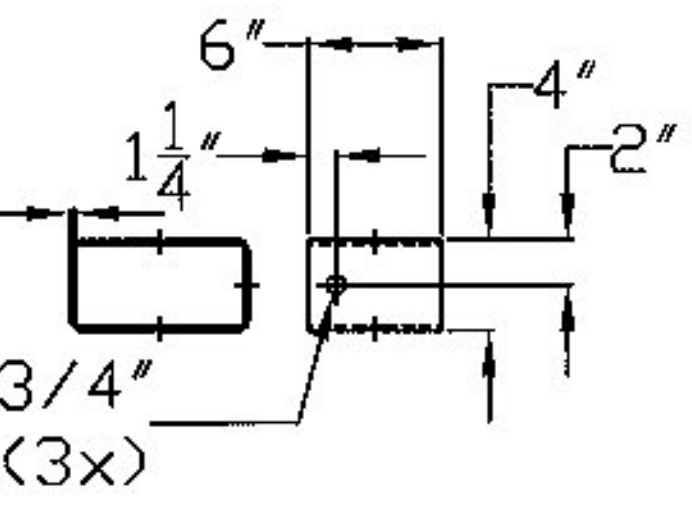

BLOCK OUT DETAIL

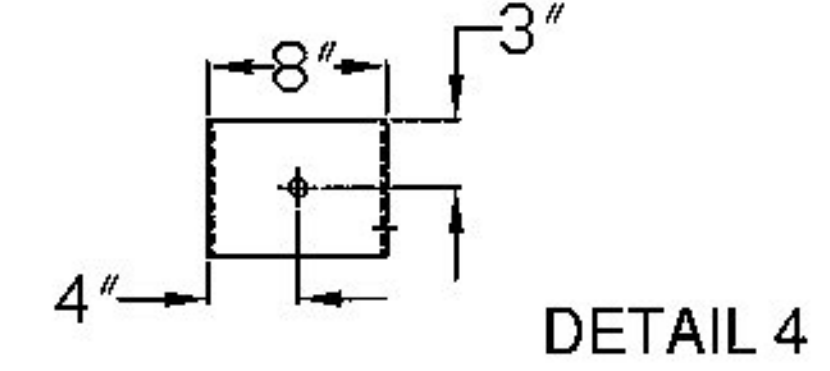
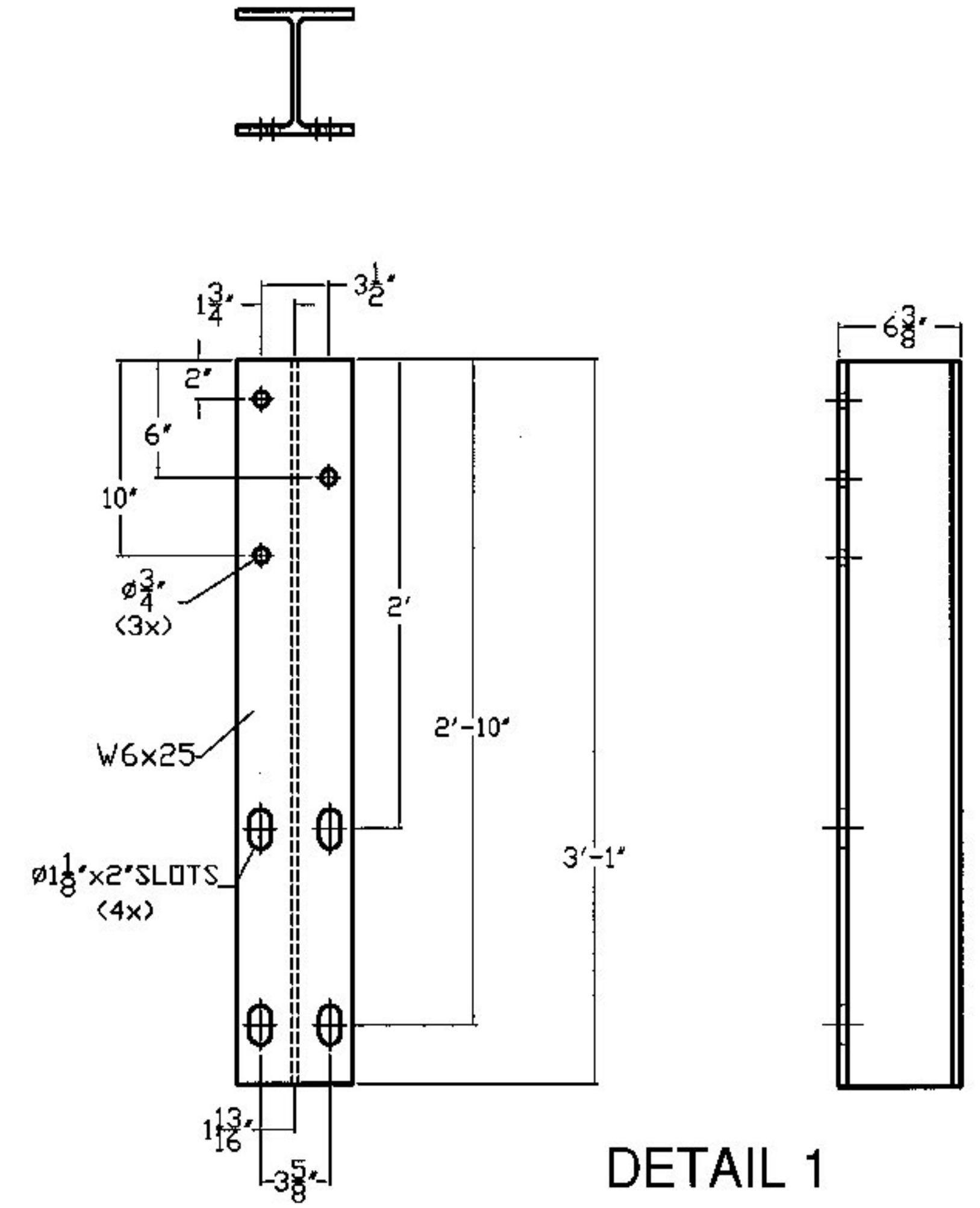

DETAIL 1

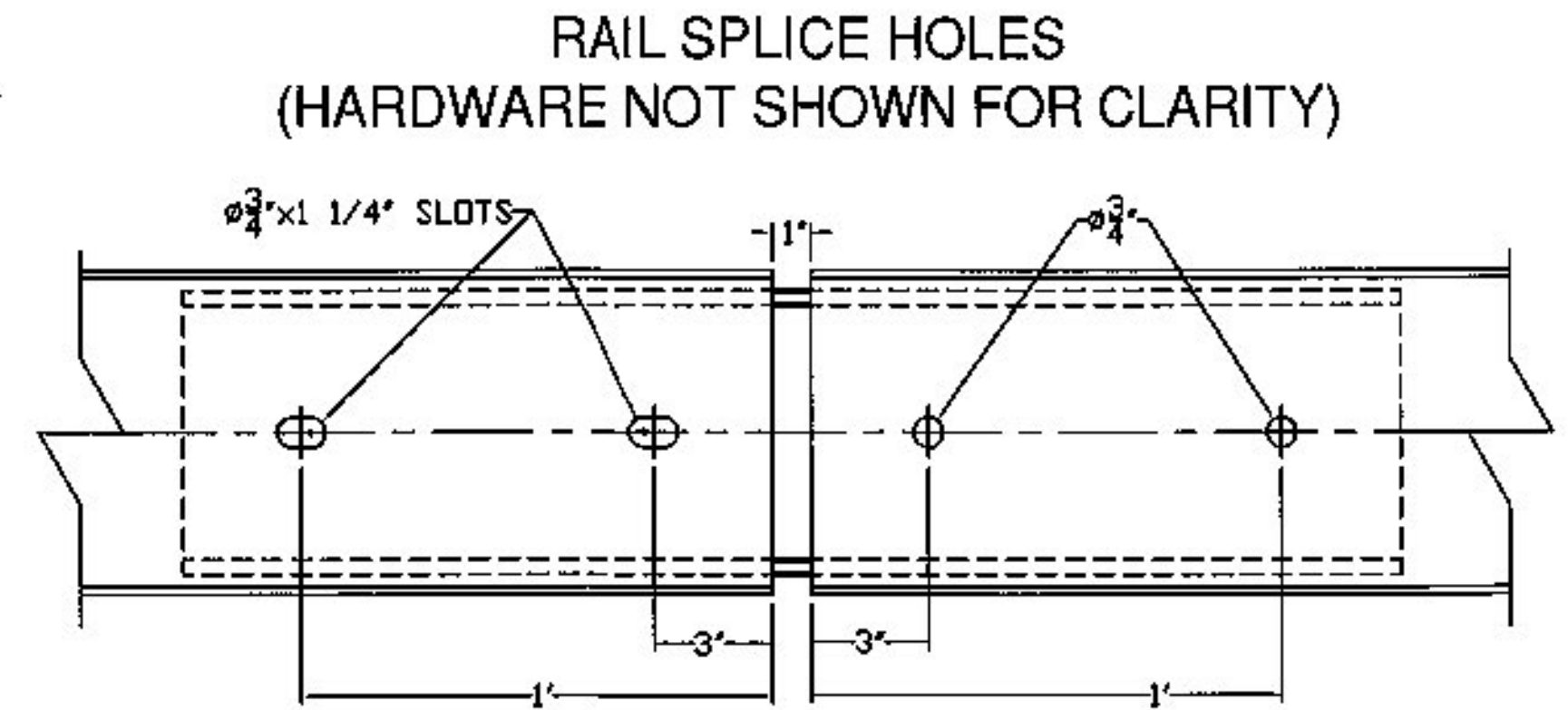

- NOTES:
1. - ALL WORK AND MATERIALS SHALL CONFORM TO SECTION 525.
 2. - PRIOR TO GALVANIZING THE ASSEMBLED POST, GRIND ALL EDGES TO A MINIMUM RADIUS OF 1/16".
 3. - ALL POSTS SHALL BE SET NORMAL TO GRADE.
 4. - SPLICES FOR THE STEEL BEAM GUARDRAIL SHALL LAP IN THE DIRECTION OF TRAFFIC.
 5. - A RAILING JOINT SPLICE SHALL BE PROVIDED IN ANY RAIL BAY SPANNING THE END OF THE INTEGRAL ABUTMENT BRIDGE AND AT ALL SUPERSTRUCTURE EXPANSION JOINTS.
 6. - SEE STANDARD DRAWING G-1 FOR DETAILS OF DELINEATORS. A DELINEATOR SHALL BE INSTALLED AT 30 FOOT SPACING OR THE NEAREST POST. WHITE IS TO BE INSTALLED ON THE DRIVER'S RIGHT. FOR ONE WAY BRIDGES, YELLOW IS TO BE INSTALLED ON THE DRIVER'S LEFT.
 7. - THE 1/2" EXPANSION JOINT SHOWN IN THE RAILING ELEVATION IS DESIGNED FOR THE BRIDGE LENGTHS UP TO 80 FEET, ANY LONGER SPANS WILL HAVE TO BE MODIFIED TO ACCOUNT FOR THEIR MOVEMENT.
 8. - FOR RADII LESS THAN 950 FEET, HSS8x4 TUBES SHALL BE SHOP BENT TO FIT THE APPLICABLE CURVE.
 9. - THIS RAILING MEETS THE REQUIREMENTS FOR A TL-2 SERVICE LEVEL.

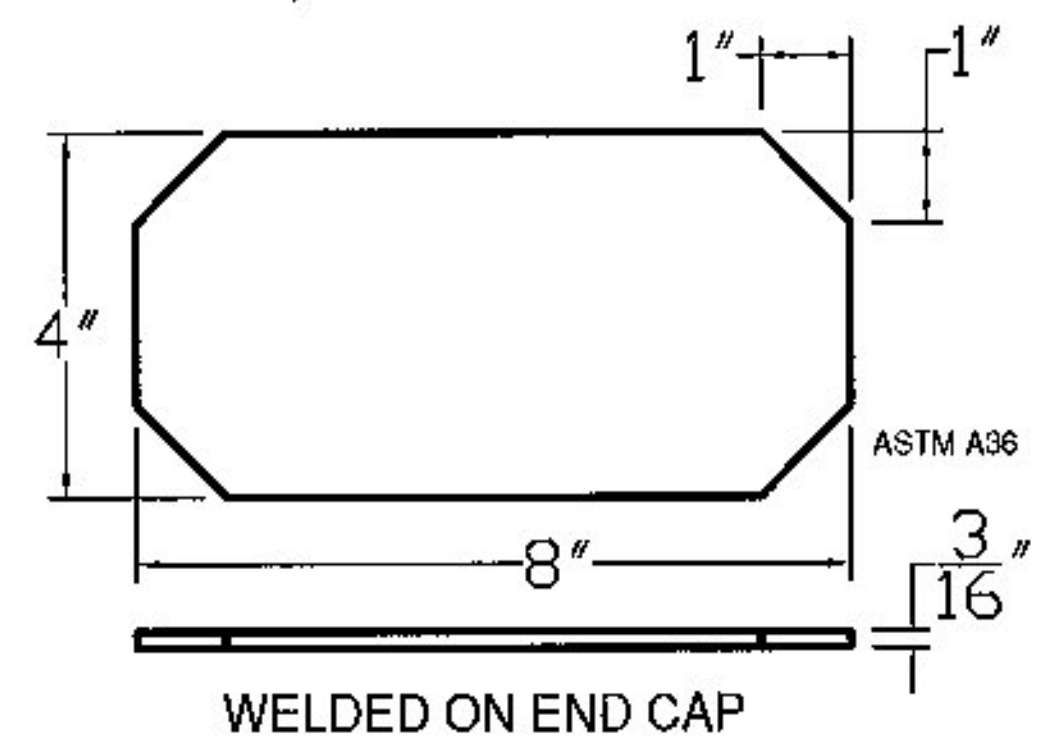

WELDED ON END CAP

ITEM #: 900.640

CONTRACTOR: F R LaFayette - 27795

SHEET 2 OF 2

APPROVED BY:
RECEIVED
 VERMONT AGENCY OF TRANSPORTATION
 CK'D BY JTS OK'D BY
 July 15, 2013
 RESUBMIT NO Approved As Noted
 BY KMH DATE 7-16-2013

Special Provision Fascia Mounted Steel Bridge Rail
 Town of Woodstock County of Windsor Bridge No. 13

R NO.	DATE	DESCRIPTION	BY	R NO.	DATE	DESCRIPTION	BY
E 1	5/28/13	Added 4x W6x25 Post @ 6'-0", one for Each Corner	D.L.	E			
V 2	7/3/13	Implemented Revisions per J.S. on June 25, 2013	D.L.	V			

ELDERLEE, INC.
 OAKS CORNERS, NEW YORK 14518
 E-Mail: dlong@elderlee.com
 Tel: 315-789-6670 Fax: 315-789-6615

DRAWN	D.L.	5/20/13
CHECKED	E.P.	5/20/13
APPROVED		
SCALE	SCHEMATIC	
DRAWING NO. F R LAFAYETTE EM13-064R		