

SEE SHEET 2 FOR
INDEX OF SHEETS
AND LIST OF STANDARDS

STATE OF VERMONT AGENCY OF TRANSPORTATION



PROPOSED IMPROVEMENT BRIDGE PROJECT TOWN OF BRAINTREE COUNTY OF ORANGE

ROUTE NO : TH 23 CLASS III BRIDGE NO : 12

PROJECT LOCATION : LOCATED ON TH 23 APPROXIMATELY 0.1 MILES
FROM ITS JUNCTION WITH VT ROUTE 12.

PROJECT DESCRIPTION : REPLACEMENT OF BRIDGE 12 WITH RELATED ROADWAY
APPROACH WORK.

LENGTH OF STRUCTURE : 70 FEET.
LENGTH OF ROADWAY : 80 FEET.
LENGTH OF PROJECT : 150 FEET.

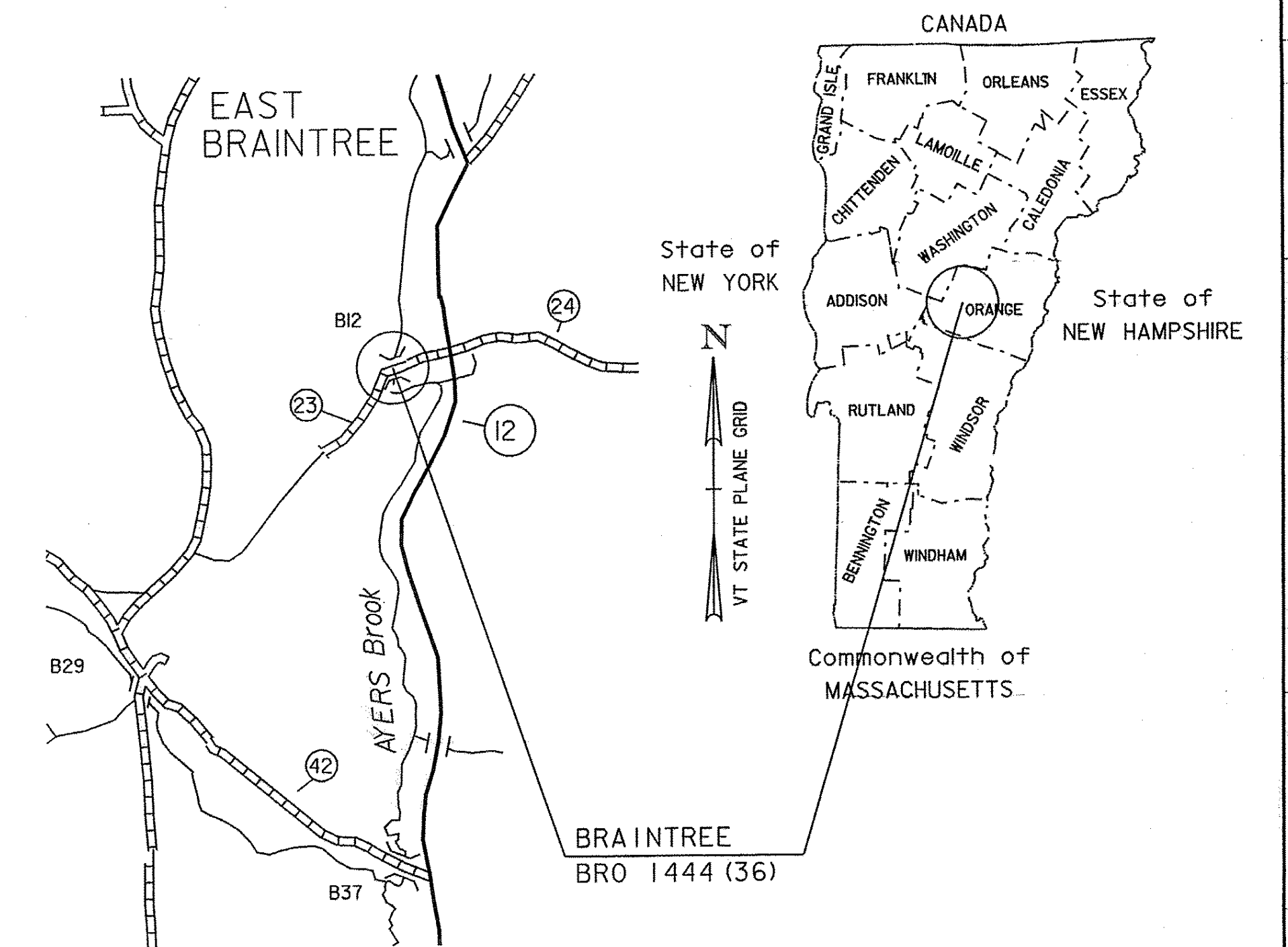

RECORD PLANS	
CONTRACTOR:	RENAUD BROTHERS, INC. - VERNON, VT
RESIDENT ENGINEER:	JEREMY REED
CONSTRUCTION BEGAN:	SEPTEMBER 14, 2010
CONSTRUCTION COMPLETE:	OCTOBER 13, 2010
RECORD PLANS BY:	JEREMY REED & NICK GARBACIK
I HEREBY CERTIFY THAT ALL THE CONSTRUCTION REQUIRED BY THIS SET OF DRAWINGS HAS BEEN ACCOMPLISHED AS INDICATED HEREIN.	
BY:	<i>Jeremy Reed</i> RESIDENT ENGINEER
DATE:	3/30/2013
NOTE: Any further information concerning final quantities, amounts or other details relative to this project may be found at Central Files in the electronic archives.	

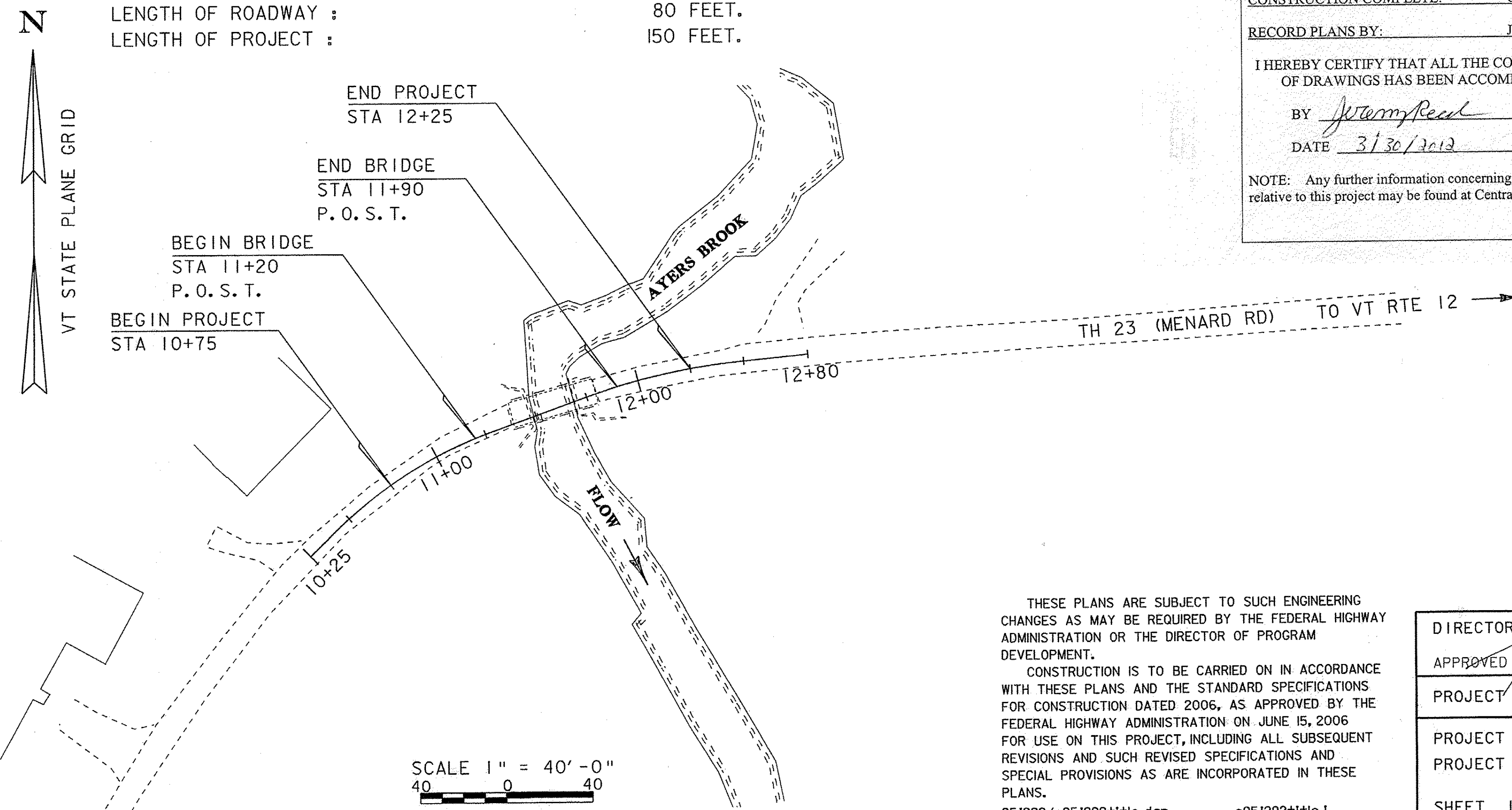

CONVENTIONAL SYMBOLS	
COUNTY LINE	— — — — —
TOWN LINE	— — — — —
LIMITS OF ACCESS	— o — o — o — o —
POINT OF ACCESS	X
FENCE LINE	X — X — X — X —
STONE WALL	o — o — o — o — o — o — o — o —
TRAVELED WAY	— — — — —
GUARD RAIL	o — o — o — o — o — o — o — o —
RAILROAD	— — — — —
SURVEY LINE	— — — — —
CULVERT	— — — — —
POWER POLE	⊕
TELEPHONE POLE	⊕
TREES	⊕
CONTROL OF ACCESS	— — — — —
PROPERTY LINE	— — — — —
R.O.W. TAKING LINE	— — — — —
SLOPE RIGHTS	— SR — SR — SR —
TOP OF CUT	— — — — —
TOE OF SLOPE	— — — — —

SURVEYED BY : GILMAN/MOREAU
SURVEYED DATE : 10/03/1996
DATUM
VERTICAL NAVD 88
HORIZONTAL NAD 83 (92)

THESE PLANS ARE SUBJECT TO SUCH ENGINEERING CHANGES AS MAY BE REQUIRED BY THE FEDERAL HIGHWAY ADMINISTRATION OR THE DIRECTOR OF PROGRAM DEVELOPMENT.
CONSTRUCTION IS TO BE CARRIED ON IN ACCORDANCE WITH THESE PLANS AND THE STANDARD SPECIFICATIONS FOR CONSTRUCTION DATED 2006, AS APPROVED BY THE FEDERAL HIGHWAY ADMINISTRATION ON JUNE 15, 2006 FOR USE ON THIS PROJECT, INCLUDING ALL SUBSEQUENT REVISIONS AND SUCH REVISED SPECIFICATIONS AND SPECIAL PROVISIONS AS ARE INCORPORATED IN THESE PLANS.
95J292/s95J29211He.dgn s95J29211He.J

DIRECTOR OF PROGRAM DEVELOPMENT
APPROVED *Richard Johnson* DATE 12-29-09
PROJECT MANAGER : K.M. HIGGINS
PROJECT NAME : BRAINTREE
PROJECT NUMBER : BRO 1444 (36)
SHEET 1 OF 26 SHEETS