

TYPICAL ABUTMENT PLAN

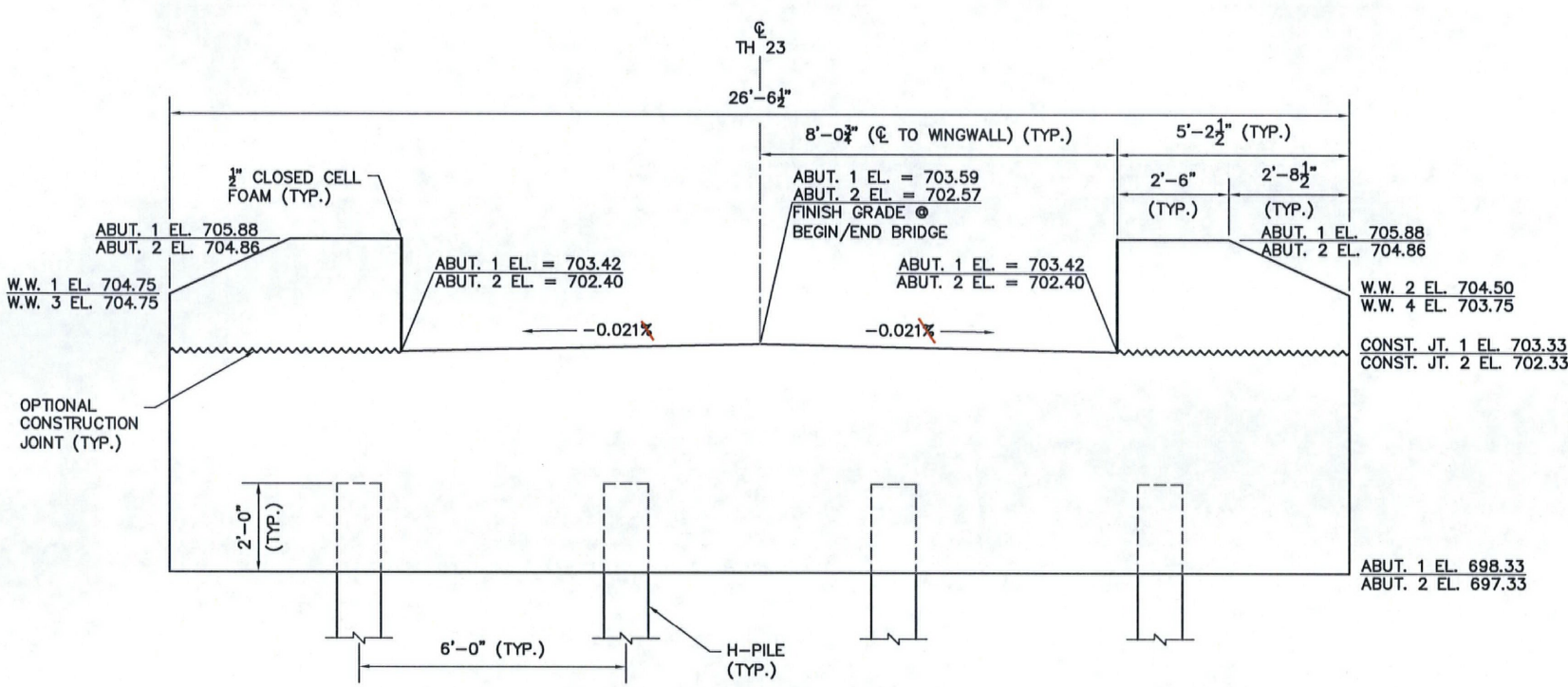

TYPICAL ABUTMENT ELEVATION

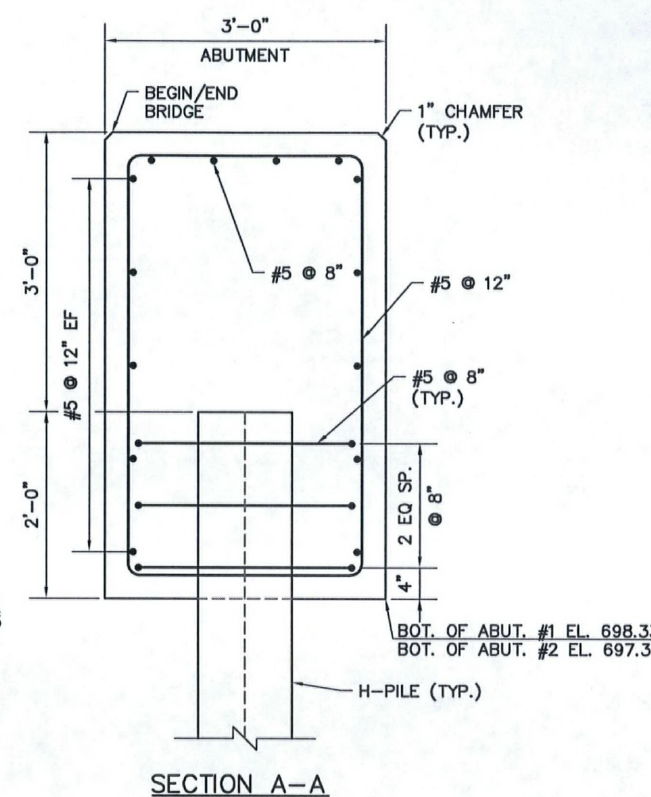

SECTION A-A

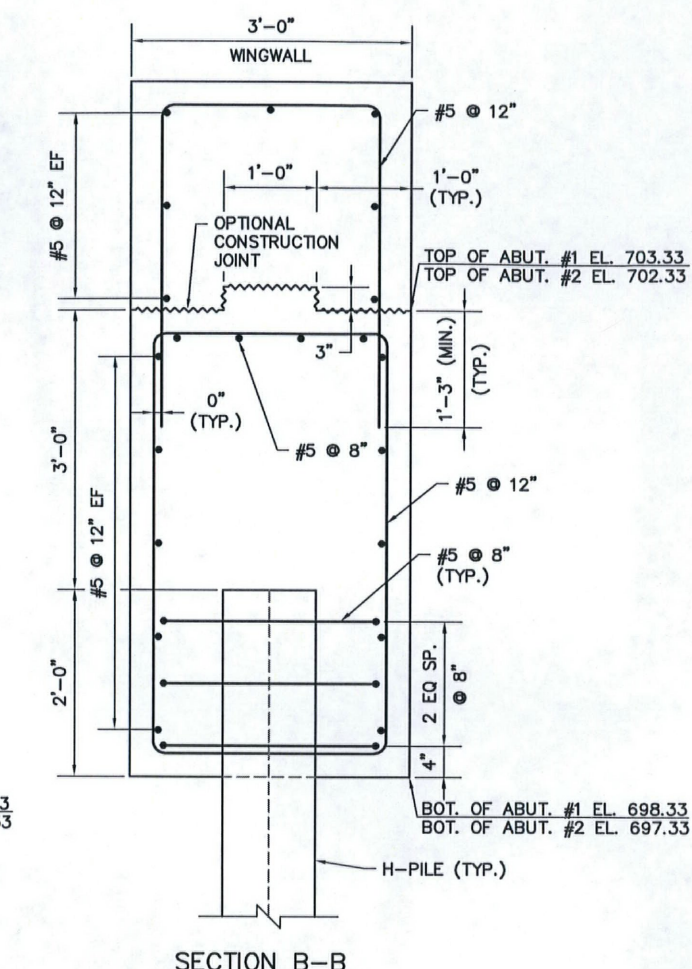

SECTION B-B

Vermont Agency of Transportation  
**RECEIVED**  
 CK'D BY TCF OK'D BY KMH  
 10:04 am, Jul 8, 2010  
 RESUBMIT APPROVED AS NOTED  
 BY KMH DATE 7-12-10

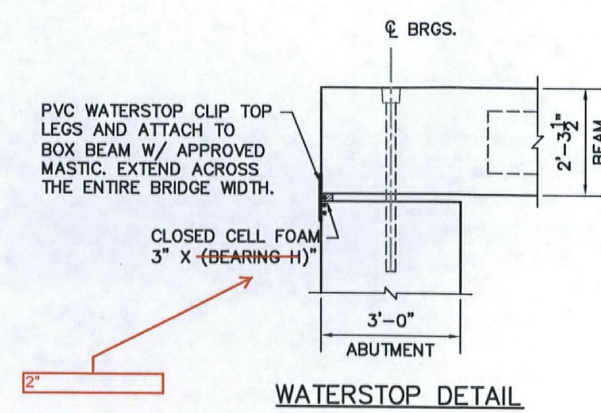

WATERSTOP DETAIL

NOTE:  
 1. LAP LENGTH FOR ALL #5 BARS SHALL BE 2'-2"  
 2. ALL CONCRETE SHALL BE HIGH PERFORMANCE CLASS B MEETING SECTION 501 OF THE STANDARD SPECIFICATIONS FOR CONSTRUCTION