

### TEMPORARY DETOUR TYPICALS

**CURVE NO. 3 DATA**

$\Delta = 16^{\circ}00'00''$  LT  
 $R = 160,000$  m  
 $T = 22,487$  m  
 $L = 44,680$  m  
 $E = 1,572$  m  
 BANK = 7.5 % MAX.

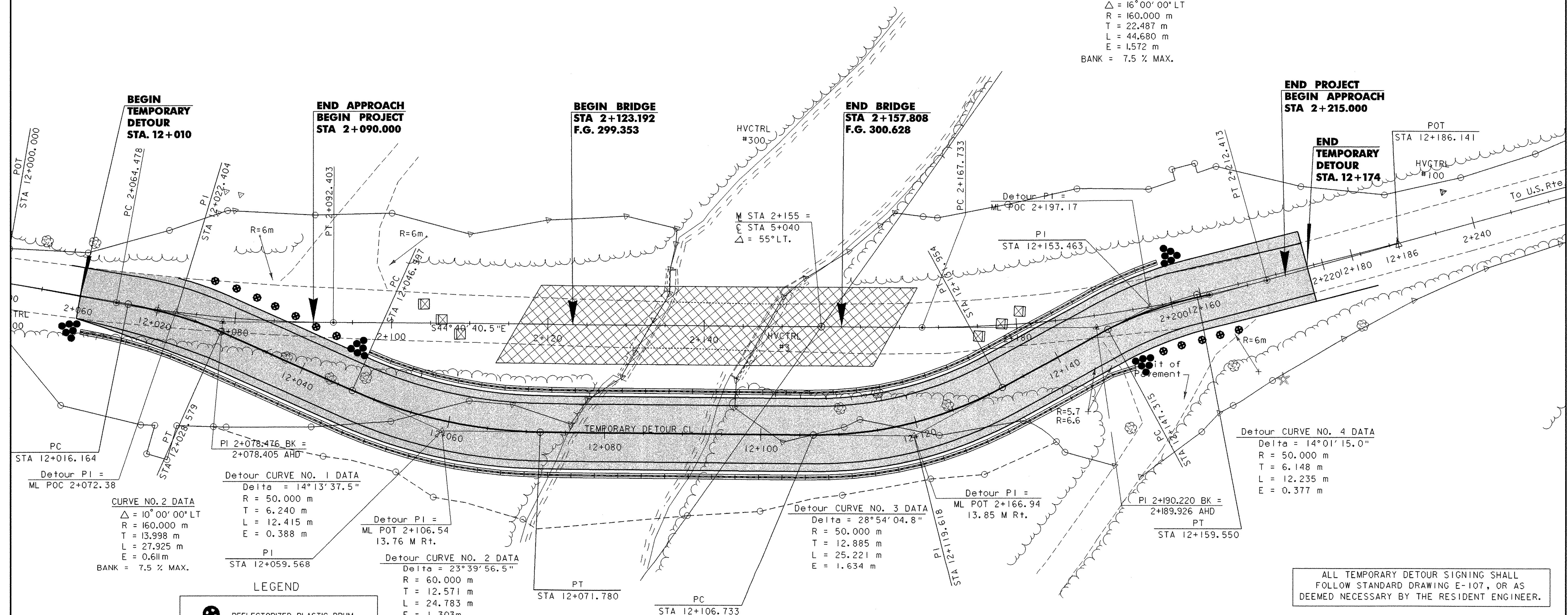

**END PROJECT  
BEGIN APPROACH  
STA 2+215.000**

**END  
TEMPORARY  
DETOUR  
STA. 12+174**

**Detour CURVE NO. 4 DATA**  
 $\Delta = 14^{\circ}01'15.0''$   
 $R = 50,000$  m  
 $T = 6,148$  m  
 $L = 12,235$  m  
 $E = 0,377$  m

**CURVE NO. 2 DATA**  
 $\Delta = 10^{\circ}00'00''$  LT  
 $R = 160,000$  m  
 $T = 13,998$  m  
 $L = 27,925$  m  
 $E = 0,611$  m  
 BANK = 7.5 % MAX.

**Detour CURVE NO. 1 DATA**  
 $\Delta = 14^{\circ}13'37.5''$   
 $R = 50,000$  m  
 $T = 6,240$  m  
 $L = 12,415$  m  
 $E = 0,388$  m

**Detour CURVE NO. 2 DATA**  
 $\Delta = 23^{\circ}39'56.5''$   
 $R = 60,000$  m  
 $T = 12,571$  m  
 $L = 24,783$  m  
 $E = 1,303$  m

**Detour CURVE NO. 3 DATA**  
 $\Delta = 28^{\circ}54'04.8''$   
 $R = 50,000$  m  
 $T = 12,885$  m  
 $L = 25,221$  m  
 $E = 1,634$  m

**LEGEND**

- REFLECTORIZED PLASTIC DRUM
- SIGN AND POSTS
- WORK AREA
- TYPE III BARRICADES
- TYPE III BARRICADES (MOD)
- TEMP. TRAFFIC BARRIER
- ENERGY ABSORPTION ATTENUATOR (SAND FILLED BARRELS)

**DATUM**  
 VERTICAL NAVD 88  
 HORIZONTAL NAD 83/92

ALL TEMPORARY DETOUR SIGNING SHALL FOLLOW STANDARD DRAWING E-107, OR AS DEEMED NECESSARY BY THE RESIDENT ENGINEER.

### TEMPORARY DETOUR

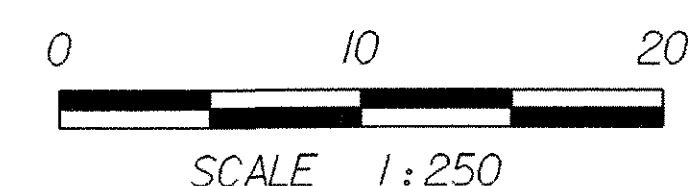

PROJECT: <b>MENDON</b>	PROJECT NO.: <b>BRO 1443(35)</b>
DESIGN FILE NAME: /str5/95j290/sj290bdr.dgn	PLOT DATE: 18-NOV-2005
IPARM FILE NAME: SJ290det.i	SURVEY DATE: 2/96
SURVEYED BY: L. ORVIS	DRAWN BY: R.H.PELLETT
SQUAD LEADER: C. KELLER	SHEET: 20 OF 94
TEMPORARY DETOUR SHEET	