

* REUSE SIGNS AND POSTS FOR TEMPORARY TRAFFIC DETOUR. SEE SHEET 40 FOR SIGN LOCATIONS.

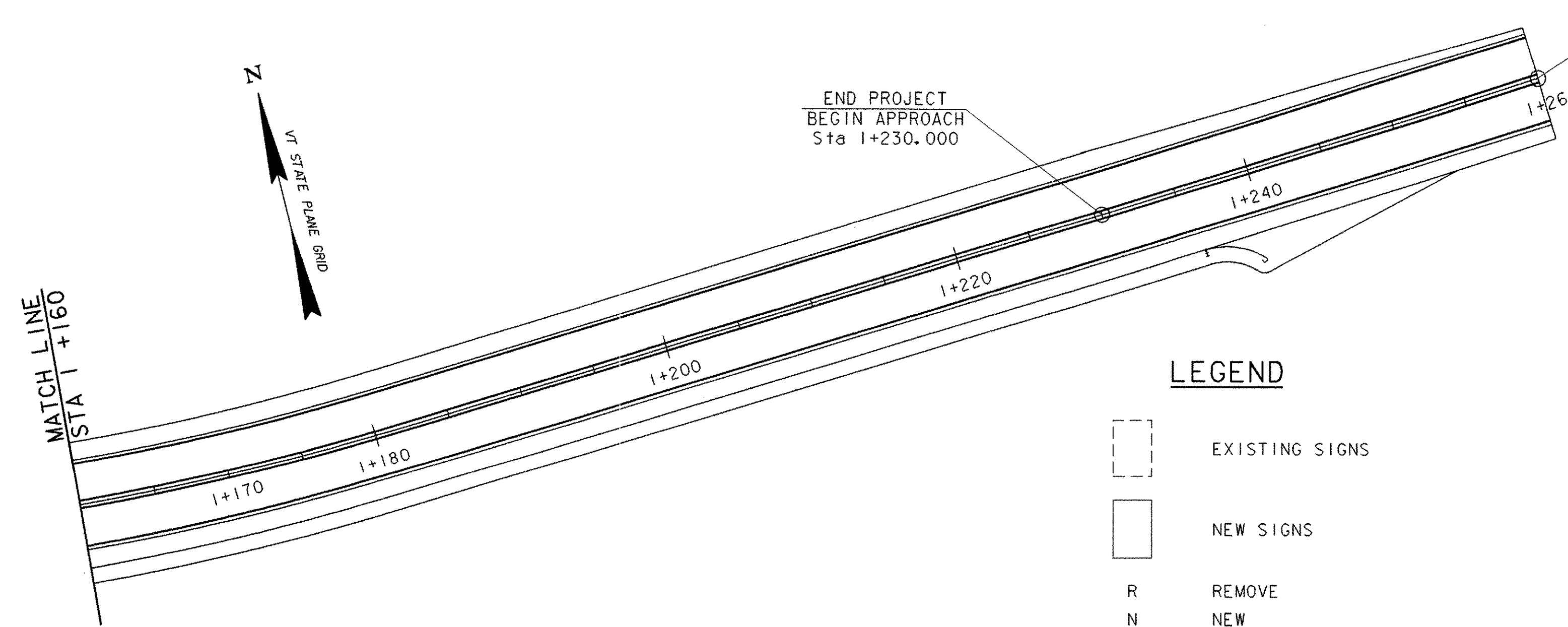

- 100mm YELLOW LINE (DOUBLE LINE)**
 STA 1+006.466 - STA 1+138
 STA 1+150 - STA 1+260
 § STA 2+006.1 - § STA 2+020
- 600mm STOP BAR**
 STA 1+072.5 LT
 STA 1+087.5 LT
 § STA 2+006.1 LT
- LETTERS**
 STA 2+008 (STOP)
- RAILROAD CROSSING SYMBOL**
 STA 1+080.0 LT
- TRAFFIC SIGNS, TYPE A**
 STA 1+066.7 LT - 1 EACH
 STA 1+080.0 LT - 1 EACH
 § STA 2+010.3 LT - 1 EACH
- REMOVING SIGNS**
 STA 1+068.7 LT - 2 EACH
 * STA 1+130.0 LT - 1 EACH
 * § STA 2+011.1 LT - 3 EACH
- ERECTING SALVAGED SIGNS**
 § STA 2+010.3 LT - 2 EACH

LEGEND

- EXISTING SIGNS
- NEW SIGNS
- R REMOVE
- N NEW
- R&S REMOVE & SALVAGE
- S SALVAGE

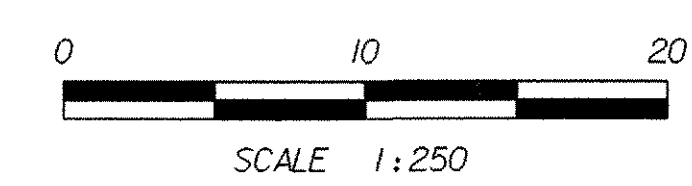
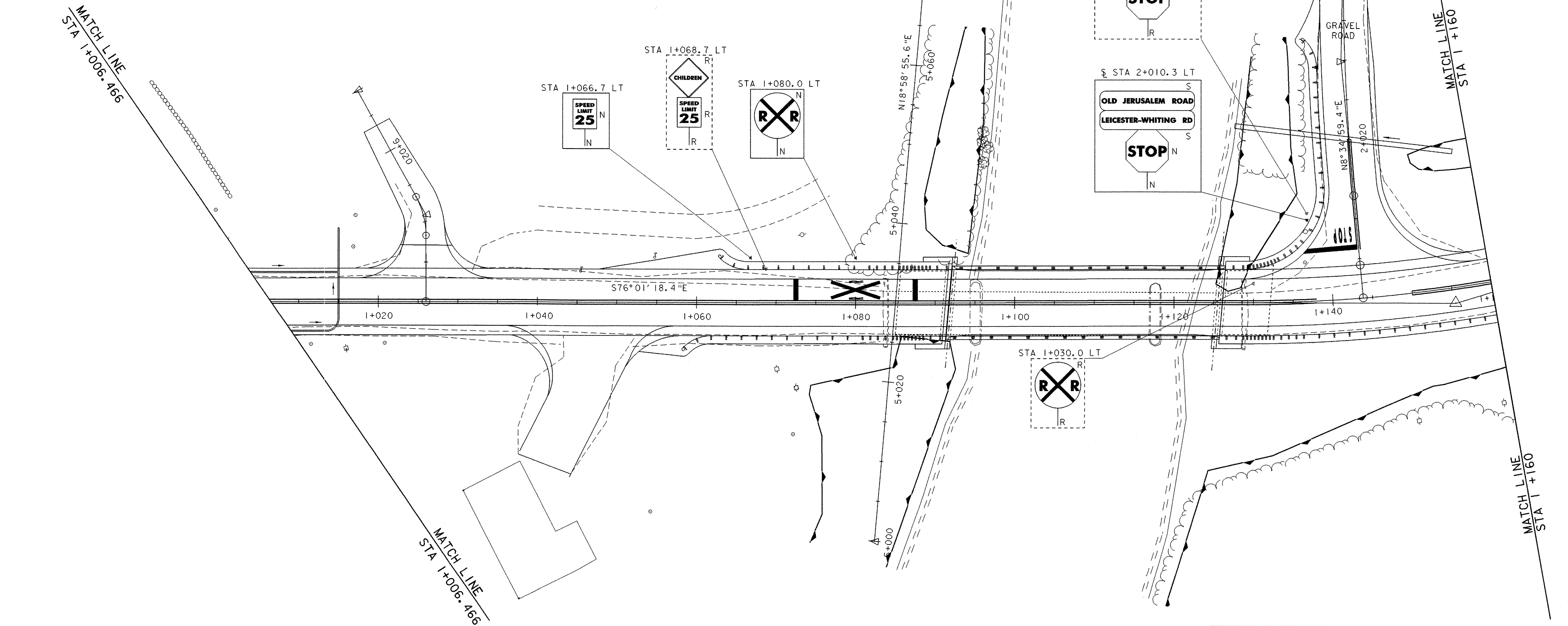

SHEET NAME: LINE STRIPING AND SIGN LAYOUT (2)	
PROJECT NAME: LEICESTER	HIGHWAY NO.: FAS 0160
PROJECT NUMBER: BRF 0160(3)S	BRIDGE NO.: 6
	OVER: OTTER CREEK
FILE NAME: 95j288\Structures\sj288bdr.dgn	DATE: 17-AUG-2005
PROJECT MANAGER: R. R. WHITCOMB	DRAWN BY: J. GILMORE
DESIGNED BY: C. CARLSON	IPARM NAME: sj088sg2.1
BRIDGE SHEET NUMBER:	SHEET 37 OF 90