

CONSTRUCT ACCESS
STA. 1+019.099 LT (60° ASKEW)

GUARD RAIL - HEAVY DUTY STEEL BEAM
W/ WOOD POSTS, WEATHERING

STA. 1+029.100 - 1+035.59 LT.
STA. 1+031.80 - 1+035.59 RT.
STA. 1+060.36 - 1+073.36 LT.
STA. 1+060.36 - 1+073.26 RT.

BRIDGE RAILING - HEAVY DUTY
STEEL BEAM/CURB MOUNTED/HANDRAIL (MOD)

STA. 1+035.59 - 1+060.36 LT.
STA. 1+035.59 - 1+060.36 RT.

MANUFACTURED TERMINAL END DETAIL
(TANGENT)(MOD.)

STA. 1+016.18 - 1+031.80 RT.

ANCHOR FOR STEEL BEAM RAIL

STA. 1+031.000 LT.
STA. 1+071.40 LT. & RT.

THE SEDIMENT SETTLING BASIN WILL BE LINED WITH IMPERVIOUS MEMBRANE AND ALL WATERS DISCHARGED FROM THE SETTLEMENT BASIN WILL BE PIPED BACK TO THE STREAM. THESE PRECAUTIONS ARE TO INSURE THAT THIS WATER WILL NOT CONTAMINATE THE WELL AT STA 1+093.3 12.5m LT.

VT. STATE PLANE GRID

**BEGIN R.O.W. PROJECT
BRO 1443 (34)
STA. 1+027.1 7.3M(24')LT.**

**①
GRIFFITH, JAMES
&
WINSLOW, MICHAEL**

**END R.O.W. PROJECT
BRO 1443 (34)
STA. 1+090.7 7.3M(24')LT.**

**②
ROBICHAUD,
GILBERT H. & APRIL L.**

**③
HESSE, PAMELA L.**

**④
COSTANTINO, ANTHONY R.
& BONITA L.**

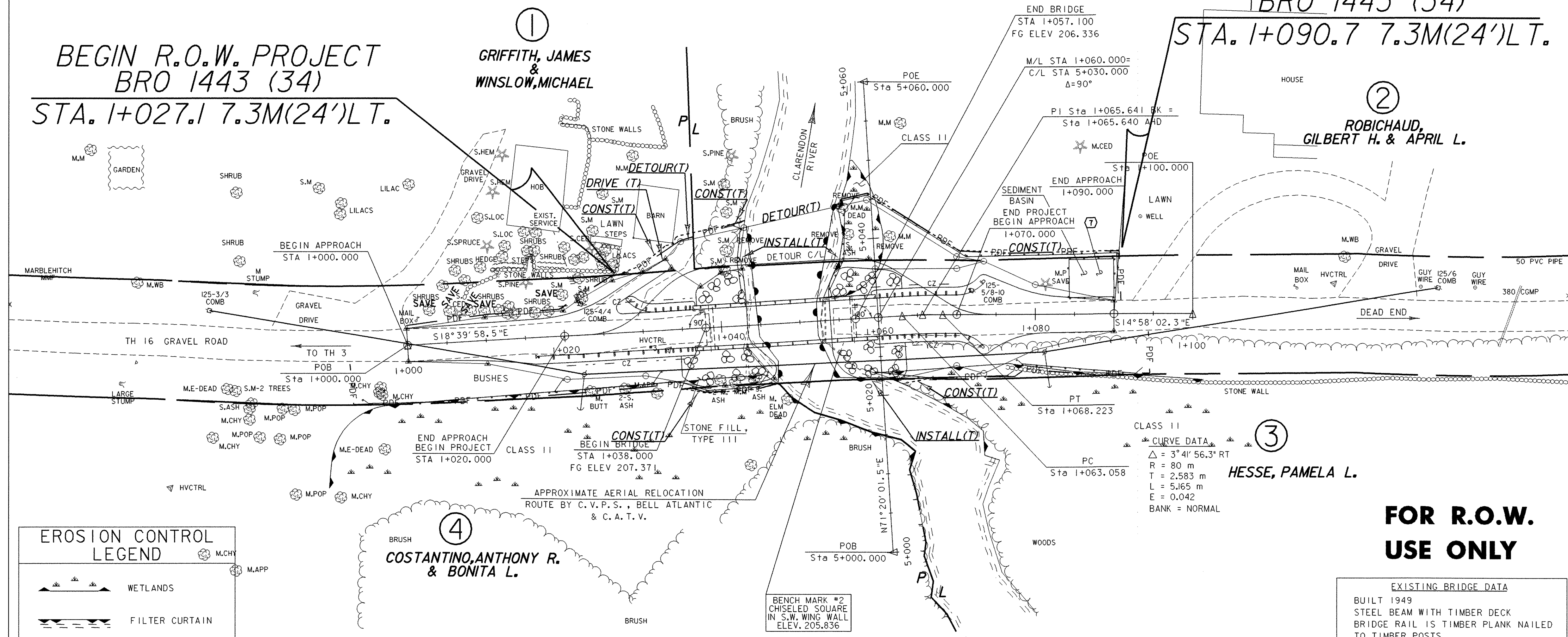

CLASS II
CURVE DATA
Δ = 3° 41' 56.3" RT
R = 80 m
T = 2.583 m
L = 5.165 m
E = 0.042
BANK = NORMAL

BENCH MARK #2
CHISELED SQUARE
IN S.W. WING WALL
ELEV. 205.836

**EROSION CONTROL
LEGEND**

- WETLANDS
- FILTER CURTAIN
- SILT FENCE
- HAY BALES
- STONE FILL, TYPE I
- STONE FILL, TYPE II

NOTE:
THE RESIDENT ENGINEER WILL TRY TO SAVE AS MANY SHRUBS AS POSSIBLE THAT ARE NOT ALREADY MARKED AS "SAVE."

NOTE: ALL UTILITY EASEMENTS HAVE BEEN ACQUIRED BY THE UTILITY COMPANIES.

⑤ LINE SEDIMENT BASIN WITH PLASTIC & PIPE WATER BACK TO RIVER

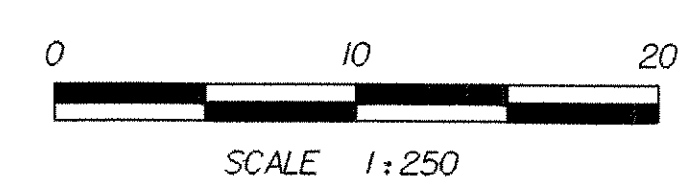

LINES SHOWN ON THIS PLAN AS EXISTING PROPERTY LINES P/L ARE BELIEVED TO BE ACCURATE BUT SHOULD NOT BE RELIED UPON FOR PURPOSES UNRELATED TO THE TOWN OF CLARENDON'S ACQUISITION OF LAND AND RIGHTS FOR THIS PROJECT.

**FOR R.O.W.
USE ONLY**

EXISTING BRIDGE DATA
BUILT 1949
STEEL BEAM WITH TIMBER DECK
BRIDGE RAIL IS TIMBER PLANK NAILED TO TIMBER POSTS
DECK WIDTH = 4298
SPAN LENGTH = 12 497
ABUTMENT NO. 1 IS LAID UP STONE
ABUTMENT NO. 2 IS CONCRETE
* TEMPORARY "MABEY" BRIDGE IS IN PLACE OVER EXISTING BRIDGE.

SHEET NAME: LAYOUT SHEET		
PROJECT NAME: CLARENDON	HIGHWAY NO.: TH 16	
PROJECT NUMBER: BRO 1443(34)	BRIDGE NO.: 24	
	OVER: CLARENDON RIVER	
FILE NAME: /PW/95j286/sj286bdr.dgn	PLOT DATE: 01-DEC-2005	
PROJECT MANAGER: R. WHITCOMB	DRAWN BY: J. GILMORE	
DESIGNED BY: C. CARLSON	IPARM NAME: sj286lcl1	
R.O.W. SHEET 6 OF 6 SHEETS	SHEET 7 OF 43 SHEETS	