

75B URBAN LAND-COLTON-CROGHAN  
WITH 0% TO 8% SLOPES  
"K FACTOR" = 0.17

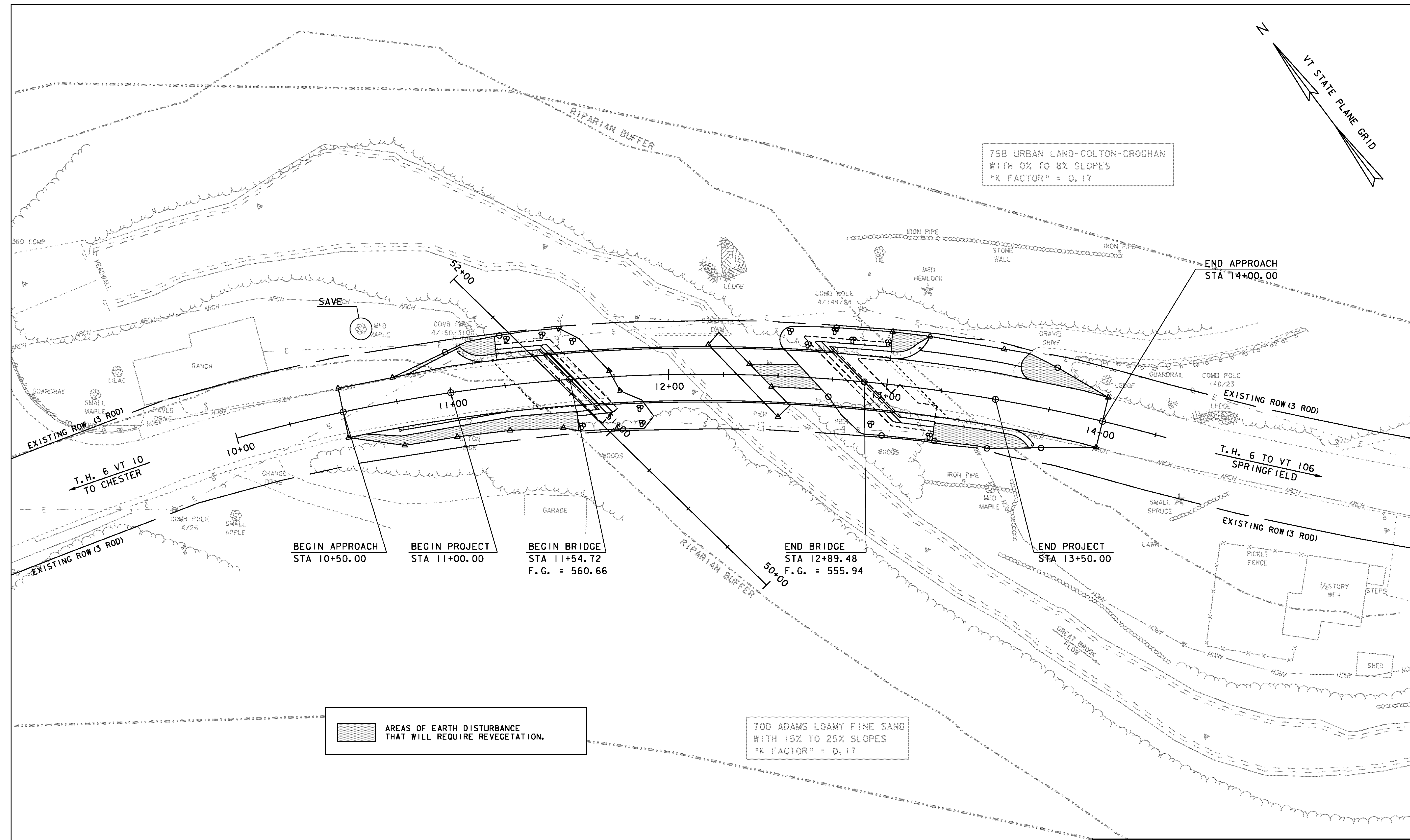

AREAS OF EARTH DISTURBANCE  
THAT WILL REQUIRE REVEGETATION.

70D ADAMS LOAMY FINE SAND  
WITH 15% TO 25% SLOPES  
"K FACTOR" = 0.17

**EPSC FINAL CONDITIONS**

SCALE 1" = 20'-0"  
20 0 20

75B URBAN LAND-COLTON-CROGHAN  
WITH 0% TO 8% SLOPES  
"K FACTOR" = 0.17

|                 |              |                       |                     |             |              |
|-----------------|--------------|-----------------------|---------------------|-------------|--------------|
| PROJECT NAME:   | SPRINGFIELD  | FILE NAME:            | s95j282EPSC_BDR.dgn | PLOT DATE:  | 30-AUG-2011  |
| PROJECT NUMBER: | BRO 1442(26) | PROJECT LEADER:       | K. HIGGINS          | DRAWN BY:   | R. PELLETT   |
|                 |              | DESIGNED BY:          | J. LACROIX          | CHECKED BY: | J. SALVATORI |
|                 |              | EPSC FINAL CONDITIONS |                     | SHEET       | 40 OF 52     |