

SEE SHEET 2 FOR INDEX OF SHEETS
AND LIST OF STANDARDS.

STATE OF VERMONT AGENCY OF TRANSPORTATION

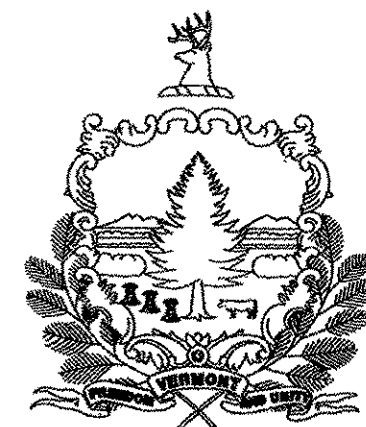

PROPOSED IMPROVEMENT BRIDGE PROJECT TOWNS OF BROOKLINE AND NEWFANE COUNTY OF WINDHAM

ROUTE NO : T.H.1 / T.H.4, CLASS 2 BRIDGE NO : 19 (BROOKLINE)

PROJECT LOCATION : BEGINNING AT A POINT ON T.H.4 APPROXIMATELY 0.823 KILOMETERS EASTERLY FROM THE EXISTING INTERSECTION OF T.H.4 AND VT.30 AND PROCEEDING EASTERLY 0.13 KILOMETERS ALONG T.H.4/T.H.1.

PROJECT DESCRIPTION : REHABILITATION OF THE EXISTING BRIDGE INCLUDING RELATED APPROACH ROADWAY AND CHANNEL WORK.

LENGTH OF STRUCTURE : 59.111 METERS.
LENGTH OF ROADWAY : 70.889 METERS.
LENGTH OF PROJECT : 130.000 METERS.

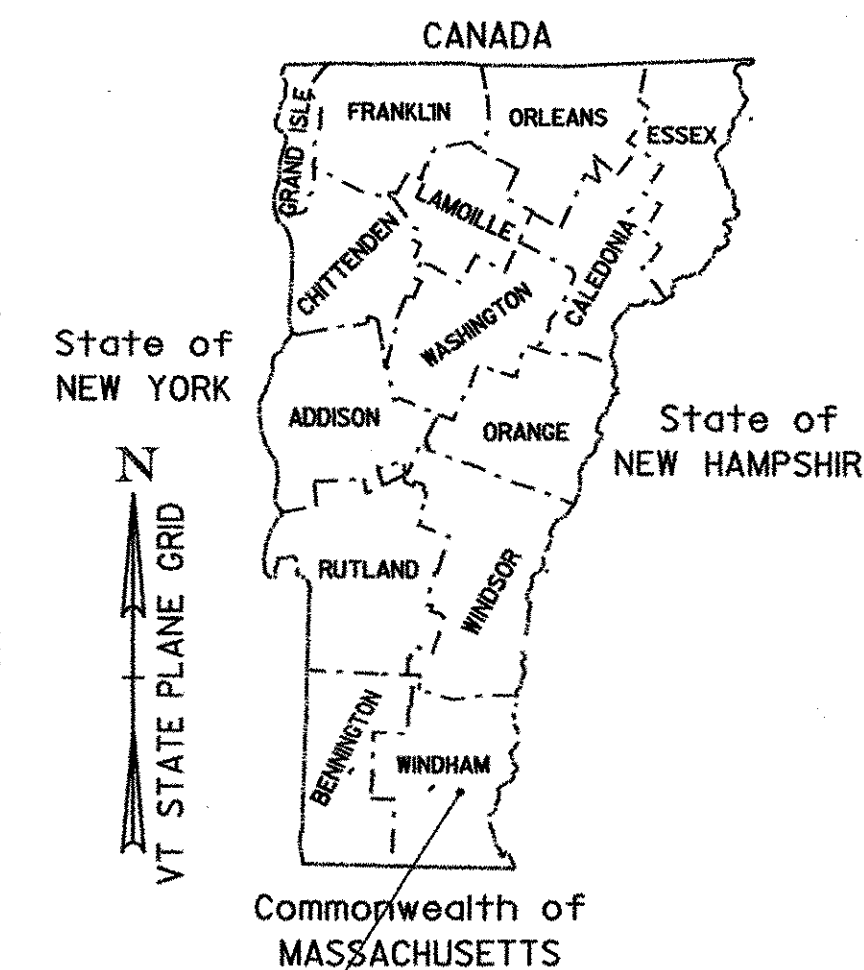
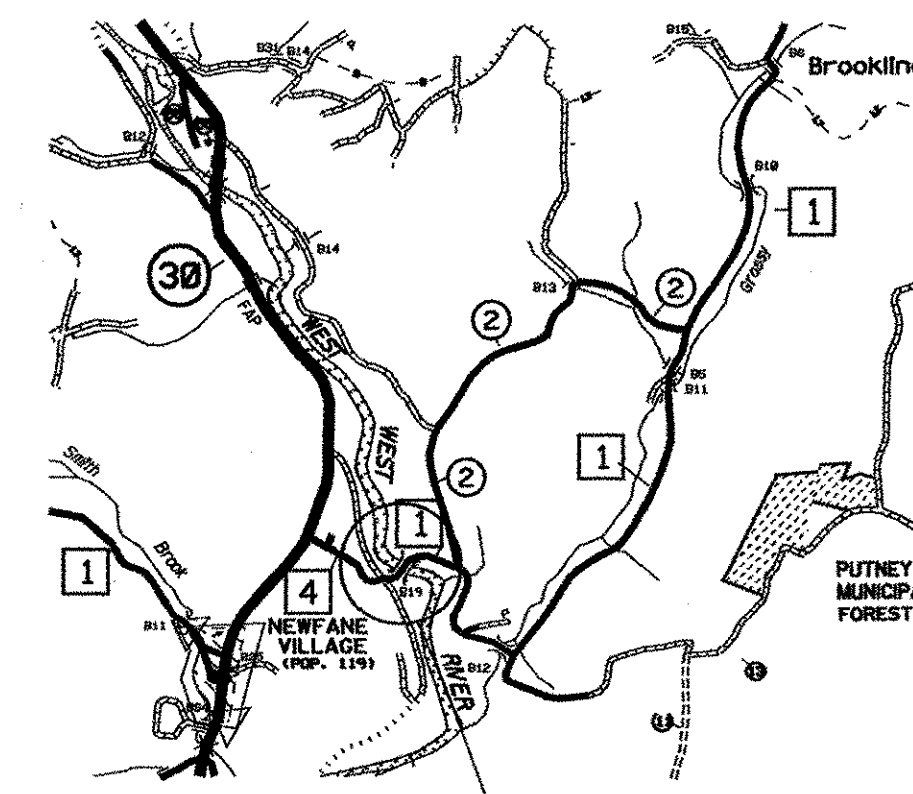

BROOKLINE-NEWFANE BHO 1442 (25)
T.H.1/T.H.4, CLASS 2, BR 19

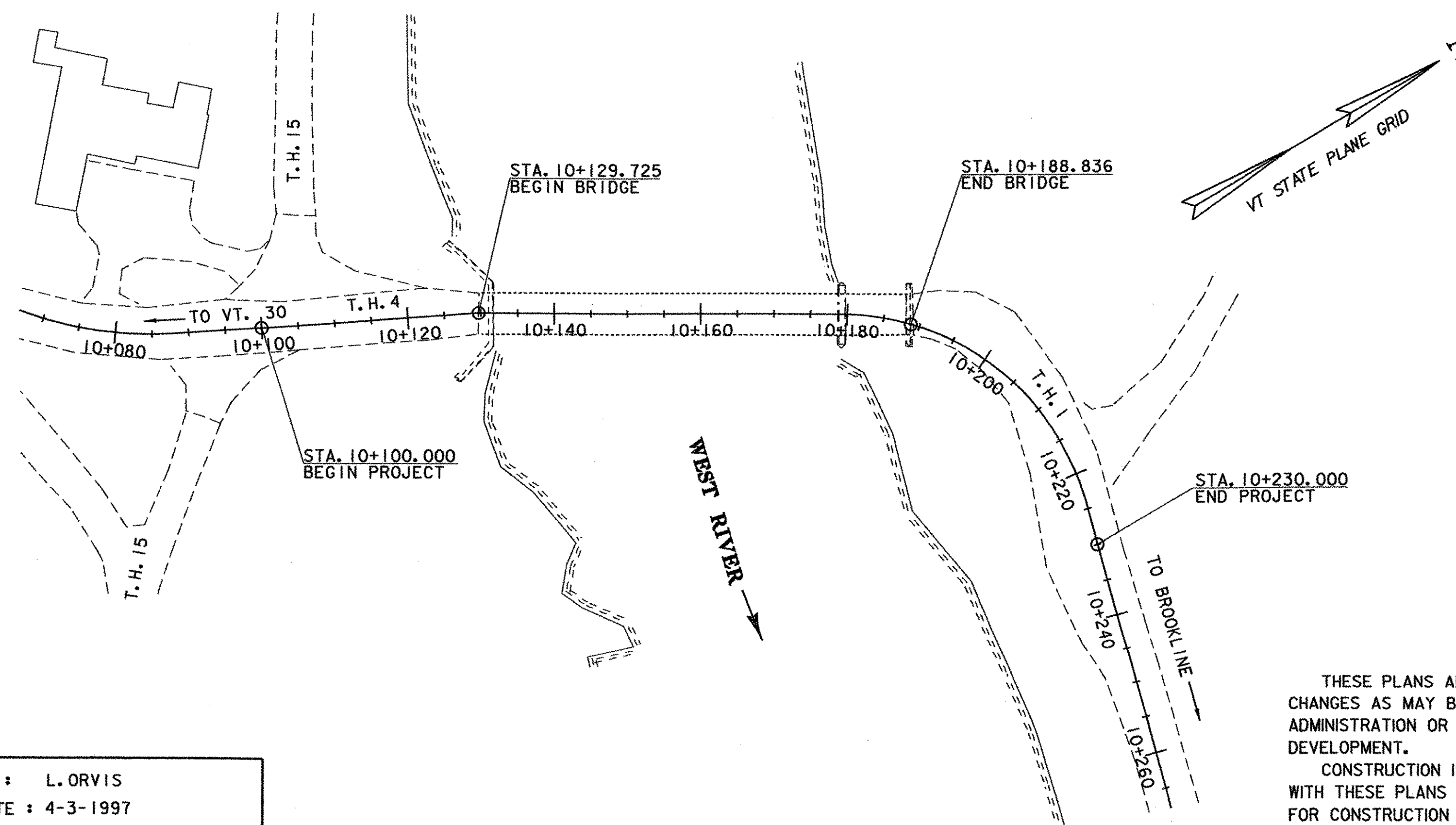

RECORD PLANS	
CONTRACTOR:	RENAUD BROS., INC. - VERNON, VT
RESIDENT ENGINEER:	PAUL PERRY
CONSTRUCTION BEGAN:	SEPTEMBER 15, 2003
CONSTRUCTION COMPLETE:	DECEMBER 6, 2005
RECORD PLANS BY:	P. PERRY & E. FOSTER
I HEREBY CERTIFY THAT ALL THE CONSTRUCTION REQUIRED BY THIS SET OF DRAWINGS HAS BEEN ACCOMPLISHED AS INDICATED HEREIN.	
BY:	<i>Paul H. Perry</i> RESIDENT ENGINEER
DATE:	4/3/06
NOTE: Any further information concerning final quantities, amounts or other details relative to this project may be found at Central Files in the electronic archives.	

CONVENTIONAL SYMBOLS	
COUNTY LINE	
TOWN LINE	
LIMITS OF ACCESS	
POINT OF ACCESS	
FENCE LINE	
STONE WALL	
TRAVELED WAY	
GUARD RAIL	
RAILROAD	
SURVEY LINE	
CULVERT	
POWER POLE	
TELEPHONE POLE	
TREES	
CONTROL OF ACCESS	
PROPERTY LINE	
R.O.W. TAKING LINE	
SLOPE RIGHTS	
TOP OF CUT	
TOE OF SLOPE	

SURVEYED BY : L. ORVIS
SURVEYED DATE : 4-3-1997

DATUM
VERTICAL NAVD 88
HORIZONTAL NAD 83 (92)

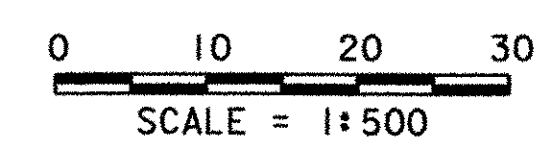

THESE PLANS ARE SUBJECT TO SUCH ENGINEERING CHANGES AS MAY BE REQUIRED BY THE FEDERAL HIGHWAY ADMINISTRATION OR THE DIRECTOR OF PROGRAM DEVELOPMENT.

CONSTRUCTION IS TO BE CARRIED ON IN ACCORDANCE WITH THESE PLANS AND THE STANDARD SPECIFICATIONS FOR CONSTRUCTION DATED 2001, AS APPROVED BY THE FEDERAL HIGHWAY ADMINISTRATION ON JANUARY 4, 2001 FOR USE ON THIS PROJECT, INCLUDING ALL SUBSEQUENT REVISIONS AND SUCH REVISED SPECIFICATIONS AND SPECIAL PROVISIONS AS ARE INCORPORATED IN THESE PLANS.

Metric
UNLESS NOTED OTHERWISE
STATIONS ARE IN KILOMETERS
ELEVATIONS ARE IN METERS
DIMENSIONS ARE IN MILLIMETERS

DIRECTOR OF PROGRAM DEVELOPMENT	<i>[Signature]</i>	DATE	6/25/03
APPROVED	<i>[Signature]</i>		
PROJECT MANAGER :	ROGER R. WHITCOMB		
PROJECT NAME :	BROOKLINE-NEWFANE		
PROJECT NUMBER :	BHO 1442 (25)		
SHEET	1	OF	78 SHEETS