

**(6015) RL-4 RAPID LIFT TECH ERECTION ANCHOR WITH SHEAR PLATE**  
**STD: 2-Ton, 4-Ton and 8-Ton High Capacity: 2.5-Ton, 5-Ton and 10-Ton**

The RL-4 Tech Erection Anchor with Plate is similar in design and use to the RL-3 Tech Erection Anchor, but has the added shear plate to eliminate the need for a shear bar. This design feature gives the anchor a smaller height envelope allowing it to be used in thinner concrete panels. This anchor is available in the sizes shown in the table and in plain or hot dip galva- nize finish.

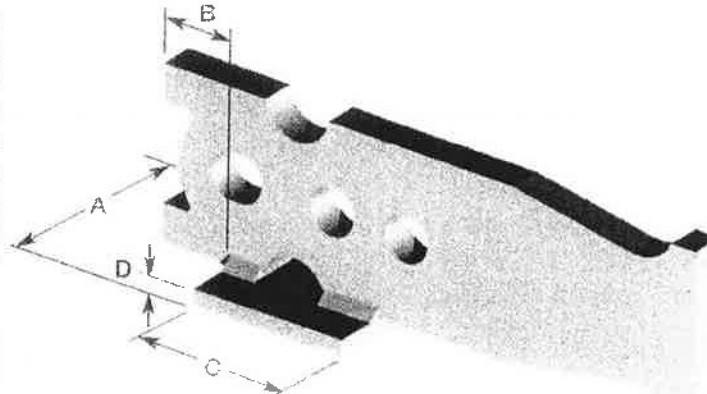

See Ring Clutches on page 46, 47, and 48, the Recessing Members on 49, 50 and 51, and the Tension Bars on page 38.

26

RL-4 TECH ERECTION ANCHOR WITH PLATE									
Ring Clutch System	Clutch I.D.	Item Number Standard	Item Number High Capacity	A	B	C	D	Weight (lbs)	Minimum Panel Thickness
2T/2.5T	2.5T	79527SP	79527SPHC	2 1/2"	3/4"	3"	1/4"	2.12	3 1/2"
4T/5T	5T	79548SP	79548SPHC	2 1/2"	1 1/4"	3"	3/8"	4.93	4"
8T/10T	10T	79589SP	79589SPHC	3"	1 5/8"	3 1/2"	3/8"	10.33	7"

See Standard RL-3 Tech Erection Anchor for all other dimensions.

RL-4 2-TON, 4-TON, 8-TON								Standard	High Capacity
Ring Clutch System	Clutch I.D.	Item Number Standard	Item Number High Capacity	Panel Thickness in Inches	SHEAR 2.66:1 Safety Factor (lbs)	SHEAR 4:1 Safety Factor (lbs)	TENSION w/o Tension Bar 4:1 Safety Factor (lbs)	TENSION w/ Tension Bar 4:1 Safety Factor (lbs)	TENSION w/ Tension Bar 4:1 Safety Factor (lbs)
2T/2.5T	2.5T	79527SP	79527SPHC	3 1/2" min.	2150	1130	2640	4000	5000
2T/2.5T	2.5T	79527SP	79527SPHC	4"	2930	1950	3190	4000	5000
2T/2.5T	2.5T	79527SP	79527SPHC	4 1/2"	3040	2020	3550	4000	5000
2T/2.5T	2.5T	79527SP	79527SPHC	5"	3160	2100	3900	4000	5000
4T/5T	5T	79548SP	79548SPHC	4" min.	2710	1800	3400	8000	10,000
4T/5T	5T	79548SP	79548SPHC	4 1/2"	3710	2470	3360	8000	10,000
4T/5T	5T	79548SP	79548SPHC	5"	4000	2660	4730	8000	10,000
4T/5T	5T	79548SP	79548SPHC	5 1/2"	4160	2770	4970	8000	10,000
4T/5T	5T	79548SP	79548SPHC	6"	4290	2860	5170	8000	10,000
8T/10T	10T	79589SP	79589SPHC	7" min.	6030	4010	7100	16,000	20,000
8T/10T	10T	79589SP	79589SPHC	7 1/2"	6630	4010	7220	16,000	20,000
8T/10T	10T	79589SP	79589SPHC	8"	6030	4010	7690	16,000	20,000

Table is based on dead load only, 150 PCF and a standard concrete compressive strength of 3,500 psi.

- 1) The 2.66:1 safety factor is commonly used for back stopping operations. Increased safety factor may be required for unusual live loads or cable magnification.
- 2) Given full embedment, reinforcement and minimum compressive strength concrete, Tech Erection Anchors should achieve a pull out strength equal to their ultimate mechanical strength.

To order, specify: quantity, name, item number and finish.