

S:\PROJECTS\CASELLA CONSTRUCTION\SHREWSBURY, VT - VTAOT STP 1443 (44)\DWGS\RFB 12x8 CASELLA 5676.DWG 3/18/2015 9:09 AM

- ELEV: 1002.69
- STREAM INVERT OUT  
ELEV: 995.67
- TOP OF FOOTING  
ELEV: 993.84
- BTM OF FOOTING  
ELEV: 989.66

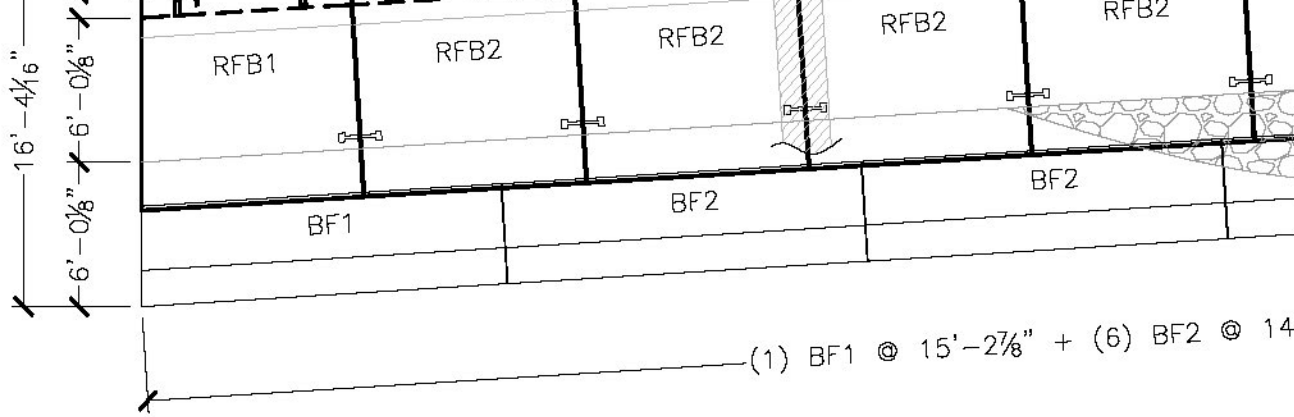

### BILL OF MATERIALS

QTY	DESCRIPTION	IN STOCK
<b>ITEMS CAST-IN</b>		
114	5-TON UTILITY ANCHORS	
4	RL-4 8TON TECH ANCHORS	
28	1-8NC 6X6 DOUBLE WINGWALL ANCHORS	
6	4" PVC X 10"L SLEEVES	
6	6" X 6" X 4" POCKET	
6	3" PVC X 8" LONG	
6	MB CX-51 COIL THREAD INSERT	
<b>ITEMS FOR PRE-SHIPMENT PREPARATION</b>		
600LF	1" NEOPRENE (25LF/ROLL)	
2 GAL	RED ADHESIVE (250 SF/GAL)	
<b>ITEMS TO SHIP TO THE JOB</b>		
380LF	ROYSTON AHT104 24" WIDE JOINT WRAP (50LF/ROLL)	
4 GAL	ROYBOND 740 ADHESIVE PRIMER (2 ROLLS/GAL)	
4	180DEG 1/2" X 10" X 14" GALV BRACKET	
6	120DEG 1/2" X 10" X 14" GALV BRACKET	
3	128DEG 1" X 10" X 14" GALV BRACKET	
64	1" X 5" GALV ROD WITH PLATE WASHER AND NUT	
6	1" X 13.5" GALV COIL ROD WITH HD NUT AND PLATE WASHER	
18	#6 X 18"L DOWEL	
78	7/8" X 18" GALV ROD W/ 2 NUTS & 4 WASHERS	
204	1/4" SHIMS	

2  
S1.

**Vermont**  
**R**  
Precast Rigid Frame

**CK'D BY C**

**RESUBMIT**  
**BY C. CARL**