

Boring Crew: PORTER, GARROW
 Date Started: 4/27/11 Date Finished: 4/29/11
 VTSPG NADB3: N 370162.50 ft E 1531069.11 ft
 Station: 102+76 Offset: -16.00
 Ground Elevation: 1019.85 ft

Casing Sampler
 Type: WB SS
 I.D.: 4 in 1.5 in
 Hammer Wt: N.A. 140 lb.
 Hammer Fall: N.A. 30 in.
 Hammer/Rod Type: Auto/AWJ
 Rig: CME 55 TRACK CE = 1.46

Groundwater Observations
 Date: 05/02/11
 Depth (ft): 14.2
 Notes: After Weekend

Depth (ft)	Strata (1)	CLASSIFICATION OF MATERIALS (Description)	Blows/6" (N Value)	Moisture Content %	Gravel %	Sand %	Fines %
10	A-2-4, SiSa Topsoil, Dk/brn, Moist, Rec. = 0.5 ft		1-1-1	26.9	13.8	55.8	30.4
	A-4, SaSi, brn, Moist, Rec. = 0.5 ft Field Note: NXDC, Cobbles & Gravel		R@6.0"	17.3	10.1	43.0	46.9
20	A-4, SaSi, brn, Moist, Rec. = 1.5 ft		1-1-1-1 (2)	19.1	18.2	39.6	42.2
	Field Note: No Recovery, Appears to be SaSi		1-1-1-1 (2)				
	Field Note: NXDC, Cobbles						
30	A-1-b, SiGrSa, brn, Moist, Rec. = 1.0 ft		8-14-11-30 (25)	15.9	38.5	38.9	22.6
	Field Note: NXDC, Cobbles & Gravel						
	A-1-b, SiGrSa, brn, Moist, Rec. = 0.7 ft		8-R@6.0"	10.2	23.5	54.7	21.8
	Field Note: NXDC, Cobbles & Gravel						
40	A-2-4, SiGrSa, brn, Moist, Rec. = 0.5 ft		40-R@2.5"	7.6	36.2	36.9	26.9
	Field Note: NXDC, Cobbles & Gravel						
	A-1-b, GrSa, gry, Moist, Rec. = 0.5 ft		R@6.0"	14.3	22.5	70.5	7.0
	Field Note: NXDC, Cobbles & Gravel						
	Visual Classification, SaGr, brn, Moist, Rec. = 0.3 ft, Insufficient sample for testing.		10-R@2.5"	8.5			
50	Field Note: NXDC, SaGr		40-80-R@0.0"	8.7	14.5	32.9	52.6
	A-4, SaSi (HP), gry, Moist, Rec. = 0.8 ft		33-70-R@0.0"	9.3	16.3	31.8	51.9
	A-4, SaSi (HP), gry, Moist, Rec. = 1.0 ft		R@3.5"	9.5	18.8	32.0	49.2
	A-4, SaSi (HP), brn, Moist, Rec. = 0.3 ft		R@6.0"	9.4	15.3	35.4	49.3
50	A-4, SaSi (HP), brn, Moist, Rec. = 0.5 ft						
	A-2-4, SiSaGr, red-brn, Moist, Rec. = 0.3 ft, Lab Note: A small amount of Weathered Rock within sample.		R@3.5"	9.2	38.5	34.6	26.9
Hole stopped @ 48.3 ft NLTD							

Notes:
 1. Stratification lines represent approximate boundary between material types. Transition may be gradual.
 2. N Values have not been corrected for hammer energy. CE is the hammer energy correction factor.
 3. Water level readings have been made at times and under conditions stated. Fluctuations of groundwater may occur due to other factors than those present at the time measurements were made.

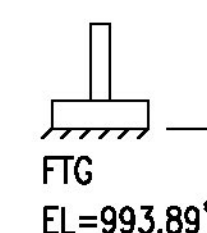

BORING LOG 2 SHREWSBURY BRO. 1443(44) GP. VERMONT AUT.GDT 6/1/11

Boring Crew: PORTER, GARROW
 Date Started: 5/03/11 Date Finished: 5/03/11
 VTSPG NADB3: N 370197.52 ft E 1531125.33 ft
 Station: 103+40 Offset: -38.00
 Ground Elevation: 1013.82 ft

Casing Sampler
 Type: WB SS
 I.D.: 4 in 1.5 in
 Hammer Wt: N.A. 140 lb.
 Hammer Fall: N.A. 30 in.
 Hammer/Rod Type: Auto/AWJ
 Rig: CME 55 TRACK CE = 1.46

Groundwater Observations
 Date: 05/03/11
 Depth (ft): 0.6
 Notes: Before drilling started

Depth (ft)	Strata (1)	CLASSIFICATION OF MATERIALS (Description)	Blows/6" (N Value)	Moisture Content %	Gravel %	Sand %	Fines %
5	A-2-4, GrSiSa, blk, Wei, Rec. = 0.6 ft, (Muck)		WH-WH-2-3 (2)	55.8	28.2	43.5	28.3
	A-1-b, SiSaGr, Dk/brn, Wei, Rec. = 0.7 ft		8-8-10-8 (18)	18.3	40.6	37.8	21.6
	A-1-b, SiGrSa, brn, MTW, Rec. = 0.6 ft, Cleaned out casing with BXDC.		2-5-5-10 (10)	12.4	37.2	40.6	22.2
10	A-4, SaGrSi, brn, MTW, Rec. = 0.6 ft, Cleaned out casing with BXDC.		10-10-8-10 (18)	8.5	34.2	29.6	36.2
	Field Note: No Recovery, Stone in sampler. Appears to be Gravel, Cleaned out casing with BXDC.		3-13-13-15 (26)				
	Visual Classification, Broken cobbles (Quartzite) with little silt & sand, white-brn, Moist, Rec. = 0.3 ft, Cleaned out casing with BXDC.		10-14-14-15 (28)	6.0			
	A-4, GrSaSi, brn, MTW, Rec. = 0.3 ft		1-10-17-10 (27)	10.4	30.6	32.0	37.4
15	A-2-4, SiGrSa, brn, Moist, Rec. = 1.0 ft		12-7-11-12 (18)	10.1	36.5	36.7	26.8
	A-2-4, SaGrSi, brn, Moist, Rec. = 1.5 ft		10-14-25-12 (39)	10.3	33.5	32.2	34.3
	A-2-4, SiSaGr (HP), brn, Moist, Rec. = 0.8 ft		8-11-22-38 (33)	9.8	42.3	29.6	28.1
25	Field Note: BXDC, Appears to be Sandy Gravel						
	A-1-b, SiSaGr (HP), orange-brown, Moist, Rec. = 0.8 ft		20-80-R@0.0"	9.7	38.9	37.8	23.3
30	Field Note: BXDC, Appears to be Silty Sand						
	A-2-4, SiGrSa (HP), brn, Moist, Rec. = 0.5 ft		R@6.0"	10.7	34.0	36.2	29.8
Field Note: No recovery, BXDC, To confirm it was not bedrock							
Hole stopped @ 30.0 ft NLTD							

Notes:
 1. Stratification lines represent approximate boundary between material types. Transition may be gradual.
 2. N Values have not been corrected for hammer energy. CE is the hammer energy correction factor.
 3. Water level readings have been made at times and under conditions stated. Fluctuations of groundwater may occur due to other factors than those present at the time measurements were made.

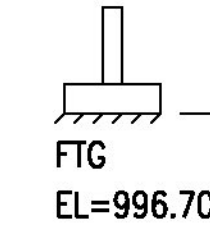

BORING LOG 2 SHREWSBURY BRO. 1443(44) GP. VERMONT AUT.GDT 6/1/11