

STATE OF VERMONT AGENCY OF TRANSPORTATION



PROPOSED IMPROVEMENT BRIDGE PROJECT TOWN OF SHREWSBURY COUNTY OF RUTLAND

ROUTE NO : TH 4 (CLASS 2 LOCAL ROAD) BRIDGE NO : 37

PROJECT LOCATION : TH 4 (LINCOLN HILL ROAD), SHREWSBURY, VERMONT.
APPROXIMATELY 0.25 MILES EASTERLY OF THE INTERSECTION OF TOWN
HIGHWAY 4 AND VERMONT ROUTE 103.

PROJECT DESCRIPTION : WORK TO BE PERFORMED UNDER THIS PROJECT
INCLUDES REPLACEMENT OF EXISTING STRUCTURE (BRIDGE #37) WITH
A NEW STRUCTURE WITH MINIMAL APPROACH ROADWAY AND CHANNEL WORK.

LENGTH OF STRUCTURE : 12 FOOT WIDE BURIED STRUCTURE
LENGTH OF ROADWAY : 350 FEET
LENGTH OF PROJECT : 350 FEET

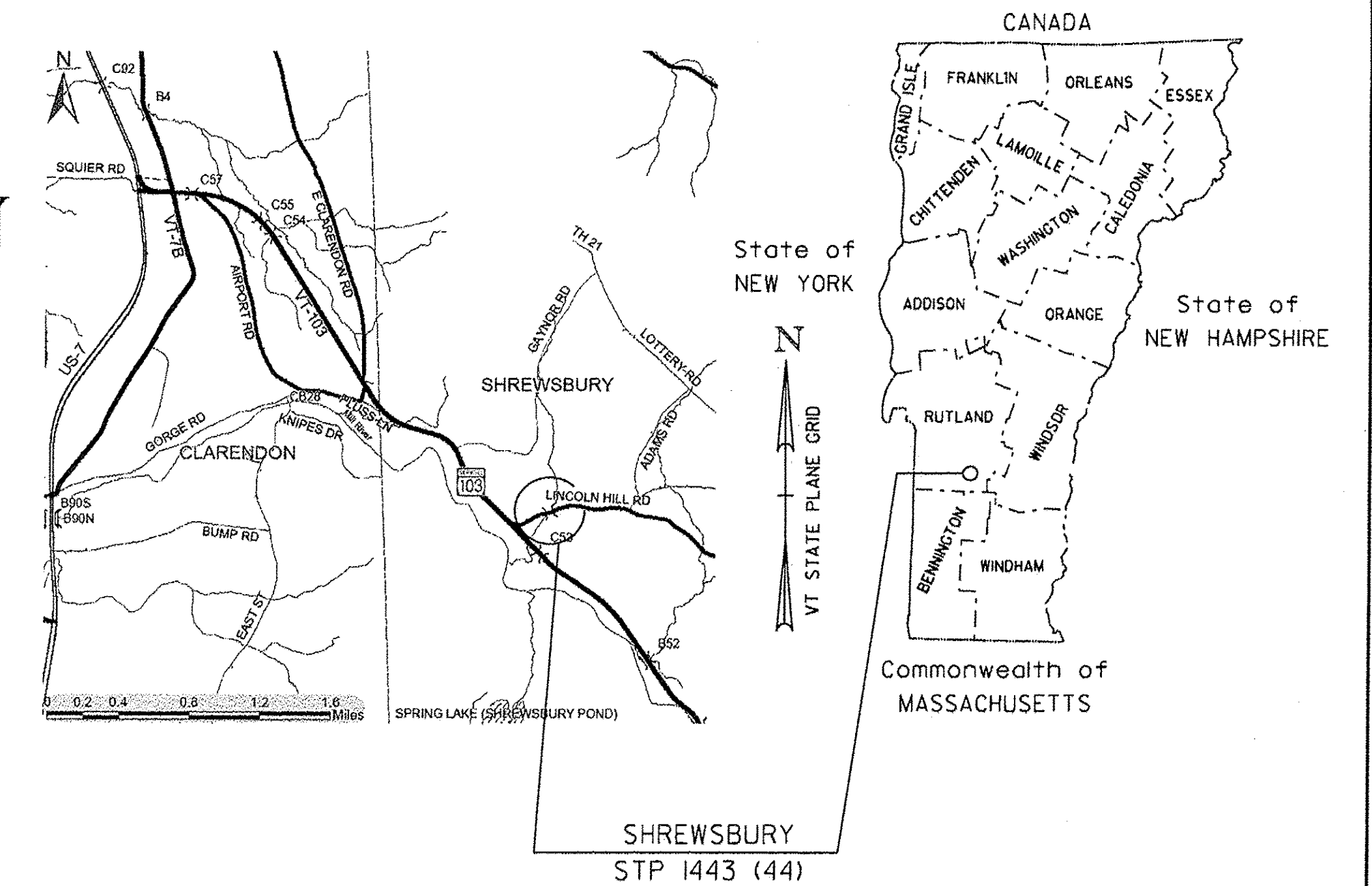

RECORD PLANS	
CONTRACTOR:	CASELLA CONSTRUCTION, INC. - MENDON, VT
RESIDENT ENGINEER:	TIM POKETTE
CONSTRUCTION BEGAN:	APRIL 14, 2015
CONSTRUCTION COMPLETE:	AUGUST 28, 2015
RECORD PLANS BY:	TIM POKETTE & AARON JAMES
I HEREBY CERTIFY THAT ALL THE CONSTRUCTION REQUIRED BY THIS SET OF DRAWINGS HAS BEEN ACCOMPLISHED AS INDICATED HEREIN.	
BY:	RESIDENT ENGINEER
DATE:	09-12-2016
NOTE: Any further information concerning final quantities, amounts or other details relative to this project may be found at Central Files in the electronic archives.	

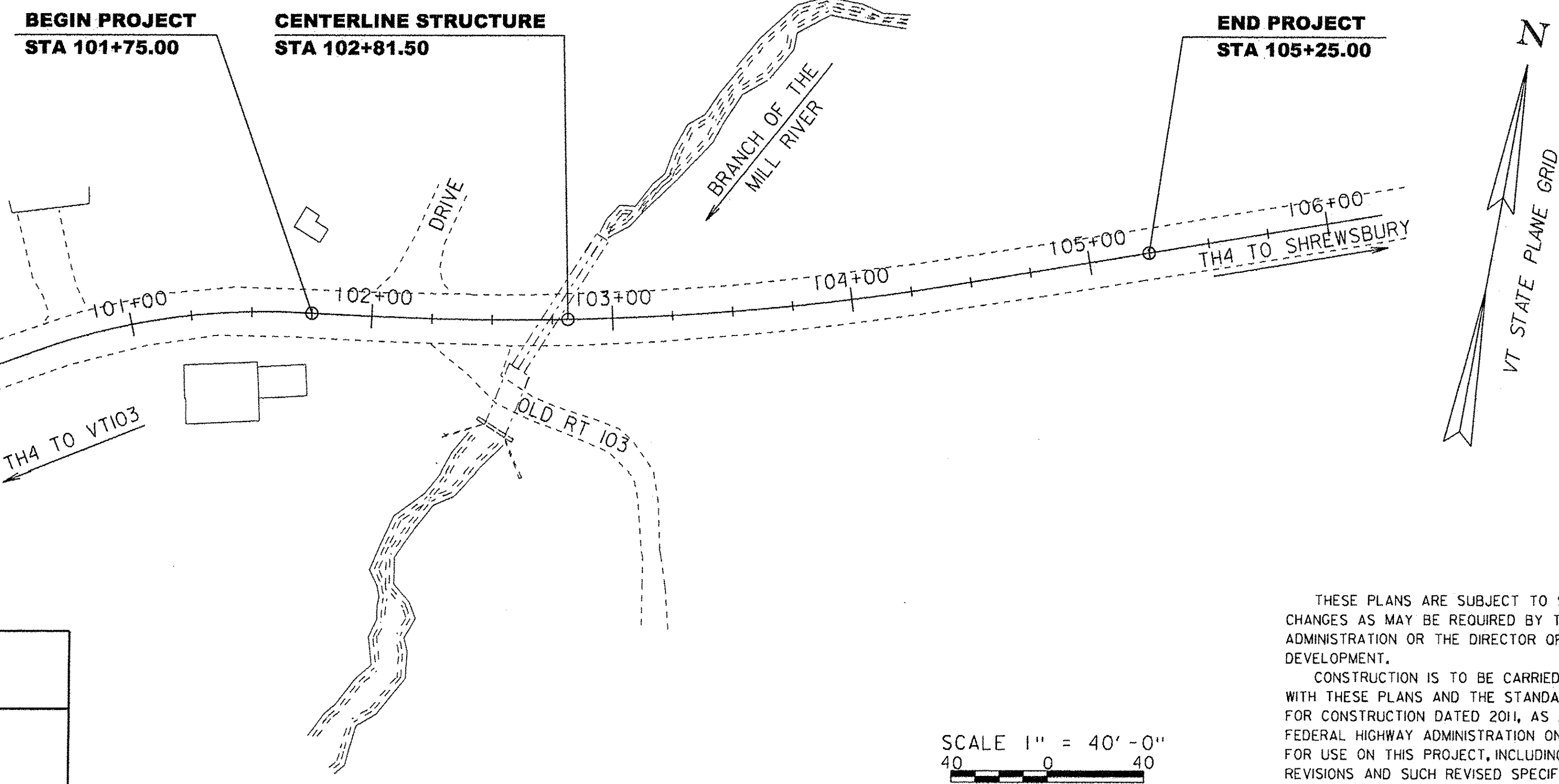

QUALITY ASSURANCE PROGRAM: LEVEL 2

CONVENTIONAL SYMBOLS	
COUNTY LINE	
TOWN LINE	
LIMITS OF ACCESS	
POINT OF ACCESS	
FENCE LINE	
STONE WALL	
TRAVELED WAY	
GUARD RAIL	
RAILROAD	
SURVEY LINE	
CULVERT	
POWER POLE	
TELEPHONE POLE	
TREES	
CONTROL OF ACCESS	
PROPERTY LINE	
R.O.W. TAKING LINE	
SLOPE RIGHTS	
TOP OF CUT	
TOE OF SLOPE	

SURVEYED BY : R. D. GILMAN
SURVEYED DATE : NOV. 1995

DATUM
VERTICAL NAVD 88
HORIZONTAL NAD 83 (92)

SCALE 1" = 40'-0"
40 0 40

THESE PLANS ARE SUBJECT TO SUCH ENGINEERING CHANGES AS MAY BE REQUIRED BY THE FEDERAL HIGHWAY ADMINISTRATION OR THE DIRECTOR OF PROGRAM DEVELOPMENT.

CONSTRUCTION IS TO BE CARRIED ON IN ACCORDANCE WITH THESE PLANS AND THE STANDARD SPECIFICATIONS FOR CONSTRUCTION DATED 2011, AS APPROVED BY THE FEDERAL HIGHWAY ADMINISTRATION ON JULY 20, 2011 FOR USE ON THIS PROJECT, INCLUDING ALL SUBSEQUENT REVISIONS AND SUCH REVISED SPECIFICATIONS AND SPECIAL PROVISIONS AS ARE INCORPORATED IN THESE PLANS.

DIRECTOR OF PROGRAM DEVELOPMENT	
APPROVED:	DATE: 5-22-17
PROJECT MANAGER : CAROLYN CARLSON P. E.	
PROJECT NAME :	SHREWSBURY
PROJECT NUMBER :	STP 1443 (44)
SHEET 1 OF 36 SHEETS	