

**CHAUVIN, PAUL J.  
& DEBORAH J.**

**NOTES:**

- 1) THE RIPARIAN BUFFER IS A RESOURCE OF SPECIFIC CONCERN. EARTH DISTURBANCES WITHIN THE BUFFER ZONE SHALL BE MINIMIZED.

**SCOTT,  
LAURA FALK**

**KEEN, COLIN G.  
& BRIGITTE**

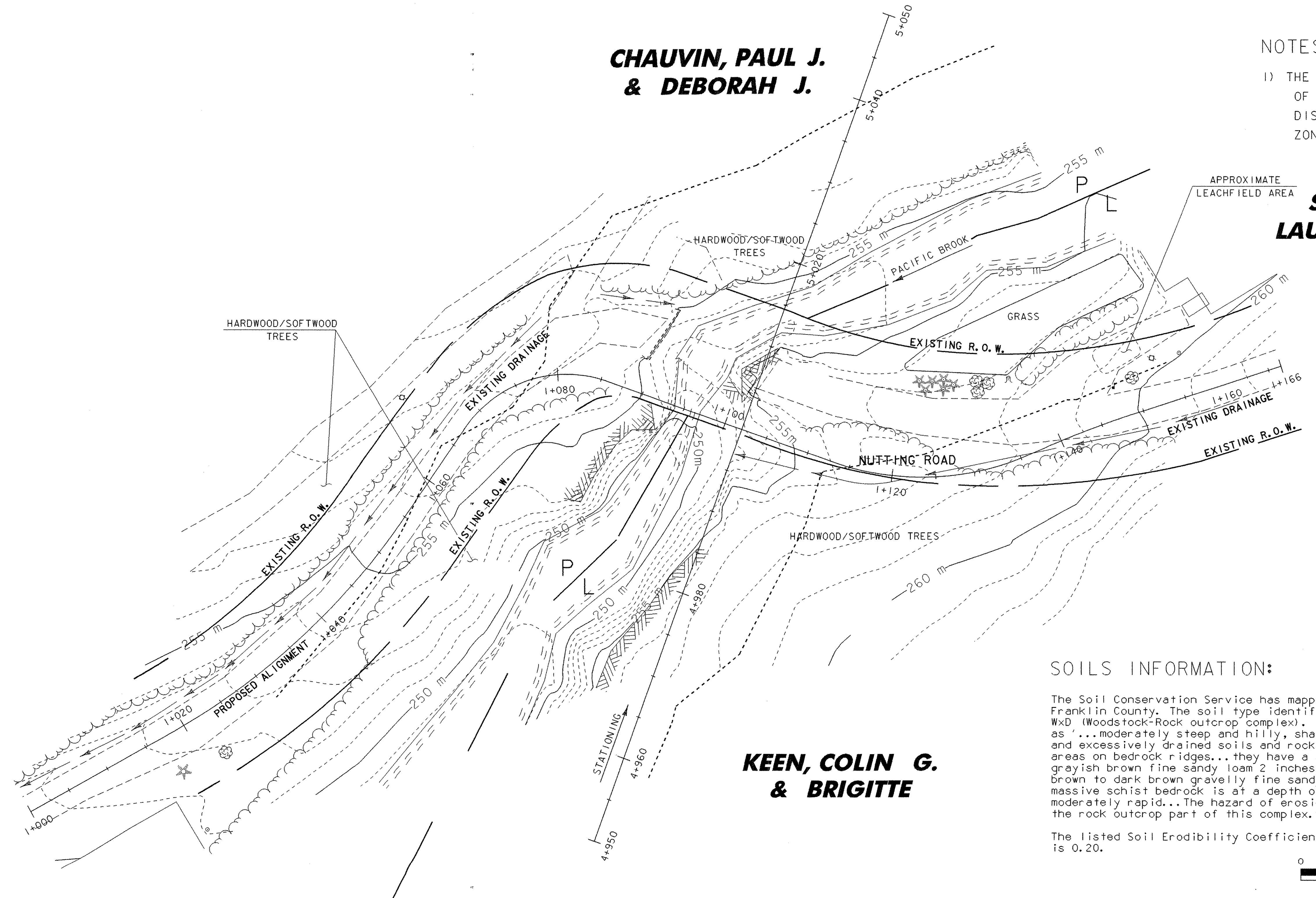

**SOILS INFORMATION:**

The Soil Conservation Service has mapped the soils throughout Franklin County. The soil type identified for this project site is WxD (Woodstock-Rock outcrop complex). This soil type is described as "...moderately steep and hilly, shallow, somewhat excessively drained and excessively drained soils and rock outcrop in irregularly shaped areas on bedrock ridges...they have a surface layer of very dark grayish brown fine sandy loam 2 inches thick. The subsoil is friable, brown to dark brown gravelly fine sandy loam 10 inches thick. Hard, massive schist bedrock is at a depth of 12 inches....Permeability is moderately rapid...The hazard of erosion is severe. Runoff is rapid on the rock outcrop part of this complex."

The listed Soil Erodibility Coefficient (K-value) for this soil type is 0.20.

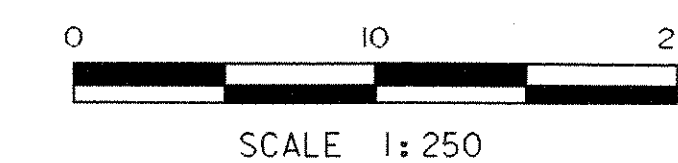

LEGEND	
-----	RIPARIAN BUFFER

DATUM	
VERTICAL	NAVD88
HORIZONTAL	NAD 83/92

SHEET NAME: <b>EXISTING CONDITIONS SITE PLAN</b>	
PROJECT NAME: <b>MONTGOMERY</b>	HIGHWAY NO.: TH 35
PROJECT NUMBER: <b>BRO 1448(20)</b>	BRIDGE NO.: 24
	OVER: PACIFIC BROOK
FILE NAME: /PW/94j124/sj124ero.dgn	PLOT DATE: 06-DEC-2005
PROJECT MANAGER: R. WHITCOMB	DRAWN BY: T. HUSK
DESIGNED BY: D. BONNEAU	IPARM NAME: sj124ec2.1
BRIDGE SHEET NUMBER:	SHEET 19 OF 50