

STATE OF VERMONT AGENCY OF TRANSPORTATION

R. O. W. PLANS



PROPOSED IMPROVEMENT BRIDGE PROJECT

TOWN OF MONTGOMERY
COUNTY OF FRANKLIN

ROUTE NO : TH 35 (CLASS 3) (LOCAL ROAD) BRIDGE NO : 24
PROJECT LOCATION : BRIDGE 24 ON TH 35 APPROXIMATELY 0.2 KM
SOUTHEASTERLY OF THE INTERSECTION OF TH35 AND VT 118
AND EXTENDING ALONG TH 35 FOR 100 METERS.
PROJECT DESCRIPTION : REPLACEMENT OF BRIDGE 24 WITH NECESSARY APPROACH WORK.

LENGTH OF STRUCTURE :	27.100	METERS.
LENGTH OF ROADWAY :	72.900	METERS.
LENGTH OF PROJECT :	100.000	METERS.
LENGTH OF R.O.W. PROJECT :	131.5+/-	METERS. (431 FEET +/-)

NOTE: TRAFFIC WILL BE MAINTAINED ON EXISTING BRIDGE.

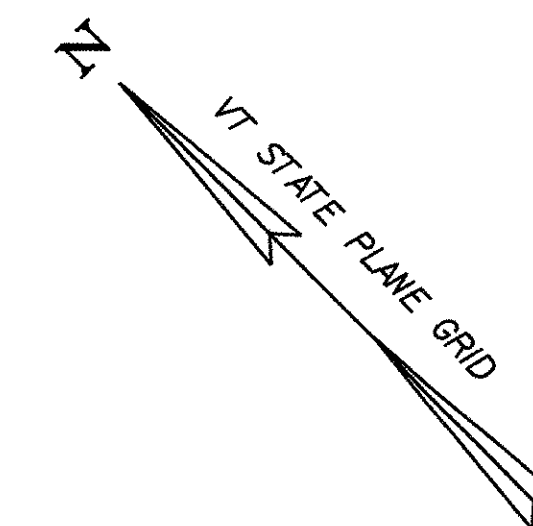
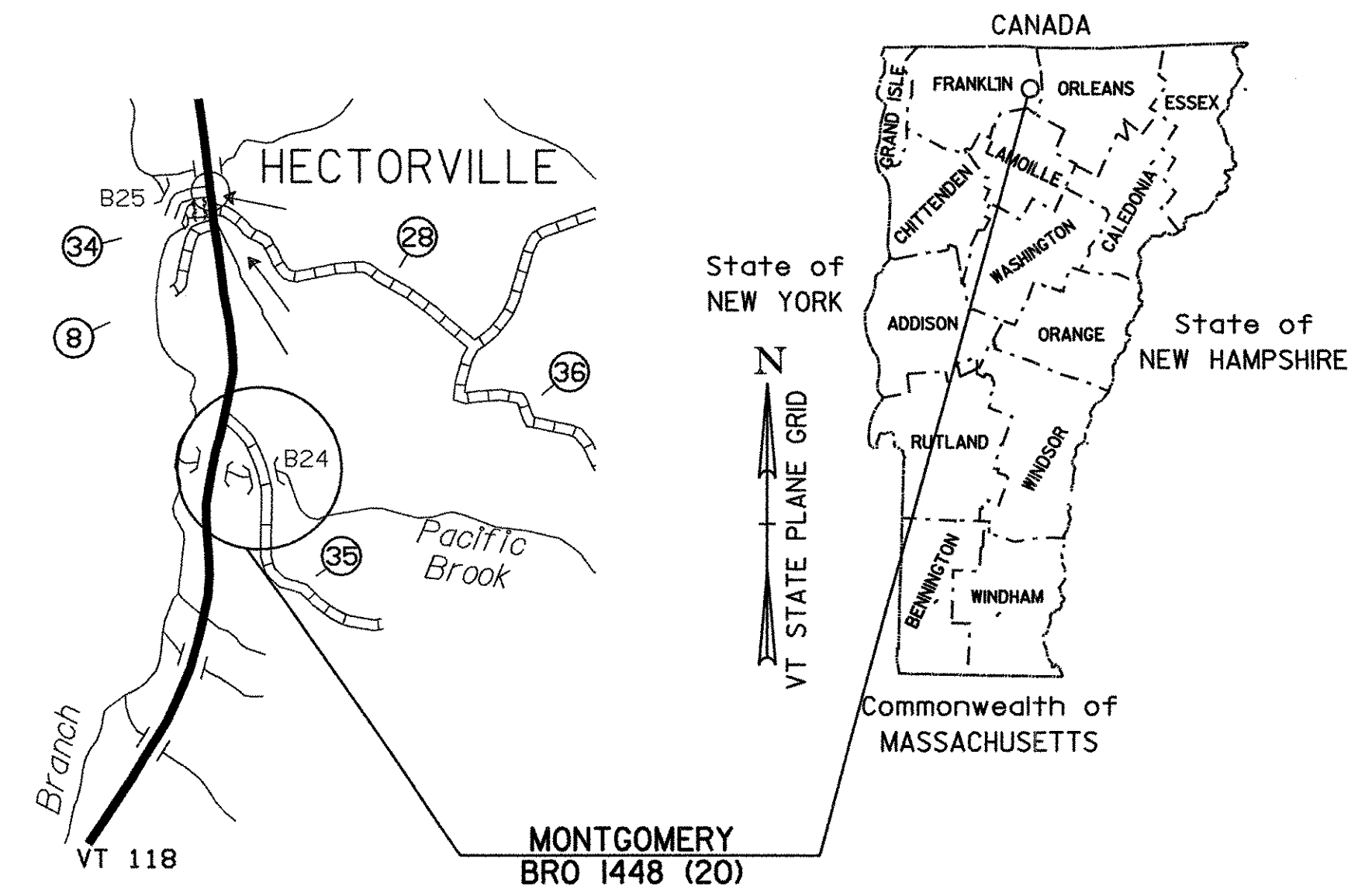

THE FOLLOWING RIGHT OF WAY PLAN SHEETS PERTAIN DIRECTLY TO THE ACQUISITION OF LAND AND RIGHTS NECESSARY TO CONSTRUCT THIS TRANSPORTATION PROJECT. SHEETS REGARDING SPECIFIC CONSTRUCTION DETAILS ARE NOT INCLUDED IN THIS RECORDED SET.

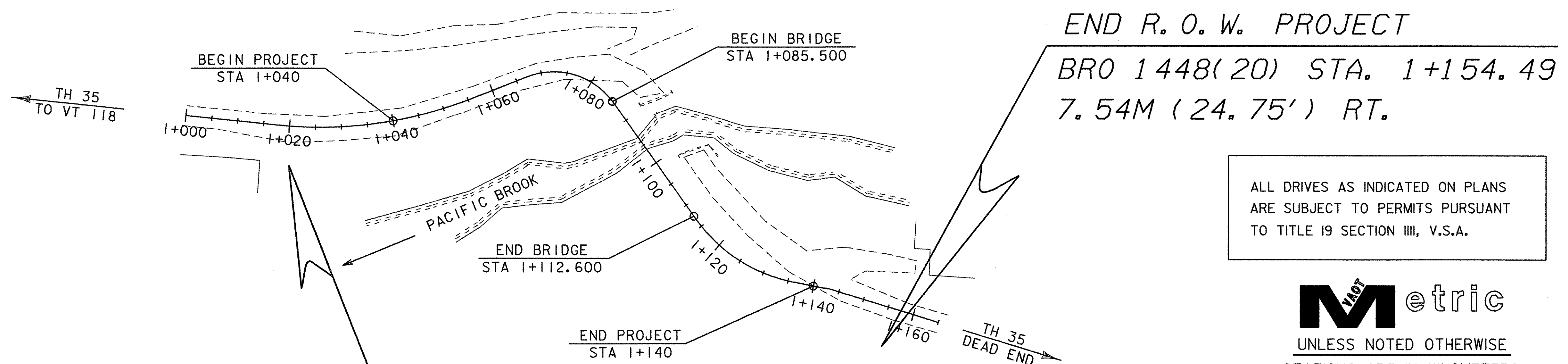

END R. O. W. PROJECT
BRO 1448(20) STA. 1+154.49
7.54M (24.75') RT.

ALL DRIVES AS INDICATED ON PLANS ARE SUBJECT TO PERMITS PURSUANT TO TITLE 19 SECTION III, V.S.A.

CONVENTIONAL SYMBOLS	
COUNTY LINE	
TOWN LINE	
LIMITS OF ACCESS	
POINT OF ACCESS	
FENCE LINE	
STONE WALL	
TRAVELED WAY	
GUARD RAIL	
RAILROAD	
SURVEY LINE	
CULVERT	
POWER POLE	
TELEPHONE POLE	
TREES	
CONTROL OF ACCESS	
PROPERTY LINE	
R.O.W. TAKING LINE	
SLOPE RIGHTS	
TOP OF CUT	
TOE OF SLOPE	

BEGIN R. O. W. PROJECT
BRO 1448(20) STA. 1+023.00
7.54M (24.75') RT.

SURVEYED BY :
SURVEYED DATE :
DATUM
VERTICAL NAVD 88
HORIZONTAL NAD - 83 (92)

LINES SHOWN ON THIS PLAN AS EXISTING PROPERTY LINES P/L ARE BELIEVED TO BE ACCURATE BUT SHOULD NOT BE RELIED UPON FOR PURPOSES UNRELATED TO THE TOWN OF MONTGOMERY'S ACQUISITION OF LAND AND RIGHTS FOR THIS PROJECT.

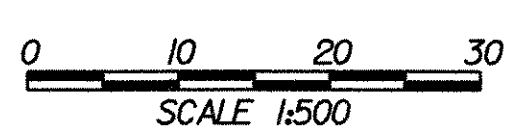

THESE PLANS ARE SUBJECT TO SUCH ENGINEERING CHANGES AS MAY BE REQUIRED BY THE FEDERAL HIGHWAY ADMINISTRATION OR THE DIRECTOR OF PROJECT DEVELOPMENT.
CONSTRUCTION IS TO BE CARRIED ON IN ACCORDANCE WITH THESE PLANS AND THE STANDARD SPECIFICATIONS FOR CONSTRUCTION DATED 2001, AS APPROVED BY THE FEDERAL HIGHWAY ADMINISTRATION ON JANUARY 4, 2001 FOR USE ON THIS PROJECT, INCLUDING ALL SUBSEQUENT REVISIONS AND SUCH REVISED SPECIFICATIONS AND SPECIAL PROVISIONS AS ARE INCORPORATED IN THESE PLANS.
/str/94j24/sj24bdr.dgn PLOTTED: 31-JAN-2003

UNLESS NOTED OTHERWISE
STATIONS ARE IN KILOMETERS
ELEVATIONS ARE IN METERS
DIMENSIONS ARE IN MILLIMETERS

APPROVED	DATE 2/3/03
APPROVED	DATE 1/31/03
MONTGOMERY BRO 1448(20) R. O. W. SHEET 1 OF 7 SHEETS	