

WINGWALL #3 ELEVATION
SCALE: 1:25

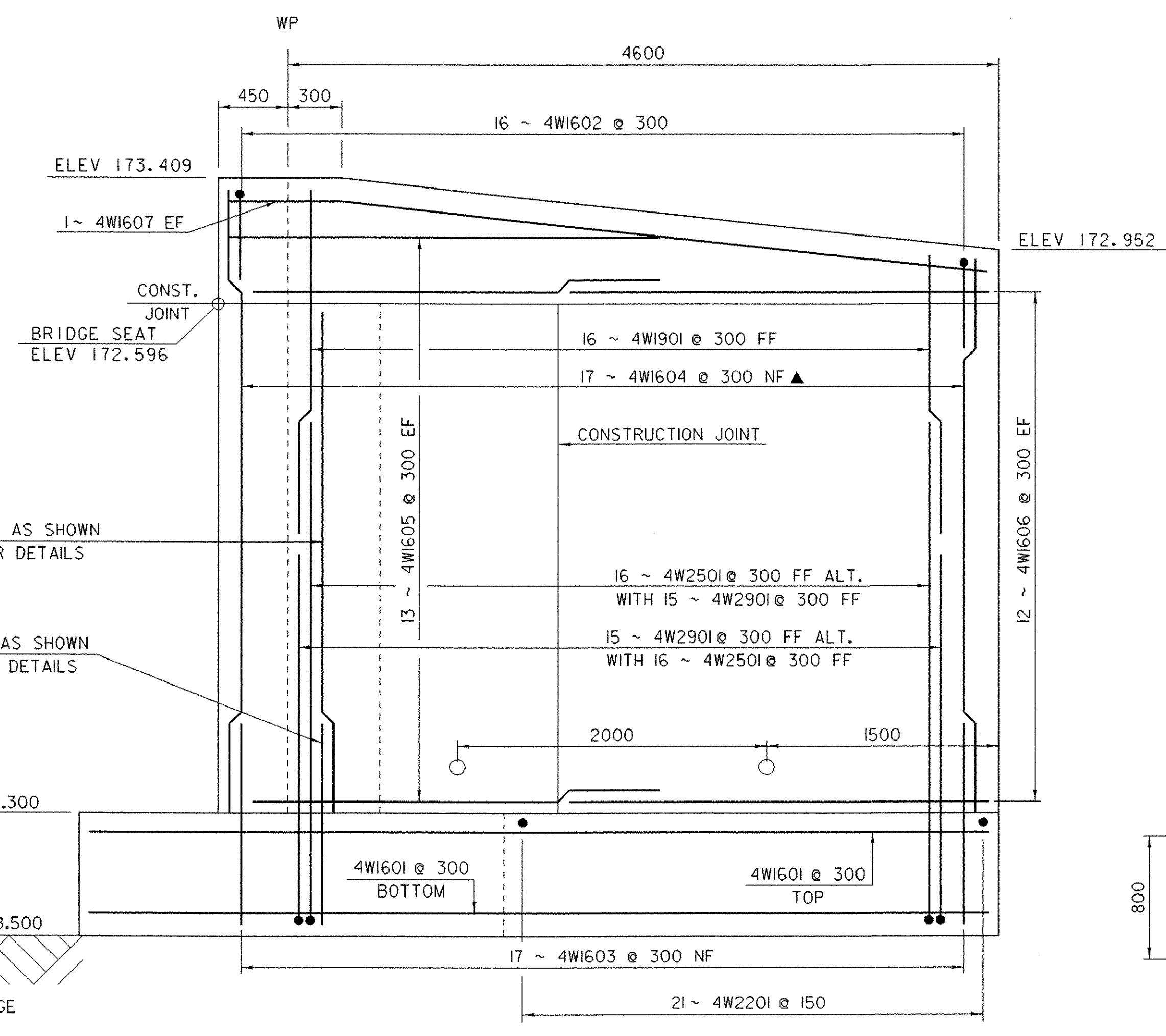

WINGWALL #4 ELEVATION
SCALE: 1:25

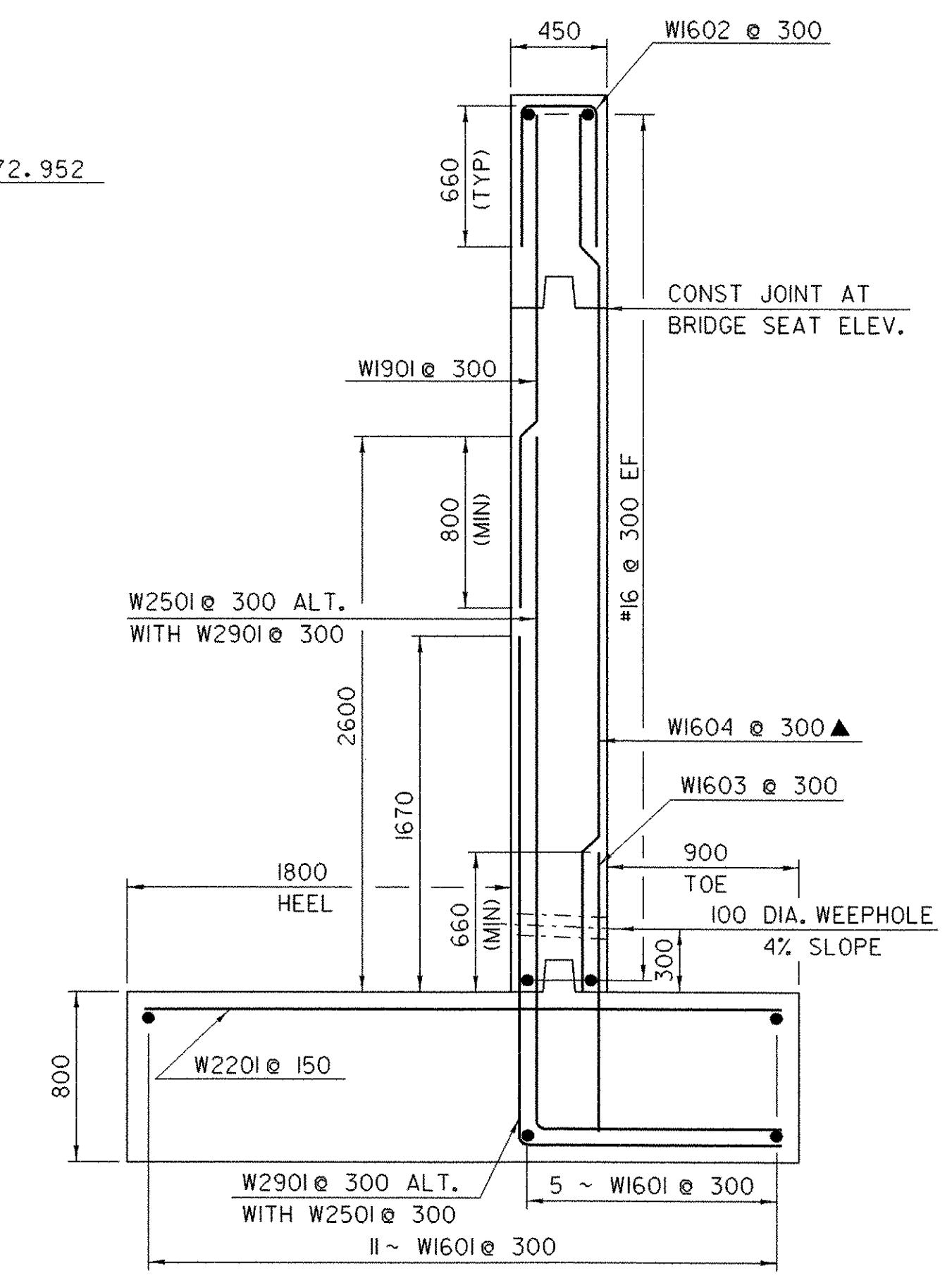

WINGWALL TYPICAL SECTION
(WINGWALL #3 AND #4 ARE SIMILAR)
SCALE: 1:25



SCALE = 1:25

NOTES

1. NF = NEAR FACE
2. FF = FAR FACE
3. EF = EACH FACE
4. ▲ = CUT TO FIT IN FIELD
5. 80 CLEAR UNLESS OTHERWISE SPECIFIED ON THE PLANS
6. 3000 MAX. WEEPHOLE SPACING
7. ALL LAPS NOT DETAILED SHALL BE 660 (MIN)
8. SEE SHEET 37 FOR CORNER DETAILS.

SHEET NAME: WW #3 & WW #4 ELEVATIONS	
PROJECT NAME: WESTFORD	HIGHWAY NO.: TH 4
PROJECT NUMBER: TH2 9436	BRIDGE NO.: 2
	OVER: ROGERS BROOK
FILE NAME: 94J122\Structures\sj122sup.dgn	PLOT DATE: 25-MAR-2005
PROJECT MANAGER: R. R. WHITCOMB	DRAWN BY: T. FILLBACH
DESIGNED BY: T. FILLBACH	IPARM NAME: sj122ww2.1
BRIDGE SHEET NUMBER:	SHEET 38 OF 56