

SEE SHEET 2 FOR INDEX OF SHEETS
AND LIST OF STANDARDS

STATE OF VERMONT AGENCY OF TRANSPORTATION



PROPOSED IMPROVEMENT BRIDGE PROJECT TOWN OF WALLINGFORD COUNTY OF RUTLAND

ROUTE NO: TH 60, CLASS 3 (LOCAL ROAD), BRIDGE 50

PROJECT LOCATION : THE BRIDGE IS LOCATED APPROXIMATELY 0.080 KM WESTERLY OF THE INTERSECTION OF TH 60 AND TH 58.

PROJECT DESCRIPTION : THE PROJECT SHALL CONSIST OF THE REPLACEMENT OF THE EXISTING SUPERSTRUCTURE, REHABILITATION OF ABUTMENT NO. 1 AND REPLACEMENT OF ABUTMENT NO. 2 WITH MINIMAL APPROACH ROADWAY AND CHANNEL WORK.

LENGTH OF STRUCTURE = 22.240 METERS

LENGTH OF ROADWAY = 17.760 METERS

LENGTH OF PROJECT = 40.000 METERS

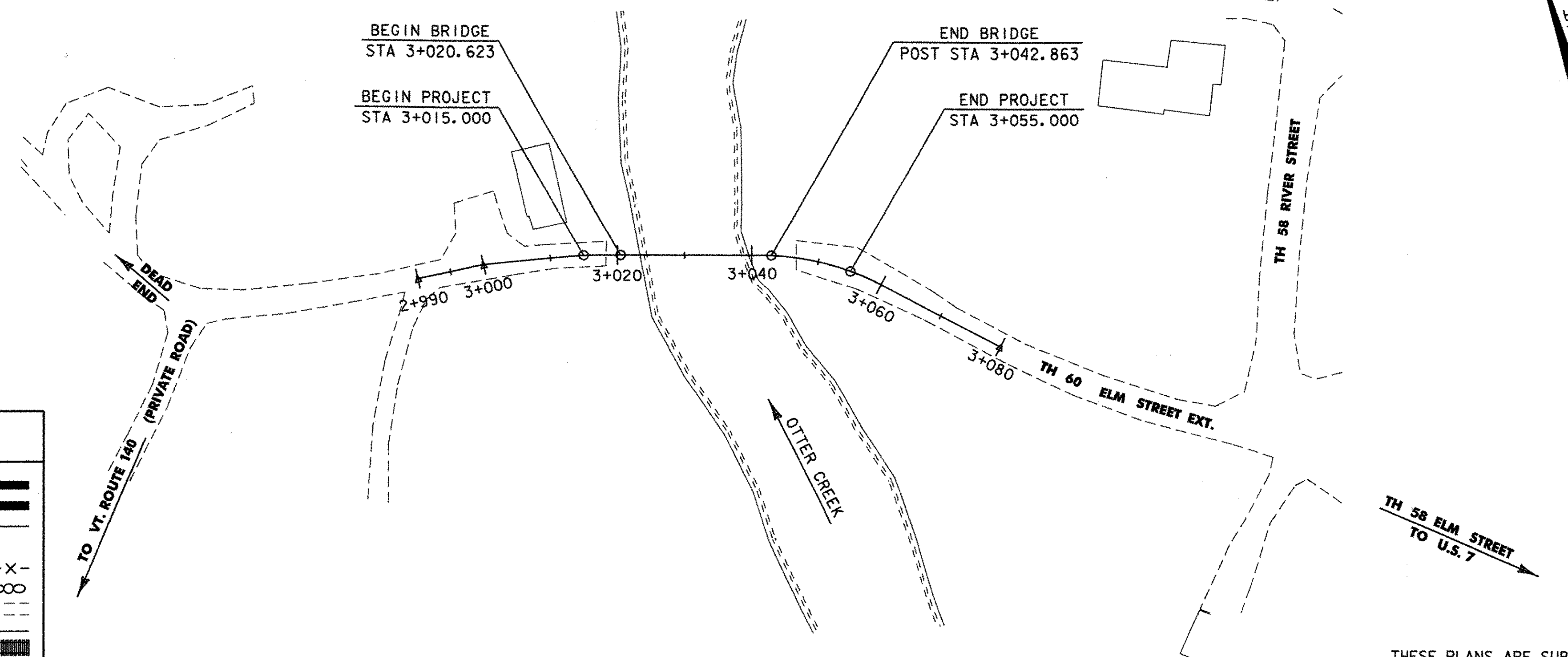
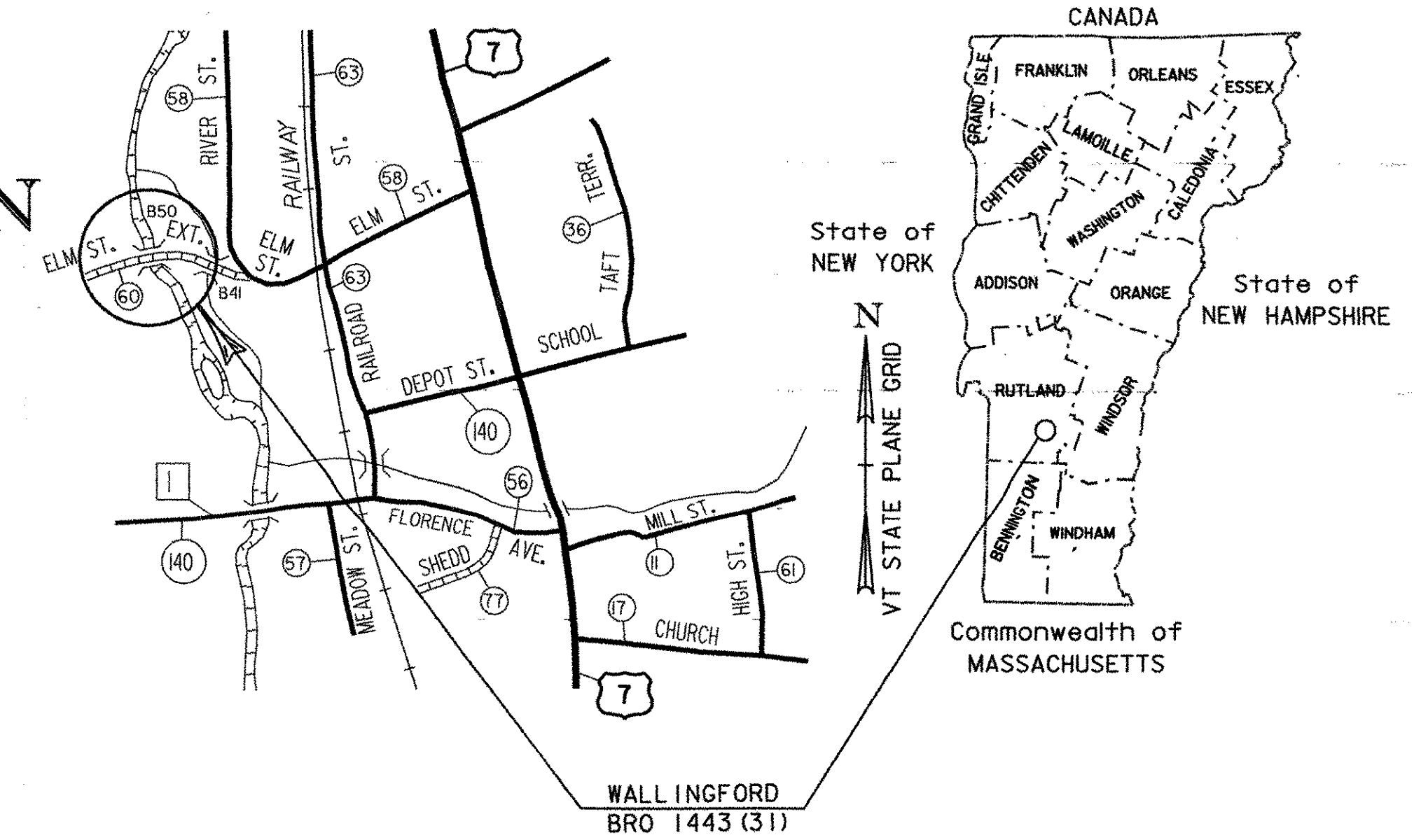

RECORD PLANS	
CONTRACTOR:	ALPINE CONSTRUCTION L.L.C. - SCHUYLerville, NY
RESIDENT ENGINEER:	TIM POKETTE
CONSTRUCTION BEGAN:	MARCH 20, 2006
CONSTRUCTION COMPLETE:	NOVEMBER 13, 2006
RECORD PLANS BY:	TIM POKETTE & JUDY GILMORE
I HEREBY CERTIFY THAT ALL THE CONSTRUCTION REQUIRED BY THIS SET OF DRAWINGS HAS BEEN ACCOMPLISHED AS INDICATED HEREIN.	
BY:	<i>Tim Pockette</i> RESIDENT ENGINEER
DATE:	April 5, 2007
NOTE: Any further information concerning final quantities, amounts or other details relative to this project may be found at Central Files in the electronic archives.	

CONVENTIONAL SYMBOLS	
COUNTY LINE	
TOWN LINE	
LIMITS OF ACCESS	
POINT OF ACCESS	
FENCE LINE	
STONE WALL	
TRAVELED WAY	
GUARD RAIL	
RAILROAD	
SURVEY LINE	
CULVERT	
POWER POLE	
TELEPHONE POLE	
TREES	
CONTROL OF ACCESS	
PROPERTY LINE	
R.O.W. TAKING LINE	
SLOPE RIGHTS	
TOP OF CUT	
TOE OF SLOPE	

SURVEYED BY : L. ORVIS
SURVEYED DATE : FEB 1995 & JUNE 1998

DATUM
VERTICAL NAVD 88
HORIZONTAL NAD 83/92

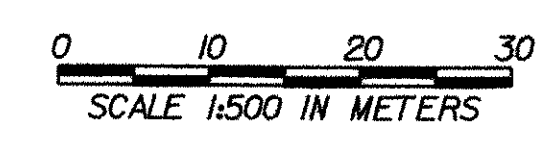

THESE PLANS ARE SUBJECT TO SUCH ENGINEERING CHANGES AS MAY BE REQUIRED BY THE FEDERAL HIGHWAY ADMINISTRATION OR THE DIRECTOR OF PROGRAM DEVELOPMENT.

CONSTRUCTION IS TO BE CARRIED ON IN ACCORDANCE WITH THESE PLANS AND THE STANDARD SPECIFICATIONS FOR CONSTRUCTION DATED 2001, AS APPROVED BY THE FEDERAL HIGHWAY ADMINISTRATION ON JANUARY 4, 2001 FOR USE ON THIS PROJECT, INCLUDING ALL SUBSEQUENT REVISIONS AND SUCH REVISED SPECIFICATIONS AND SPECIAL PROVISIONS AS ARE INCORPORATED IN THESE PLANS.

/PW/94J084/sj084bdr.dgn PLOTTED 22-SEP-2005

Metric
UNLESS NOTED OTHERWISE
STATIONS ARE IN KILOMETERS
ELEVATIONS ARE IN METERS
DIMENSIONS ARE IN MILLIMETERS

DIRECTOR OF PROGRAM DEVELOPMENT	<i>Rodney Peterson</i> DATE 9-21-05
PROJECT MANAGER	ROGER WHITCOMB
PROJECT NAME :	WALLINGFORD
PROJECT NUMBER :	BRO 1443(31)
SHEET 1 OF 38 SHEETS	