

POST PLATE LENGTHS VARY TO ALLOW FOR FIELD CONDITIONS;
CUT POST PLATE AS REQUIRED TO MATCH EXISTING POST,
DRILL HOLES TO MATCH EXISTING HOLES IN POST
(SEE TRUSS POST DETAIL TYP)

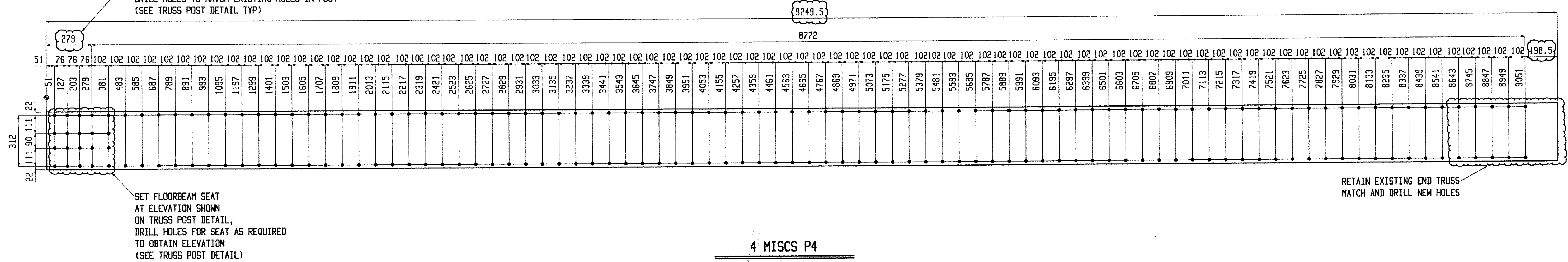

4 MISCS P4

POST ANGLE LENGTHS VARY TO ALLOW FOR FIELD CONDITIONS;
MATCH EXISTING POST ANGLE LENGTHS AS REQUIRED
(SEE TRUSS POST DETAIL TYP).

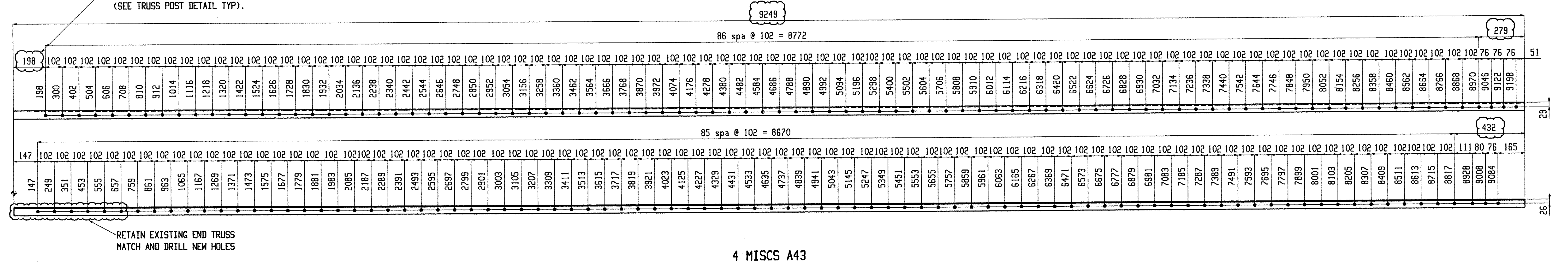

4 MISCS A43

POST ANGLE LENGTHS VARY TO ALLOW FOR FIELD CONDITIONS;
MATCH EXISTING POST ANGLE LENGTHS AS REQUIRED
(SEE TRUSS POST DETAIL TYP).

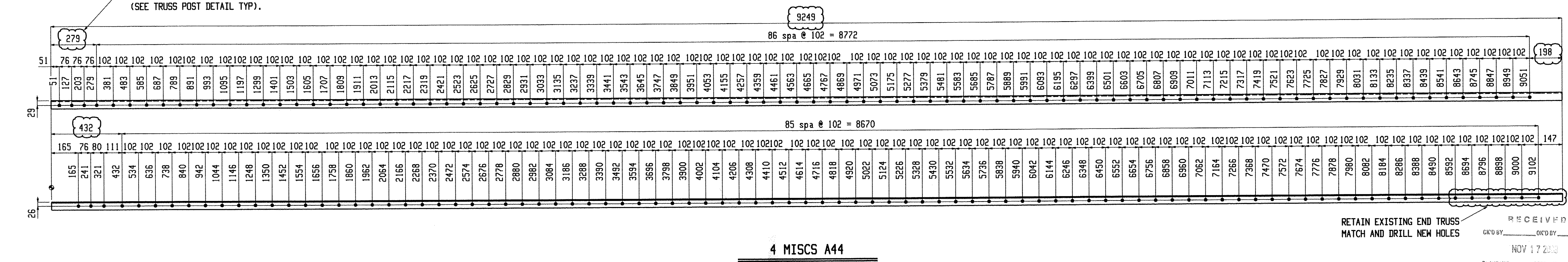

4 MISCS A44

RETAIN EXISTING END TRUSS
MATCH AND DRILL NEW HOLES

RECEIVED
OK'D BY: _____ OK'D BY: _____
NOV 17 2008

BY: _____ DATE: _____

NOTE: WORK THIS DRAWING WITH
GROUP MEMBER GM11

BILL OF MATERIAL						
Qty	Piece	Description	Length	Seq NO.	Seq Qty	Adv ABM #
4	P4	MISC		1	4	
4	P4	PL6.4x356	9249.5			M270M-345
4	A43	MISC		1	4	
4	A43	L51x51x6.4	9249			M270M-345

BILL OF MATERIAL						
Qty	Piece	Description	Length	Seq NO.	Seq Qty	Adv ABM #
4	A44	MISC		1	4	
4	A44	L51x51x6.4	9249			M270M-345

BILL OF MATERIAL						
Qty	Piece	Description	Length	Seq NO.	Seq Qty	Adv ABM #
4	A44	MISC		1	4	
4	A44	L51x51x6.4	9249			M270M-345

Total weight: 1014

Renaud Bros. Inc.
283 Fort Bridgeman Rd. #2
Vernon, VT. 05354
Phone 1-802 257-7383

Project: **DUMMERSTON BRIDGE**
DUMMERSTON, VT

Date: 9-9-09
Checked: MRS
Job No. Bto 1442 (28)
Sheet No. 16

Holes: 21mm UNF
BOLTS: 19mm DIA. M164M-I GALV UNF
Steel GR: M270M-GR345 UNF
Paint: PER SPECS (GREEN) UNF
Surface Prep: PER SPECS