



**Dufresne & Associates, P.C.**  
 459 Portland Street, Suite 106  
 St. Johnsbury, Vermont 05819  
 Tel: (802) 748-8605 Fax: (802) 748-4512  
 E-mail: duf@dufresne.com  
 Home page: http://www.dufresne.com

Project #	416006
Project Mgr.	RAW
Design	RNG
Drawn	EAE
Checked by	R.E. DUFRESNE
Date	December 09
Scale	AS SHOWN
Approved by	RED

Revisions:  
 △ 10-27-09: REVISIONS PER VTRANS COMMENTS  
 △ 11-20-09: REVISE SLEEVE SIZE  
 △ 12-28-09: GENERAL REVISIONS

THIS DRAWING FOR THE PROJECT SHOWN IS THE PROPERTY OF DUFRESNE & ASSOCIATES, P.C. ANY REVISIONS SHALL BE MADE BY THE ORIGINAL DRAWING.  
**Dufresne & Associates, P.C.**

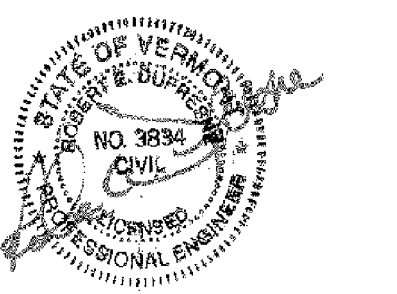

12-29-09

BRIDGE #31  
**WATER AND SEWER FORCE MAIN PROFILE**  
 READSBORO, VERMONT

**C2**

READSBORO  
 BRO 1441(25)  
 WATER AND SEWER MAIN FORCE PROFILE  
 SHEET 34 OF 80  
 DWG. NO. 416006-C2ED  
 SHEET 1 OF 1

NO WATER MAIN WAS INSTALLED,  
 ONLY THE SLEEVE THROUGH THE  
 ABUTMENTS AND THE HANGER  
 SUPPORT BRACKETS ON THE BRIDGE  
 WERE INSTALLED

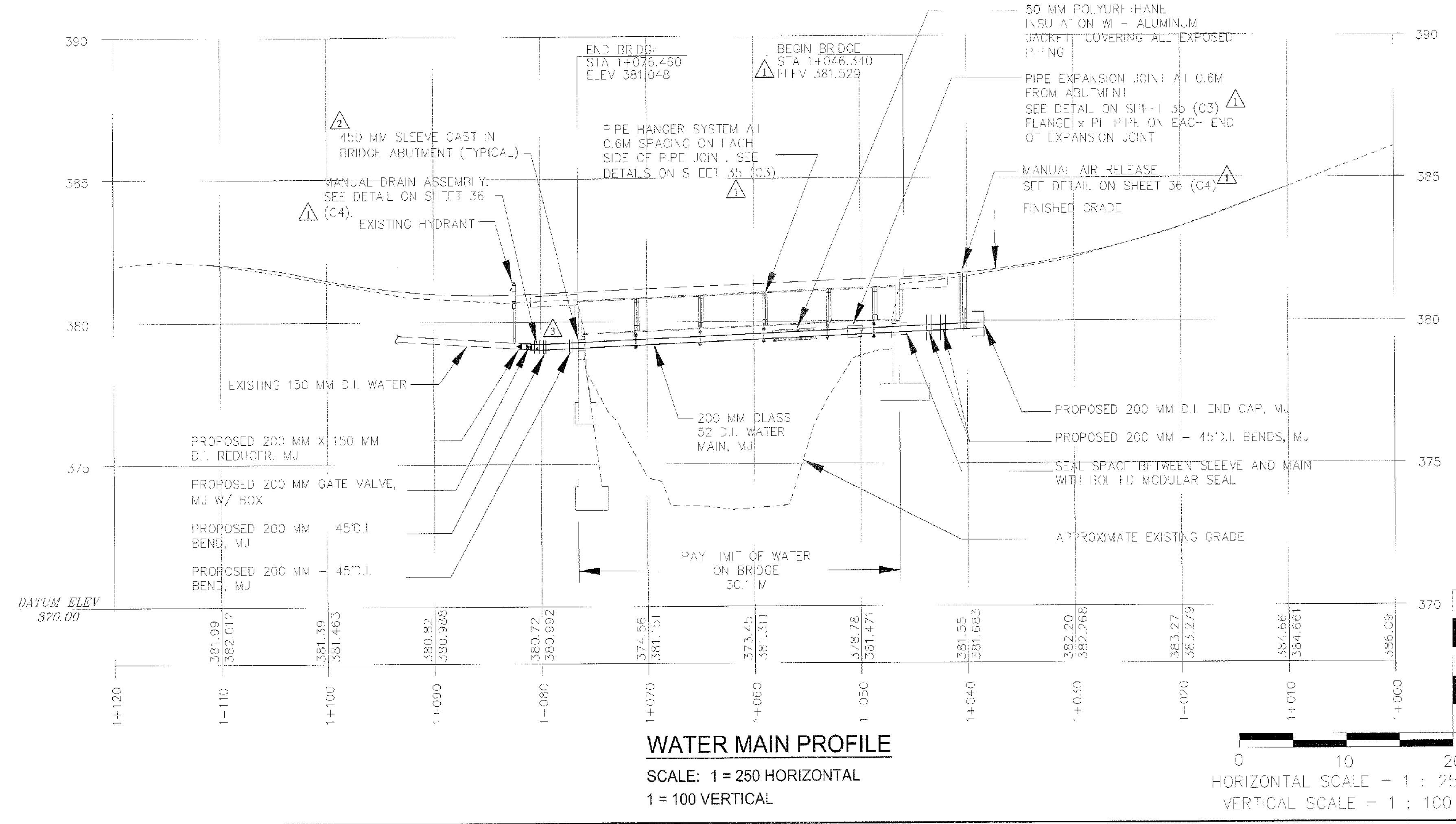
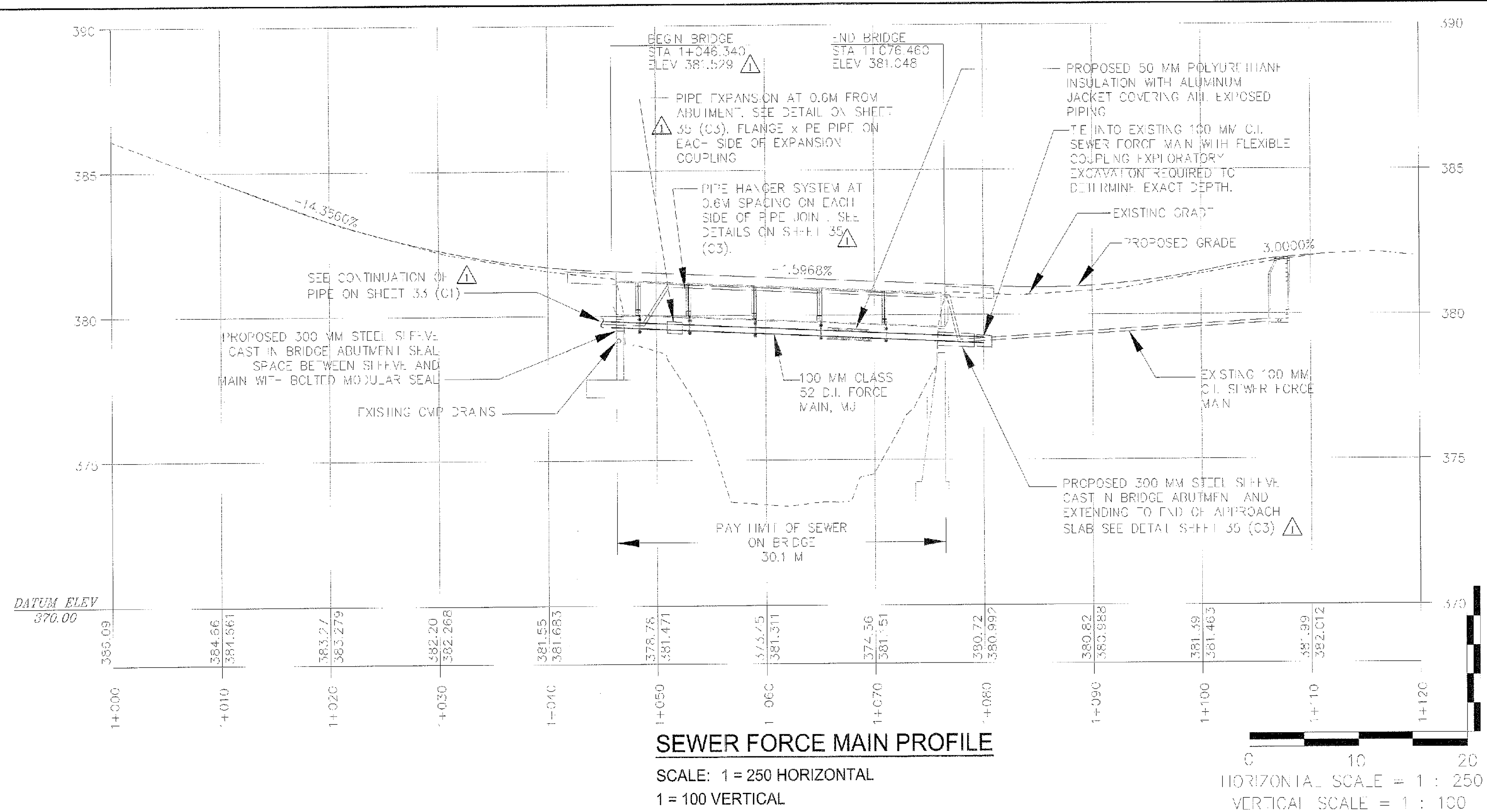

- NOTES:**
- THE DIMENSIONS AND STATIONING SHOWN ON THIS DRAWING FOR BRIDGE SUPPORTS ARE APPROXIMATE AND MAY BE ADJUSTED ON THE BASIS OF APPROVED BRIDGE FABRICATION DRAWINGS. THE CONTRACTOR SHALL NOT FABRICATE THE CROSS BRIDGE PIPING UNTIL APPROVED BRIDGE FABRICATION DRAWINGS ARE AVAILABLE.
  - THE FABRICATED PIPE SUPPORTS ATTACHED TO THE BRIDGE SHALL BE HOT DIPPED GALVANIZED AFTER COMPLETE FABRICATION. ALL HIGH STRENGTH BOLTS, NUTS AND WASHERS AS WELL AS THE PIPE SUPPORT ROLLERS AND SUPPORTING ELEMENTS SHALL BE ELECTROGALVANIZED.
  - THE PIPE LOCATED BETWEEN BRIDGE ABUTMENT SHALL BE INSULATED AND HAVE HEAT TRACING INSTALLED AFTER PLACEMENT.
  - THE PIPE SYSTEM SHALL BE SUPPORTED AND RESTRAINED BY ROLLER PIPE SUPPORTS, SIZED TO PROVIDE FULL SUPPORT FOR THE INSULATED PIPING. THE CONTRACTOR SHALL FURNISH GALVANIZED INSULATION SHIELDS WHERE THE INSULATED PIPE COMES IN CONTACT WITH THE ROLLERS.
  - A HANGED EXPANSION FITTING SHALL BE FURNISHED AND INSTALLED ON THE WEST SIDE OF THE BRIDGE ABUTMENT AS SHOWN ON THE DRAWING. THE EXPANSION JOINT SHALL HAVE A MINIMUM OF 100 MM OF EXPANSION AND BE PROVIDED WITH INTEGRAL EXPANSION STOPS.
  - PIPE FOR BRIDGE CROSSING SHALL BE MECHANICAL JOINT CLASS 52, DUCTILE IRON WITH MEGA-A-LUG RETAINER GLANDS. EACH SECTION OF PIPE SHALL BE SUPPORTED BY AT LEAST TWO PIPE SUPPORTS.
  - ALL GATE VALVES MUST CONFORM TO THE TOWN OF READSBORO STANDARD AND OPEN LEFT (COUNTER CLOCKWISE).
  - ALL PIPING SHALL BE TESTED FOR ELECTRICAL CONTINUITY BEFORE BACKFILLING BENCH OR INSULATION IS APPLIED.
  - "WATER MAIN ON BRIDGE 900.645 SPECIAL PROVISION (WATER MAIN ON BRIDGE)(200MM)" SHALL COVER ALL WORK FROM BRIDGE ABUTMENT BACKWALL TO BRIDGE ABUTMENT BACKWALL. ALL WORK OUTSIDE OF THESE LIMITS WILL BE PAID FOR UNDER THE APPROPRIATE ITEMS.
  - "SEWER FORCE MAIN ON BRIDGE 900.645 (SEWER MAIN ON BRIDGE)(100MM)" SHALL COVER ALL WORK FROM BRIDGE ABUTMENT BACKWALL TO BRIDGE ABUTMENT BACKWALL. ALL WORK OUTSIDE OF THESE LIMITS WILL BE PAID FOR UNDER THE APPROPRIATE ITEMS.

DATE: 12/29/09 10:46:00 AM 11/14/09 09:50 AM 2009 11/14/09