

NOTE: FOR A LIST OF SHEETS AND STANDARDS, SEE SHEET 2

STATE OF VERMONT AGENCY OF TRANSPORTATION



PROPOSED IMPROVEMENT BRIDGE PROJECT TOWN OF READSBORO COUNTY OF BENNINGTON

ROUTE NO : TOWN HIGHWAY 3 (CLASS 2), LOCAL ROAD, BRIDGE NUMBER : 31

PROJECT LOCATION : BEGINNING AT A POINT ON TH 3 APPROXIMATELY 0.12 KM WEST OF THE INTERSECTION OF TH 3 AND VT. RTE 100 AND PROCEEDING EASTERLY ALONG TH 3 FOR 0.09 KM.

PROJECT DESCRIPTION : THE PROJECT SHALL CONSIST OF THE REPLACEMENT OF THE EXISTING STRUCTURE WITH A NEW STRUCTURE INCLUDING ALL NECESSARY APPROACH ROADWAY AND CHANNEL WORK.

LENGTH OF STRUCTURE = 30.120 METERS
LENGTH OF ROADWAY = 55.880 METERS
LENGTH OF PROJECT = 86.000 METERS

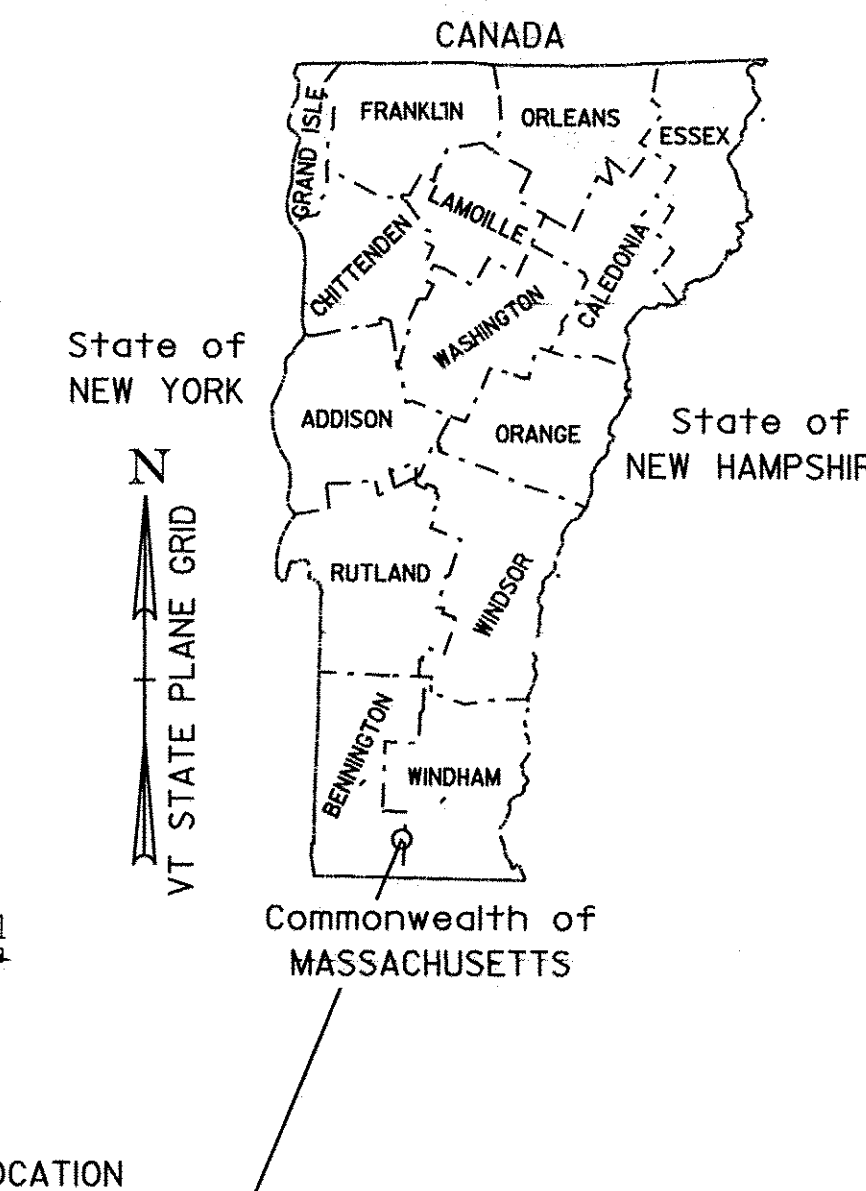
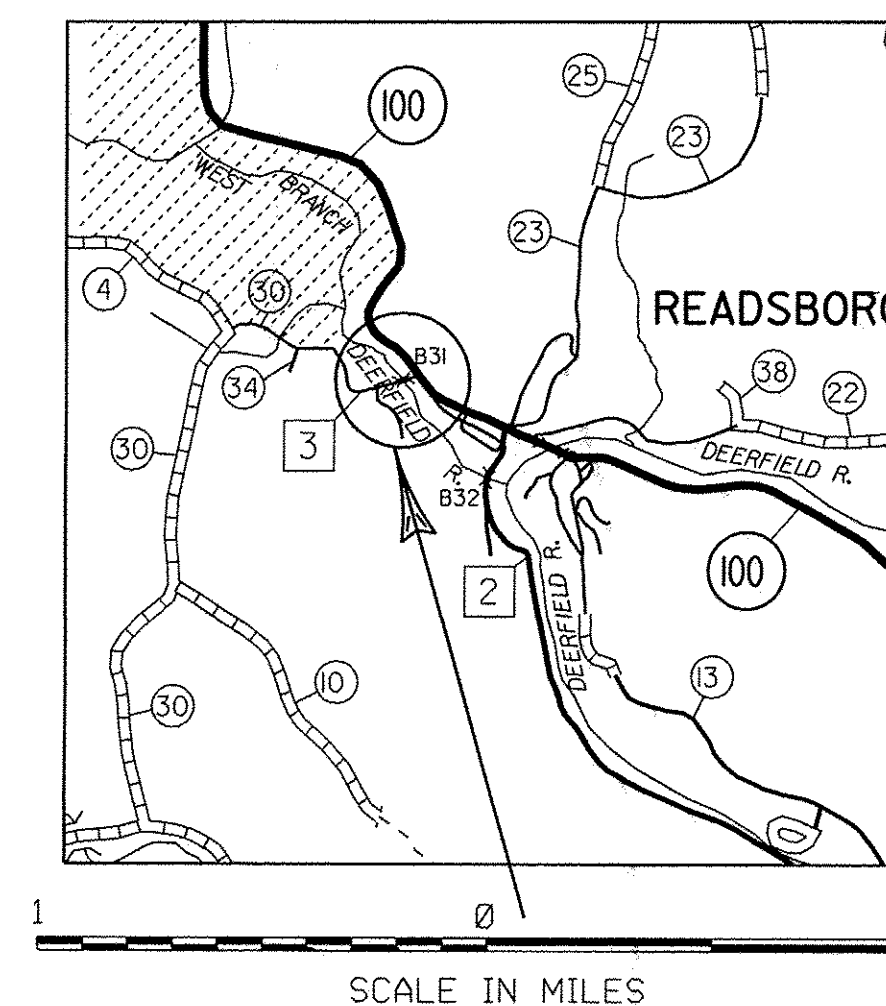

RECORD PLANS	
CONTRACTOR:	COLD RIVER BRIDGES, LLC- KEENE, NH
RESIDENT ENGINEER:	CHRIS WILLIAMS
CONSTRUCTION BEGAN:	MAY 24, 2010
CONSTRUCTION COMPLETE:	MAY 24, 2012
RECORD PLANS BY:	CHRIS WILLIAMS & STEVE KENT
I HEREBY CERTIFY THAT ALL THE CONSTRUCTION REQUIRED BY THIS SET OF DRAWINGS HAS BEEN ACCOMPLISHED AS INDICATED HEREIN.	
BY <i>Chris Williams</i>	RESIDENT ENGINEER
DATE <i>4/15/2013</i>	
NOTE: Any further information concerning final quantities, amounts or other details relative to this project may be found at Central Files in the electronic archives.	

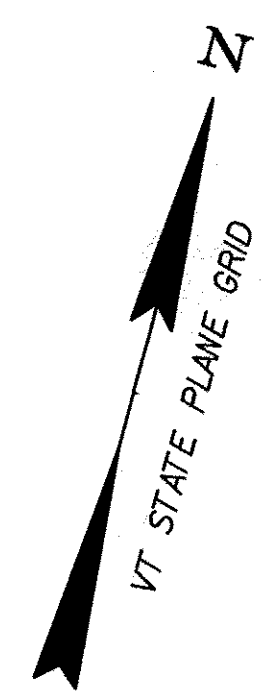
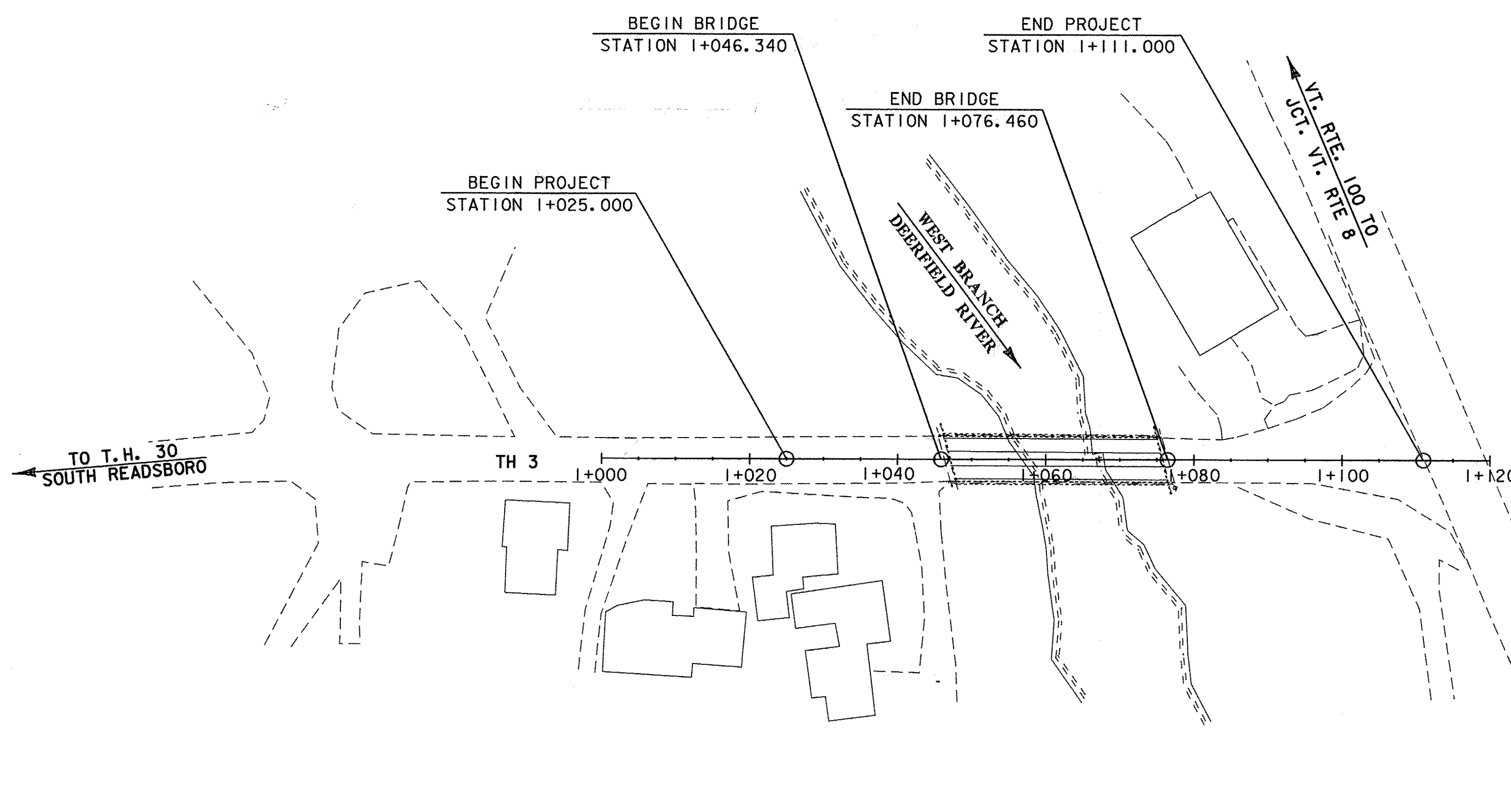

CONVENTIONAL SYMBOLS	
COUNTY LINE	
TOWN LINE	
LIMITS OF ACCESS	
POINT OF ACCESS	
FENCE LINE	
STONE WALL	
TRAVELED WAY	
GUARD RAIL	
RAILROAD	
SURVEY LINE	
CULVERT	
POWER POLE	
TELEPHONE POLE	
TREES	
CONTROL OF ACCESS	
PROPERTY LINE	
R.O.W. TAKING LINE	
SLOPE RIGHTS	
TOP OF CUT	
TOE OF SLOPE	

SURVEYED BY : L. ORVIS
SURVEYED DATE : JANUARY 1995

DATUM
VERTICAL : NAVD 88
HORIZONTAL : NAD 83/92

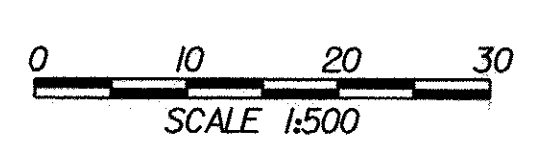

THESE PLANS ARE SUBJECT TO SUCH ENGINEERING CHANGES AS MAY BE REQUIRED BY THE FEDERAL HIGHWAY ADMINISTRATION OR THE DIRECTOR OF PROGRAM DEVELOPMENT.

CONSTRUCTION IS TO BE CARRIED ON IN ACCORDANCE WITH THESE PLANS AND THE STANDARD SPECIFICATIONS FOR CONSTRUCTION DATED 2006, AS APPROVED BY THE FEDERAL HIGHWAY ADMINISTRATION ON JUNE 15, 2006 FOR USE ON THIS PROJECT, INCLUDING ALL SUBSEQUENT REVISIONS AND SUCH REVISED SPECIFICATIONS AND SPECIAL PROVISIONS AS ARE INCORPORATED IN THESE PLANS.

/PW/94J070/sj070bdr.dgn sj070+1.i PLOTTED 05-JAN-2010

Metric

UNLESS NOTED OTHERWISE
STATIONS ARE IN KILOMETERS
ELEVATIONS ARE IN METERS
DIMENSIONS ARE IN MILLIMETERS

DIRECTOR OF PROGRAM DEVELOPMENT	
APPROVED <i>Richard Williams</i>	DATE <i>1-5-10</i>
PROJECT MANAGER : C.P. WILLIAMS	
PROJECT NAME :	READSBORO
PROJECT NUMBER :	BRO 1441 (25)
SHEET 1 OF 60 SHEETS	