

STEEL BEAM GUARD RAIL, GALVANIZED
 CHAN 50+123.7 RT - CHAN 50+140.6 RT

ANCHOR FOR STEEL BEAM RAIL
 CHAN 50+138.3 RT

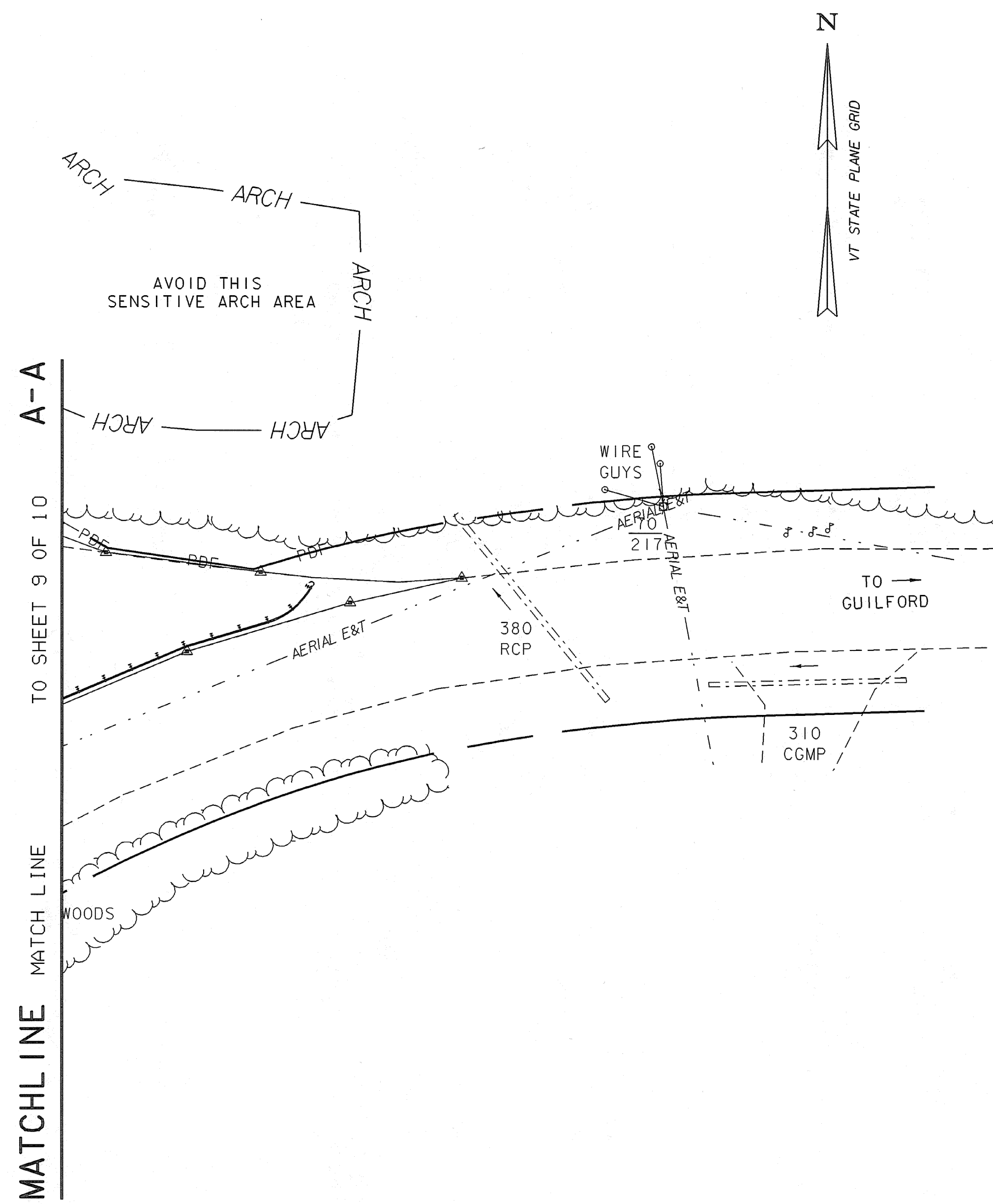

**FOR R.O.W.
 USE ONLY**

LINES SHOWN ON THIS PLAN AS EXISTING
 PROPERTY LINES P/L ARE BELIEVED TO
 BE ACCURATE BUT SHOULD NOT BE RELIED
 UPON FOR PURPOSES UNRELATED TO THE
 TOWN OF GUILFORD'S ACQUISITION OF LAND
 AND RIGHTS FOR THIS PROJECT.

**RIGHT OF WAY
 LAYOUT PLAN 2**

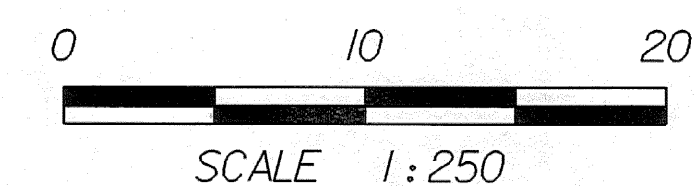

PROJECT NAME:	GUILFORD	PLLOT DATE:	15-APR-2008
PROJECT NUMBER:	BRO 1442(24)	DRAWN BY:	L. BULLOCK
FILE NAME:	sj076102.1	CHECKED BY:	T. LACKEY
PROJECT LEADER:	R. WHITCOMB	R. O. W. SHEET 10 OF 10 SHEETS	SHEET 11 OF 59
DESIGNED BY:	J. PERRIGO		