

PRE-EXCAVATION LIMITS DETAIL

(NOT TO SCALE)

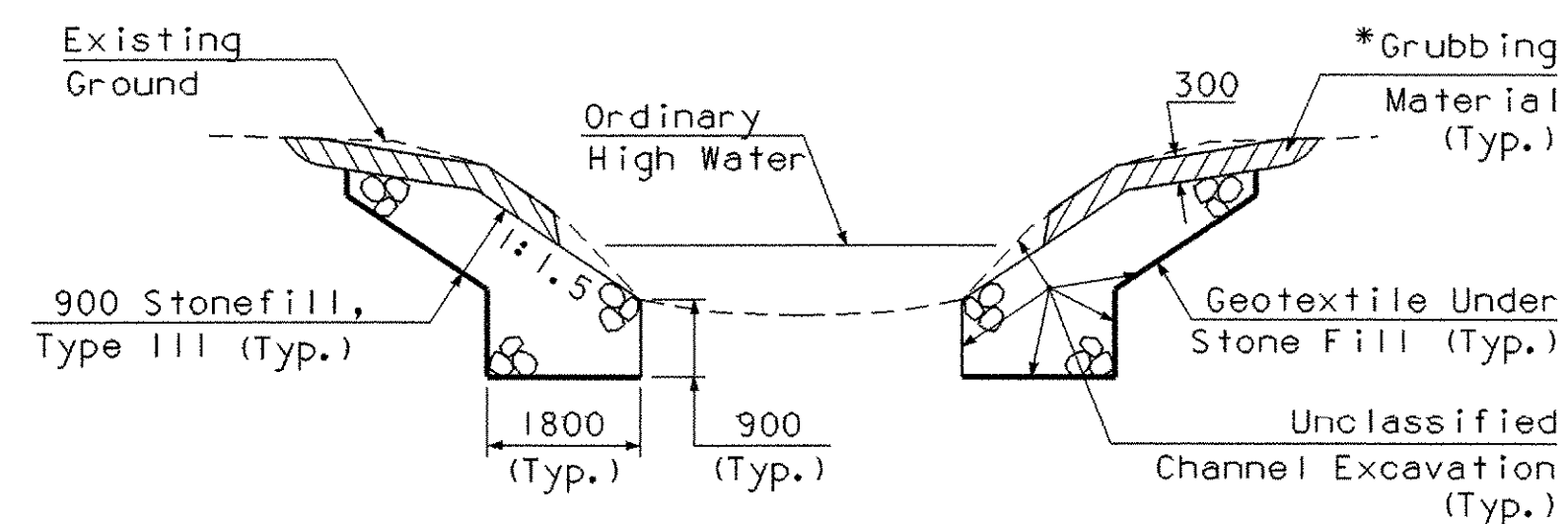

*Grubbing material shall not be placed on the stone fill in the area under the bridge. Whenever channel slope intersects roadway subbase, grubbing material shall begin at the bottom of subbase.

TYPICAL CHANNEL SECTION

(NOT TO SCALE)

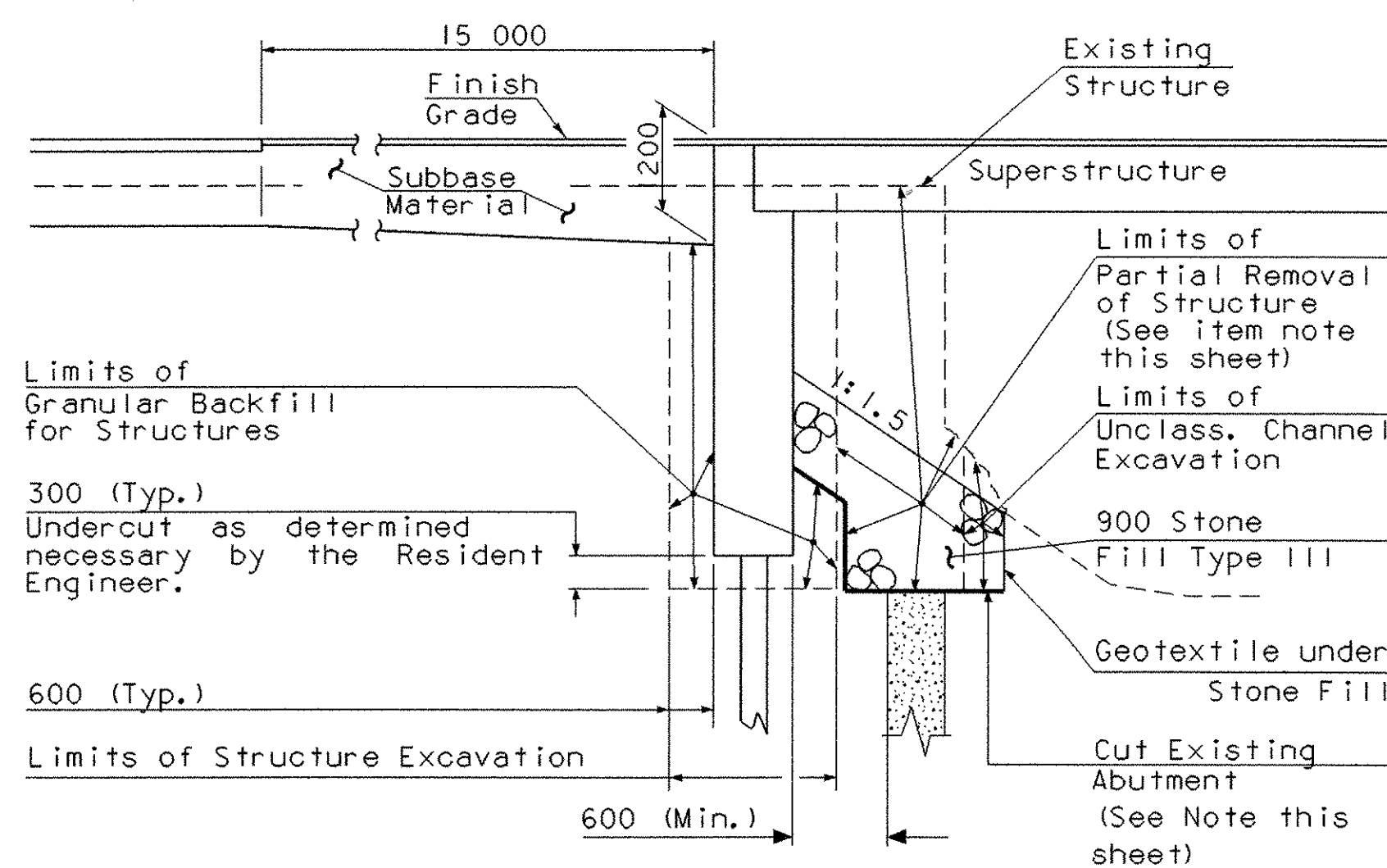

TYPICAL ABUTMENT SECTION

(NOT TO SCALE)

Material Tolerances	
Bituminous Concrete Pavement	±5mm
Aggregate Surface Course	±10mm
Subbase of gravel	±30mm
Sand Borrow	±30mm

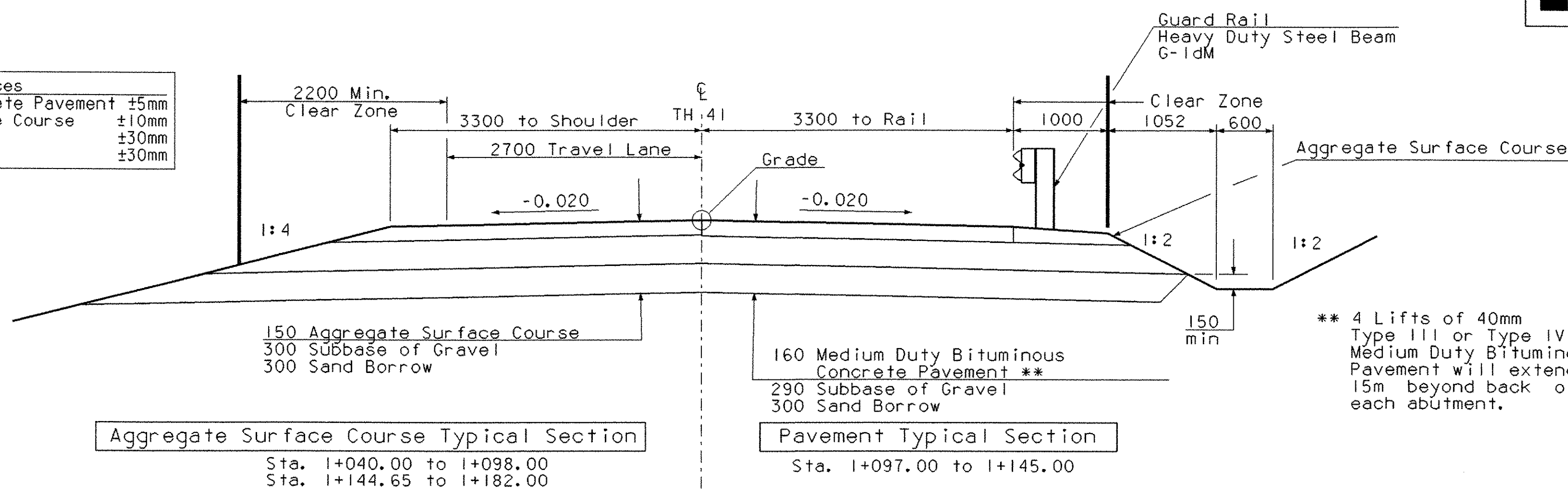

Aggregate Surface Course Typical Section

Pavement Typical Section

** 4 Lifts of 40mm Type III or Type IV (PG 58-34) Medium Duty Bituminous Concrete Pavement will extend 15m beyond back of each abutment.

TYPICAL ROADWAY SECTION

SCALE = 1:40

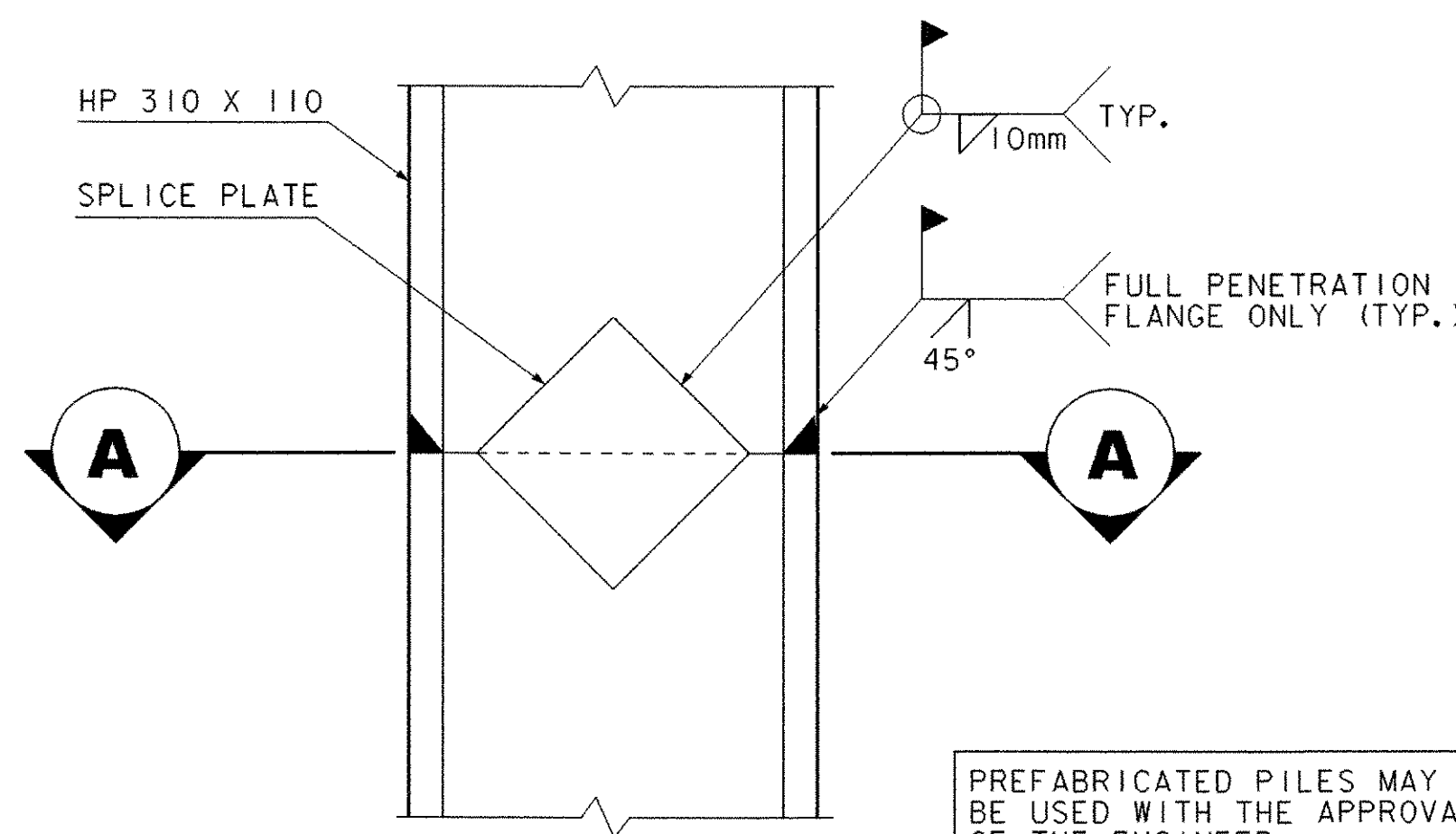

PREFABRICATED PILES MAY BE USED WITH THE APPROVAL OF THE ENGINEER

PILE FIELD SPLICE DETAIL

(NOT TO SCALE)

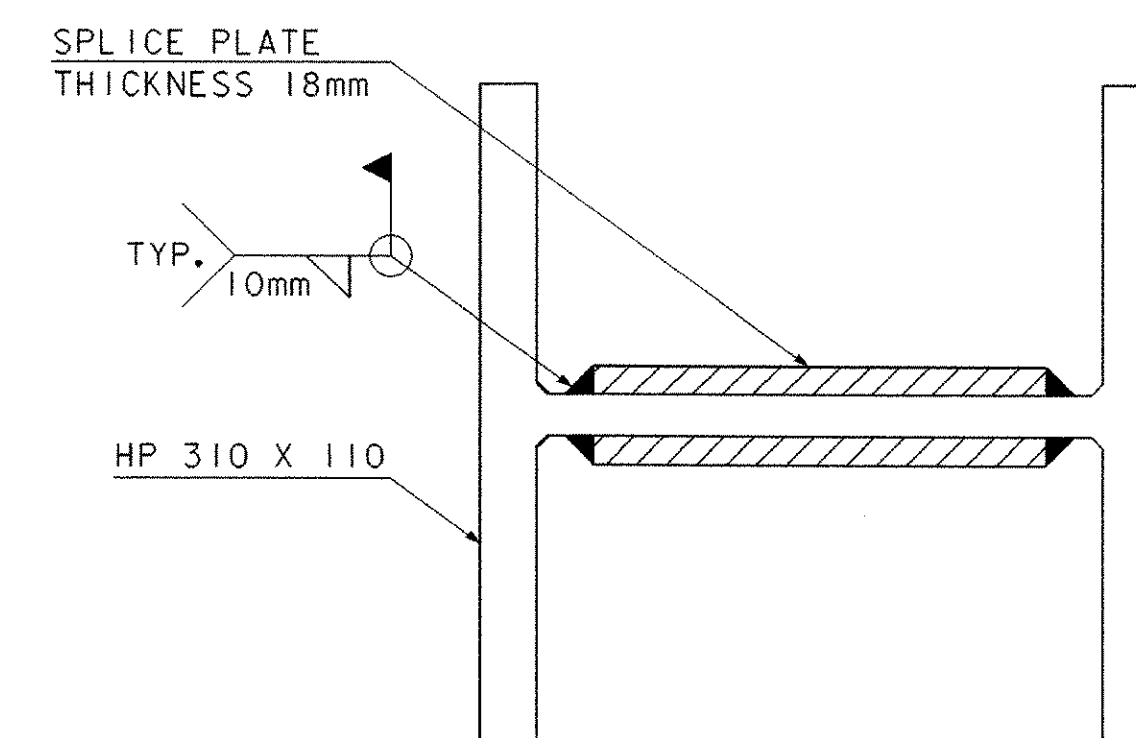

A

NOTES

- Pay Item 529.20 (Partial Removal of Structure)
Superstructure: The superstructure will be moved from its current location to the temporary bridge location, this work will be paid for under 528.10 One-Way Temporary Bridge (Mod.-Existing Modular).
The Contractor is only required to remove the portions of the existing abutments that fall within the areas where the new abutments will be constructed or where stone fill or granular backfill for structures is to be placed. This removal is to be paid for under the item "Partial Removal of Structure".

TYPICAL SECTIONS SHEET

PROJECT NAME: CHARLESTON
PROJECT NUMBER: BRO 1449 (22)

FILE NAME: .../93J051/SJ051TYP.DGN PLOT DATE: 13-APR-2006
PROJECT MANAGER: M. EVANS MONGEON DRAWN BY: G. COLGROVE
DESIGNED BY: G. COLGROVE CHECKED BY:
SHEET 4 OF 50

TYPICAL EARTHWORKS SECTION

(NOT TO SCALE)