

NOTE:
~~THIS PROJECT SHALL CONSIST OF STAGE CONSTRUCTION.~~
~~STAGE 1 IS SHOWN, STAGE 2 IS SIMILAR. SEE STAGE~~
~~CONSTRUCTION DETAILS FOR MORE INFORMATION.~~

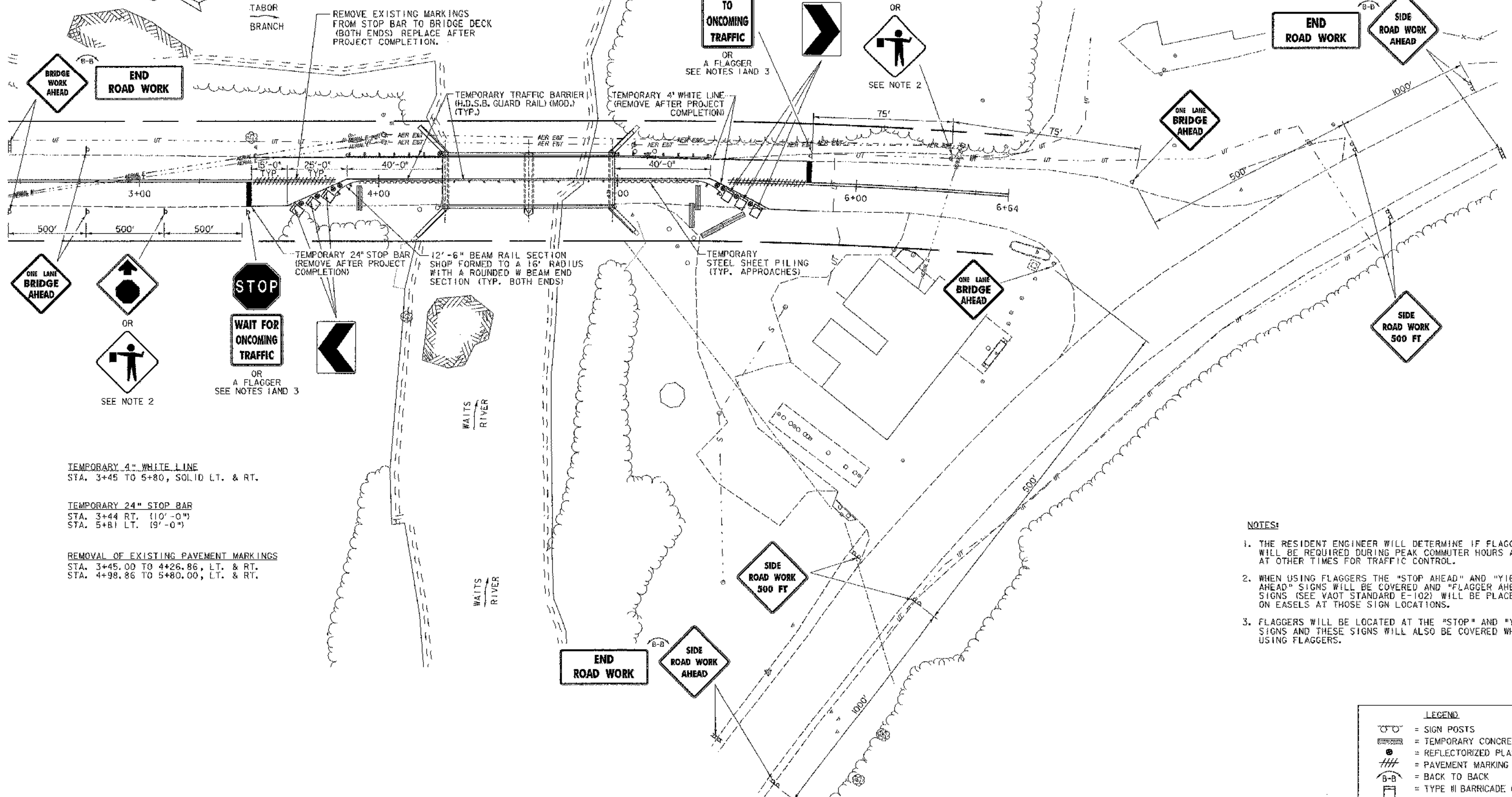

TEMPORARY 4" WHITE LINE
 STA. 3+45 TO 5+80, SOLID LT. & RT.

TEMPORARY 24" STOP BAR
 STA. 3+44 RT. (10'-0")
 STA. 5+81 LT. (9'-0")

REMOVAL OF EXISTING PAVEMENT MARKINGS
 STA. 3+45.00 TO 4+26.86, LT. & RT.
 STA. 4+98.86 TO 5+80.00, LT. & RT.

- NOTES:**
1. THE RESIDENT ENGINEER WILL DETERMINE IF FLAGGERS WILL BE REQUIRED DURING PEAK COMMUTER HOURS AND AT OTHER TIMES FOR TRAFFIC CONTROL.
 2. WHEN USING FLAGGERS THE "STOP AHEAD" AND "YIELD AHEAD" SIGNS WILL BE COVERED AND "FLAGGER AHEAD" SIGNS (SEE VAOT STANDARD E-102) WILL BE PLACED ON EASELS AT THOSE SIGN LOCATIONS.
 3. FLAGGERS WILL BE LOCATED AT THE "STOP" AND "YIELD" SIGNS AND THESE SIGNS WILL ALSO BE COVERED WHEN USING FLAGGERS.

| LEGEND | |
|--------|------------------------------|
| | = SIGN POSTS |
| | = TEMPORARY CONCRETE BARRIER |
| | = REFLECTORIZED PLASTIC DRUM |
| | = PAVEMENT MARKING REMOVAL |
| | = BACK TO BACK |
| | = TYPE III BARRICADE (MOD.) |

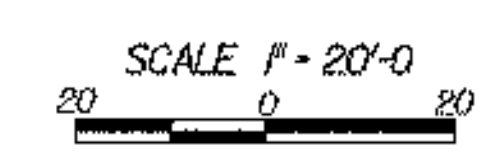

| | | |
|-----------------------------|---|-----------------------|
| | PROJECT NAME: CORINTH | PLOT DATE: 05/07/2003 |
| | PROJECT NUMBER: TH2-9352 | DRAWN BY: AET |
| | FILE NAME: ...Cor-stageplan.dgn | CHECKED BY: MJC |
| | PROJECT LEADER: MJC DESIGNED BY: SEB | SHEET 10 OF 28 |
| TRAFFIC STAGING PLAN | | |