

**NOTE:**

PRIOR TO THE BEGINNING OF WORK AND IN ACCORDANCE WITH SECTION 652 OF THE SPECIAL PROVISIONS, THE CONTRACTOR SHALL SUBMIT FOR THE RESIDENT ENGINEER'S APPROVAL AN EROSION AND SEDIMENT CONTROL PLAN SEPARATE FROM THIS SHEET.

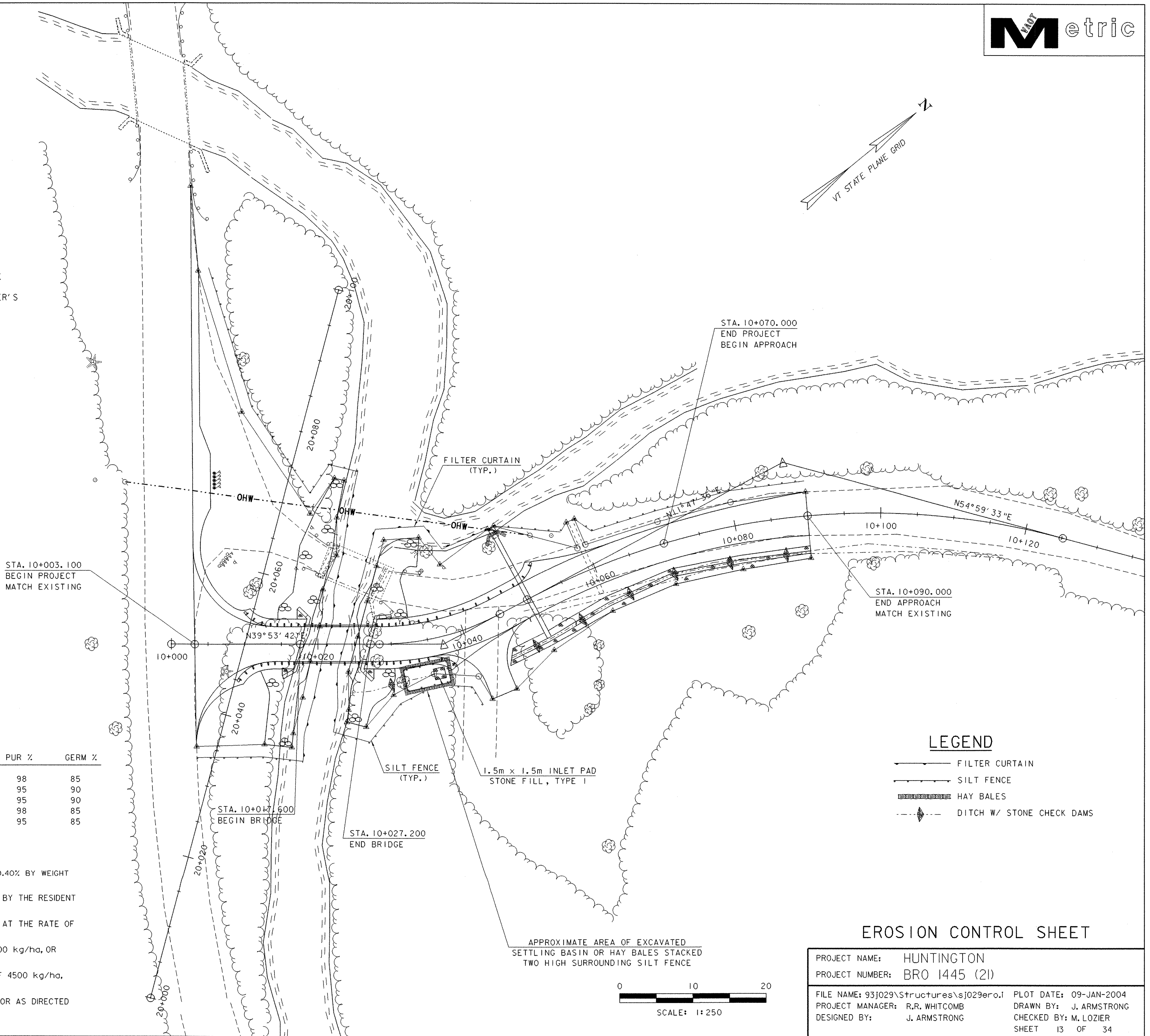

**SEEDING FORMULA  
RURAL AREAS**

% WT.	kg/ha	NAME	PUR %	GERM %
37.5	26.0	CREeping RED FESCUE	98	85
37.5	26.0	TALL FESCUE	95	90
5.0	4.0	RED TOP	95	90
15.0	10.0	BIRDSFOOT TREFOIL	98	85
5.0	4.0	ANNUAL RYE GRASS	95	85
100.0	70.0			

**GENERAL NOTES**

- SEED MIXTURE: SHALL NOT HAVE A WEED CONTENT EXCEEDING 0.40% BY WEIGHT AND SHALL BE FREE OF ALL NOXIOUS SEED.
- SEED: TO BE APPLIED PER SEEDING FORMULAS OR AS DIRECTED BY THE RESIDENT ENGINEER.
- FERTILIZER: FORMULA 10-20-10, TO BE USED WITH SEED, APPLIED AT THE RATE OF 560 kg/ha. (HYDRO SEEDERS MAY USE 19-19-19 FORMULA).
- AGRICULTURAL LIMESTONE: TO BE APPLIED AT THE RATE OF 4500 kg/ha, OR AS DIRECTED BY THE RESIDENT ENGINEER.
- HAY MULCH: TO BE PLACED ON EARTH SLOPES AT THE RATE OF 4500 kg/ha, OR AS DIRECTED BY THE RESIDENT ENGINEER.
- TOPSOIL: TO BE USED WITH SEED AS INDICATED ON THE PLANS, OR AS DIRECTED BY THE RESIDENT ENGINEER.

**LEGEND**

- FILTER CURTAIN
- SILT FENCE
- HAY BALES
- DITCH W/ STONE CHECK DAMS

**EROSION CONTROL SHEET**

PROJECT NAME:	HUNTINGTON	FILE NAME:	93j029\Structures\sj029ero.1	PLOT DATE:	09-JAN-2004
PROJECT NUMBER:	BRO 1445 (21)	PROJECT MANAGER:	R.R. WHITCOMB	DRAWN BY:	J. ARMSTRONG
		DESIGNED BY:	J. ARMSTRONG	CHECKED BY:	M. LOZIER
				SHEET	13 OF 34

