



525.41 BRIDGE RAILING - HD STEEL BEAM/FASCIA MOUNTED, TYPE D

STN 1+127.3 - 1+140.6 RT.
STN 1+131.4 - 1+144.8 LT.

621.21 HEAVY DUTY STEEL BEAM GUARD RAIL, TYPE 4

STN 1+107.0 - 1+127.3 RT.
STN 1+140.6 - 1+151.0 RT.
STN 1+118.0 - 1+131.4 LT.
STN 1+144.8 - 1+157.0 LT.

601.2615 450 CPEP OR (CSP OPTION)

STN 1+070.0 RT. -LT.

CONSTRUCT BERM

CHAN. STN 2+022 - 2+030

621.60 ANCHOR FOR STEEL BEAM GUARD RAIL

STN 1+109.0 RT.
STN 1+120.5 LT.
STN 1+149.5 RT.
STN 1+154.5 LT.

Curve #2
Radius: 140.000
Delta: 16°43'39.5"L
Length: 40.873
Tangent: 20.583
Chord: 40.728
Ordinate: 1.489
External: 1.505
2T-L: 0.293
Banking: 0.040

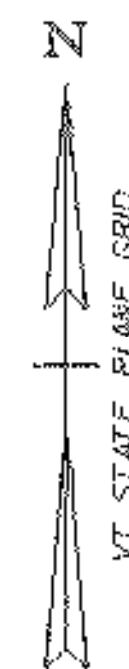

Curve #1
Radius: 140.000
Delta: 32°28'27.4"L
Length: 79.350
Tangent: 40.772
Chord: 78.292
Ordinate: 5.584
External: 5.816
2T-L: 2.195

BENCHMARK #1
CH. SQ. IN BOULDER
ELEV 418.054

BENCHMARK #2
VERMONT SURVEY MARK
STAMPED "RCF-1 1994"
ELEV 421.512

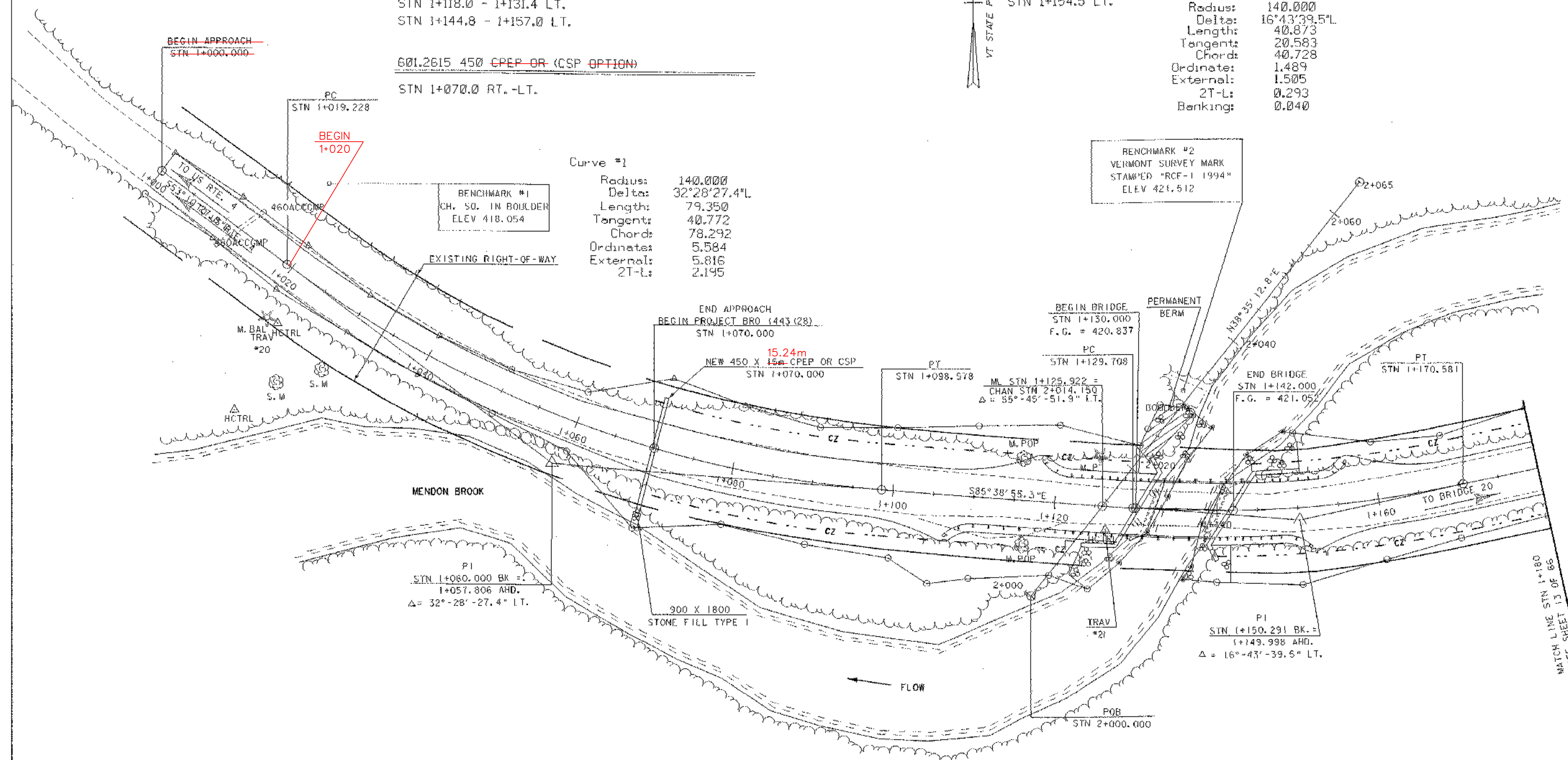

EXISTING BRIDGE DATA

BRIDGE WIDTH: 4.27 m
ROADWAY WIDTH: 5.49 m
BRIDGE LENGTH: 8.53 m
CLEAR SPAN: 6.7 m
CLEAR HEIGHT: 2.4 m
THE EXISTING STRUCTURE IS A CONCRETE DECK ON ROLLED BEAM STRINGERS.
THE EXISTING ABUTMENTS ARE POURED IN PLACE CONCRETE.
THERE IS ALSO AN EXISTING BAILEY BRIDGE.

C.Z. = CLEAR ZONE



| | |
|---|-------------------------------|
| PROJECT: MENDON | PROJECT NO.: BRO 1443 (28) |
| DESIGN FILE NAME: /USR/STRI/93J022/SJ022BOR.DGN | PLT DATE: 5-JUN-1998 |
| IPARM FILE NAME: SJ022LSJ | PLAN SHEET |
| SHEET: 12 OF 66 | |