

# STATE OF VERMONT AGENCY OF TRANSPORTATION

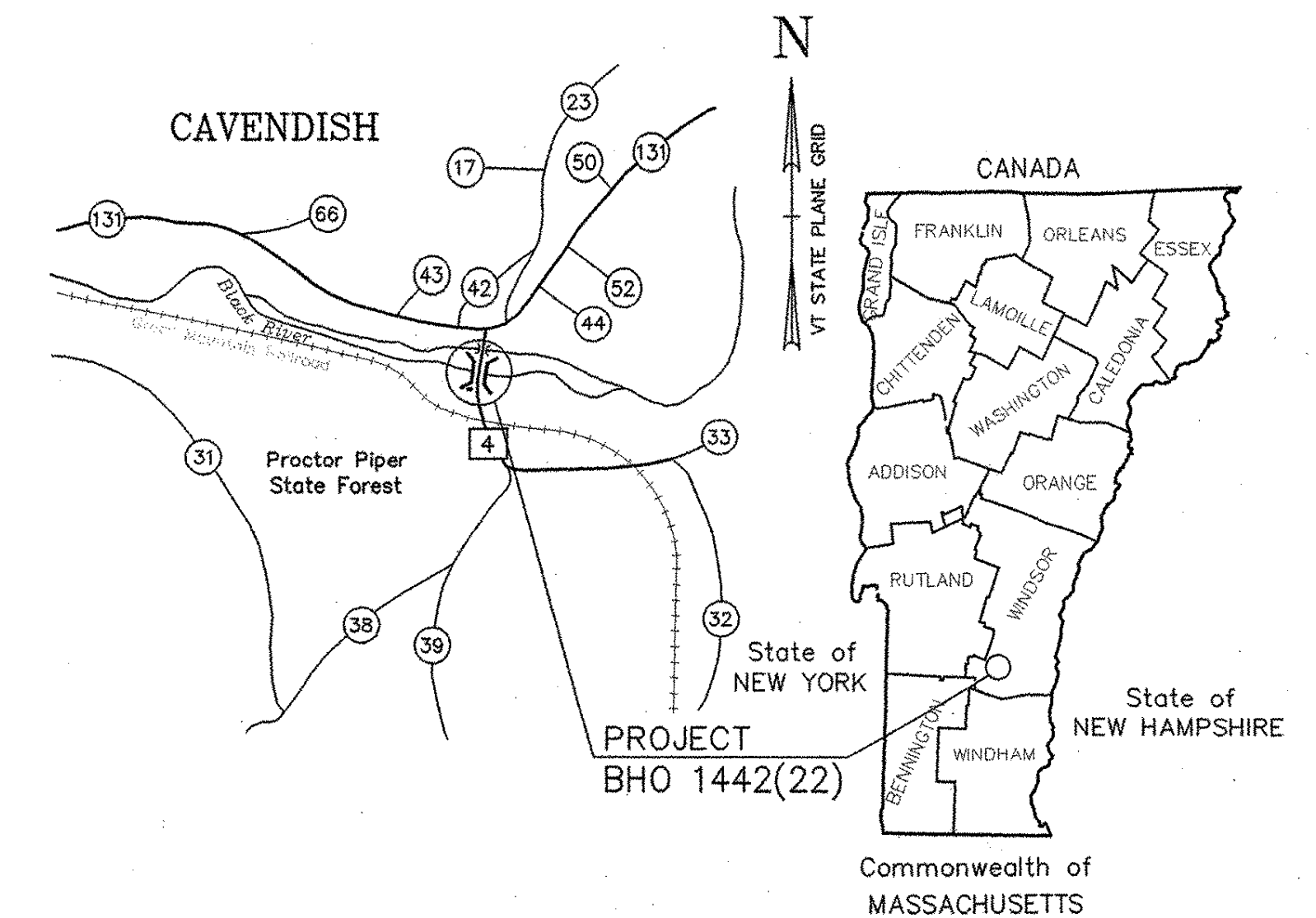

## PROPOSED IMPROVEMENT BRIDGE PROJECT

TOWN OF CAVENDISH  
COUNTY OF WINDSOR



LOCATION MAP

INDEX OF SHEETS

1	TITLE SHEET
2	PRELIMINARY INFORMATION SHEET
3	QUANTITY SHEET
4	RIGHT OF WAY SHEET
5	RIGHT OF WAY SHEET
6	TIE SHEET AND TYPICAL DETAILS
7	ROADWAY PLAN
8	PROFILE
9	PLAN AND ELEVATION
10	EROSION CONTROL PLAN
11	CONSTRUCTION NOTES
12	TRUSS REHABILITATION KEY & DETAILS
13	TRUSS REPAIR DETAILS (1 OF 2)
14	TRUSS REPAIR DETAILS (2 OF 2)
15	FLOOR SYSTEM FRAMING
16	GUSSET PLATE & SIDEWALK BRACKET DETAILS
17	DECK JOINT & SIDEWALK END DETAILS
18	SIDEWALK & ORNAMENTAL RAIL DETAILS
19	BEARING DETAILS
20	BRIDGE RAIL DETAILS
21	APPROACH RAIL DETAILS
22	ABUTMENT ELEVATIONS
23	ABUTMENT 1 MODIFICATIONS
24	ABUTMENT 2 MODIFICATIONS
25	REINFORCING STEEL SCHEDULE
26 - 31	ROADWAY CROSS SECTIONS
32 - 34	CHANNEL CROSS SECTIONS

STANDARDS

A-76M	6-13-97	E-111M	2-17-98
B-5M	1-3-00	E-120M	6-13-97
C-1M	1-3-00	E-121M	6-13-97
C-2AM	1-3-00	E-160M	6-13-97
C-3M	1-3-00	E-161M	6-13-97
E-100AM	2-2-98	E-162M	6-13-97
E-100M	6-13-97	E-163M	6-13-97
E-101M	6-13-97	E-164M	6-13-97
E-102AM	6-13-97	E-191M	2-1-99
E-102M	6-13-97	E-192M	12-28-98
E-103M	9-24-98	E-193M	6-13-97
E-106M	6-13-97	F-2M	1-3-00
E-107AM	6-13-97	G-1bM	6-13-97
E-107M	6-13-97	T-1M	6-13-97
E-108	6-13-97	T-2M	6-13-97

ROUTE NO. T.H. 4 (CLASS 2), BRIDGE NO. 12

PROJECT LOCATION: BEGINNING AT A POINT 0.117 km SOUTH OF THE INTERSECTION OF VT 131 AND T.H. 4 AND EXTENDING NORTHERLY 31.24 m.

PROJECT DESCRIPTION: INSTALLATION OF A NEW FLOOR SYSTEM AND DECK, REHABILITATION OF EXISTING TRUSSES AND SUBSTRUCTURE AND ROADWAY APPROACHES

LENGTH OF STRUCTURE: 31.240 m

LENGTH OF ROADWAY: 0.000 m

LENGTH OF PROJECT: 31.240 m

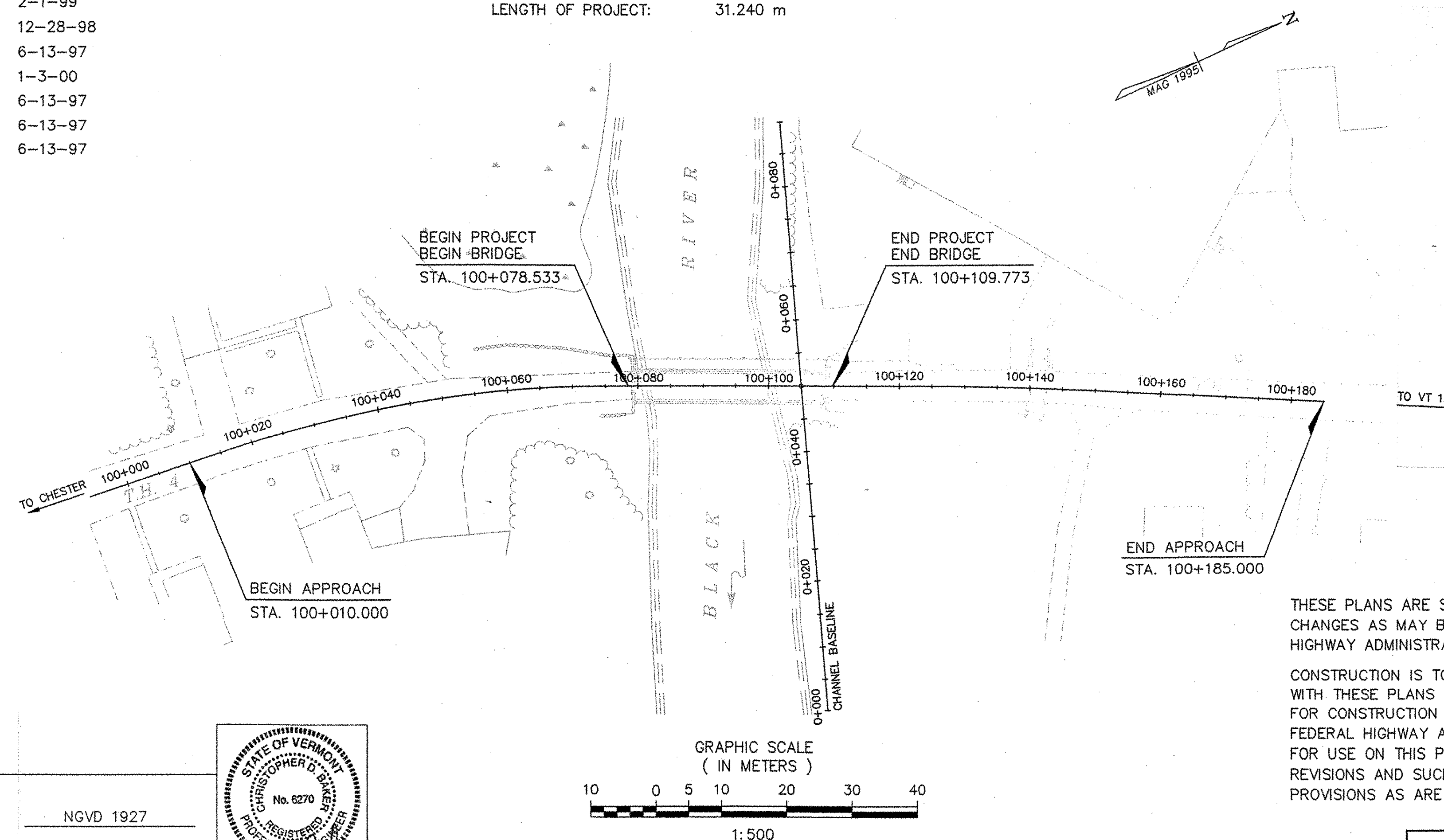

CONVENTIONAL SIGNS

---	COUNTY LINE
---	TOWN LINE
---	LIMITS OF ACCESS
X	POINT OF ACCESS
-x-x-	FENCE LINE
o-o-o-o	STONE WALL
---	TRAVELED WAY
---	GUARD RAIL
---	RAILROAD
---	SURVEY LINE
---	CULVERT
o	UTILITY POLE
o	TREES
///	CONTROL OF ACCESS
---	PROPERTY LINE
---	R.O.W.
SR	SLOPE RIGHTS
△	TOP OF CUT
○	TOE OF CONST. SLOPE

DATUM  
VERTICAL NGVD 1927  
HORIZONTAL ASSUMED

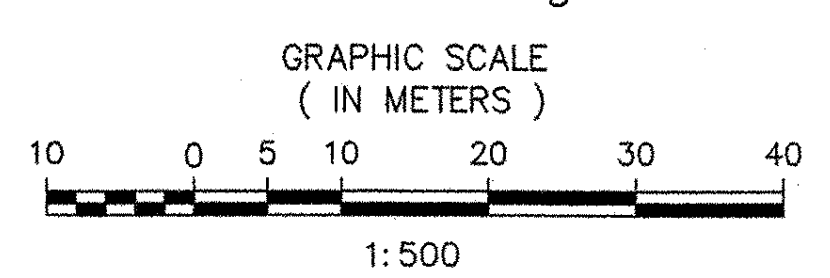
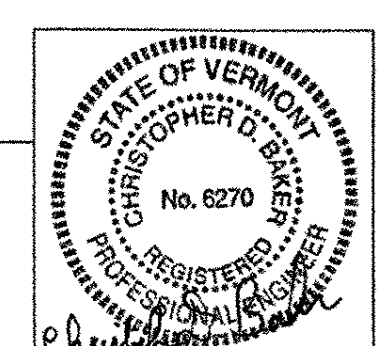

RECORD PLANS

CONTRACTOR: MILLER CONSTRUCTION INC. - WINDSOR VT

RESIDENT ENGINEER: GERALD COLBY

CONSTRUCTION BEGAN: APRIL 13, 2004

CONSTRUCTION COMPLETE: MAY 25, 2005

RECORD PLANS BY: G. COLBY & N. GARBACIK

I HEREBY CERTIFY THAT ALL THE CONSTRUCTION REQUIRED BY THIS SET OF DRAWINGS HAS BEEN ACCOMPLISHED AS INDICATED HEREIN.

BY: *[Signature]* RESIDENT ENGINEER

DATE: 2/18/06

NOTE: Any further information concerning final quantities, amounts or other details relative to this project may be found at Central Files in the electronic archives.



UNLESS OTHERWISE NOTED, ALL STATIONS ARE IN KILOMETERS, ALL ELEVATIONS ARE IN METERS, AND ALL DIMENSIONS ARE IN MILLIMETERS

THESE PLANS ARE SUBJECT TO SUCH ENGINEERING CHANGES AS MAY BE REQUIRED BY THE FEDERAL HIGHWAY ADMINISTRATION.

CONSTRUCTION IS TO BE CARRIED ON IN ACCORDANCE WITH THESE PLANS AND THE STANDARD SPECIFICATIONS FOR CONSTRUCTION DATED 2001, AS APPROVED BY THE FEDERAL HIGHWAY ADMINISTRATION ON JANUARY 4, 2001 FOR USE ON THIS PROJECT, INCLUDING ALL SUBSEQUENT REVISIONS AND SUCH REVISED SPECIFICATIONS AND SPECIAL PROVISIONS AS ARE INCORPORATED IN THESE PLANS.

VANASSE HANGEN BRUSTLIN, INC.

SUBMITTED BY ORDER OF THE STATE TRANSPORTATION BOARD

APPROVED: *[Signature]* DATE 1/29/04  
DIRECTOR OF PROGRAM DEVELOPMENT

PROJECT CAVENDISH BHO 1442(22)  
SHEET 1 OF 34 SHEETS