

GENERAL NOTES:

1- MATERIAL: ASTM A709 GRADE 50W

ALL MEMBERS MARKED (CVN) MUST MEET THE CHARPY V-NOTCH TESTING REQUIREMENTS AS INDICATED IN SECTION 714 OF VERMONT AGENCY OF TRANSPORTATION SPECIFICATIONS FOR CONSTRUCTION.

BEARING STIFFENERS SHALL BE PLUMB AND PERPENDICULAR TO THE WEB IN THEIR FINAL POSITION.

DEAD LOAD DEFLECTION IS DUE TO GIRDER, DIAPHRAGMS, DECK, CURB AND RAILING.

2- WELDING: ALL WELDING SHALL CONFORM TO THE PROVISIONS OF VERMONT SPECIFICATION 506.10

3- BOLTS: ANY HOLES IN THE WEBS OF THE FASCIA BEAMS/GIRDERS THAT ARE NOT OTHERWISE FILLED, SHALL BE FILLED WITH EITHER BUTTON HEAD OR HEX HEAD BOLTS. THESE BOLTS SHALL BE TIGHTENED IN ACCORDANCE WITH VERMONT SPECIFICATION 506.19.

FIELD CONNECTION SHALL BE MADE WITH 22mm DIAMETER AASHTO DESIGNATION M164M TYPE III BOLTS IN 24mm DIAMETER HOLES, EXCEPT CONNECTION BETWEEN LATERAL BRACING AND BOTTOM FLANGE WHICH REQUIRE 20 DIAMETER BOLTS AND 22 AND 24 DIAMETER HOLES. ALL CONNECTIONS MADE WITHIN PAINTED AREAS SHALL BE MADE WITH M164M TYPE 1 GALVANIZED BOLTS. SEE ERECTION PLAN FOR DETAILS.

4- PAINT: ALL STEEL MEMBERS AND CONNECTION COMPONENTS WITHIN 2400mm OF EXPANSION ENDS OF THE GIRDERS SHALL BE PAINTED AND GREASED, **except Girder 1**

will have both ends painted & greased, all have both ends painted

Paint System?

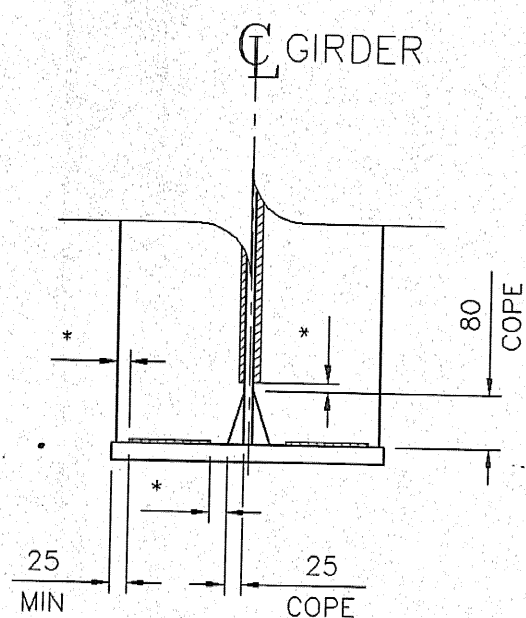

* NO WELD FOR 10 MIN. ²⁰18 MAX (EXCEPT MUST MAINTAIN 25 MIN. FROM EDGE OF FLANGE.)

WELD TERMINATION AND COPING DETAILS FOR STEEL MEMBERS

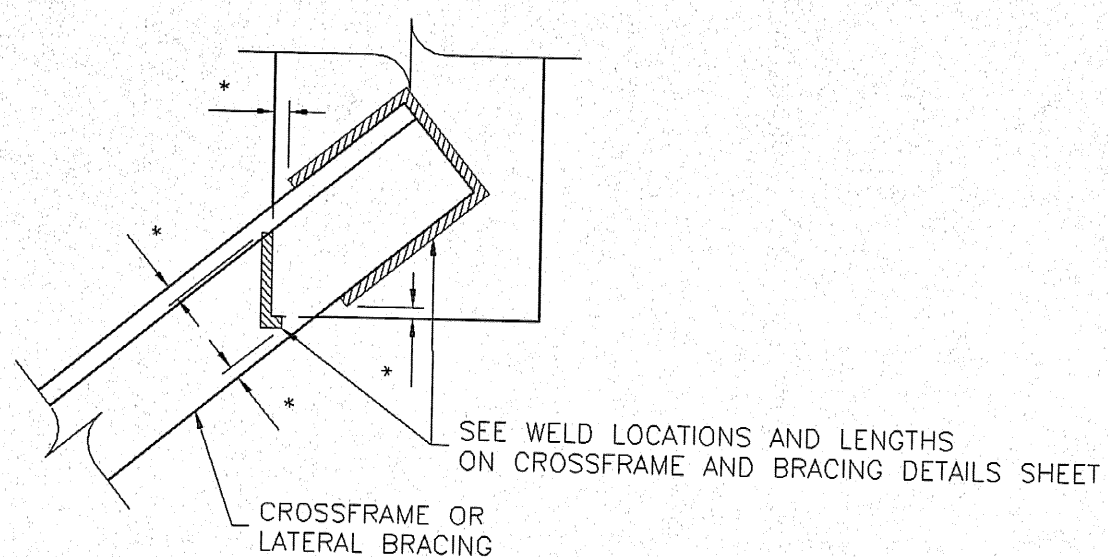

* NO WELD FOR ⁶5 MIN. 13 MAX

WELD LOCATION DETAIL AT CROSSFRAMES AND LATERAL BRACING

RECEIVED
OK'D BY: *Duc* OK'D BY: *DRP*
MAR 07 2007
RESUBMIT APPROVED AS NOTED
BY: *Duc* DATE: *3/30/07*

S. Frudens copy

ALL MATERIAL (EXCEPT BOLTS) TO BE ASTM:		A709M-50W	
ALL WELDS TO BE MADE WITH ELECTRODES SERIES E XXX			
OPEN HOLES ARE FOR H.S. BOLTS AND ARE TO BE FREE OF BURRS AND SCALE			
BOLTS: 7/8" A325M TYPE III	OPEN HOLES: 24 UN	PAINT: SEE GN-1	
International Bridge & Iron Co. 90 Day Street Newington, CT. 06111			
VERMONT DOT SUNDERLAND BRIDGE FED. AID PROJ. NO.: BRP-0114 (2) CONTRACTOR: PETRICCA CONSTRUCTION CORP. ENGINEER: ROGER WHITCOMB			
For Approval	Revised	Issue to Shop	GENERAL NOTES
			Drawn by: K. E. Date: 02/28/07 Checked by: G. D. Date: 03/01/07
		Contract	Suffix Dwg. Number
		606	GN1