

DRIVE HORIZONTAL CURVE DATA					
DRIVE	1	2	3	4	5
MAINLINE	3+564.000 LEFT	3+568.000 RIGHT	3+593.40 RIGHT	3+695.000 LEFT	S/L 4+010.000 RIGHT
DELTA	28 -26'-07.6 LT	14 -53'-53.6 LT	37 -17'-35.7 RT		25 -17'-19.2 LT
RADIUS	15,000	20,000	12,000		28,000
TANGENT	3.801	2.615	4.049		6.281
LENGTH	7.444	5.200	7.811		12.358
EXTERNAL	0.474	0.170	0.665		0.696
DELTA	68 -09'-27.2 LT				
RADIUS	11,800				
TANGENT	7.983				
LENGTH	14.037				
EXTERNAL	2.447				

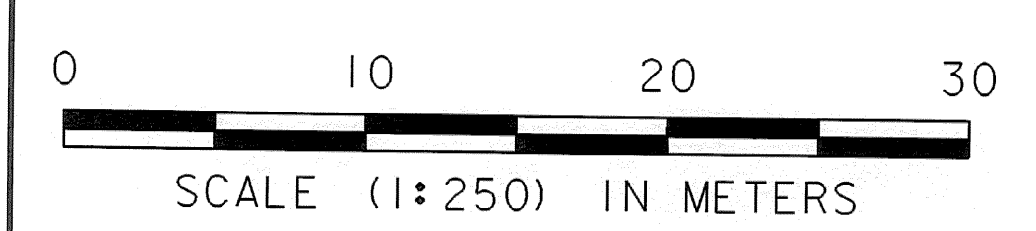
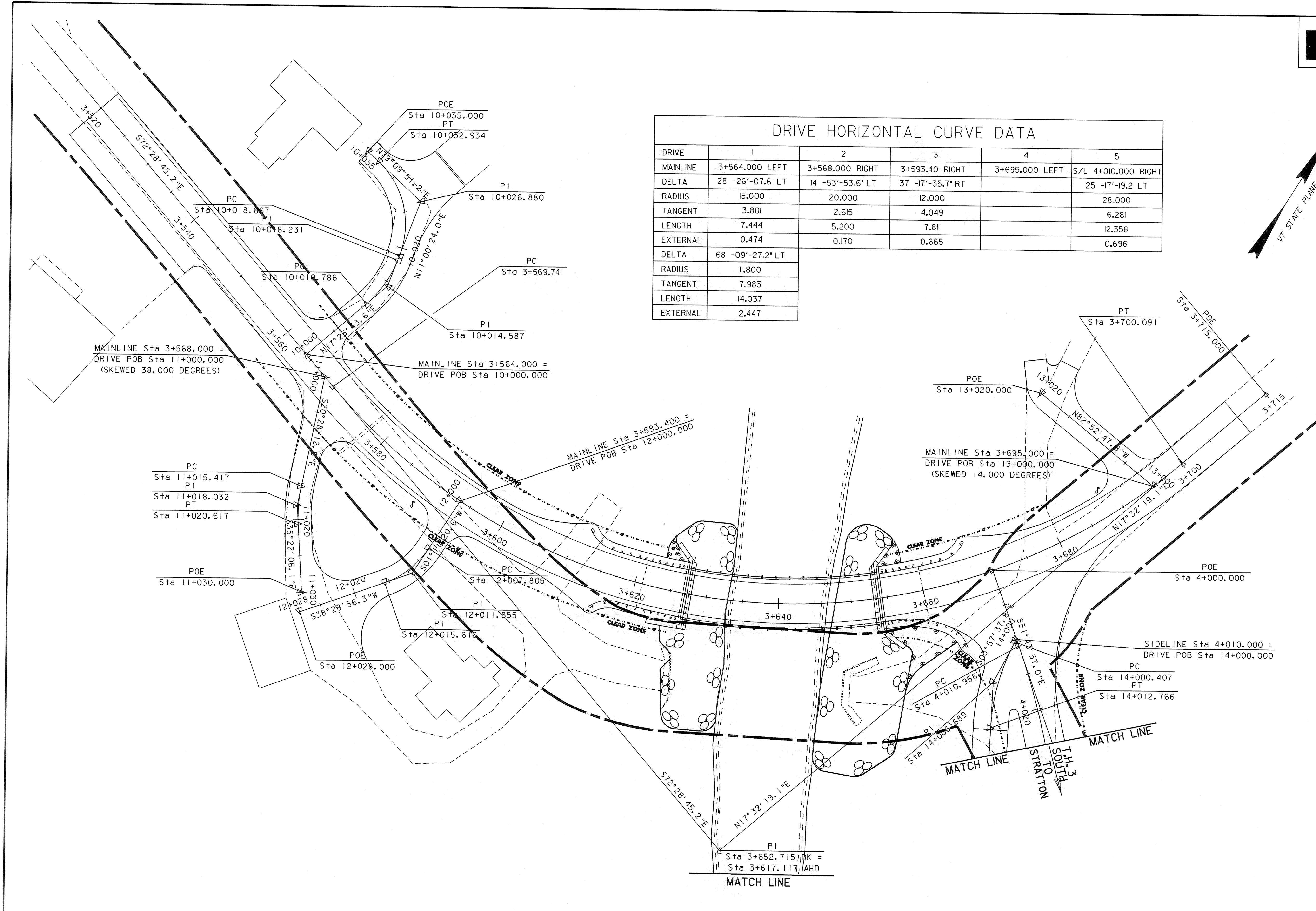
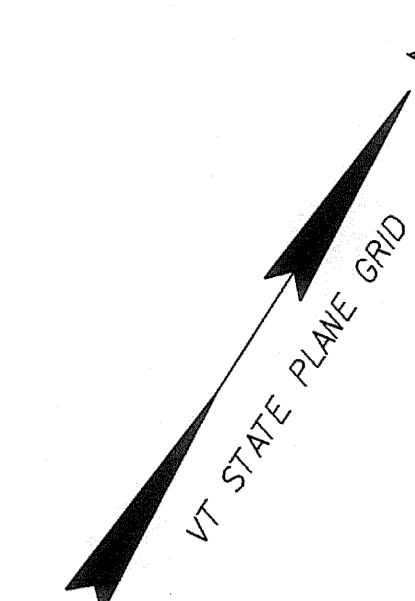

SHEET NAME: <b>DRIVE ALIGNMENTS</b>	
PROJECT NAME: <b>SUNDERLAND</b>	HIGHWAY NO.: TH 3
PROJECT NUMBER: <b>BRF 0114(2)</b>	BRIDGE NO.: 14
	OVER: ROARING BRANCH
FILE NAME: /PW/93J009/sj009bdr.dgn	PLOT DATE: 14-DEC-2005
PROJECT MANAGER: R. R. WHITCOMB	DRAWN BY: K.UPMAL
DESIGNED BY: K.UPMAL	IPARM NAME: sj009d01.i
	SHEET 14 OF 67