

TYPICAL CURB SECTION
SCALE 1:10

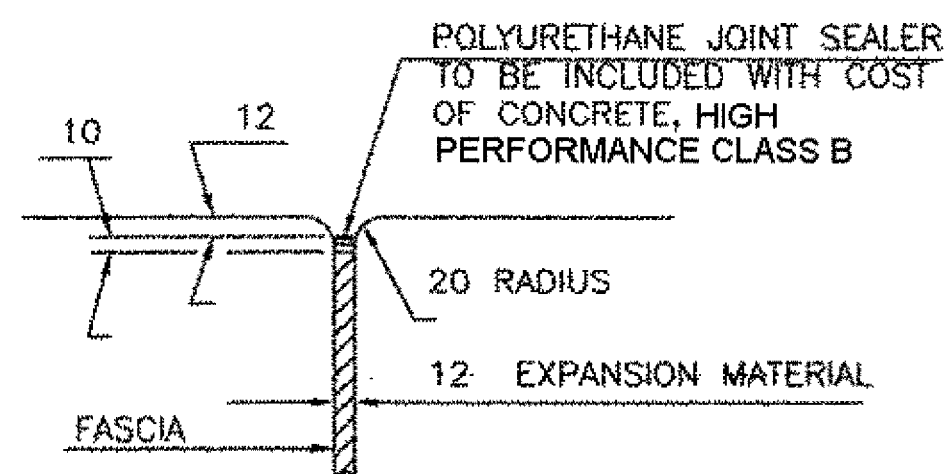

JOINT BETWEEN FASCIA AND WINGWALL

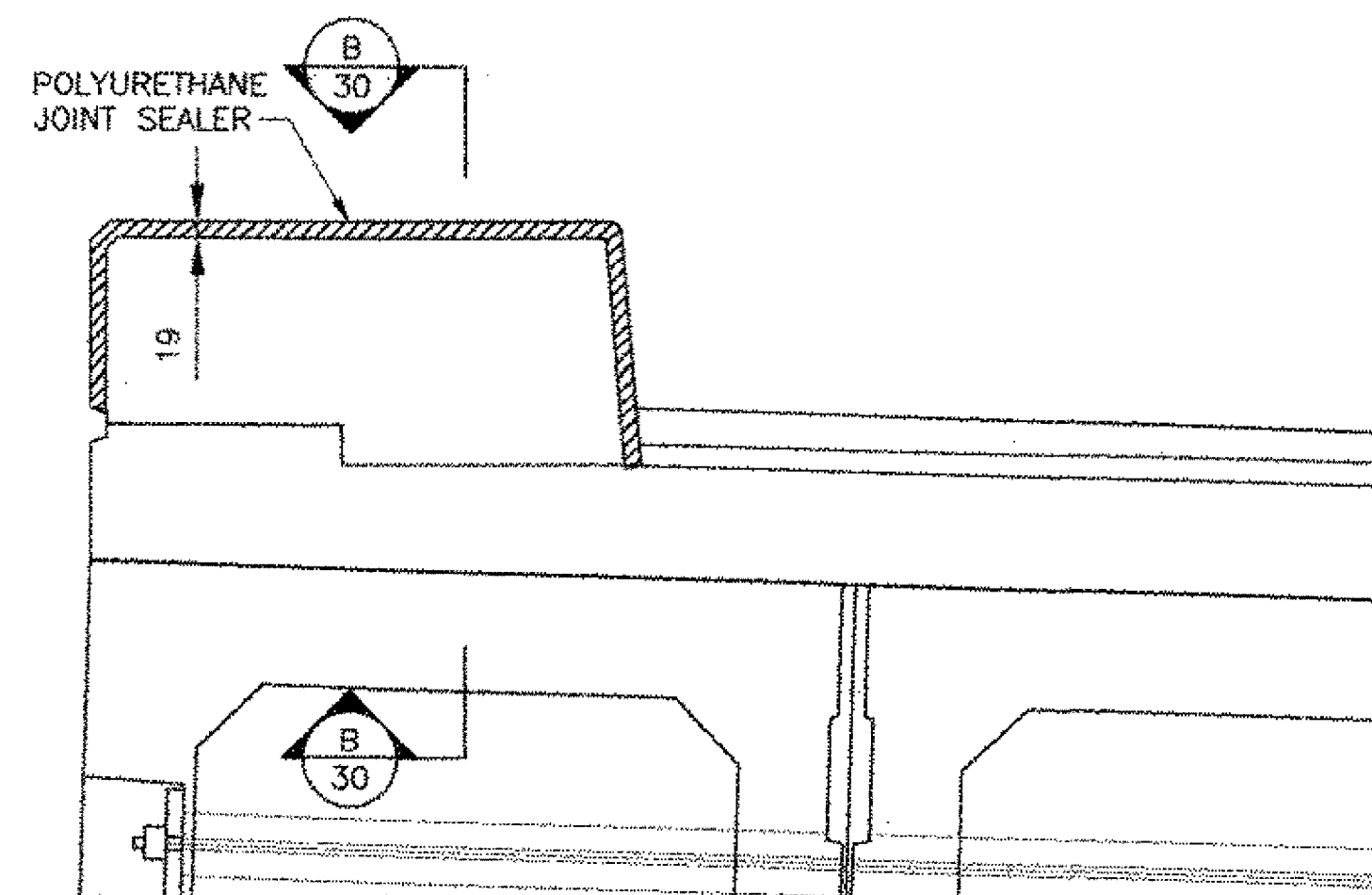

TYPICAL SECTION THROUGH CONCRETE CONSTRUCTION JOINT

SCALE 1:10

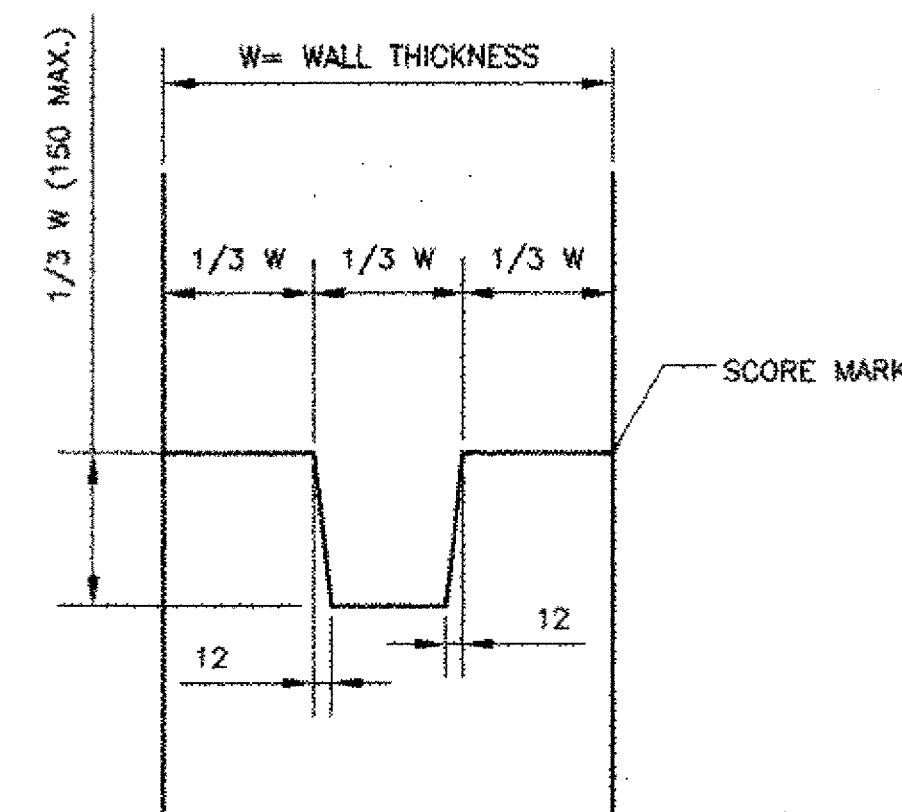

TYPICAL CONCRETE CONSTRUCTION JOINT

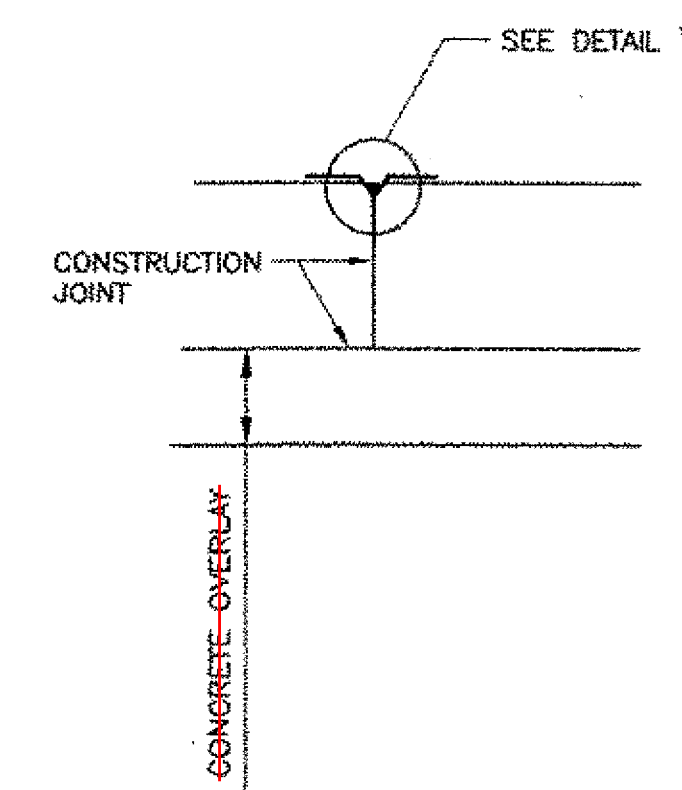

SECTION B-30

POLYURETHANE JOINT SEALER PER SUBSECTION 524.06(c) COLOR TO MATCH CONCRETE. COST TO BE INCLUDED IN THE UNIT PRICE BID FOR CONCRETE.

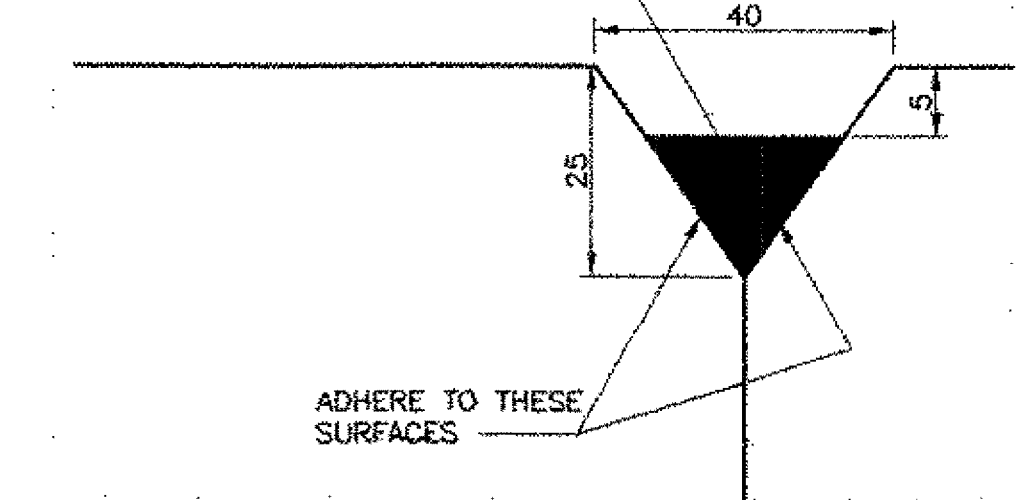

DETAIL "B"

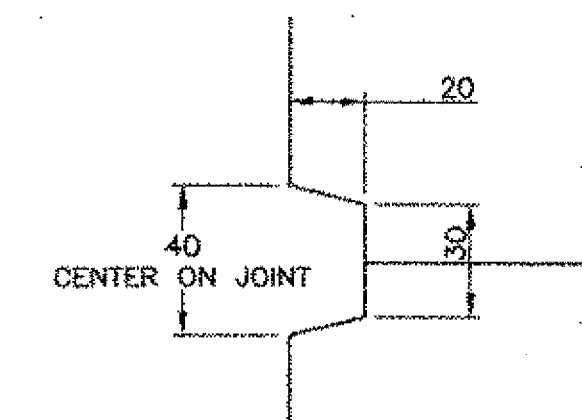

SCORE MARK DETAIL

NOT TO SCALE

NOTES:

1. POLYURETHANE MEMBRANE AND BLAST CLEANING SHALL BE INCLUDED IN THE UNIT PRICE BID FOR SHEET MEMBRANE WATERPROOFING (TORCH APPLIED).
2. SHEET MEMBRANE WATERPROOFING (TORCH APPLIED) SHALL EXTEND TO FACE OF CURB.
3. "E" DENOTES EPOXY COATED BARS.
4. CONSTRUCTION JOINTS IN THE CURBS SHALL BE PROVIDED AS SHOWN ABOVE. JOINTS SHALL BE SPACED MAXIMUM OF 4500 CENTER TO CENTER AND SHALL BE 480 MINIMUM FROM THE CENTER OF THE NEAREST BRIDGE RAIL POST. CONCRETE SHALL BE PLACED IN ALTERNATING SECTIONS WITH A MINIMUM OF 48 HOURS DELAY BETWEEN ADJACENT POURS.
5. LONGITUDINAL REINFORCING SHALL PASS THROUGH CONCRETE CONSTRUCTION JOINTS.
6. ALL EPOXY COATED STEEL THAT NEEDS TO BE CUT IN THE FIELD IS TO BE SAW CUT AND THE EXPOSED END IS TO BE TREATED AS PER SECTION 507.04.

REVISIONS		STATE OF VERMONT AGENCY OF TRANSPORTATION	
DESCRIPTION	BY & DATE		
		CLARENDON, VERMONT	Bridge No. 14
		TOWN HIGHWAY NO. 1	Log Sta.
			Surv. Sta.
TOWN HIGHWAY NO. 1 OVER THE COLD RIVER			
CURB DETAILS			
Designed by: B. C. ALUSTIN		Drawn by: E. B. SMALL	
Checked by: K. S. MARSHIA date 05/01		Bridge Design Supervisor J.W. TUCKER date 05/01	
PROJECT CLARENDON		PROJECT NO. BRO 1443(29)	
Bridge Sheet No.		SHEET 30 OF 40	

